

Version 1



Version 2



KNIT | SKILL LEVEL: INTERMEDIATE

ABBREVIATIONS

Approx = Approximately

Beg = Beginning

Cont = Continue(ity)

K = Knit

K1tbl = Knit next stitch through back loop

K2tog = Knit next 2 stitches together

M1L = Make 1 stitch by picking up horizontal loop lying before next stitch from front to back and knitting into back of loop.

M1R = Make 1 stitch by picking up horizontal loop lying before next stitch from back to front and knitting into front of loop

P = Purl

Pat = Pattern

P1tbl = Purl next stitch through back loop

PM = Place marker

Rem = Remain(ing)

Rep = Repeat

RS = Right side

SM = Slip marker

Ssk = Slip next 2 stitches knitwise one at a time. Pass them back on to left-hand needle, then knit through back loops together

WS = Wrong side

MATERIALS

Caron® x Pantone™ (3.5 oz/100 g; 127 yds/116m)

Sizes XS/S M L XL 2/3 XL 4/5 XL
Dance Party (01029) 6 7 8 9 11 13 braids

Sizes U.S. 9 [5.5 mm] and U.S. 10 [6 mm] circular knitting needles 29" [73.5 cm] long. Sets of 4 sizes U.S. 9 (5.5 mm) and U.S. 10 (6 mm) double-pointed knitting needles **or sizes needed to obtain gauge.** 4 stitch markers. 2 stitch holders.

Version 1

A - 18-2436 B - 18-3520 C - 17-4540 D - 19-4324 E - 19-4009

Version 2

A - 19-4009 B - 17-4540 C - 18-3520 D - 18-2436 E - 19-4324

SIZES

To fit bust measurement

XS/S 28-34" [71-86.5 cm]
M 36-38" [91.5-96.5 cm]
L 40-42" [101.5-106.5 cm]
XL 44-46" [112-117 cm]
2/3 XL 48-54" [122-137 cm]
4/5 XL 56-62" [142-157.5 cm]

Finished bust measurement

XS/S 36" [91.5 cm]
M 40" [101.5 cm]
L 44" [112 cm]
XL 48" [122 cm]
2/3 XL 56" [142 cm]
4/5 XL 64" [162.5 cm]

GAUGE

15 sts and 20 rows = 4" [10 cm] in stocking st with larger needles.

INSTRUCTIONS

Notes:

- Before working with Caron® x Pantone™ multi-shade yarn braid, separate each color link and wind into 5 separate balls.

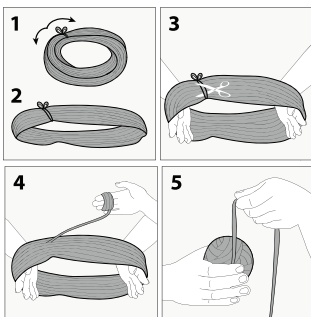

- Each color link will be referenced by its Pantone # (see ball band).
- Designate each different shade of the 5 separate yarn balls as Contrast A, B, C, D and E as noted in Materials section (or as desired).
- Due to finite amount of yarn in each shade, pattern gauge must be matched to ensure successful results.
- Garment is intended to be worn open at center front.

The instructions are written for smallest size. If changes are necessary for larger sizes the instructions will be written thus (). Numbers for each size are shown in the same color throughout the pattern. When only one number is given in black, it applies to all sizes.

Stripe Pat

With A, work 6 rows.
With D, work 2 rows.
With B, work 6 rows.
With D, work 2 rows.
With C, work 6 rows.
With D, work 2 rows.
These 24 rows form Stripe Pat.

Note: Contrast E is reserved for ribbing.
Body is worked in one piece on circular needle. Sleeves are worked in the round on double-pointed needles.

BODY

Beg at neck edge, with A and larger circular needle, cast on **35** (39-41-43-51-55) sts.

Set Up Row: K3. PM. K2. PM. **K25** (29-31-33-41-45). PM. K2. PM. Knit to end of row.

Next row: Purl.

Begin Raglan Increases:

1st row: (Knit to 1 st before marker. M1R. K1. SM. K1. M1L) 4 times. Knit to end of row. **43** (47-49-51-59-63) sts.

2nd and alt rows: Purl.

3rd row: As 1st row. **51** (55-57-59-67-71) sts.

5th row: K2. M1L. (Knit to 1 st before marker. M1R. K1. SM. K1. M1L) 4 times. Knit to last 2 sts. M1R. K2. **61** (65-67-69-77-81) sts.

6th row: Purl.

First 8 rows of Stripe Pat are complete. Keeping cont of Stripe Pat, rep 1st to 6th rows **5** (6-6-7-7-8) times more, ending last rep on a **6th** (2nd-6th-2nd-6th-6th) row. **191** (203-223-233-259-289) sts.

Divide Body and Sleeves

Next row: **K27** (28-31-32-35-39). Place next **38** (40-44-46-50-56) sts on st holder. Cast on **6** (8-10-12-16-18) sts. **K61** (67-73-77-89-99). Place next **38** (40-44-46-50-56) sts on st holder. Cast on **6** (8-10-12-16-18) sts. Knit to end of row. **127** (139-155-165-191-213) Body sts.

Cont in Stripe Pat until Body from joining row measures approx **12** (12-12½-13-13½-14)" [**30.5** (30.5-32-33-34.5-35.5)cm], ending on a 6th, 14th, or 22nd row of Stripe Pat.

Bottom Ribbing

Change to E and smaller circular needle.

1st row: (RS). K1tbl. *P1tbl. K1tbl. Rep from * to end of row.

2nd row: P1tbl. *K1tbl. P1tbl. Rep from * to end of row.

Rep these 2 rows for Twisted Rib Pat for 2" [5 cm], ending on a RS row. Cast off in pat.

SLEEVES

With set of 4 larger double-pointed needles, using appropriate color to cont in Stripe Pat, beg at center of underarm, pick up and knit **3** (4-5-6-8-9) sts. **K38** (40-44-46-50-56) from st holder. Pick up and knit **3** (4-5-6-8-9) sts across rem of underarm cast on edge. Join in rnd. PM on first st. **44** (48-54-58-66-74) sts.

Keeping cont of Stripe Pat, work in rnds until Sleeve measures **7** (6½-6-5½-5-4)" [**18** (16.5-15-14-12.5-10) cm] from underarm.

Shape sides: 1st rnd: K1. K2tog. Knit to last 3 sts. ssk. K1. **42 (46-52-56-64-72)** sts.

2nd to 4th rnds: Knit.

Rep these 4 rnds **3 (4-6-7-9)** times more. **36 (38-40-42-50-54)** sts.

Cont even in Stripe Pat until Sleeve from underarm measures approx **12 (12-11½-11-11-11)" [30.5 (30.5-29-28-28-25.5) cm]**, ending on a 6th, 14th, or 22nd row of Stripe Pat.

Ribbing

Change to E and smaller double-pointed needles.

1st rnd: *K1tbl. P1tbl. Rep from * around.

Rep last rnd until ribbing measures 2" [5 cm]. Cast off in ribbing.

Neckband

With smaller circular needle and E, pick up and knit **100 (104-110-114-118-122)** sts up along Right Front to Sleeve; **29 (33-35-37-45-49)** sts across top of Sleeves and Back neck edge; and **100 (104-110-114-118-122)** sts down Left Front. **229 (241-255-265-281-293)** sts

1st row: (WS). P1tbl. *K1tbl. P1tbl. Rep from * to end of row.

2nd row: K1tbl. *P1tbl. K1tbl. Rep from * to end of row.

Rep these 2 rows for Twisted Rib Pat for 1½" [4 cm], ending on a RS row. Cast off in pat.

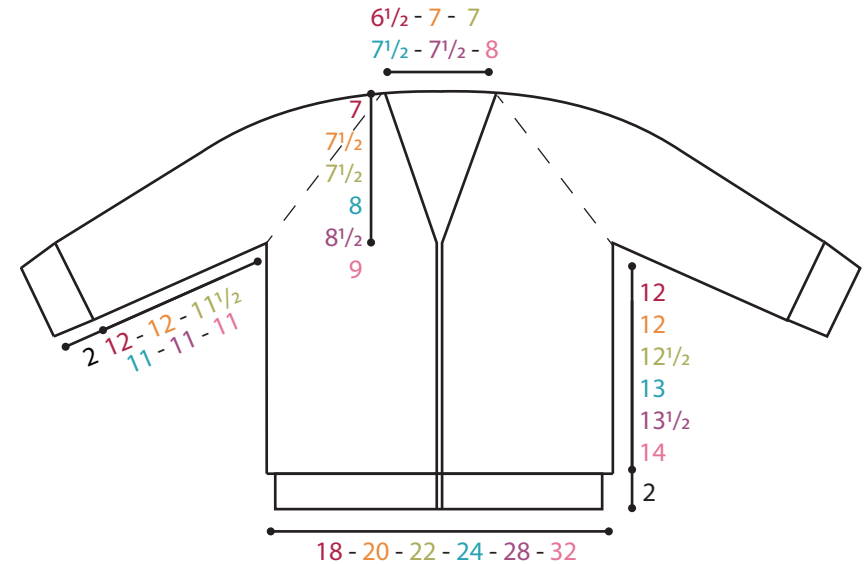

Version 1



Version 2

