

Version 1



Version 2



## MATERIALS

**Caron® x Pantone™ Bamboo™** (3.5 oz/100 g; 180 yds/165 m)  
Cherry Cheesecake (03039) **8 braids**

Size U.S. 8 (5 mm) circular knitting needle 29" [73.5 cm] long **or size needed to obtain gauge.** Stitch marker.

A - 11-0603

B - 13-1208

C - 16-1620

D - 18-1950

E - 19-1524



KNIT | SKILL LEVEL: **INTERMEDIATE**

## ABBREVIATIONS

**Approx** = Approximately

**Beg** = Beginning

**Cont** = Continue(ity)

**K** = Knit

**Kfb** = Increase 1 stitch by knitting into front and back of next stitch

**P** = Purl

**Pat** = Pattern

**PM** = Place marker

**P2sso** = Pass 2 slipped stitches over

**Rem** = Remain(ing)

**Rep** = Repeat

**RS** = Right side

**Sl1Pwyib** = Slip next stitch purlwise with yarn held in back

**Sl1Pwyif** = Slip next stitch purlwise with yarn held in front

**Sl2K** = Slip next 2 stitches knitwise

**St(s)** = Stitch(es)

**WS** = Wrong side

## MEASUREMENTS

Approx 22" x 68" [59 x 172.5 cm].

## GAUGE

24 sts and 40 rows = 4" [10 cm] in Linen St Pat.

## INSTRUCTIONS

- Before working with Caron® x Pantone™ Bamboo™ multi-shade yarn braid, separate each color link and wind into 5 separate balls.

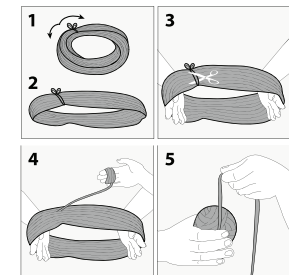

- Due to finite amount of yarn in each shade, pattern gauge must be matched to ensure successful results.

## Version 1 – Stripe Pat

With A, work 2 rows.

With B, work 2 rows.

With C, work 2 rows.

With D, work 2 rows.

With E, work 2 rows.

These 10 rows form Stripe Pat.

## Version 2 – Stripe Pat

With A, work 56 rows.

(With B, work 2 rows. With A, work 2 rows) 14 times.

With B, work 56 rows.

(With C, work 2 rows. With B, work 2 rows) 14 times.

With C, work 56 rows.

(With D, work 2 rows. With C, work 2 rows) 14 times.

With D, work 56 rows.

(With E, work 2 rows. With D, work 2 rows) 14 times.

With E, work 56 rows.

These 504 rows form Stripe Pat.

## Both Versions

With A, cast on 153 sts. Knit 2 rows (garter st), noting 1st row is WS.

**Set-up row:** K77. PM on last st. Knit to end of row.

Beg working in Stripe Pat.

### Linen St Pat:

**1st row:** (RS). K3. Kfb. \*Sl1Pwyif. K1. Rep from \* to 1 st before marked st. Sl2K. K1. P2sso. PM on last st. \*\*K1. Sl1Pwyif. Rep from \*\* to last 4 sts. Kfb. K3.

**2nd row:** K3. \*P1. Sl1Pwyib. Rep from \* to last 4 sts. P1. K3.

**3rd row:** K2. Kfb. Sl1Pwyif. \*K1. Sl1pwyif. Rep from \*\* to 1 st before marked st. Sl2K. K1. P2sso. PM on last st. \*\*Sl1Pwyif. K1. Rep from \*\* to last 4 sts. Sl1Pwyif. Kfb. K2.

**4th row:** K3. \*Sl1Pwyib. P1. Rep from \* to marked st. Sl1Pwyif. \*\*P1. Sl1Pwyib. Rep from \*\* to last 3 sts. K3.

These 4 rows form Linen St Pat.

Cont in pat until work from beg measures 48" [122 cm] long, ending on a WS row.

Keeping cont of Stripe Pat, work decrease section as follows:

### Decrease Section:

**1st row:** (RS). K4. \*Sl1Pwyif. K1. Rep from \* to 1 st before marked st. Sl2K. K1. P2sso. PM on last st. \*\*K1. Sl1Pwyif. Rep from \*\* to last 4 sts. K4.

**2nd row:** K3. \*Sl1Pwyib. P1. Rep from \* to last 4 sts. Sl1Pwyib. K3.

**3rd row:** K4. \*Sl1pwyif. K1. Rep from \* to 2 sts before marked st. Sl1Pwyif. Sl2K. K1. P2sso. PM on last st. \*\*Sl1Pwyif. K1. Rep from \*\* to last 3 sts. K3.

**4th row:** K3. \*Sl1Pwyib. P1. Rep from \* to marked st. Sl1Pwyif. \*\*P1. Sl1Pwyib. Rep from \*\* to last 3 sts. K3.

Rep these 4 rows until 13 sts rem.

### Final Decrease Section

**1st row:** K5. Sl2K. K1. P2sso. K5.

**2nd row:** Knit.

**3rd row:** K4. Sl2K. K1. P2sso. K4.

**4th row:** Knit.

**5th row:** K3. Sl2K. K1. P2sso. K3.

**6th row:** Knit.

**7th row:** K2. Sl2K. K1. P2sso. K2.

Cast off knitwise.

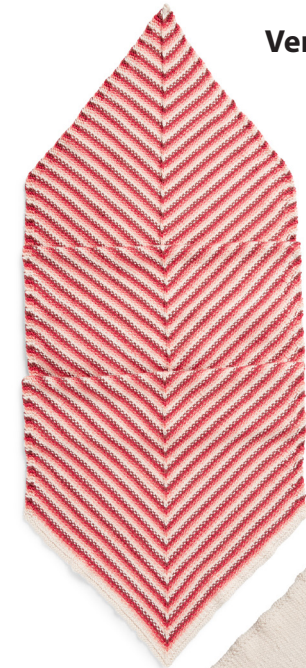

Version 1



Version 2