

Version 1

Version 2



## MATERIALS

**Caron® x Pantone™ Bamboo™** (3.5 oz/100 g; 180 yds/165 m)  
Life's Beginning (03035) **5 braids**

Size U.S. H/8 (5 mm) crochet hook **or size needed to obtain gauge.**

## Version 1

A - 14-4504    B - 13-0935    C - 15-6317    D - 12-4609    E - 19-4205

## Version 2

A - 19-4205    B - 12-4609    C - 15-6317    D - 14-4504    E - 13-0935

 CROCHET | SKILL LEVEL: **EASY**

## ABBREVIATIONS

**Approx** = Approximately

**Ch** = Chain(s)

**Cont** = Continue(ity)

**Dc** = Double crochet

**Pat** = Pattern

**Rep** = Repeat

**Sc** = Single crochet

**Sp(s)** = Space(s)

**St(s)** = Stitch(es)

**WS** = Wrong side

## MEASUREMENTS

Approx 32" x 64" [81.5 x 163 cm].

## GAUGE

2 Fan Sts and 8 rows = 4" [10 cm] in pat.

## INSTRUCTIONS

### Notes:

- Before working with Caron® x Pantone™ Bamboo™ multi-shade yarn braid, separate each color link and wind into 5 separate balls.
- Each color link will be referenced by its Pantone # (see ball band)
- Designate each different shade of the 5 separate yarn balls as Contrast A, B, C, D and E as noted in Materials section (or as desired).
- Due to finite amount of yarn in each shade, pattern gauge must be matched to ensure successful results.
- When joining colors, work to last 2 loops on hook of first color. Draw new color through last 2 loops and proceed.

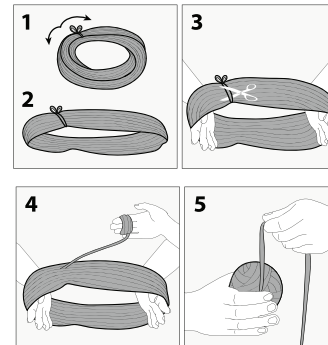

## Stripe Pat

With A, work 28 rows.

With B, work 2 rows.

With A, work 2 rows.

\*\*With B, work 2 rows.

With C, work 2 rows.\*\*

Rep from \*\* to \*\* 3 times more.

With D, work 2 rows.

With C, work 2 rows.

\*\*\*With D, work 2 rows.

With E, work 2 rows.\*\*\*

Rep from \*\*\* to \*\*\* twice more.

These 64 rows form Stripe Pat.

With A, ch 5.

**1st row:** (WS). 1 dc in 5th ch from hook (counts as 1 dc. Ch 1. 1 dc). Turn.

**2nd row:** Ch 3 (counts as 1 dc here and throughout). 9 dc in ch-1 sp – Fan St made. 1 dc in last st. Turn.

**3rd row:** Ch 4 (counts as 1 dc. Ch 1 here and throughout). 1 dc in first dc. Ch 5. Skip each of next 9 dc. (1 dc. Ch 1. 1 dc) in last st. Turn.

**4th row:** Ch 3. 1 Fan St in next ch-1 sp. Working around ch-5 to enclose it, 1 sc in 5th dc of Fan St 2 rows below. 1 Fan St in next ch-1 sp. 1 dc in last st. Turn.

**5th row:** Ch 4. 1 dc in first dc. Ch 5. Skip each of next 9 dc. (1 dc. Ch 1. 1 dc) in next sc. Ch 5. Skip each of next 9 dc. (1 dc. Ch 1. 1 dc) in last st. Turn.

**6th row:** Ch 3. 1 Fan St in next ch-1 sp. \*Working around ch-5 to enclose it, 1 sc in 5th dc of Fan St 2 rows below. 1 Fan St in next ch-1 sp. Rep from \* to last st. 1 dc in last st.

**7th row:** Ch 4. 1 dc in first dc. \*Ch 5. Skip each of next 9 dc. (1 dc. Ch 1. 1 dc) in next sc. Rep from \* to last Fan St. Ch 5. Skip each of next 9 dc. (1 dc. Ch 1. 1 dc) in last st. Turn.

**8th row:** Ch 3. 1 Fan St in next ch-1 sp. \*Working around ch-5 to enclose it, 1 sc in 5th dc of Fan St 2 rows below. 1 Fan St in next ch-1 sp. Rep from \* to last st. 1 dc in last st. Turn.

First 8 rows of Stripe Pat are complete.

Keeping cont of Stripe Pat, rep 7th and 8th rows 28 times more. 32 Fan Sts.

Fasten off.

