



Version 1

Version 2

MATERIALS

Caron® x Pantone™ (3.5 oz/100 g; 127 yds/116 m)
Blushing Coral (01033) **5 balls**

Size U.S. K/10½ (6.5 mm) crochet hook **or size needed to obtain gauge.**

Version 1

A - 12-5209 B - 14-4812 C - 14-1219 D - 16-1546 E - 18-3712

Version 2

Right Side

E - 18-3712 B - 14-4812 C - 12-5209 D - 14-4812 E - 12-5209

Left Side

E - 18-3712 B - 16-1546 C - 14-1219 D - 16-1546 E - 14-1219



CROCHET | SKILL LEVEL: **EASY**

ABBREVIATIONS

Approx = Approximately

Beg = Begin(ning)

Ch = Chain(s)

Dc = Double crochet

Pat = Pattern

Rem = Remain(ing)

RS = Right side

Sl st = Slip stitch

Sp = Space(s)

St(s) = Stitch(es)

Tog = Tog

WS = Wrong side

MEASUREMENTS

Approx 18 x 60" [45.5 x 152.5 cm].

GAUGE

12 dc and 6½ rows = 4" [10 cm] in pat.

- Due to a finite amount of yarn in each shade, pattern gauge must be matched to ensure successful results.
- Ch-3 at beg of rows counts as dc throughout.

INSTRUCTIONS

Notes:

- Before working with Caron® x Pantone™ multi-shade yarn braid, separate each color link and wind into 5 separate balls.

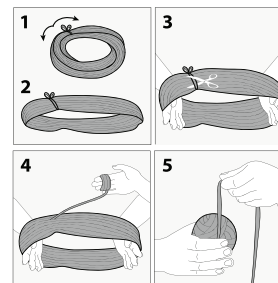

Right Side

With A, ch 42.

1st row: (RS). 1 dc in 4th ch from hook (counts as 2 dc). 1 dc in each ch to last ch. [(1 dc. Ch 1) 4 times. 1 dc] all in last ch. Working across opposite side of foundation ch, 1 dc in each ch to last 6 ch. **Turn.** Leave rem 6 ch unworked.

2nd row: (WS). Ch 3. 1 dc in each dc to first ch-1 sp. 1 dc in first ch-1 sp. [(1 dc. Ch 1) twice. 1 dc] in next dc – corner made. 1 dc in next ch-1 sp. 1 dc in next dc. 1 dc in next ch-1 sp. Corner in next dc. 1 dc in next ch-1 sp. 1 dc in each dc to end of row. **Turn.**

3rd row: (RS). Ch 3. 1 dc in each dc to first ch-1 sp. 1 dc in first ch-1 sp. Corner in next dc. 1 dc in next ch-1 sp. 1 dc in each of next 5 dc. 1 dc in next ch-1 sp. Corner in next dc. 1 dc in next ch-1 sp. 1 dc in each dc to end of row. Fasten off.

Do not turn.

With RS facing, join B with sl st to first dc of Row 3.

4th row: (RS). With B, ch 8. 1 dc in 4th ch from hook (counts as 2 dc). 1 dc in each of next 4 ch. *Working in back loops only*, 1 dc in next dc (same st as joining sl st). 1 dc in each dc to first ch-1 sp. 1 dc in first ch-1 sp. Corner in next dc. 1 dc in next ch-1 sp. 1 dc in each dc to next ch-1 sp. 1 dc in next ch-1 sp. Corner in next dc. 1 dc in next ch-1 sp. 1 dc in each dc to last 6 dc. **Turn.** Leave rem 6 dc unworked.

5th row: (WS). Ch 3. *Working in both loops*, 1 dc in each dc to first ch-1 sp. 1 dc in first ch-1 sp. Corner in next dc. 1 dc in next ch-1 sp. 1 dc in each dc to next ch-1 sp. 1 dc in next ch-1 sp. Corner in next dc. 1 dc in next ch-1 sp. 1 dc in each dc to end of row. Turn.

6th row: (RS). As 5th row. Fasten off.

With RS facing, join C with sl st to first dc of 6th row.

7th to 9th rows: With C, as 4th to 6th rows.

With RS facing, join D with sl st to first dc of 9th row.

10th to 12th rows: With D, as 4th to 6th rows.

With RS facing, join E with sl st to first dc of 12th row.

13th to 15th rows: With E, as 4th to 6th rows. Fasten off.

Left Side

Work as given for Right Side, noting RS and WS will be reversed, and working 4th, 7th, 10th and 13th rows in front loops only.

FINISHING

Sew Right and Left Sides tog between corners.



Version 1



Version 2