



 CROCHET | SKILL LEVEL: EASY

ABBREVIATIONS

Approx = Approximate(ly)
Ch = Chain(s)
Cont = Continue(ity)
Pat = Pattern
Rem = Remaining
Rep = Repeat

RS = Right side
Sc = Single crochet
Sp(s) = Space(s)
St(s) = Stitch(es)
Tog = Together
WS = Wrong side

MEASUREMENTS

Approx 8" x 80" [20.5 x 203.5 cm], excluding fringe.

GAUGE

12 sts and 14 rows = 4" [10 cm] in pat.

INSTRUCTIONS

Notes:

- Before working with Caron® x Pantone™ multi-shade yarn braid, separate each color link and wind into 5 separate balls for each braid.

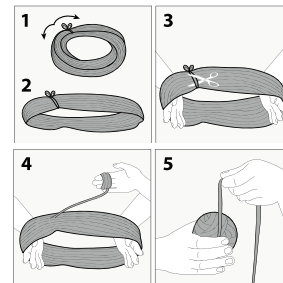

- Due to a finite amount of yarn in each shade, pattern gauge must be matched to ensure successful results.
- To join new color, work to last loops on hook of first color. Yoh with new color, draw through loops and proceed with new color.

With MC, ch 24.

1st row: (RS). 1 sc in 2nd ch from hook. *Ch 1. Skip next ch. 1 sc in next ch. Rep from * to end of chain. Turn. 23 sts.

****2nd row:** Ch 1. 1 sc in first sc. 1 sc in next ch-1 sp. *Ch 1. Skip next sc. 1 sc in next ch-1 sp. Rep from * to last sc. 1 sc in last sc. Turn.

MATERIALS

Caron® x Pantone™ (3.5 oz/100 g; 127 yds/116 m)

Version 1

Main Color (MC) Coconut Cream (01001) **1 braid**
Contrast A Spicy Blooms (01014) **2 braids**

Version 2

Main Color (MC) Coconut Cream (01001) **1 braid**
Contrast A Ultra Violet Minerals (01012) **2 braids**

Version 3

Main Color (MC) Coconut Cream (01001) **1 braid**
Contrast A Morning Blues (01016) **2 braids**

Size U.S. L/11 (8 mm) crochet hook **or size needed to obtain gauge.**

MC - 11-4302

Version 1

17-1452 17-1462 17-1723 18-1561 18-2436

Version 2

13-3406 15-3912 16-3307 18-3712 18-3838

Version 3

14-4809 17-5034 19-4340 19-4026 19-4023

3rd row: Ch 1. 1 sc in first sc. Ch 1. Skip next sc. *1 sc in next ch-1 sp. Ch 1. Skip next sc. Rep from * to last sc. 1 sc in last sc. Turn. Rep last 2 rows for pat until MC section measures 4" [10 cm], ending on a WS row.

Join color of choice from Contrast A braid. Cont in pat until work from color change measures 12" [30.5 cm], ending on a WS row. Join MC.**

Work from ** to ** 4 times more. Fasten off.

Fringe: Using rem yarn from Contrast A braid, cut strands of yarn 16" [40.5 cm] long. Taking 3 strands tog, fold in half and knot into fringe across ends of Scarf. Trim fringe evenly.

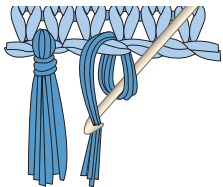

Version 1



Version 2



Version 3

