



STEM CASTERS ASSEMBLY GUIDE

VIEW OUR ASSEMBLY VIDEO



Scan the QR code to view video instructions on assembling casters onto your wire shelving unit.

BEFORE GETTING STARTED

1. Lay out all of your parts to take inventory of your goods
2. If you notice something damaged or missing, call us
3. Assemble on a flat surface

INSIDE YOUR BOXES

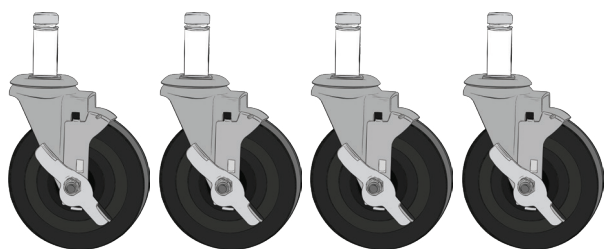

STEM CASTERS

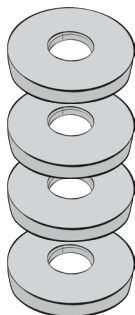

DONUT BUMPERS

— if purchased —

HOW TO ASSEMBLE

- 01** Lay your assembled wire shelving unit on its side.

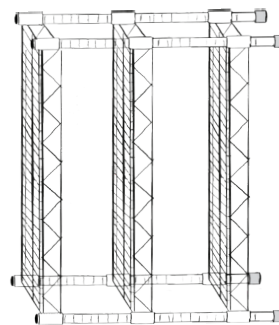

- 02** Remove leveling feet and threaded insert from the post bottoms. Tap the post bottom against a hard surface if insert is stuck.



- 03** Keep bushing (or half ring) in place. This helps hold the caster in place once installed.

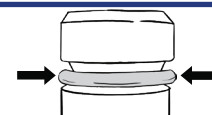

- 04** Add donut bumpers to each post (if purchased). Insert the stem caster plug into the bottom of each post.

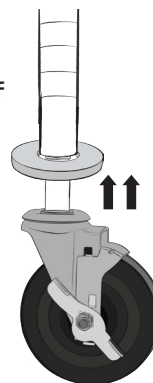

- 05** Use a rubber mallet or hammer to drive casters into place. Ensure all are securely inserted.

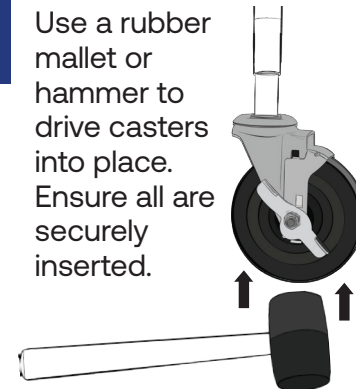

Thank you for shopping with Shelving Inc. If you have any questions, comments, or concerns, please contact us:

Toll Free: 1-800-637-9508 | **Local/International:** 248-852-8500 | **Live Chat:** Shelving.com



THREADED CASTERS ASSEMBLY GUIDE

VIEW OUR ASSEMBLY VIDEO



Scan the QR code to view video instructions on assembling casters onto your wire shelving unit.

BEFORE GETTING STARTED

1. Lay out all of your parts to take inventory of your goods
2. If you notice something damaged or missing, call us
3. Assemble on a flat surface

INSIDE YOUR BOXES

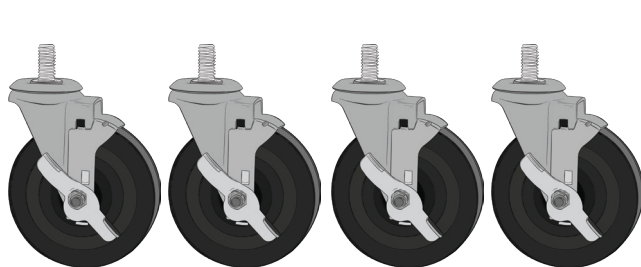

THREADED CASTERS

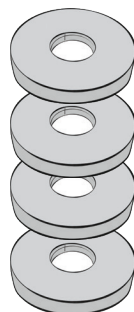

DONUT BUMPERS
— if purchased —

HOW TO ASSEMBLE

- 01** Lay your assembled wire shelving unit on its side.

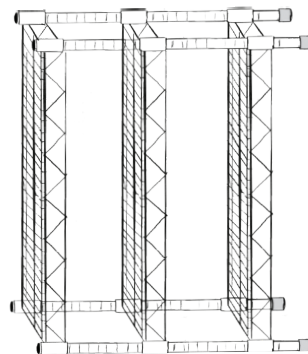

- 02** Remove leveling feet from post bottom.

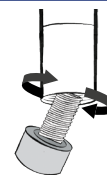

- 03** Add locking washer to caster to prevent from untwisting once attached.

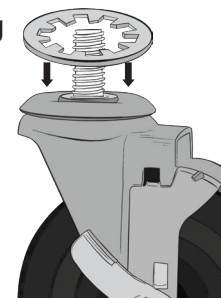

- 04** Add donut bumpers to each post (if purchased). Screw the caster into the threaded hole at the bottom of each post. Ensure caster threads are aligned with post threads to avoid cross-threading.

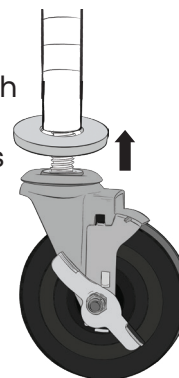

- 05** Tighten casters with a wrench or pliers. Avoid over-tightening, which could strip the threads. Ensure all are securely inserted.



Thank you for shopping with Shelving Inc. If you have any questions, comments, or concerns, please contact us:

Toll Free: 1-800-637-9508 | **Local/International:** 248-852-8500 | **Live Chat:** Shelving.com