

# Aqara



## Camera Protect Kit Y100 User Manual

### Product Introduction

#### Welcome to Aqara HomeGuardian Protect Plan:

[Camera Hub G3] The core device for video surveillance and home security alerts, and serves as a Zigbee Hub for other Aqara Zigbee devices. Home monitoring can be viewed at all times through the app, and the Hub can securely control connected home devices.

[Motion Sensor P1] Alerts you to abnormal movement inside your home. The sensor should be adjusted to the appropriate monitoring angle and attached with the 3M adhesive tape.

[Door and Window sensor] Alerts you when a door or window is opened abnormally. The sensor can be attached with the 3M adhesive tape.

[Vibration Sensor T1] Alerts you when abnormal vibrations are detected. The sensor can be attached with the 3M adhesive tape.

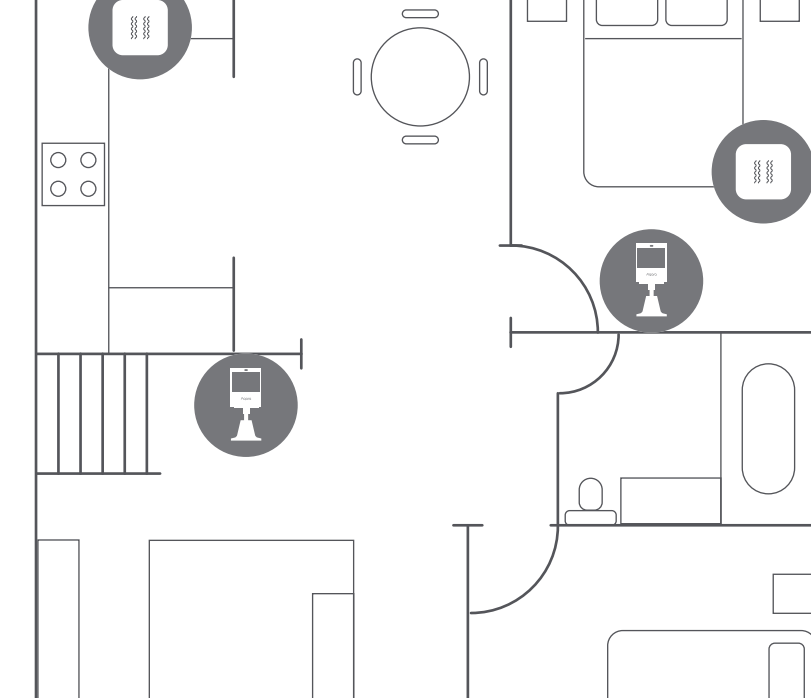

\*The Aqara HomeGuardian Protection plan requires an additional subscription on the Aqara Home app. Subscription sold separately. Users who purchase the kit receive a free subscription for 31 days. For details, please refer to the Aqara Home app.

### Schematic diagram of product installation location

This house diagram shows you where Aqara HomeGuardian Protect devices can be installed

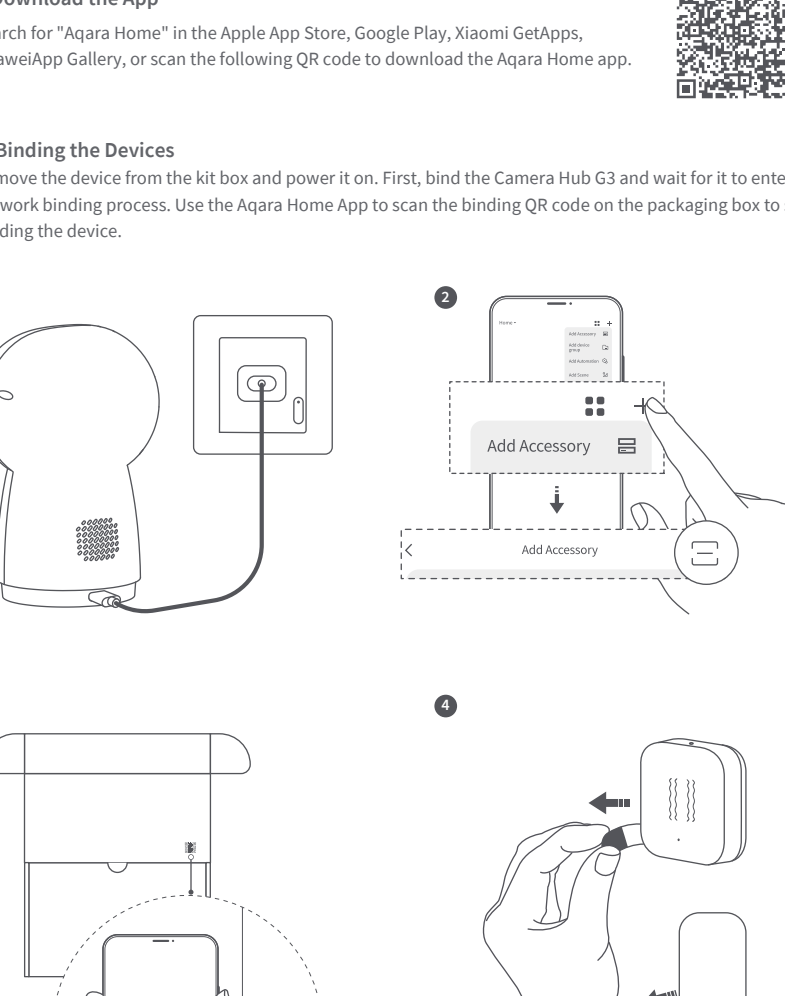

### Quick connection of the device

#### 1.Download the App

Search for "Aqara Home" in the Apple App Store, Google Play, Xiaomi GetApps, HuaweiApp Gallery, or scan the following QR code to download the Aqara Home app.

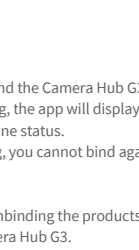

#### 2. Binding the Devices

Remove the device from the kit box and power it on. First, bind the Camera Hub G3 and wait for it to enter the network binding process. Use the Aqara Home App to scan the binding QR code on the packaging box to start binding the device.

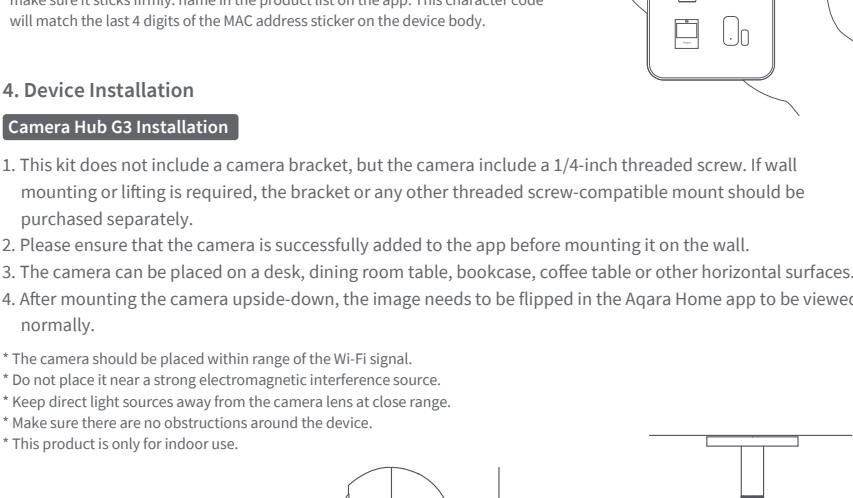

\*When the products in the kit are first bound, they are pre-bound together by default. Users only need to bind the Camera Hub G3 to complete the binding of all products in the kit. If the sensors do not have a battery installed after binding, the app will display the sensors status as offline by default. Replace and install new batteries, and the sensor will return to online status.  
\*The pre-binding status only takes effect during the first binding. If you unbind after completing the binding, you cannot bind again in the pre-binding status. However, you can still manually bind the products in the package.  
\*You can purchase other Aqara Zigbee sub devices and bind them to the Camera Hub G3.  
\*When binding for the first time, do not perform a factory reset operation on the Camera Hub G3 to avoid unbinding the products in the set. If you accidentally factory reset, you will need to manually bind the sensors after binding the Camera Hub G3.

#### 3. Follow the Instructions in the App to Proceed

Follow the instructions on the Aqara Home App to complete the binding process of the Kit.

\*Once binding is complete, you can view the character code at the end of the device  
2.Stick the sensor to the installation pedestal, and press hard and evenly for 30 s to make sure it sticks firmly, name in the product list on the app. This character code will match the last 4 digits of the MAC address sticker on the device body.

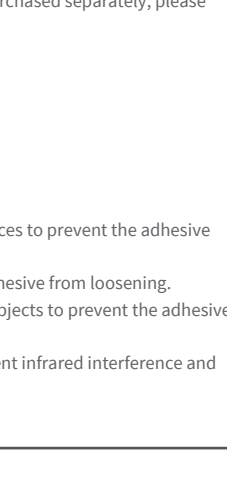

#### 4. Device Installation

##### Camera Hub G3 Installation

- This kit does not include a camera bracket, but the camera include a 1/4-inch threaded screw. If wall mounting or lifting is required, the bracket or any other threaded screw-compatible mount should be purchased separately.
- Please ensure that the camera is successfully added to the app before mounting it on the wall.
- The camera can be placed on a desk, dining room table, bookcase, coffee table or other horizontal surfaces.
- After mounting the camera upside-down, the image needs to be flipped in the Aqara Home app to be viewed normally.

\* The camera should be placed within range of the Wi-Fi signal.  
\* Do not place it near a strong electromagnetic interference source.  
\* Keep direct light sources away from the camera lens at close range.  
\* Make sure there are no obstructions around the device.  
\* This product is only for indoor use.

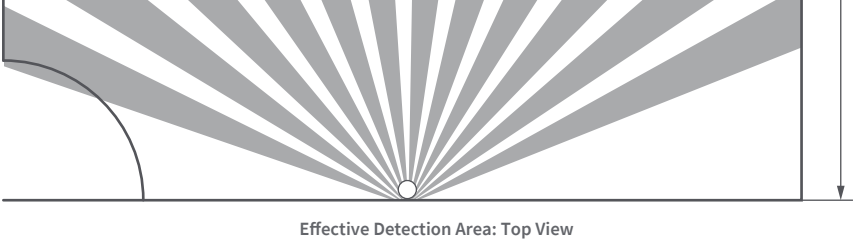

The above diagram shows the installation methods. If using a bracket/mount purchased separately, please refer to its installation guide.

##### Motion Sensor P1 Installation

- Avoid installing on tile, glass, marble, or other smooth, moisture-prone surfaces to prevent the adhesive from loosening.
- Avoid installing on lights or other high-temperature surfaces to prevent the adhesive from loosening.
- Avoid installing on the surface of wall coverings and other rough and uneven objects to prevent the adhesive from loosening.
- Avoid positioning it toward electrical appliances or other heat sources to prevent infrared interference and false triggers.

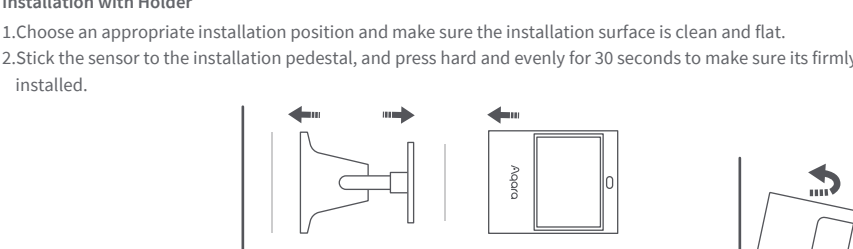

Effective Detection Area: Lateral View



Effective Detection Area: Top View

The recommended installation height is 1.2-2 m. The detection scope gets smaller if it is lower than 1.2 m. There will be a blind zone at the bottom of the motion sensor if it is installed higher than 2 m.

\*Recommended installation height is 1.2-2 m. The detection scope gets smaller if it is lower than 1.2 m. There will be a blind zone at the bottom of the motion sensor if it is installed higher than 2 m.

#### Direct Installation

It requires no manual intervention and is ideal for devices that need 24/7 monitoring, such as smoke detectors. While in this mode, other security modes like Home, Away, and Night can still be armed and will work together to protect your home.

- Choose an appropriate installation position and make sure the installation surface is clean and flat.
- Put the adhesive on the bottom of the battery cover, determine the detection direction, stick it in the desired installation position, and press hard and evenly for 30 seconds to make sure its firmly installed.

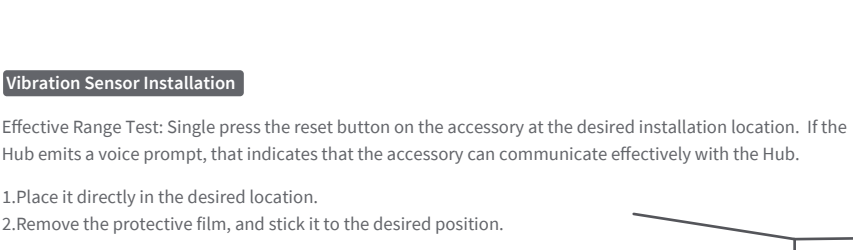

#### Installation with Holder

- Choose an appropriate installation position and make sure the installation surface is clean and flat.
- Stick the sensor to the installation pedestal, and press hard and evenly for 30 seconds to make sure its firmly installed.

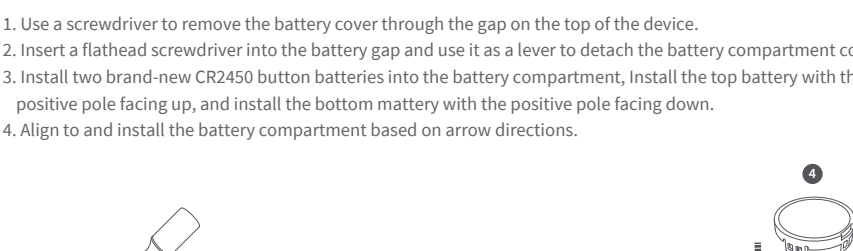

#### Door and Window Sensor Installation

Effective Range Test: Single press the reset button on the accessory at the desired installation location. If the Hub emits a voice prompt, that indicates that the accessory can communicate effectively with the Hub.

\*Avoid metal surfaces to maximize signal strength

- Remove the protective film
- During installation, try to align the marker line of the sensor unit and the magnet
- Stick onto the door or window (It is recommended to install the sensor unit on an unmovable surface, and the magnet on a movable surface. Make sure the installation gap is less than 22 mm when doors or windows are closed).

Keep the surface clean and dry.

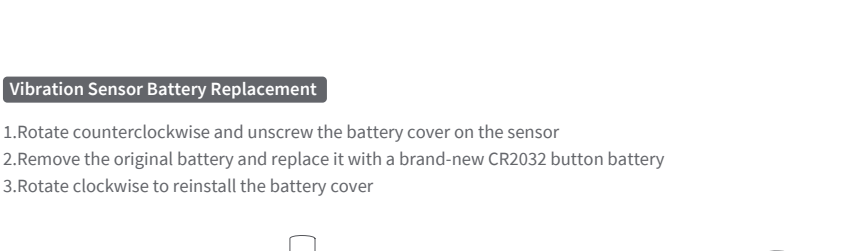

#### Vibration Sensor Installation

Effective Range Test: Single press the reset button on the accessory at the desired installation location. If the Hub emits a voice prompt, that indicates that the accessory can communicate effectively with the Hub.

- Place it directly in the desired location.
- Remove the protective film, and stick it to the desired position.

\*Keep the surface clean and dry.

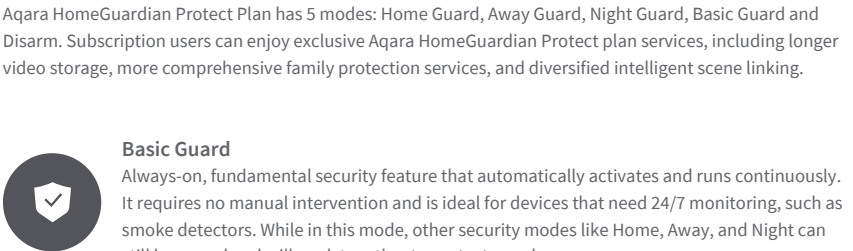

#### Motion Sensor P1 Battery Replacement

- Use a screwdriver to remove the battery cover through the gap on the top of the device.
- Insert a flathead screwdriver into the battery gap and use it as a lever to detach the battery compartment cover.
- Install two brand-new CR2450 button batteries into the battery compartment, install the top battery with the positive pole facing up, and install the bottom battery with the positive pole facing down.
- Align to and install the battery compartment based on arrow directions.

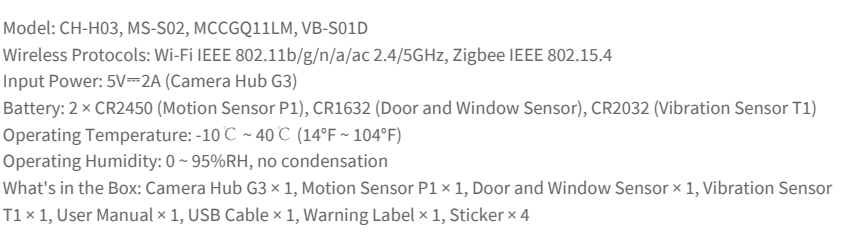

#### Door and Window Sensor Battery Replacement

- Use a pry bar to pry open the sensor's buckle
- Remove the original battery and replace it with a brand-new CR1632 battery
- Reconnect the sensor



#### Vibration Sensor Battery Replacement

- Rotate counterclockwise and unscrew the battery cover on the sensor
- Remove the original battery and replace it with a brand-new CR2032 button battery
- Rotate clockwise to reinstall the battery cover



### Using the Aqara HomeGuardian Service

#### Protect Mode

Aqara HomeGuardian Protect Plan has 5 modes: Home Guard, Away Guard, Night Guard, Basic Guard and Disarm. Subscription users can enjoy exclusive Aqara HomeGuardian Protect plan services, including longer video storage, more comprehensive family protection services, and diversified intelligent scene linking.



### Product Specifications

Model: CH-H03, MS-S02, MCCGQ11LM, VB-S01D  
Wireless Protocols: Wi-Fi IEEE 802.11b/g/n/a/ac 2.4/5GHz, Zigbee IEEE 802.15.4

Input Power: 5V=2A (Camera Hub G3)

Battery: 2 × CR2450 (Motion Sensor P1), CR1632 (Door and Window Sensor), CR2032 (Vibration Sensor T1)

Operating Temperature: -10 °C ~ 40 °C (14°F ~ 104°F)

Operating Humidity: 0 ~ 95%RH, no condensation

What's in the Box: Camera Hub G3 × 1, Motion Sensor P1 × 1, Door and Window Sensor × 1, Vibration Sensor T1 × 1, User Manual × 1, USB Cable × 1, Warning Label × 1, Sticker × 4

Online Customer Service: [www.aqara.com/support](http://www.aqara.com/support)

Manufacturer: Lumi United Technology Co., Ltd.

Address: Room 801-804, Building 1, Chongwen Park, Nanshan iPark, No. 3370, Liuxian Avenue, Fuguang Community, Taoyuan Residential District, Nanshan District, Shenzhen, China.

Email: [support@aqara.com](mailto:support@aqara.com)

Made in China