

5200 SERIES APPLICATIONS

Regular Arm Mount (Pull Side)

- Opening: Templating allows up to 180°
 Hold Open: Hold Open points 90° up to 180° with Hold Open arm
- Frame Face: 1-3/8" (35 mm)
 Ceiling Clearance: • 1-3/4" (45 mm) minimum
 • 1-5/8" (41 mm) minimum for Hold Open arm
- Top Rail: • 2-1/2" (64 mm) minimum without drop plate
 • 1-5/8" (38 mm) minimum with drop plate, 5918
- Top Rail Clearance: 3-1/2" (89 mm) minimum

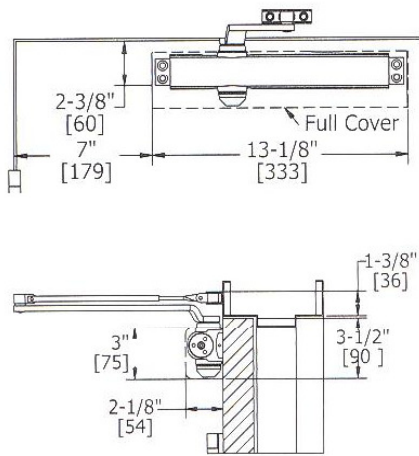

Top Jamb Mount (Pull Side)

- Opening: Templating allows up to 180°
 Hold Open: Hold Open points 90° up to 180° with Hold Open
- Frame Face: • 1-7/8" (48 mm) minimum
 • 1-1/8" (29 mm) minimum with drop plate, 5918
- Ceiling Clearance: • 2-3/4" (70 mm) minimum
 • 1-5/8" (41 mm) minimum with drop plate, 5918
- Top Rail: 2" (51 mm) minimum
 Top Rail Clearance: • 2-1/4" (57 mm) minimum
 • 2-1/2" (64 mm) minimum for hold-open
 • 3-3/8" (86 mm) minimum with drop plate, 5918
 • 3-5/8" (92 mm) minimum for Hold Open with drop plate

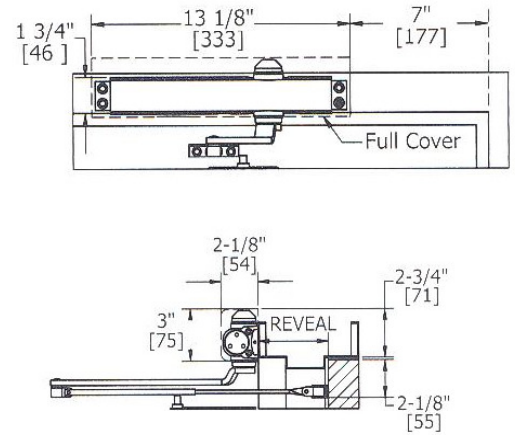

Parallel Arm Mount (Push Side)

- Opening: Templating allows up to 180°
 Hold Open: Hold Open points 90° up to 180° with Hold Open
- Top Rail: • Standard hollow metal 5/8" frame stop
 • 5-3/8" (137 mm) minimum
- Top Rail Clearance: 6-1/4" (159 mm) minimum

