

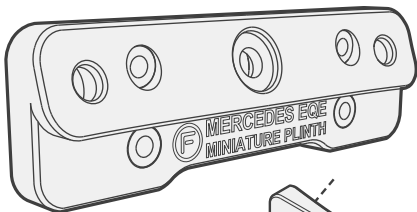

FLOW BRACKETS

MERCEDES V295 EQE

MINIATURE NUMBER PLATE PLINTH INSTRUCTIONS



INSTALLATION GUIDE

- Remove OEM Number Plate Plinth from the front of the vehicle.
- Align the centre of the Plinth to the factory screw hole. Ensure the Plinth is flush to the front bumper.
- Using supplied screws **(A)**, mount the centre screw the vehicle. Then mount the 2 remaining screws into the Plinth.
- Optional - Use screws from fitting kit **(B)** to plug grommet holes left behind from OEM Number Plate Plinth.
- Secure the number plate bracket to the Plinth and vehicle using the supplied screws **(C)**.

FITTING KIT

FLOW NUMBER PLATE BRACKET **NOT INCLUDED***

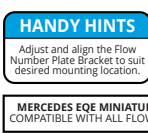
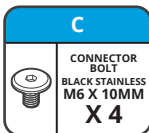
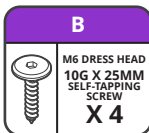
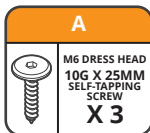

STEP 1

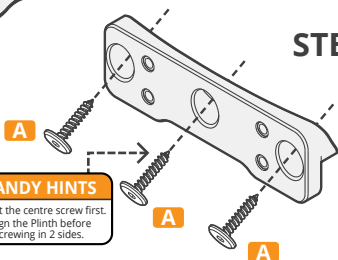

STEP 2

