

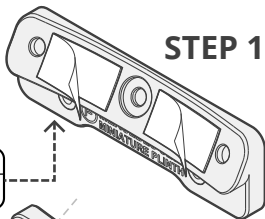

# FLOW BRACKETS

## MERCEDES R232 SL63

### MINIATURE NUMBER PLATE PLINTH INSTRUCTIONS

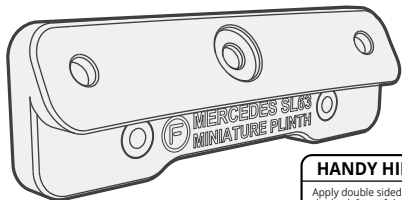

STEP 1

#### HANDY HINTS

Apply double sided tape to the back face of the Plinth.

## INSTALLATION GUIDE

- Remove OEM Number Plate Plinth from the front of the vehicle.
- Apply and peel double sided tape to the curved face of the Plinth as shown.
- Align the centre of the Plinth to the factory screw hole. Ensure the Plinth is flush to the front bumper.
- Using supplied screws **(A)** or **original screw**, mount the centre screw to the vehicle.
- **Optional** - Mount the 2 remaining screws into the Plinth.
- **Optional** - Use screws from fitting kit **(B)** to plug grommet holes left behind from OEM Number Plate Plinth.
- Secure the number plate bracket to the plinth and vehicle using the supplied screws **(C)**.

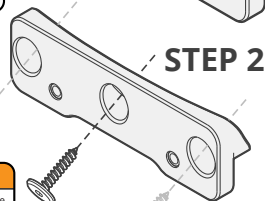

STEP 2

#### HANDY HINTS

Reuse original screw or use fitting kit **(A)**. Mount through the centre hole first.

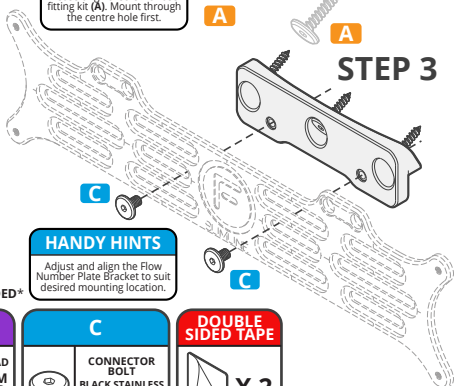

STEP 3

#### HANDY HINTS

Adjust and align the Flow Number Plate Bracket to suit desired mounting location.

## FITTING KIT

FLOW NUMBER PLATE BRACKET NOT INCLUDED\*

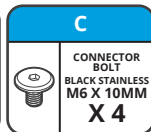
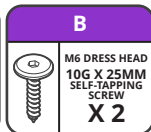
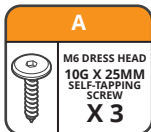

MERCEDES SL63 MINIATURE PLINTH  
COMPATIBLE WITH ALL FLOW  
BRACKETS