

AB776

CAR SEAT

⚠ Read all instructions before using this child restraint. Keep instructions for future use.

- Approved to ECE44/04 standard
- ten levels headrest adjustable
- Strong side impact protection
- Soft and comfortable cover
- Misuse prevention setting
- No re-thread harness
- Fabric breathable design for air ventilation
- Using ISOFIX
- Locking device



INSTRUCTION FOR BABY SAFETY SEAT

9kg-36kg

Group I, II, III

① Safety warnings

Please follow the instruction; otherwise your child may have serious injury during an accident. We have special marks ★ in the instruction, for you to notify the importance of it.

- ★ According the summary of car accidents, the children sit in the back seat are more safe than sit in the front seat.
- ★ When the car running, please does not move your child out from the child safety car seat, and do not leave the child in the seat unattended at any time.
- ★ Please do not use the damaged or incomplete child car seat.
- ★ Please do not use the damaged safety belt.
- ★ Please don't try to replace the components to modified child seat.
- ★ Please check the car safety belt for the tightness and safeness before using the child car seat
- ★ Ensure that the safety belt match the child's height.
- ★ Please read this manual carefully, otherwise, incorrect installation can cause serious injury. In this case, manufacturers are irresponsible .
- ★ Please fix the child car seat stably in the car when it is not being used, otherwise may cause damage for the people in the car when a bad impact or sudden brake happens.
- ★ This seat is suitable for 9 months -12 years old (9-36KG) children, in line with European ECE R44/04 Standard.
- ★ The seat is not allowed to be changed. It should be carefully installed and operated, or else it can not rule out injuries by carrying children.
- ★ The Seat belts were not allowed to be gripped, it should be taut.
- ★ The Seat must be replaced, and sent to be inspected after an accident.
- ★ Please do not install child safety seats in the front seat or the seat with the airbag.
- ★ Please do not let the child treats the child car seat as toy.

-
- ★ Please do not move off the warning label or any other label with warning words and instruction .
 - ★ Please do not put the child into a child car seat with which a high temperature.
 - ★ Please make sure that the buckle of the belt is locked well, when the car is running.
 - ★ The child restraint must not be used without the cover.
 - ★ The seat cover should not be replaced with any other than the one recommended by the manufacturer, because the cover constitutes an integral part of the restraint performance.
 - ★ Seats and seat belts should be washed by warm water and soap . The removed seat cover should be washed with mild detergent and warm water.
 - ★ Ensuring that any lap strap is worn low down, so that the pelvis is firmly engaged.
 - ★ When the chair is not provided with a textile cover, the chair should be kept away from sunlight, otherwise it may be too hot for the child's skin.
 - ★ Any luggage or other objects, which liable to cause injuries in the event of a collision shall be properly secured.
 - ★ Making any alterations or additions to the device without the approval of the competent authority, and not following closely the installation instructions provided by the childrestraint manufacturer will invite dangers.
 - ★ When the device is used in combination with an adult safety-belt to be used by means of the following wording: Only suitable for use in the listed vehicles fitted with lap/3 point/static/with retractor safety-belts, approved to ECE Regulation No.16 or other equivalent standards.
 - ★ It shall be recommended that any straps holding the restraint to the vehicle should be tight, that any straps restraining the child should be adjusted to the child's body, and that straps should not be twisted.
 - ★ the rigid items and plastic parts of a child restraint shall be so located and installed that they are not liable, during everyday use of the vehicle. to become trapped by a movable seat or in a door of the vehicle.

② Product's introduction

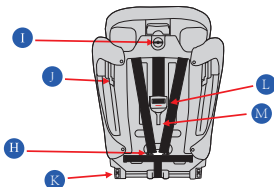
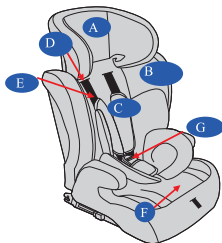

A.headrest B.backrest C.shoulder pad D.shoulder belt hole E.shoulder belt F.harness adjuster G.safety buckle

H. belt connecting part I. Adjusting knob J.lock-off K.Isofix System L. Top Tether safety brake M.Top Tether

③ The type of approved seat you must have

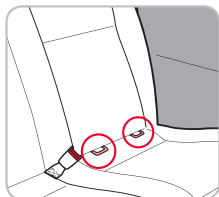
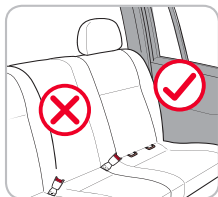

Check the vehicle handbook to identify suitable ISOFIX seating positions.

- 1、 Conventional use in cars equipped with ISOFIX connector.
- 2、 suitable for use in the list vehicles fitted with 3 point safety belts ,approved to ECE Regulation No.16 or other equivalent standards.

Warning: Under no circumstances should any child car seat be used on front passenger seat with an active airbag.



TYPE 1



TYPE 2



TYPE 3

④ Legal requirements

This child seat is approved to ECE R44.04 and only suitable for use in the listed vehicles fitted with 3 point safety belts, approved to ECE Regulation No. 16 or their equivalent standards.

⑤ Seat assembly



Pic 1

Combine the base with the backrest as pic .1

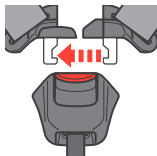

Pic 2

Assemble the inserting piece as Pic 2

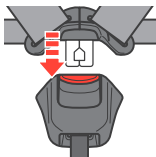

Pic 3

inserting piece the insert into the Buckle as Pic.3



Pic 4

Completed seat as Pic. 4

⑥ Use of adjusting knob

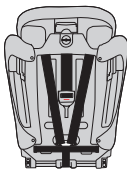

Horizontal adjustment
knob for group I

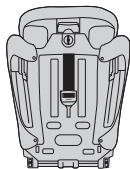

vertically adjustment
knob for group II , III

⑦ Seat fixing and removal

1、Secure with ISOFIX

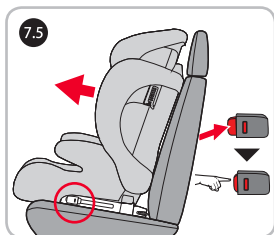
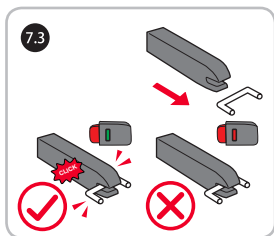
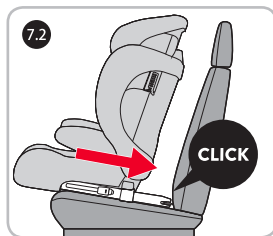
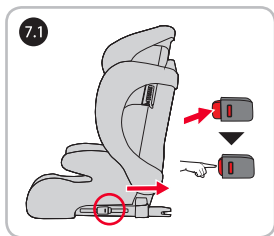

7.6



Look for this symbol
in your vehicle.



TYPE 1



TYPE 2



TYPE 3

7.7

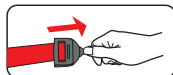
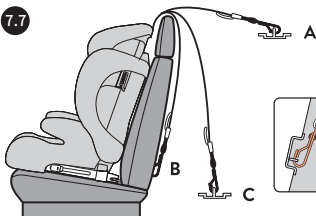

2. Secure with Car seat belt

7.8

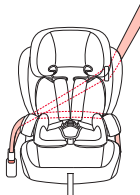

warning: It is much safer to use inner cushion when children under 12KG.

Children above 12KG are not suitable to use the inner cushion, please remove the inner cushion before using the baby car seat.

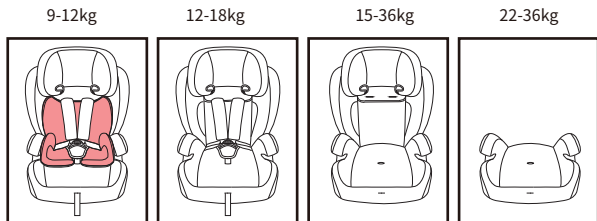

⑧ If your child's weight is between 9Kgs ~ 18Kgs , you should use an install way of group I.



Pic 5

keep knob to transverse as pic.5
ISelect ISOFIX(7.1-7.4 or 7.6-7.7) or
car seat(Refer to this page) belt fixed seat



Pic 6

Pulling out the adult safety belt as long as it
can be.as pic.6

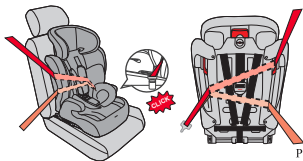

Pic 7

Pass the vehicle seat belt through the slot on the side of the safety seat until it appears at the exit. in the other side, buckle the vehicle seat belt until you hear a click. then pass the diagonal part of the seat belt through the lock off clip and lock tightly. as pic 7



Pic 8

Pressing the red button to release the buckle. Press the harness adjuster button and at the same time pull both shoulder belt. as Pic. 8 .



Pic 9

Pulling your child on the seat, buckle on both sides should be stacked with each, then locked it until "Click" as pick 9.

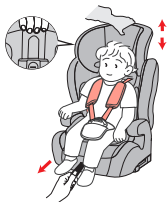

Pic 10

Pull the Adjust handles upward with one hand holding the hand. (According to the actual height of child to adjust the headrest height as pic.10)

Pull the harness adjuster strap until the harness straps are tight against the child. as Pic.10

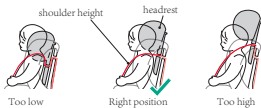

warning: Please make sure the shoulder straps position is a little higher than the child's shoulder height.

Headrest can be adjusted 11 positions, please make sure the child head is in the middle position of the headrest, top shoulder straps position need a little higher than shoulder height before using baby car seat, which can provide effective protection in case of collision.

⑨ If your child weights is in 15Kg ~ 36Kg, please remove the harness firstly and use an install way of Group II,III

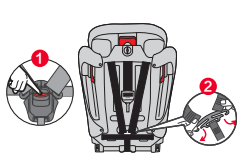

Pic 11

Pressing the red button to release the buckle, Remove belt connecting part as Pic 11

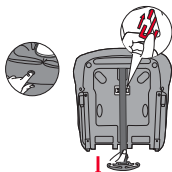

Pic 12

Press and hold the harness adjuster Remove belt connecting part and “工” iron part as Pic 12



Pic 13

Remove shoulder pads,safety buckle as pic.13

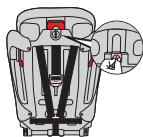

Pic 14

Adjust knob to vertical as pic.14 Install with ISOFIX(7.1-7.4)

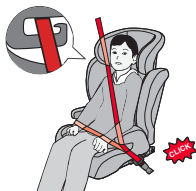

Pic 15

Pulling your child on the seat, and fixing your child by the adult safety belt, locked buckle until a “Click” as pic.15

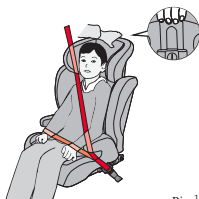

Pic 16

Pull the Adjust handles upward with one hand holding the hand. as Pic 16

⑩ **If your child weights is in 22~36kg,height over 125cm,please use and install way of Group III.**

Pushing back the backrest as pic 25, then taking out the backrest from the booster as Pic.26



Pic25

- ① Put the booster on the car seat, fix it by the adult safety seat after the child sits on the baby car seat with fix and 3-point as pic.27.feeding the shoulder guide on the adult safety belt and fasten it well
- ② Put the booster on the car seat, fix it by the adult safety seat after the child sits on the baby car seat with 3-point as pic.28.feeding the shoulder guide on the adult safety belt and fasten it well



Pic26

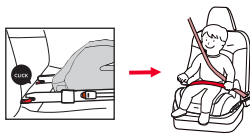

Pic .27



Pic .28

10 Removing and Cleaning

1. Press the unlock buttons on the ISOFIX system and, keeping them held down, pull backwards. The device will open, thereby releasing the child seat (fig. 7.5)
2. You will have to remove the harness and crotch strap first . to remove the harness, remove the shoulder belt from the belt connecting part , and then pull the shoulder belt through the shoulder pad and buckle . remove the should belt from the bottom of plastic.
3. removing the cover on the headrest , and removing the cover on the backrest , then removing the cover on the booster.

4. Cleaning the seat

The harness and plastic parts can be sponged with a mild detergent and warm water .

Ensure no soap gets into the buckle or adjusters .

Do not use chemical cleaners or bleach on any part of the car seat .

Dry thoroughly before use



Couverture 100% polyester

Tampa 100% polyester

Cubierta 100% poliéster

Cover 100% polyester

Abdeckung 100% polyester

11 NOTICE

This is an ISOFIX CHILD RESTRAINT SYSTEM. It is approved to Regulation No. 44, 04 series of amendments for general use in vehicles fitted with ISOFIX anchorages systems.

It will fit vehicles with positions approved as ISOFIX positions (as detailed in the vehicle handbook), depending on the category of the child seat and of the fixture.

The mass group and the ISOFIX size class for which this device is intended is Group I- II- III 9-36kg and ISOFIX size class B1.

This child seat can be used as a "universal" or "semi-universal" seat.

This Child Restraint Treat as "Semi-universal" use and is suitable for fixing into the seat positions of the following cars:

CAR	FRONT	REAR	
	Outer	Outer	Centre
(Model)	No	Yes	No

Seat positions in other cars may also be suit able to accept this child restraint.

If in doubt, consult either the child restraint manufacturer or the retailer.

See Appendix for car model.

This Child Restraint Treat as “Universal” child restraint. It is approved to Regula tion No. 44, 04 series of amendments, for general use in vehicles and it will fit most, but not all, car seats.

A correct fit is likely if the vehicle manufacturer has declared in the vehicle handbook that the vehicle is capable of accepting a “universal” child restraint for this age group.

This child restraint has been classified as “Universal” under more stringent conditions than those which applied to earlier designs which do not carry this notice.

If in doubt,consult either the child restraint manufacturer or the retailer.