



ELBA

JUICE EXTRACTOR MODEL: EJE-M0544(SS)

Owner's Manual

Please read this manual carefully before operating your set.

Retain it for future reference.

Record model number and serial number of the set.

See the label attached on the set and quote this information to your dealer when you require service.

For The Warranty Terms & Conditions, Please Refer To Warranty Certificate.

Diagram of name and position of main components

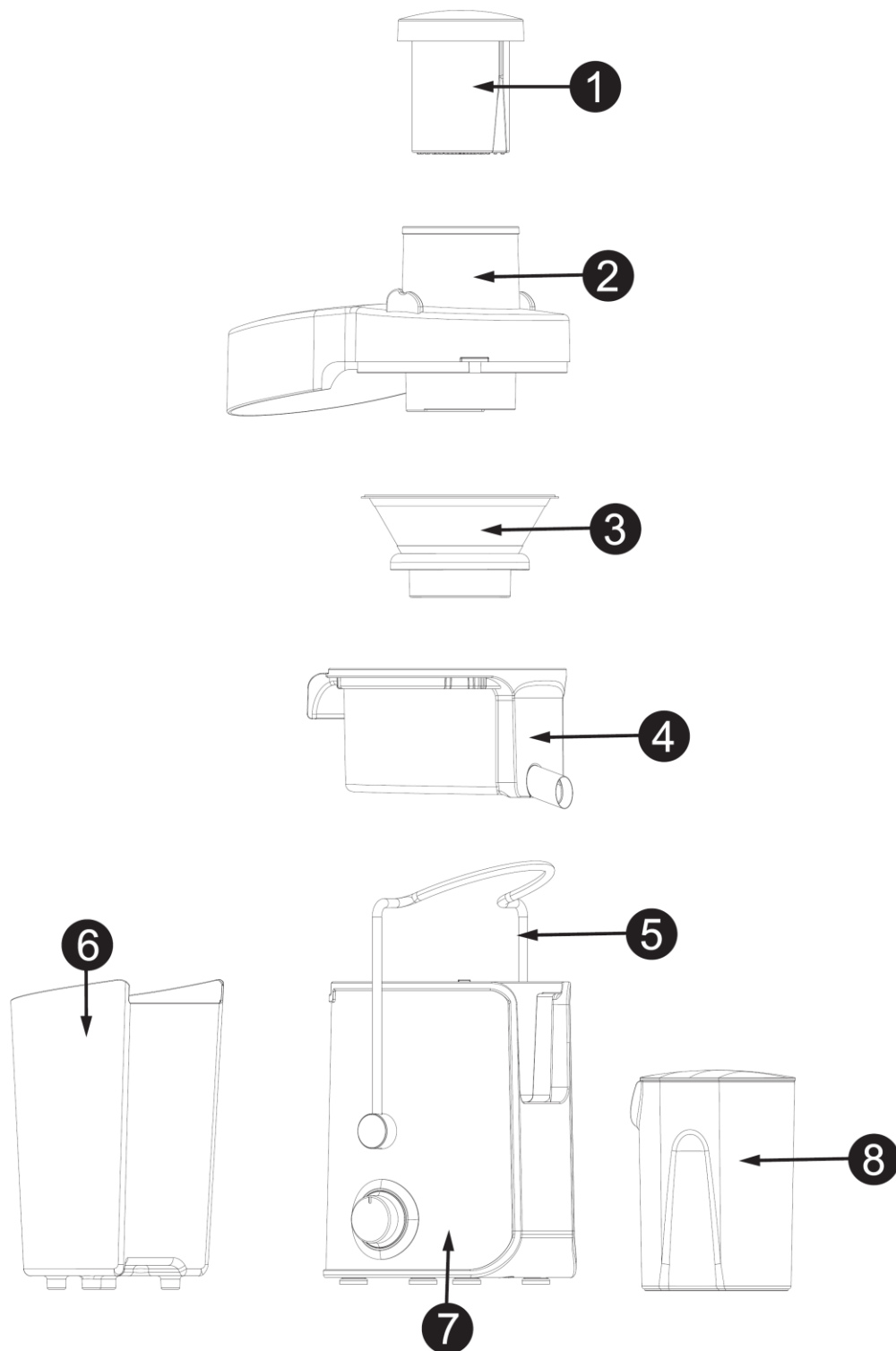

- 1. Pushing bar
- 2. Transparent cover
- 3. Juicing net
- 4. Middle ring

- 5. Handle
- 6. Residue barrel
- 7. Main machine
- 8. Juicer jug

IMPORTANT SAFEGUARDS

1. Before using, put this machine on a stable surface, operating according to below methods.
2. Before juicing, please confirm the filter has been installed in right position, then put the transparent cover on, fasten tightly the handle, then turn on the machine.
3. Before being used, the motor works in running-in phase, there may be slight peculiar smell and spark, this is normal, after the motor works for some period, the above phenomenon will disappear.
4. Do not put your fingers or other objects into the juicer opening while it is in operation. If food becomes lodged, use food pusher to push it down. When this method is not possible then turn the unit off and disassemble juicer to remove the remaining food.
5. Be sure to turn switch to OFF position after each use of your juicer. Make sure the motor stops completely before disassembling.
6. During juicing, make sure there is not too full juice and residue in the middle ring and residue barrel, if too full, please cut off power supply, clean up the unit, then use again.
7. During using, do not open the transparent cover. In case power supply is on, do not put hand or any ware into feed port, otherwise, harmful accident may occur or this machine may be damaged.
8. Do not use the appliance if the component is damaged.
9. All fitting are strictly prohibited from disinfecting in high temperature disinfection cabinet or steaming and boiling for disinfection.
10. During operating, please do not leave, never let children operate this machine.
11. After operation, do not pour the food out until pull out the plug of power supply, close supervision is necessary when any appliance is used by or near children.
12. Filter blades are very sharp, in order to avoid danger, when cleaning the filter blade, please put the filter blade under water tap for washing, do not wash it with hand.
13. This machine must not be used for others beyond regulated purposes.
14. In case of damaged power supply cord, in order to avoid danger, replacement must be performed by the manufacturer or its service department or similar professional persons in case of fault, do not disassemble the machine by yourself, please contact our maintenance department or our after service department.

IMPORTANT SAFEGUARDS

15. The use of attachments not recommended or sold by the manufacturer may cause fire electric shock or injury.
16. Unplug from outlet when not in use, before putting on or taking off parts, and before cleaning.
17. Do not let cord hang over edge of table or counter.
18. To protect against risk of electrical shock do not put in water or other liquid.
19. Do not use outdoors, only used indoor.
20. Avoid contacting moving parts.
21. Always make sure juicer cover is clamped securely in place before motor is turned on. Do not unfasten clamps while juicer is in operation.

INSTRUCTIONS FOR USE

Before using your juice extractor

Follow the assembling instructions listed below before using your juice extractor:

1. Before you start assembling your juice extractor, make sure it is unplugged and it is placed on a dry and leveled surface.
2. Place middle ring on top of the motor base.
3. Place the stainless steel filter on the middle ring, turning it until it fits into the grooves of the motor shaft.
4. Place transparent cover on top of the filter.
5. Raise the handle/safety locking arm and place it on the grooves on the sides of the transparent cover. This is a safety feature that will ensure the unit will not operate unless the transparent cover is properly locked. The safety locking arm should now be up and locked into place on top of the transparent cover.
6. Place the residue barrel into position by tilting it slightly.
7. Place the juice cup under the spout located on the right hand side of the juicer.

OPERATING INSTRUCTIONS

1. Prepare your fruits and vegetables by washing them thoroughly and peeling off those that need the skin removed.
2. Your juicer features an extra wide chute and thus most fruits and vegetables such as small apples, carrots, pears and others will not need to be cut into small pieces if they fit in the chute.
3. Make sure your juice extractor is properly assembled. Please follow the instructions from the section “Before Using Your Juice Extractor.”
4. Ensure the juice extractor and its accessories are clean by following the cleaning and maintenance section of this manual.
5. Place the juicer jug or other container/glass you may wish to use to collect the juice under the spout and make sure the residue barrel is in place prior to begin juicing. Do not allow the residue barrel to overfill as this may cause the unit to stall.
6. Plug the power cord into an electrical outlet and turn the power on “I”.
7. Once the juicer is on, place the fruits and vegetables into the feeding tube and use pushing bar to drive them down slowly. In order to extract the maximum amount of juice, it is important to push the pushing bar slowly.
8. The juice extractor will separate the juice and residue in the juicer jug and barrel automatically while you are juicing.

Note: Never use hand or fingers to push food down into the feeding tube or clean the feeding tube, always use the pushing bar provided.

OPERATION TIME

This juice extractor is designed with rotation switches of O grading, I grading, II grading (O for stop, I for weak grading, II for strong grading). For juicing hard fruits, select strong grading II, after operating for 1 min, stop for 1 min, then use again. After above operation is performed for three times, stop for 15 min, do not operate until the motor is cool down. In this way, service life of this machine would be prolonged and it will serve you more efficiently.

AFTER USING YOUR JUICE EXTRACTOR

Before cleaning and storing your juice extractor, follow the instructions below to disassemble the unit:

1. Turn juice extractor off “O” and unplug it from the electrical outlet.
2. Unlock the safety locking arm and move it down to release the transparent cover.
3. Lift the transparent cover up and remove it from the machine.
4. Lift up the juicing net and middle ring, then remove the residue barrel.

Warning: The stainless steel filter contains small sharp blades to cut and process fruits and vegetables. Do not touch blades when handling the filter.

CLEANING

1. After disassembling all removable parts of the juice extractor, wash them by hand with warm soapy water or in the dishwasher (pushing bar, transparent cover, middle ring, residue barrel, juicer cup only). If the residue dries out in the residue barrel or the filter, let it soak in water for approximately 10 minutes before washing it.
2. Wipe the main machine with a damp cloth. **Do not immerse the main machine in water or any other liquid.**
3. It is very important to keep the filter very clean, free of residues blocking the holes in order to ensure optimal performance. Use a nylon brush to clean it thoroughly, if necessary.

MAINTENANCE

Some plastic parts might stain when in contact with some fruits and vegetables for too long. In order to avoid this from happening, all parts should be washed immediately after each use.

TIPS AND SUGGESTIONS

1. Do not place any fruits or vegetables until you turn the unit on.
Allow unit to run for a few seconds before you start juicing. At the beginning of usage, the motor works in running-in phase, there may be slight peculiar smell and spark, this is normal, after the motor works for some period, the above phenomenon will disappear.
2. Do not allow the residue barrel to overflow as this may cause damage of the unit.
3. Ensure to remove large pits from fruits such as peach, mango etc as they can damage the unit.
4. Do not use bananas as they do not contain juice and will clog the unit.
5. If the machine has not been used for a long time, please store it in a dry place.

ELBA