

# ELBA

**COOKER HOOD**  
**ESH-M7598(BK)**  
**ESH-M9098(BK)**

## **Owner's Manual**

Please read this manual carefully before operating your set.

Retain it for future reference.

Record model number and serial number of the set.

See the label attached on the set and quote this information to your dealer when you require service.

**For The Warranty Terms & Conditions, Please Refer To Warranty Certificate**

Please read this instruction carefully. It is advisable to keep this instruction manual in a safe place for future reference.

## **SAFETY PRECAUTIONS**

- 1.** Keep electrical appliances out of reach from children. Do not let them to operate the appliances without supervision.
- 2.** To protect against the risk of electrical shock, do not immerse the product, cord or plug into water or any other liquid.
- 3.** This product is for household and indoor use only.
- 4.** This product is not intended for use by person (including children) with reduced physical, sensory or mental capabilities unless they have been given supervision or instruction concerning use of the appliance by a person responsible for their safety.
- 5.** If the power cord or plug is damaged, it must be replaced by the service centre or a qualified service technician to avoid hazard.
- 6.** Before installation, check if the mains supply voltage is matched with the voltage stated on the rating plate of the hood.
- 7.** There must be adequate air ventilation of the room when the cooker hood is used with the cooking appliances with burning gas or other fuels.
- 8.** Ensure that the installation of exhaust complies with the standard of local building, gas and electrical authorities.
- 9.** Do not ignite flames in the pans.
- 10.** There is a risk of fire if cleaning is not carried out in accordance with this instruction.

## ASSEMBLY INSTRUCTIONS

Please check the following before installation:

- Installation of hood must be carried out by an authorized or qualified technician.
- For optimum air extraction, avoid having too many windows surrounding the cooker hood which will cause air convection.
- Make sure the hood is in level after installation to avoid oil spill over.
- The optimum height for the installation is between 650 to 750mm which measure from the bottom of the hood to the top of the hob.

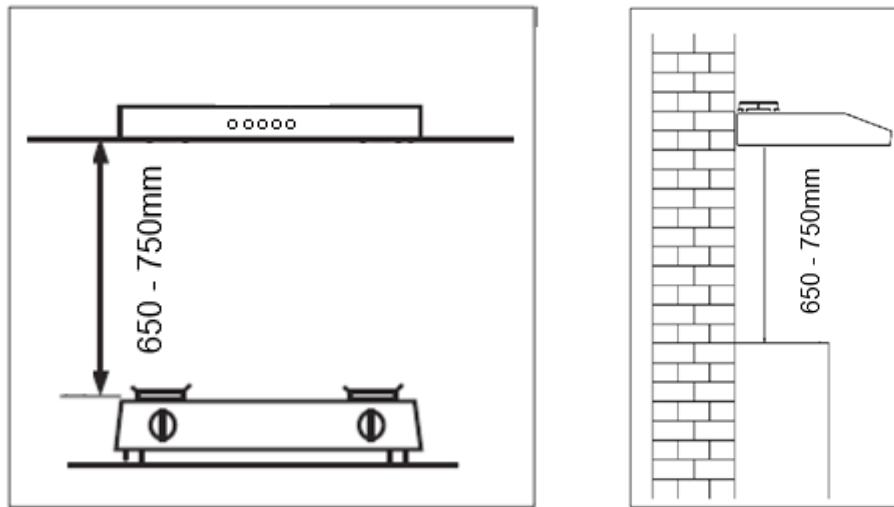

- Remove all packaging materials from the cooker hood.

Please ensure the power supply is OFF when installing the hood.

1. Loosen the screws on the metal hook but do not loosen completely. Allow the metal hook to move up and down slightly.
2. Using the metal hook provided, determine the height of the cooker hood to be installed on the wall. Mark the wall with two markers left and right then drill the hole.
3. Plug the plastic anchor into the holes tightly. Fix the installation screws by leaving 5mm gap from the wall.
4. Hang the cooker hood to the installation screws of 5mm gap and tighten the screws firmly.
5. Plug in the wall plug and switch on the power.

Note: Ensure that the plug is installed to the power point with proper earthing.

## MOUNTING UNDER THE CABINET

1. This cooker hood has two work methods which is ducted mode or recirculating mode.
2. For ducted mode, cut a minimum  $\text{Ø}120\text{mm}$  hole on the cabinet base. (To activate ducted mode, please refer to ducted mode instruction page).
3. Place the air outlet socket on the top of the hood. Rotate to lock the air outlet socket.

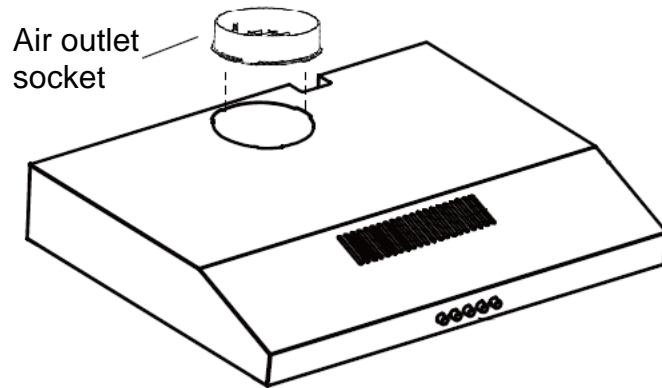

4. Remove the grease filter.

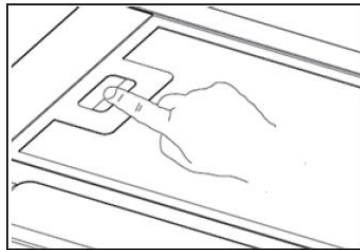

5. Lift the hood into cabinet as below and secure 4 screws under the cabinet with the guideline below.

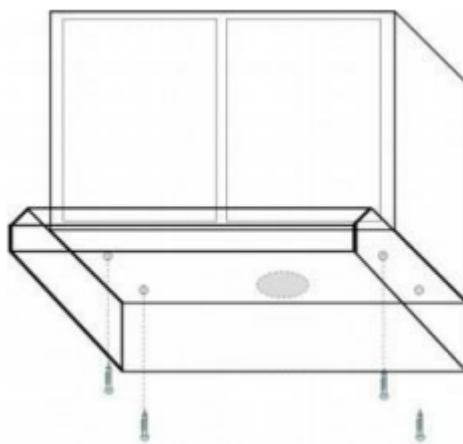

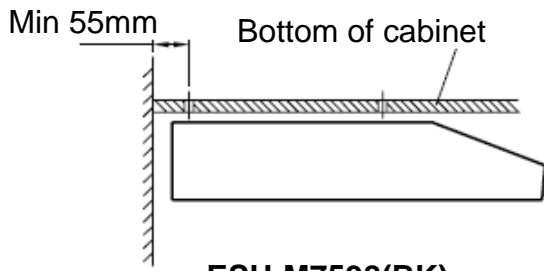

**ESH-M7598(BK)**

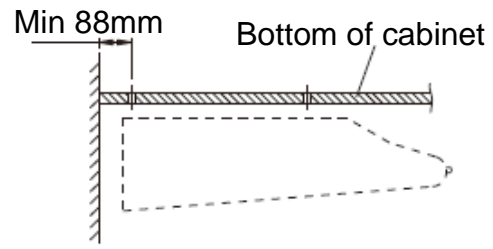

**ESH-M9098(BK)**

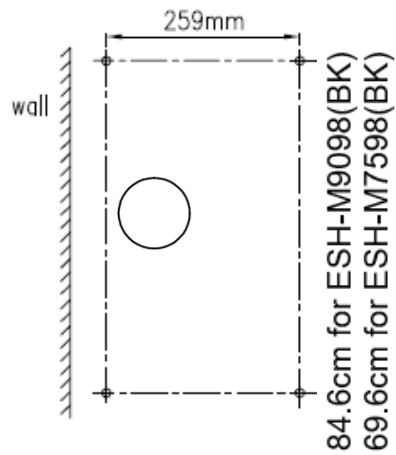

6. Connect the duct pipe with 120mm and fix it with a pipe-tightening ring on air outlet socket.

**NOTE: Charcoal filter is an optional filter to install in this ducted mode to purified air.**

## MOUNTING ON WALL

1. This cooker hood has two work methods which is ducted mode or recirculating mode.
2. For recirculating mode, place the stopper on the top of the hood. Rotate to lock the stopper (To activate recirculating mode, please refer to recirculating mode instruction page).

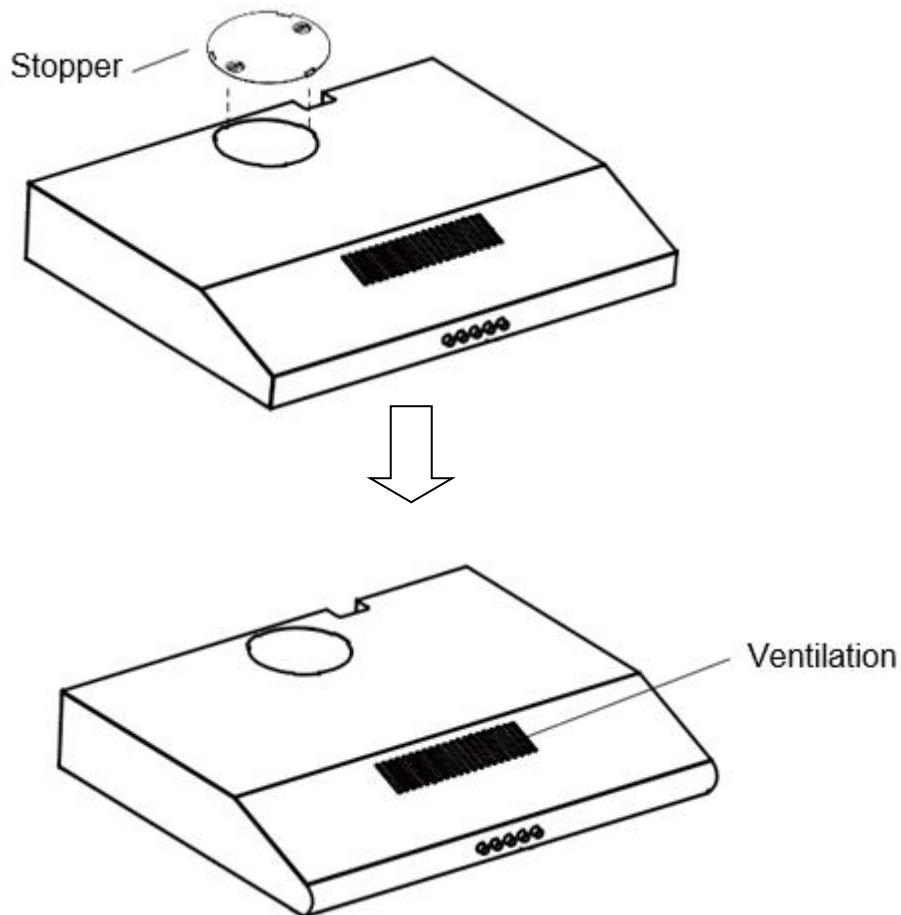

**NOTE: Stopper serve as a purpose to turn cooker for front ventilation.**

3. Remove the grease filter.

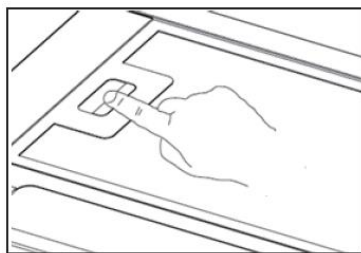

4. Lift the hood and secure 4 screws behind the wall.

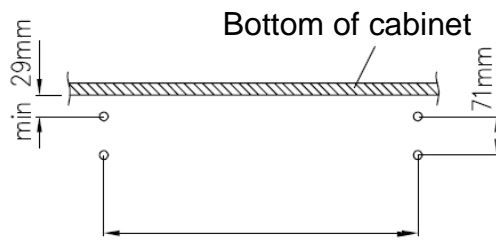
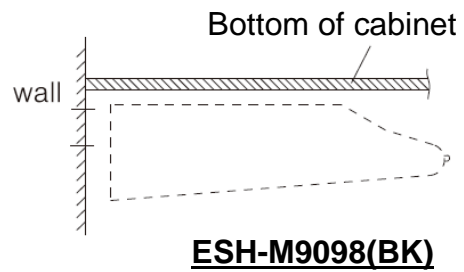
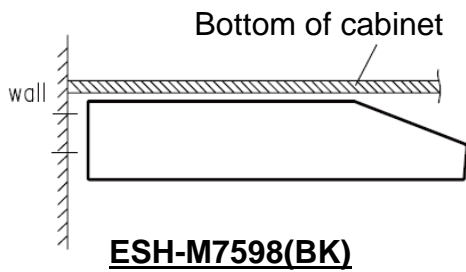
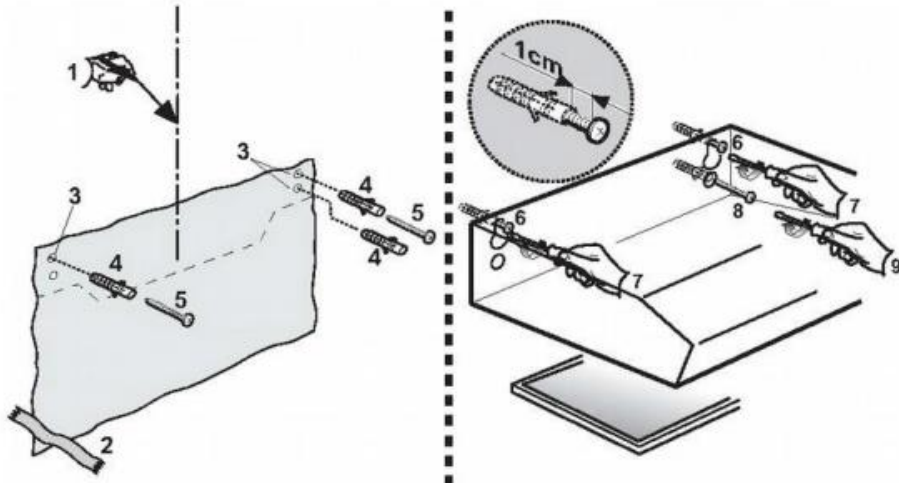

84.6cm for ESH-M9098(BK)  
69.6cm for ESH-M7598(BK)

**NOTE: In this recirculating mode, you must install charcoal filter to purified air.**

# PRODUCT DESCRIPTION

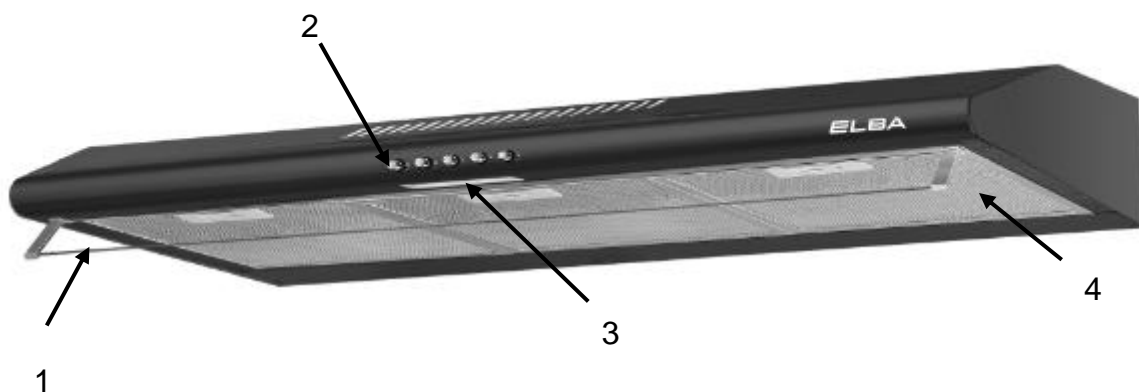
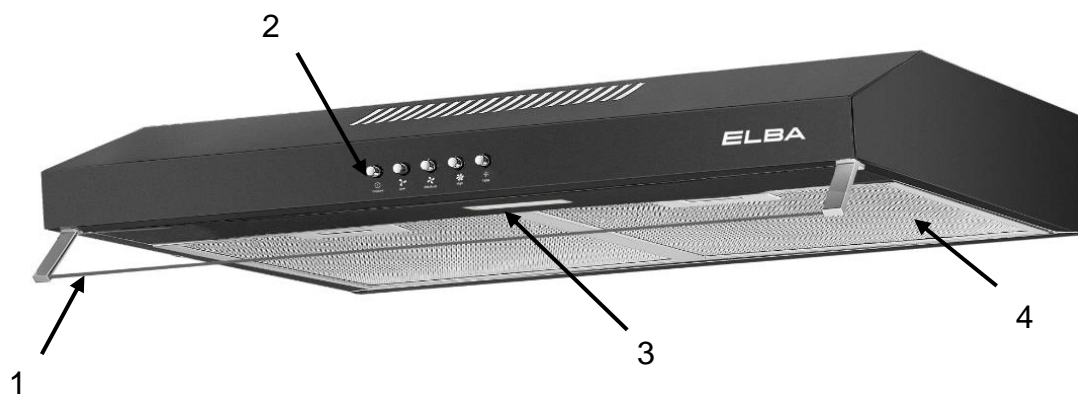

- 1. Glass Visor
- 2. Control Switch
- 3. LED Light
- 4. Grease Filter

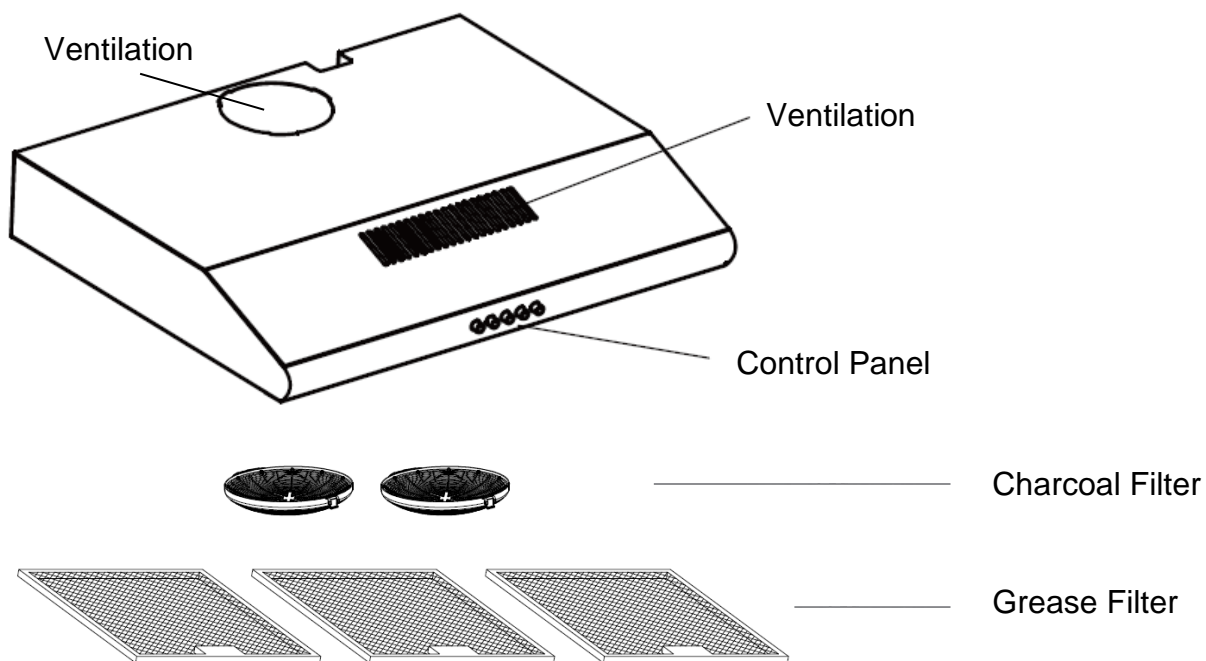



## DUCTED MODE

1. Remove the grease filter.

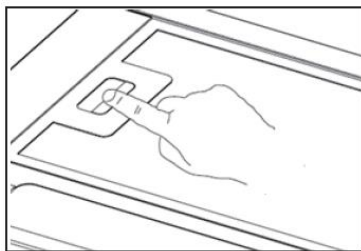

2. Turn  to activate the ducting mode.

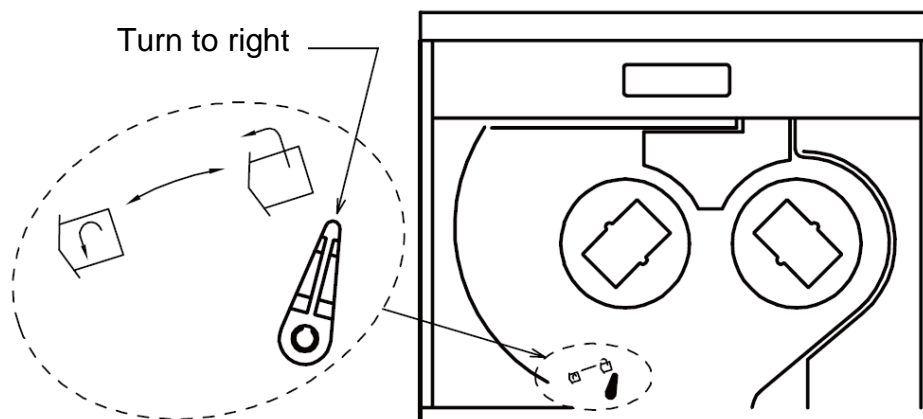

3. Place the air outlet connector on the top of the hood. Rotate to lock the air outlet connector.

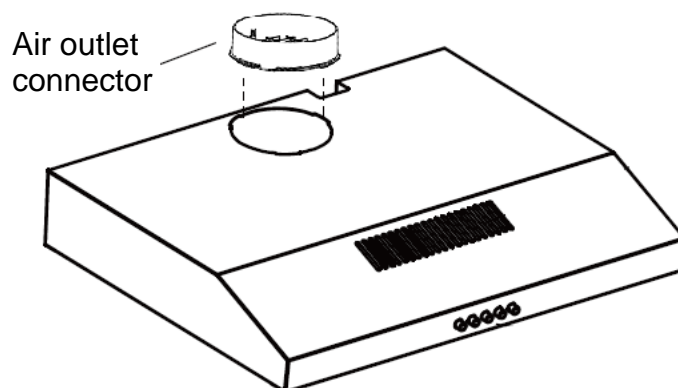

4. Use  $\varnothing 120\text{mm}$  duct pipe (not provided) and fix it with a pipe-tightening ring (not provided) on air outlet connector.

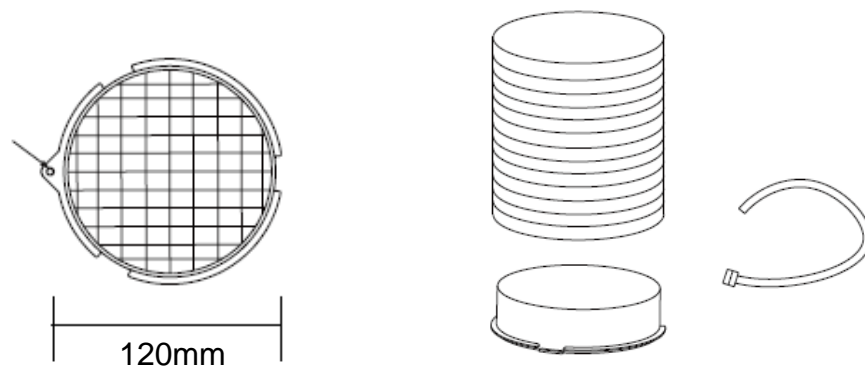

**NOTE: The accessory - duct pipe and pipe-tightening ring are not provided in box.**

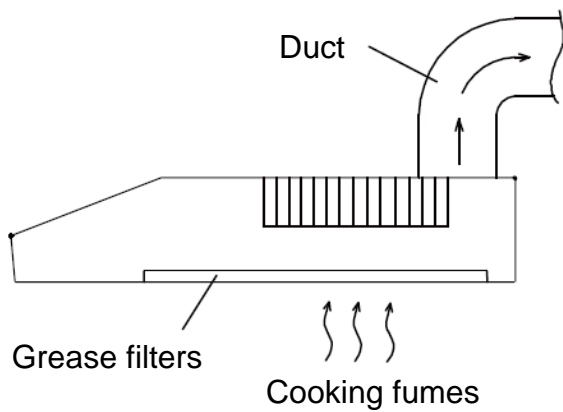

**ESH-M7598(BK)**

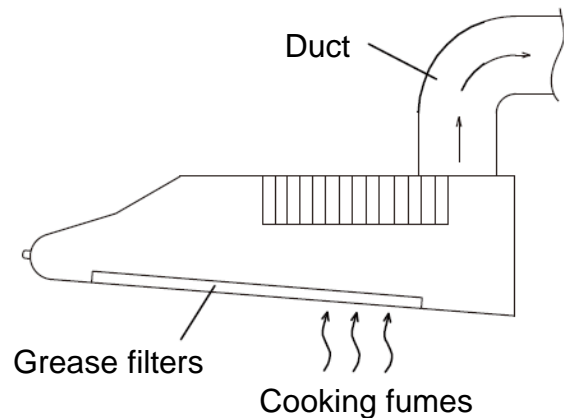

**ESH-M9098(BK)**

## RECIRCULATING MODE

1. Remove the grease filter.

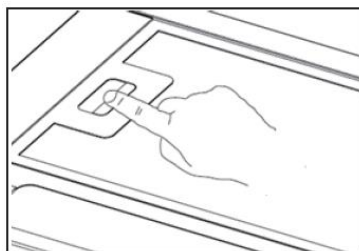

2. Turn  to activate the recirculating mode.

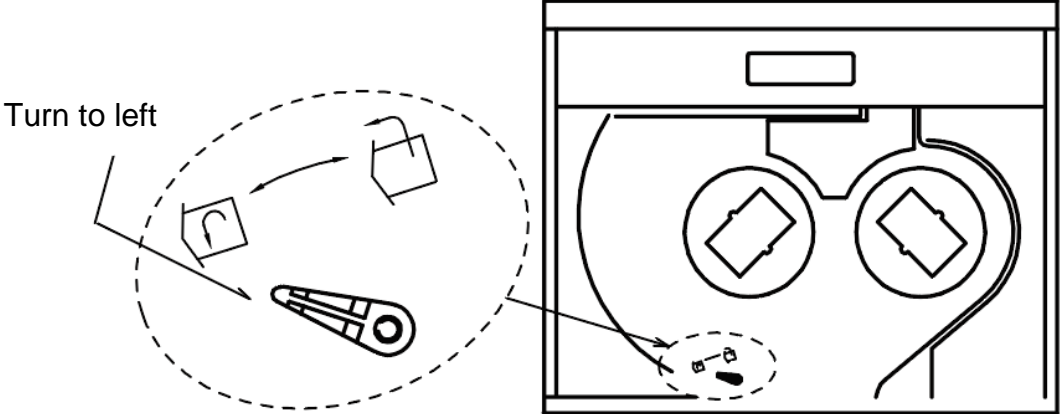

3. Place the stopper on the top of the hood. Rotate to lock the stopper.

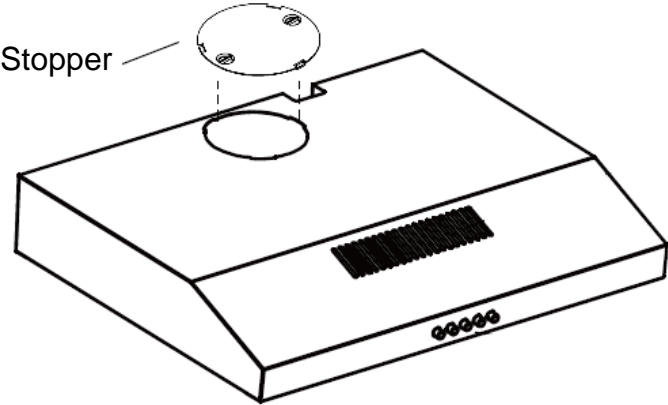

4. Install the charcoal filter and lock the position by turning clockwise direction to tighten.

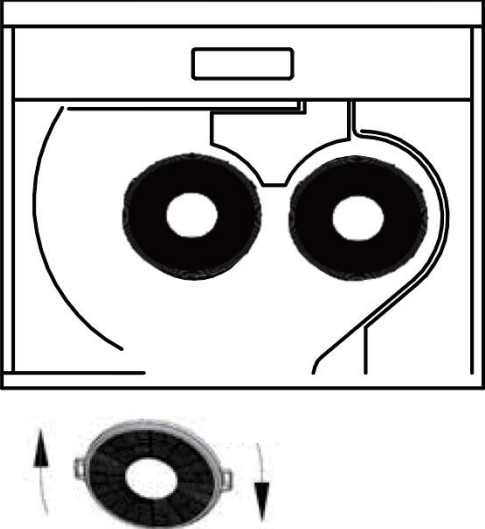

**NOTE: In this recirculating mode, you must install charcoal filter to purify air.**

5. In recirculating mode, the extractor hood extracts the cooking fumes which are purified in the grease filter and charcoal filter.
6. The purified air is then recirculated into the kitchen via a vent opening in front of the hood.

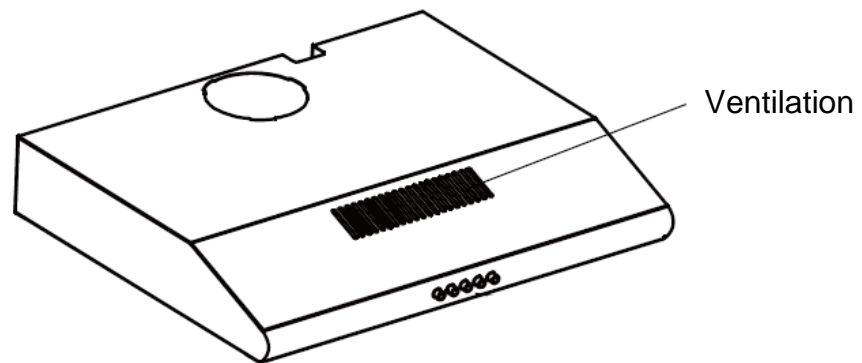

7. The grease filter absorbs the oil and grease in the cooking fumes. The charcoal filter is designed to purify cooking odor.

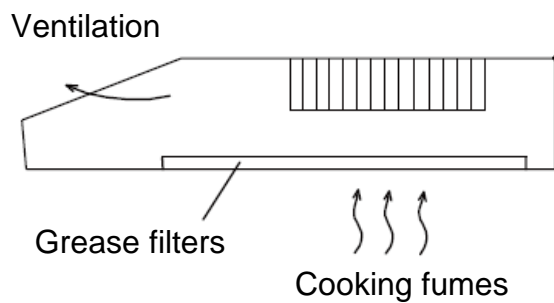

**ESH-M7598(BK)**

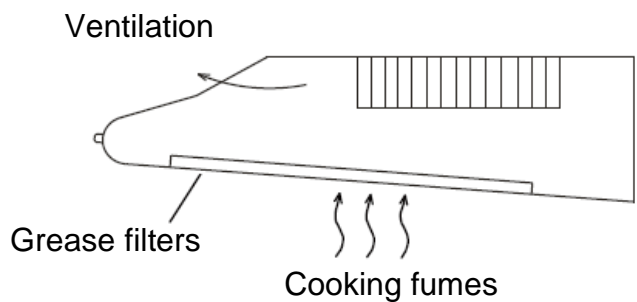

**ESH-M9098(BK)**

8. In this mode, both grease filters and charcoal filter are installed.

**NOTE: In this recirculating mode, the air is purified before being recirculated into kitchen, through the use of the charcoal filters which absorb odors. These charcoal filters need to replace regularly at intervals.**

## INSTALL THE CHARCOAL FILTER

- Disconnect the power supply and then remove the grease filter.

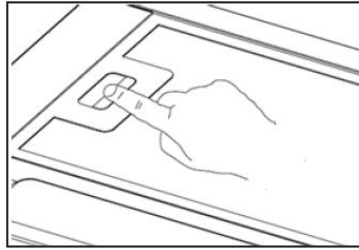



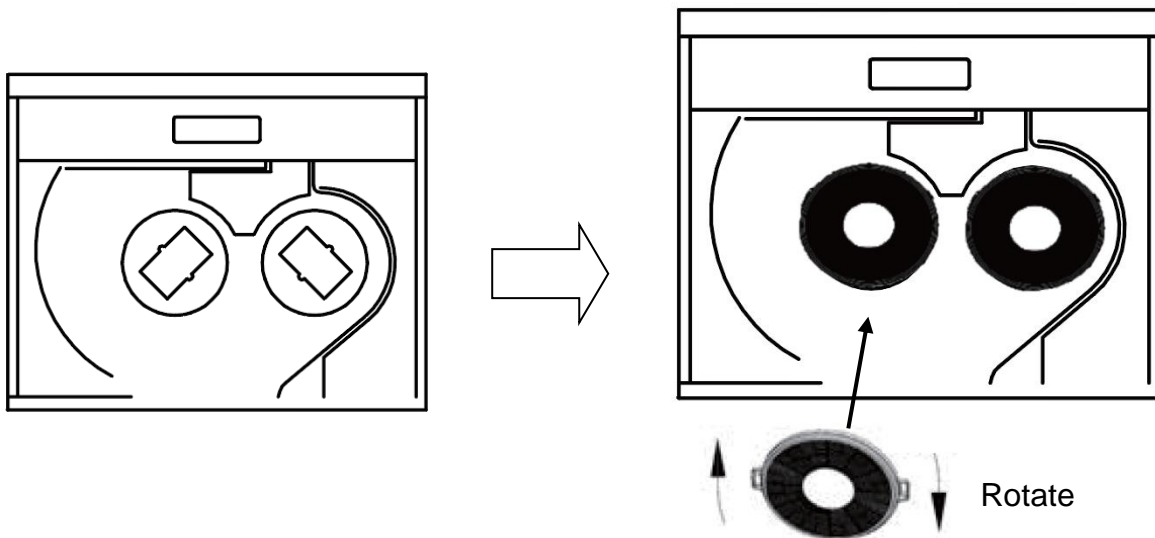

- Install the charcoal filter and lock the position by turning clockwise direction to tighten.



- To remove the charcoal filter, turn anti-clockwise direction to loosen.
- There are two charcoal filters provided and install on the left and right position.

## OPERATING INSTRUCTIONS

1. Press the  ON/OFF button to turn the unit on and off.
2. Press the  Low Button to active cooker hood in low fan speed. Press the  Medium Button to active cooker hood in medium fan speed. Press the  High Button to active cooker hood in high fan speed.
3. Press the  Light button to illuminate the lamp on/off.  
(Remarks: The Light function is independent from the ON/OFF button)

## CLEANING AND MAINTENANCE

- The hood must always be disconnected from the electricity supply before carrying out the maintenance.
- Clean the hood with damp cloth, hot water and mild detergent. Do not use chemical, steel, wooden or abrasive cleaners to clean the hood.
- Clean the grease filter with household cleaning detergent to ensure the filters are free from dirt (clean the filter once every month).
- Avoid spilling water into motor and electronic component.

## TROUBLESHOOTING

The motor & light is not working;

1. Check control panel and button, if the control panel or button is damaged please replace it.
2. Check power outlet or plug, ensure power outlet and plug is properly installed.

The motor is not working but the light is on;

1. It might be the capacitor error causing the motor unable to work properly.
2. Check control panel and button, if the control panel or button is damaged please replace it.
3. If motor faulty, please contact authorized service centre for inspection and service.

The motor is working but the light is off;

1. Check control panel and button, if the control panel or button is damaged please replace it.
2. If the control panel and button are functioning, please replace with a new LED with proper rating.

**Warning: Please ensure power is turned off before replacing new LED.**

Abnormal tremendous vibration;

1. Ensure fan is properly installed.
2. Please tighten the fan with the loose-fitting axle or the bolts.

Poor exhaust power;

1. Ensure the hood is installed at a recommended height.
2. Motor or capacitor may cause poor exhaust power, kindly request for a service.
3. Please clean hood regularly to maintain best exhaust power.
4. Ensure nothing is preventing the flue to exhaust.

## MAIN SPECIFICATION

Model : ESH-M7598(BK)  
Rated Voltage : 220-240V~  
Frequency : 50/60Hz  
LED Light : 1.5W x 1  
Suction Power : 900m<sup>3</sup>/hr  
Motor Power : 80W x 2  
Product Dimension : 750mm (W) x 100mm (H) x 480mm (D)

Model : ESH-M9098(BK)  
Rated Voltage : 220-240V~  
Frequency : 50/60Hz  
LED Light : 1.5W x 1  
Suction Power : 900m<sup>3</sup>/hr  
Motor Power : 80W x 2  
Product Dimension : 900mm (W) x 100mm (H) x 480mm (D)

## PRODUCT SIZE

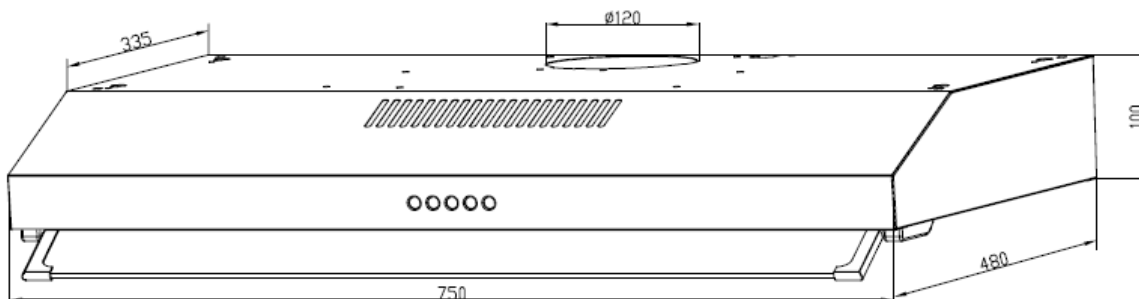

**ESH-M7598(BK)**

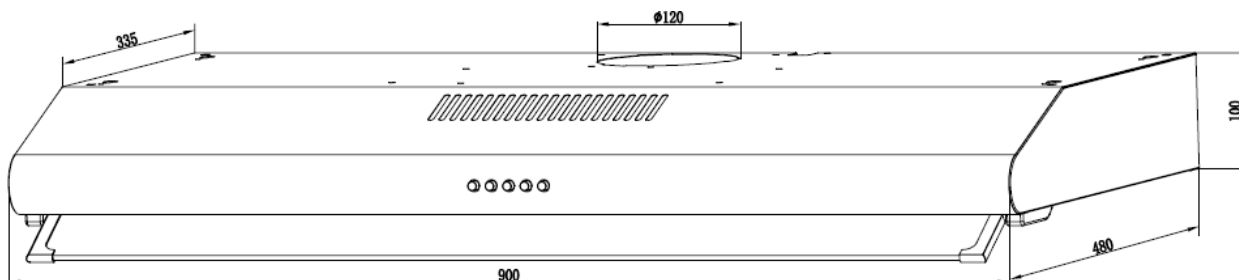

**ESH-M9098(BK)**

**ELBA**