



ELBA

WALL FAN
MODEL: EWMF-E1646RC(BK)

Owner's Manual

Please read this manual carefully before operating your set.

Retain it for future reference.

Record model number and serial number of the set.

See the label attached on the set and quote this information to your dealer when you require service.

For The Warranty Terms & Conditions, Please Refer To Warranty Certificate

REMOVE ALL PACKING MATERIALS FROM THIS PRODUCT BEFORE USING IT. THIS APPLIANCE MUST BE INSTALLED ON A FLAT SURFACE. PLEASE ENSURE THE ELECTRIC SUPPLY TO THIS APPLIANCE IS DISCONNECTED BEFORE INSTALLING.

Please read this instruction carefully. It is advisable to keep this instruction manual in a safe place for future reference.

SAFETY PRECAUTIONS

1. Keep electrical appliances out of reach from children. Do not let them to operate the appliances without supervision.
2. To protect against the risk of electrical shock, do not immerse the product, cord or plug into water or any other liquid.
3. This product is for household and indoor use only.
4. This product is not intended for use by person (including children) with reduced physical, sensory or mental capabilities unless they have been given supervision or instruction concerning use of the appliance by a person responsible for their safety.
5. If the power cord or plug is damaged, it must be replaced by the service centre or a qualified service technician to avoid hazard.

WARNING - to reduce the risk of fire, electrical shock or injury to persons or property, please read and follow below instructions carefully:

- Always operate the product from a power source of the same voltage, frequency and rating as indicated on the product identification marking.
- Do not operate this product if it has malfunctioned, damaged cord or plug or appears damaged in any way. Return the complete product to the place of purchase for inspection, repair or replacement.
- This product should not be used in the immediate vicinity of water, such as bathtub, washbowls, swimming pool etc. where the likelihood of immersion or splashing could occur.
- Always switch off and unplug the plug from outlet when not in use, before assembling or disassembling parts and before cleaning. Fully assemble the fan before operating.
- Avoid contacting with moving parts. Do not insert any object through the guard when the fan is operating.
- Do not cover the guard or operate in close proximity to curtains, etc.
- Always disconnect the fan when moving it from one location to another.

PRODUCT DESCRIPTIONS

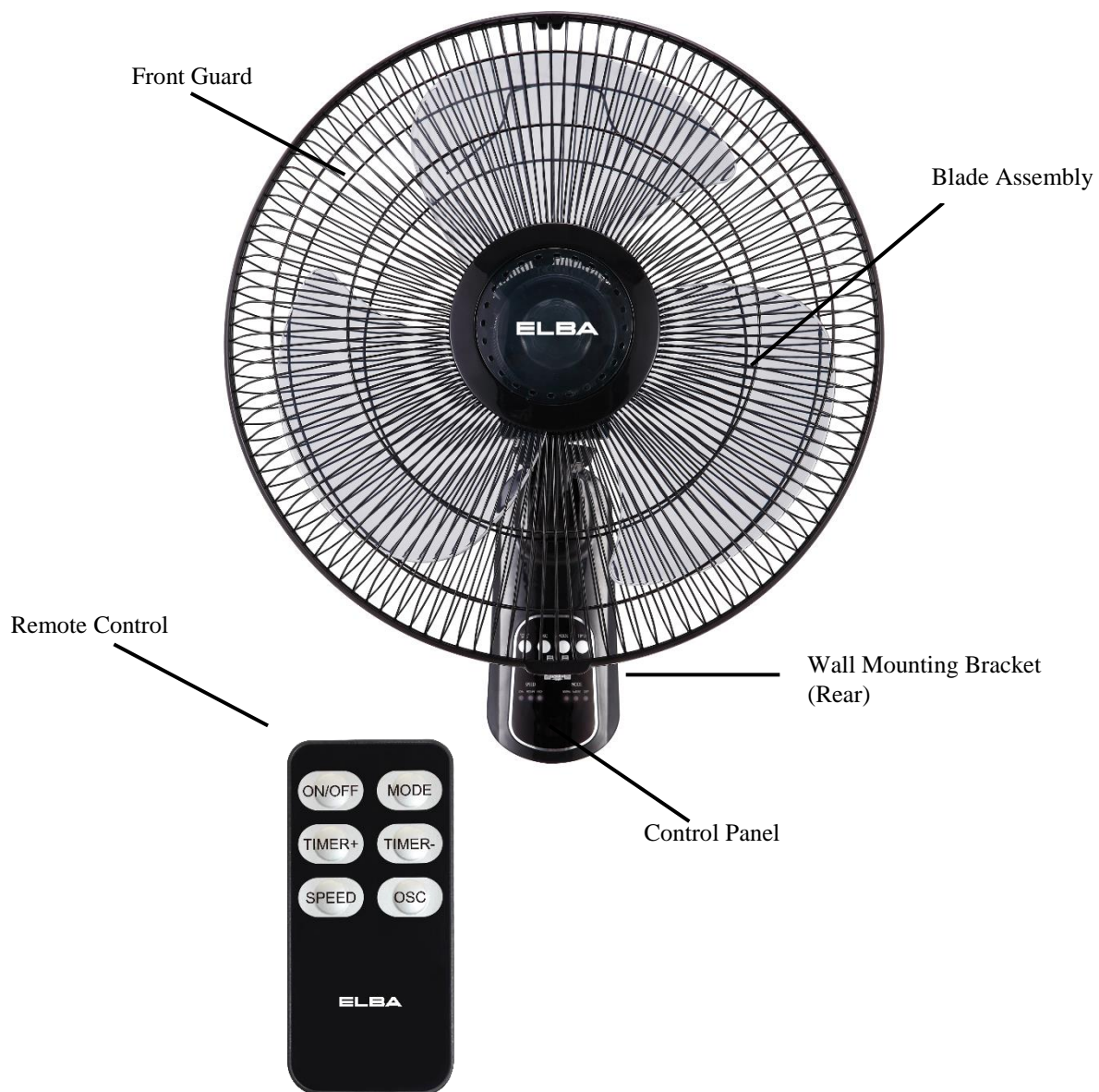

ASSEMBLY INSTRUCTIONS

1. Remove all packaging material and wire fastener from the product.
2. Drill 3 holes on the wall with a distance complied with the hole on the wall bracket (2).
3. Press the screw anchors provided into holes.
4. Mount the hanging bracket (2) on the wall with three screws (1) provided (Fig 1).



(Fig 1)

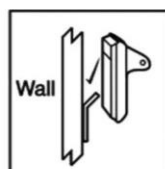

(Fig 2)

5. Hang the rear motor (3) with the holes (11) fixed onto the hanging bracket (2) (Fig 2).
6. Remove the protecting tube (12) from the motor shaft.
7. Loosen the rear guard locking nut (5) from the motor & housing assembly (A).
8. Position the rear guard (4) firmly to the motor & housing assembly (A) and fasten by turning the rear guard locking nut (5) clockwise tightly.
9. Push the fan blade (6) along the motor shaft. Fasten securely using the fan blade locking nut (7) by turning anticlockwise.
10. Press the front guard (8) to attach with rear guard (4) until both guards are properly fitted (Fig 5). Secure both guards firmly by tightening the guard ring clip (9) (Fig 6).

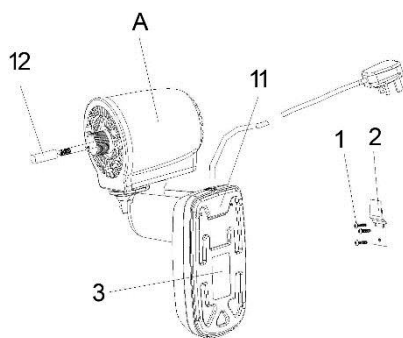

(Fig 3)

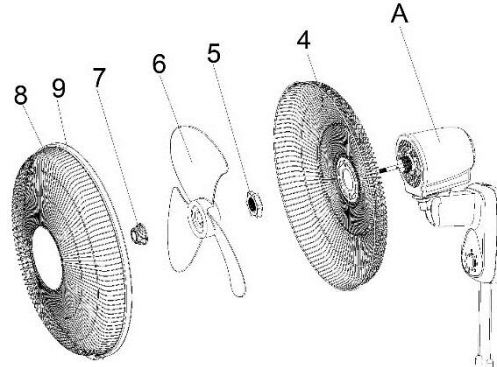

(Fig 4)

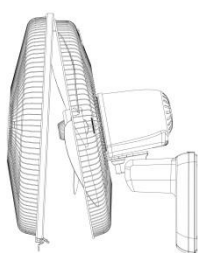

(Fig 5)

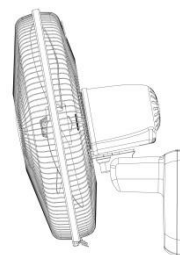

(Fig 6)

OPERATING INSTRUCTIONS

1. ON/OFF

Press this key to switch the fan on or off.

2. TIMER+ & TIMER-

When this key is pressed repeatedly or kept in pressed status, the time to be set for air delivery increased step by step of each 0.5 hour and sums to 7.5 hours in 15 steps. Don't press the TIMER key when the fan is required to run continuously. At the moment all lamps won't be on.

3. SPEED KEY

This key is for switching on the fan. The fan will be started at medium speed to speed up the rotation. After 2 seconds it will automatically change to the low step. After the fan has started, this key serves as a speed selector in the sequence from LOW - MEDIUM - HIGH - LOW - MEDIUM when this key pressed repeatedly or continuously.

4. MODE KEY

(Only for the control plate): This key is a selector key for wind type. The wind type changes in the sequence from NORMAL---NATURAL---SLEEP---NORMAL---NATURAL wind when this key being pressed repeatedly.

The features of 3 wind types are as follows:

NORMAL WIND:

The fan delivers air constantly with high, medium or low speed set by the SPEED key.

NATURAL WIND:

The fan delivers air according to the program preset in advance and simulating the natural wind. The wind varies from strong to weak or vice-versa, making people feel fresh and comfortable as breezing in natural air.

SLEEP WIND:

The wind weakens step by step as the preset time elapses. And then the fan switches automatically off.

Depending on the wind speed set by the SPEED key, the sleep wind has also strong, medium and weak steps and these steps vary as follow:

STRONG WIND:

The fan delivers at first the strong natural wind, then the medium natural wind each for 30 min. and at last the weak natural wind for the rest preset time.

MEDIUM WIND:

The fan delivers the medium natural wind for 30 min at first and then the weak natural wind for rest preset time.

WEAK WIND:

The fan delivers the natural breeze.

5. OSC KEY

This key serves to start or stop the fan oscillation. To choose one direction, press this key until the fan turns in the desired direction and then press again.

Important note: Do not try to change the fan head direction forcibly by hand; otherwise the fan will be damaged.

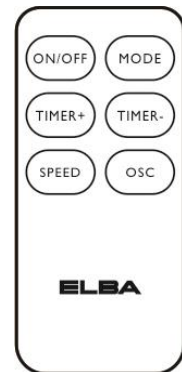

NOTES:

The fan can start only with the ON/OFF key.

The pilot lamps of the speed are in relation to the setting of the wind speed, not to the type. The three lamps for wind speed don't turn on and off frequently with the change of wind speed, when the fan operates in the state of natural wind or sleep wind.

CLEANING AND MAINTENANCE

Clean the appliance with a damp cloth with mild cleaner. Do not use chemical, steel, wooden or abrasive cleaners to clean the appliance.

WARNING: DO NOT IMMERSE THE APPLIANCE INTO WATER. ENSURE THAT THE FAN IS UNPLUGGED FROM THE POWER SUPPLY BEFORE REMOVING THE GUARD.

MAIN SPECIFICATION

Voltage : 220-240V/50Hz

Rated Power: 60W

Fan Size : 16-inch

Motor : 3-Speed

NOTICE

This product must not be disposed together with domestic waste. It has to be disposed at an authorized place for recycling of electrical and electronic appliances. By collecting and recycling waste, you help to save natural resources and make sure the product is disposed in an environmental friendly and healthy way.



ELBA