



# ELBA

## **GARMENT STEAM IRON MODEL: EGSI-M1563(PK) Owner's Manual**

Please read this manual carefully before operating your set.

Retain it for future reference.

Record model number and serial number of the set.

See the label attached on the set and quote this information to your dealer when you require service.

**For The Warranty Terms & Conditions, Please Refer To Warranty Certificate.**

# IMPORTANT SAFEGUARDS

When using the appliance, basic precautions should always be followed including the following:

1. Read all instructions before using.
2. To reduce the risk of electric shock, do not disassemble or attempt to repair the appliance on your own. Return the appliance to the nearest authorized service centre for examination, repair or adjustment.
1. Do not use the appliance if the plug, the mains cord or other parts are damaged.
2. To avoid the hazard caused by the overload of the circuit, do not use the extension cord.
3. Do not immerse the appliance, power cord or plug in water or any other liquids.
4. Do not leave the appliance unattended while operating or it is still hot.
5. Do not contact directly the steam head to people, animals or cloth that one is wearing.
6. Please fill in water before power on the appliances. Observe the water level in the water tank while operating.
7. Never use any accessories or parts from other manufacturers or that ELBA does not specifically recommended.
8. The use of foreign accessory attachments that are not supplied by ELBA is not recommended as it may result in fire, electric shock or personal injury.
9. Do not lay the hose on the ground or wind it.
10. Only use the steam head in an up and down vertical position. Never use the steam head in a horizontal position or tilt into a backward position, this may result in water discharge.
11. Be cautious of hot steam that sprays out from the steam head. To reduce the risk of contact with hot steam emitting from the steam head, hold the handle away from your body while operating the appliance.
12. Move the appliance by grasping the telescopic pole. Do not force the casters if they are struck. Drain the water from water tank and water reservoir before inspecting the casters.
13. Allow the appliance to cool completely for at least 30 minutes and drain the water from the water tank and water reservoir before storing.
14. Allow the appliance to cool completely for at least 30 minutes and drain the water from the water tank and water reservoir before storing.
15. Unplug the appliance before cleaning, moving or when the appliance is not in use.
16. Keep the appliance away from inflammable materials and chemicals.
17. Do not operate the appliance in the event of abnormality, or damage to the cord or the plug.
18. Grasp the plug to unplug it, do not unplug by pulling the power cord.
19. Do not fill the water tank with hot water, corrosive cleaning agent, perfume, vinegar, starch, ironing aids or any other chemicals, or otherwise, the appliance will be damaged. De-mineralized water or distilled water is strongly recommended.
20. Use this appliance for its intended use only.
21. This product has been designed for domestic use only. Any commercial use, inappropriate use or failure to comply with the instructions, the manufacturer accepts no responsibility and the warranty will not apply.
22. This appliance is intended for household use only. This is a floor appliance and never carries it while in use.
23. Children must be supervised to ensure that they do not play with the appliance.
24. This appliance is not intended for used by persons (including children) with reduced physical, sensory or mental capabilities, or lack of experience and knowledge, unless they have been given supervision or instruction concerning use of the appliances by a person responsible for their safety.
25. Children should be supervised to ensure that they do not play with the appliance.
26. Save these instructions for future reference

# PRODUCT DESCRIPTIONS

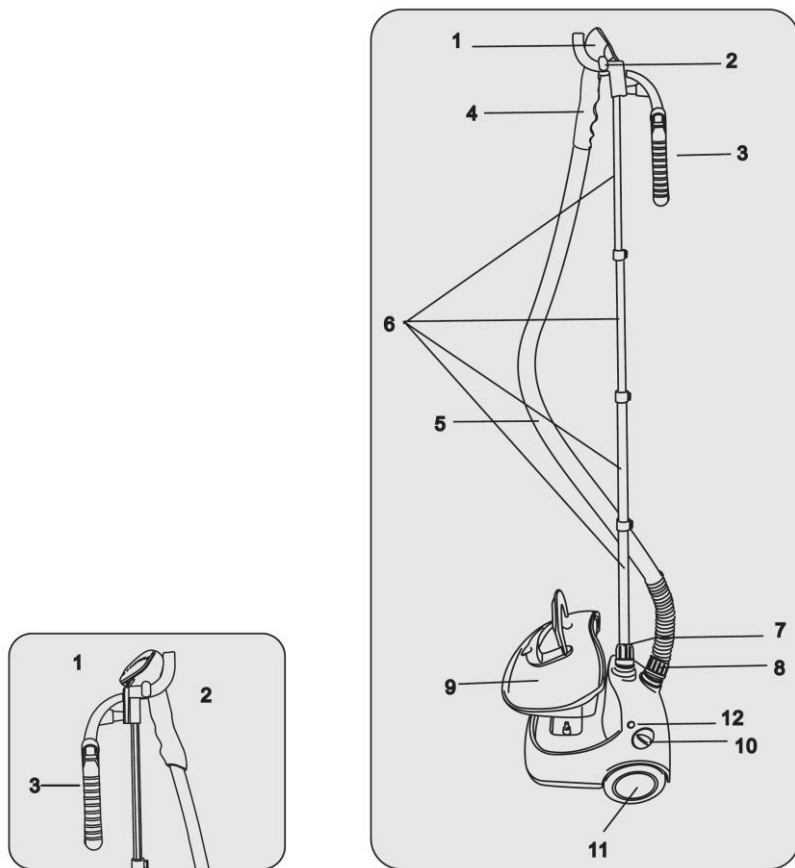

1.	Steam Nozzle	7.	Pole Connector
2.	Steam Nozzle Hanger	8.	Hose Connector
3.	Folding Hanger	9.	Water Tank
4.	Handle	10.	Switch
5.	Hose	11.	Rear Wheel
6.	Telescopic Pole	12.	Indicator Light

## ASSEMBLE AND OPERATING THE APPLIANCE

Before installing, please check carefully the product to avoid missing any parts, for some of them place at the sides of polystyrene foam.

1. Put the hanger within in the telescopic pole along the flute. (See Fig.1)
2. Insert the telescopic pole into the pole connector. (See Fig.2)
3. Screw the connector of pole clockwise until its tightened. (See Fig.3)
4. Loose the clips on the telescopic pole.
5. Stretch the pole to its full extension, and then tighten the clip of telescopic pole.
6. Install the hose into the hose connector according to the direction of arrow and turn in clockwise until it is tightened. Please don't make it too tight. (See Fig.3)
7. Hang the steam nozzle on the steam nozzle hanger. (See Fig.4)

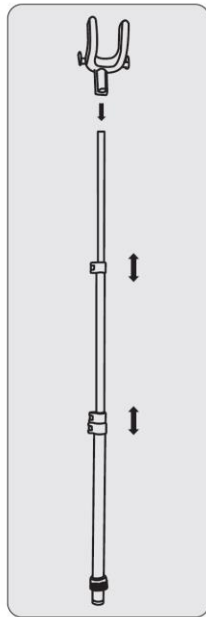

Fig.1

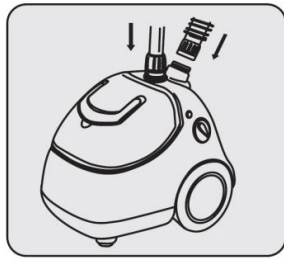

Fig.2

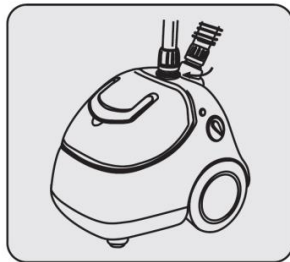

Fig.3

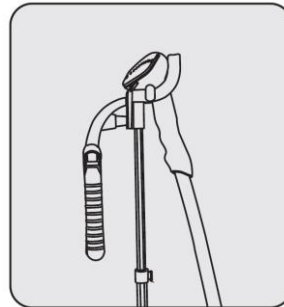

Fig.4

**Cautions:**

1. Always hang the steam nozzle on the steam head hanger when not in use to prevent scalding.
2. The telescopic pole must be fully extended during steam operation to ensure smooth lining of the hose and provide a free flow of steam.
3. Don't pull the hose with excessive force or else damage will occur and cause steam leakage. Do not move the appliance by pulling the hose. Move the appliance by grasping the telescopic pole.

**FABRIC BRUSH ASSEMBLY**

The garment steamer iron come with fabric brush. To attach this accessory to the steam head.

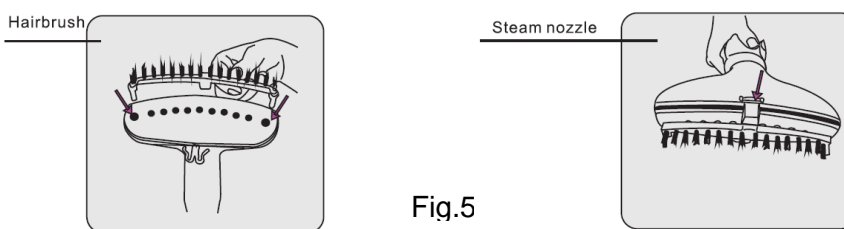

Fig.5

1. Turn off the appliance and wait until no steam is emitted from the steam head.
2. Assemble the flute of fabric brush toward the peg that at the top of the steam nozzle.
3. Press the brush to the steam nozzle until it is tightened.

**Caution:** Do not install the accessory while steam is emitting from the steam nozzle to avoid burns.

## OPERATING THE APPLIANCE

- Before operation, please ensure the garment steamer is turned off.
- Remove the water tank, twist off the water tank valve from the bottom. (See Fig.6)
- Then fill up water tank with cold water and then tighten the water tank valve cap. Do not use hot water.
- To prolong the service life of your garment steam iron, we recommend to use distilled or de-mineralized water. Place the water tank back into the unit and make sure it sits properly and securely in the cavity. (See Fig.7)

**Note:** Do not let the appliance operate with a dry water tank, as it may cause damage to the unit.

- Connect the plug to the wall outlet and power on.
- Turn the appliance to “ON” switch. When indicator is on, the garment steam iron start working. After 45 seconds, the steam will be sprayed from the nozzle.
- When you have finished with your steaming sessions, turn the switch in the “OFF” position and power off the appliance. Remove the plug from the outlet.

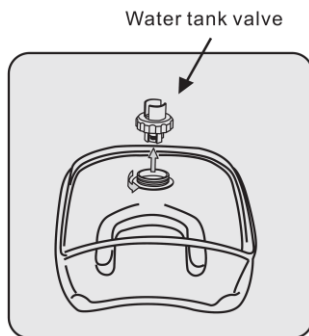

Fig.6

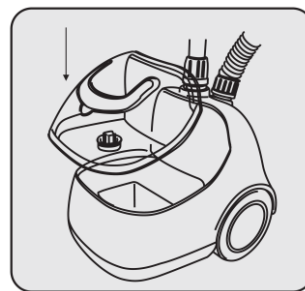

Fig.7

## INSTRUCTIONS FOR USING FOLDING HANGER

- Firstly, insert the hanger (A) in the pole (B) (as Fig.a)
- Insert the hook (D) of the folding hanger (C) into the hole of hanger (A) about tilting 40° (as Fig.b)
- Press and fasten the hook (D) vertically (as Fig.c)
- Gently pull the hanging arm (E) of the folding hanger with hands toward both sides, until two supporting poles (F) are on the same straight-line (as Fig.e)
- Push hard the positioning sleeve (G) to the supporting pole (F), to make the small hole of the positioning sleeve align at the bump of the supporting pole. (as Fig.f)

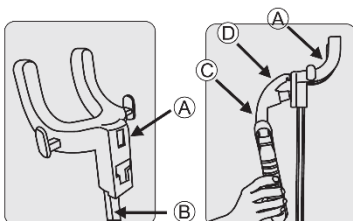

Figure a

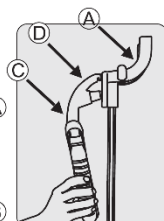

Figure b

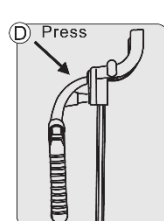

Figure c

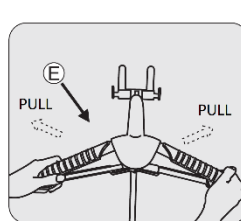

Figure d

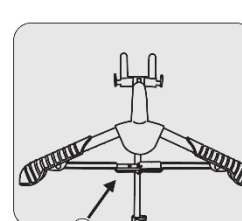

Figure e

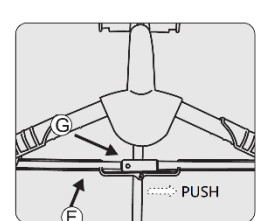

Figure f

## HOW TO OPERATING STEAM FUNCTION

- The high temperature steam is for softening the cloth fiber only. The correct way of steaming cloth is to make the cloth straight with the pulling force. Therefore, grasp the bottom of cloth with hands and pull it downwards. (See Fig.8)
- Then put the steam nozzle against the cloth firmly, gently press downwards, and then drag the nozzle up and down. Softening the fiber by the high temperature steam, and then fixing the shape with the pulling force. (See Fig.9)
- When ironing the bottom of the cloth, please grasp both sides of the cloth for tightening, and then steam from left to right, up and down. Please aware of the hot steam from nozzle. (See Fig.10)

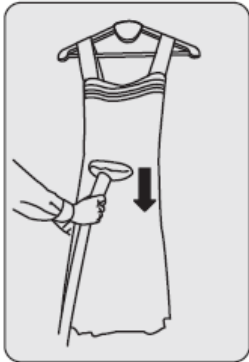

Fig.8

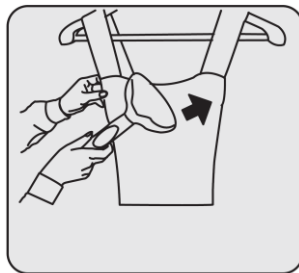

Fig.9

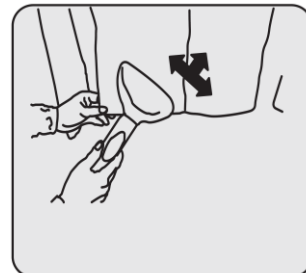

Fig.10

- When ironing the collar, please press downward a little bit harder. The nozzle should be pressed on the folding of the collar for a little longer and steam pressed back and forth and up and down. (See Fig.11)

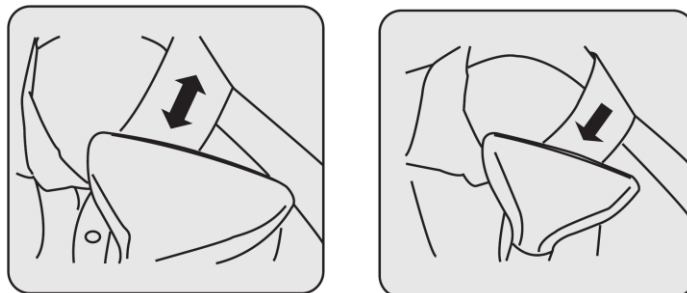

Fig.11

- When ironing the cloth sleeve, please straighten the sleeve a little hard. The steam nozzle should be longer pressed on the sleeve folding of the sleeve for a little longer and steam pressed back and forth. (See Fig.12)

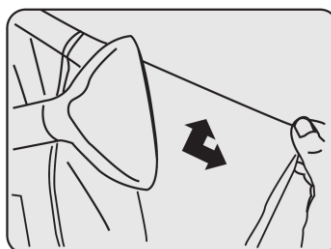

Fig.12

## HOW TO USE THE DRAINAGE VALVE

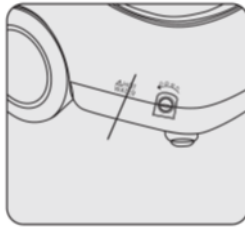

Fig.13

- Unscrew the drainage valve which is at the back of the appliance anti-clock wise. (See Fig.13)
- Empty the water reservoir after finished steaming. When the appliance is not in use or before storage. This is to avoid water deterioration and bacteria breeding. Fasten the drainage valve after all the water is drained off before storage.

**Note:** Do not touch the water reservoir's inlet hole right after steaming. Allow the appliance to cool completely for at least 30minutes before draining to avoid scalding to hands.

## CLEANING AND MAINTENANCE

We recommend you follow this procedure at least once per week.

1. Switch off your garment steam iron.
2. Unplug the unit from the wall outlet.
3. Allow the steam nozzle to cool down for at least 30 minutes.
4. Disconnect the hose from the hose base and shorten the telescopic pole, then set them aside.
5. Remove and drain the water from water tank. Rinse the water tank with fresh water, and drain completely. Place the water tank back on the water reservoir.
6. Wrap the hose around the telescopic pole one time. Place the steam head on the steam head holder.

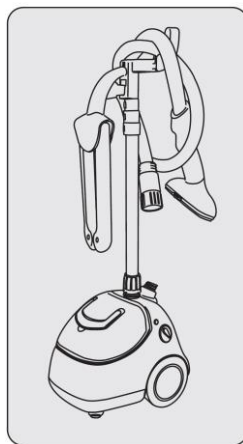

Fig.13

## REMOVING MINERAL BUILD-UP

It is common for minerals found in hard water to build up inside the appliance, causing intermittent or weak steam. If you do not use de-mineralized or distilled water in your steamer, follow these steps monthly:

1. Turn the unit off, and unplug the power cord.
2. Remove the hose and telescopic pole from the unit.
3. Drain the water reservoir by unfasten the drainage valve. Empty water from the water tank.
4. Mix a solution of 50% vinegar and 50% water. In general, appropriate up to 900ml mixing liquid is sufficient.
5. Slowly pour the water-vinegar solution into the hose connector.
6. The water-vinegar solution will become visible in the water reservoir's inlet hole, continue to pour the solution into the hose connector until it is full, monitor from the hose inlet.
7. Allow the water-vinegar solution in the hose connector for 40 minutes.
8. After that, drain the solution out of the water reservoir by removing the drainage valve to allow the liquids to drain into a sink.
9. Drain the remaining solution out from the hose connector by tilting the unit over a sink.
10. Pour clean water into the hose connector and water reservoir inlet and drain again. Repeat this step until the vinegar odor dissipates
11. Reassemble the unit and operate normally.

## TROUBLESHOOTING

Problem	Reason	Solution
The garment steam iron fails to spray the steam, and the indicator light does not illuminate.	The appliance is not plugged in	Insert the plug into power outlet
	The house power fuse is tripping off or blew out	Check the power or ask for qualified electrician help
The garment steamer fails to spray the steam and the indicator light is illuminates	There is sediment accumulation in the water tank.	Refer to the instruction manual for the cleaning method of sediment.
	There is no water in the water tank.	Refill the water into water tank.
The steam hose makes a noise.	The steam is condensed inside the steam hose, to become the small drop, so that it stops the steam to spray normally.	It is normal that there is a little sound when spraying the steam. If is too noisy, please make the steam hose become vertical, so that the water will flow back to the water tank.
The steam is successively spraying	Mineral build-up in the unit.	It's normal for the unit to periodically stop steaming for a few seconds. If the steam stays off for longer periods, follow the removing mineral build-up procedure.



**ELBA**