

ELBA

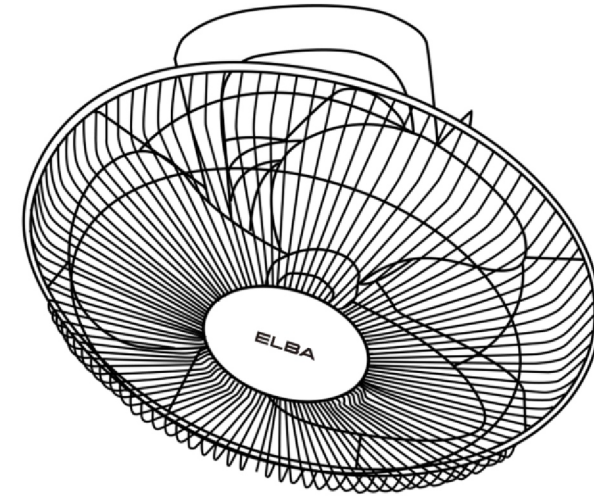

ELBA

AUTO FAN

MODEL: EATF-G1655(WH)

Owner's Manual

Please read this manual carefully before operating your set.

Retain it for future reference.

Record model number and serial number of the set.

See the label attached on the set and quote this information to your dealer when you require service.

For The Warranty Terms & Conditions, Please Refer To Warranty Certificate.

IMPORTANT SAFEGUARDS

REMOVE ALL PACKING MATERIALS FROM THIS PRODUCT BEFORE USING IT. THIS APPLIANCE MUST BE INSTALLED ON A FLAT SURFACE. PLEASE ENSURE THE ELECTRICITY SUPPLY TO THE APPLIANCE IS DISCONNECTED BEFORE INSTALLING.

Please read this instruction carefully. It is advisable to keep this instruction manual in a safe place for future reference.

1. Keep this appliance out of reach of children. Close supervision is necessary when the appliance is operating near children or infirm persons.
2. This appliance is not intended for use by persons (including children) with reduced physical, sensory or mental capabilities, or lack of experience and knowledge, unless they have been given supervision or instruction concerning the usage of this appliance by a person responsible for their safety.
3. Do not operate the appliance with damaged power cord or plug, after the appliance malfunctions, or if it was dropped or damaged in any manner. Kindly return the appliance to the nearest authorized dealer or after-sales service center for examinations, repairs, electrical or mechanical adjustments.

WARNING – to reduce the risk of fire, electrical shock or injury to persons or property, please read and follow below instructions carefully.

- Always operate the product from a power source of the same voltage, frequency and rating as indicated on the product identification marking.
- Always switch off and unplug the plug from outlet when not in use, before assembling or disassembling parts and before cleaning. Assemble the product completely before operating.
- To protect against the risk of electrical shock, do not immerse the product, cord or plug into water or any other liquid.
- This product should not be used in the immediate vicinity of water, such as bathtub, washbowls, swimming pool etc, where the likelihood of immersion or splashing could occur.
- This product should not be used in the immediate vicinity of open flame or other heating appliances where the likelihood of burning or high heat could occur.
- Avoid contact with moving parts. Do not insert any object through the guard when the product is operating.
- Do not install the auto fan at places where there is high vibration and impact. The possibility of auto fan dropping is high and will cause injury.
- Do not operate it for purposes other than its intended use.
- Always disconnect the product when relocating it.
- The auto fan must be mounted at least 2.5m above the ground to reduce risk of injury.

PRODUCT DESCRIPTION

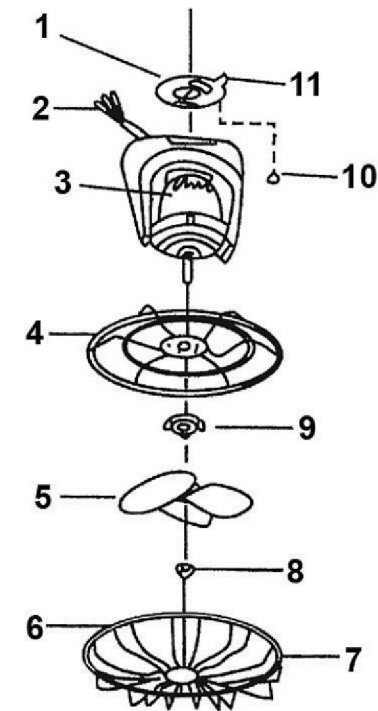

1. Mounting Bracket	7. Front Fan Guard
2. Wiring	8. Spinner
3. Motor Assembly	9. Guard Nut
4. Rear Fan Guard	10. Safety Screw
5. Fan Blade	11. Extended Metal Tab
6. Fan Guard Lock	

INSTALLATION GUIDE

ASSEMBLY OF FAN

1. Open the packaging and remove the packaging material.
2. Ensure that the surface is level and firm before operating the appliance.
3. Loosen the safety screw from the extended metal tab and turn the mounting bracket clockwise to detach.
4. With the bulge portion facing up, install the mounting bracket into the ceiling.
5. Fix the motor assembly by turning clockwise onto the mounting bracket slot.
6. Fix the safety screw back to the extended metal tab on the mounting bracket and ensure the motor assembly is firmly locked in place.
7. Mount the rear fan guard onto the motor assembly by aligning the rear guard holes with the round pins on the motor.
8. Place the guard nut into the shaft guard and turn clockwise to firmly lock it in place.
9. Fix the fan blade onto the shaft and tighten the spinner to lock it in place.
10. Place the front fan guard properly onto the rear fan guard and lock them in place using the guard locks.

INSTALLATION OF REGULATOR

1. Remove the fan regulator cover by loosening the screw on the top of the cover.
2. Mount the regulator base on to the wall with screws.
3. Connect the wiring from the motor assembly to the regulator through the hole of the base.
4. Connect the wiring from the regulator to the power source accordingly.
5. Fix the regulator cover back to its base and tighten the screw firmly.

Note:

- Green/Yellow wire – Earth (E), Blue wire – Neutral (N), Brown wire – Live (L)
- Always ensure the unit is turned off (Speed Control at “0” (OFF) position) first before installation

OPERATING INSTRUCTIONS

To Adjust Speed

Select the desired speed by turning the knob of the fan regulator:
“0” for OFF; “1” for Low Speed; “2” for Medium Speed; “3” for High Speed.

To Adjust Circulating Angle

The fan’s oscillation angle can be adjusted to your requirements by positioning the adjustable rod to the positions shown below. The rod is situated between the base and motor assembly.

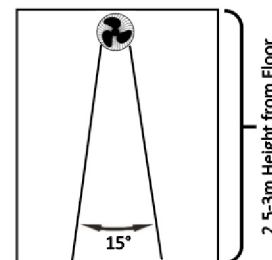
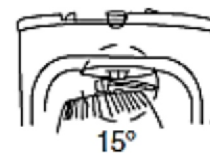
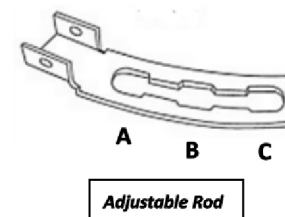

Position A

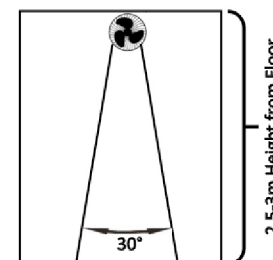
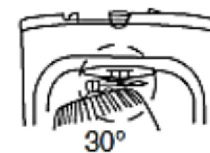

Position B

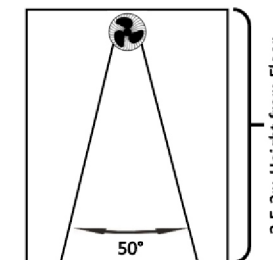
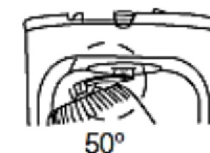

Position C

CLEANING AND MAINTENANCE

1. Ensure the fan is turned off completely and unplugged from outlet before cleaning.
2. Use only a soft and damp cloth to clean the fan.
3. To clean the fan blades, unclamp the guard clips and remove the front fan guard.
4. Wipe the fan blades and guards carefully.
5. Reassemble the fan by snapping the front guard back into place.

WARNING:

- **Always ensure the unit is turned off (Speed Control at "0" (OFF) position) first.**
- **Do not immerse the appliance into water and never let the motor housing be in contact with water**
- **Do not use any cleaning chemicals such as detergents and abrasives.**

MAIN SPECIFICATION

Voltage	: 220-240V~, 50Hz
Rated Power	: 40W
Fan Size	: 16-Inch
Motor	: 3-Speed

NOTICE

This product must not be disposed together with domestic waste. It has to be disposed at an authorized place for recycling of electrical and electronic appliances. By collecting and recycling waste, you help to save natural resources and make sure the product is disposed in an environmentally friendly and healthy way.

