

ITM. / ART. 1600276  
**WORKLIGHTS WITH SPEAKERS**  
 Stereo | Wireless | Rechargeable



**700**  
LUMENS

**IMPORTANT! RETAIN FOR FUTURE REFERENCE. READ CAREFULLY**

**Infinity X1**  
 SMARTER INSIDE. BRIGHTER OUTSIDE.

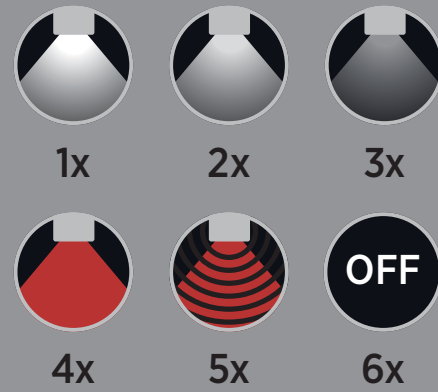
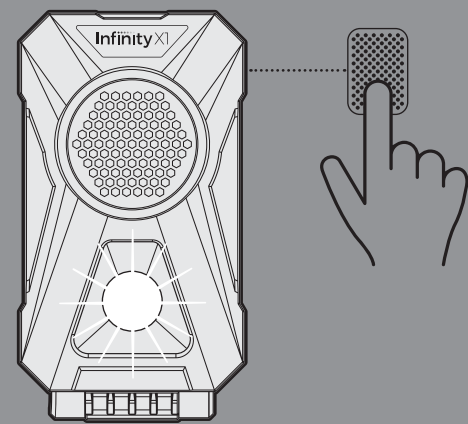

**STEP 1**

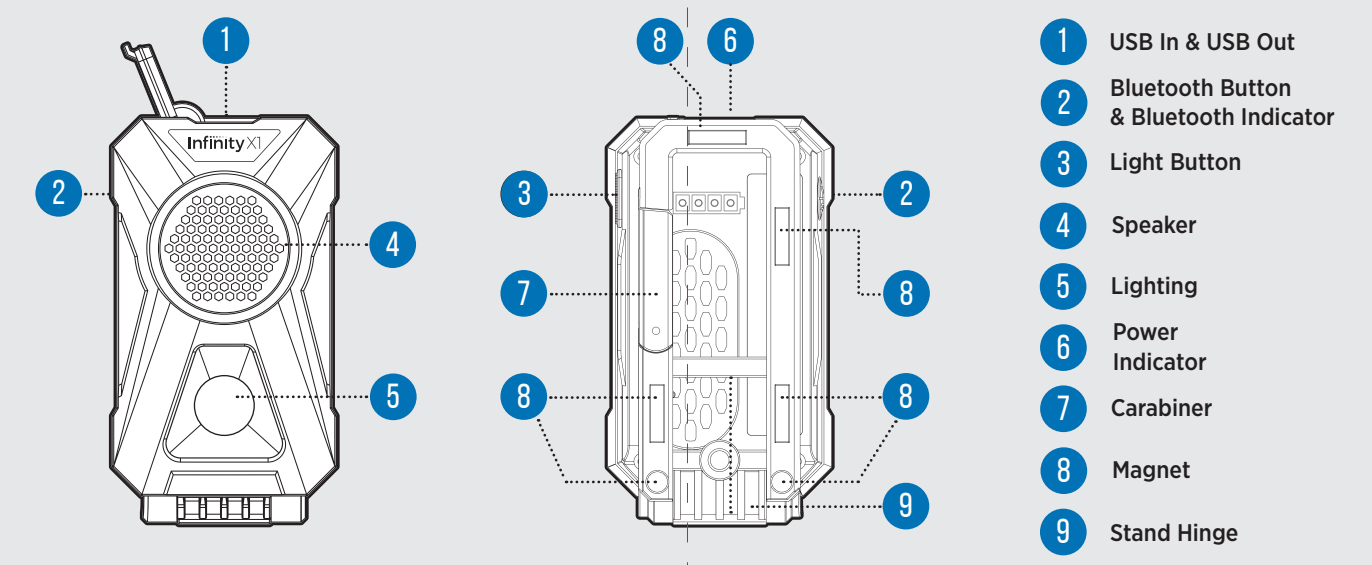
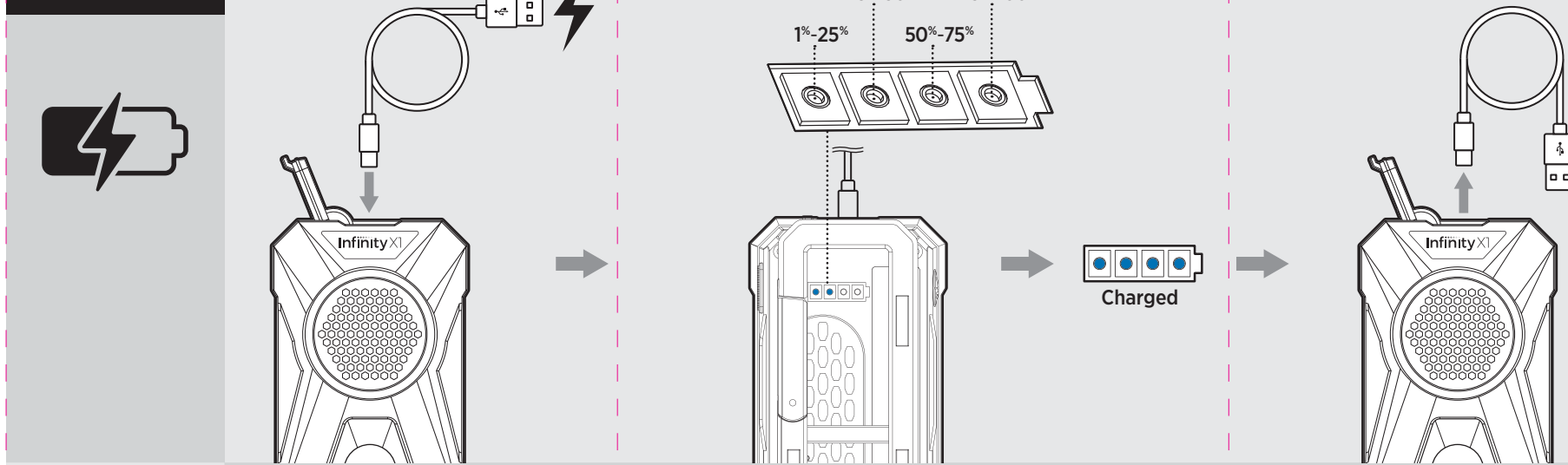

- 1 USB In & USB Out
- 2 Bluetooth Button & Bluetooth Indicator
- 3 Light Button
- 4 Speaker
- 5 Lighting
- 6 Power Indicator
- 7 Carabiner
- 8 Magnet
- 9 Stand Hinge

**STEP 2**

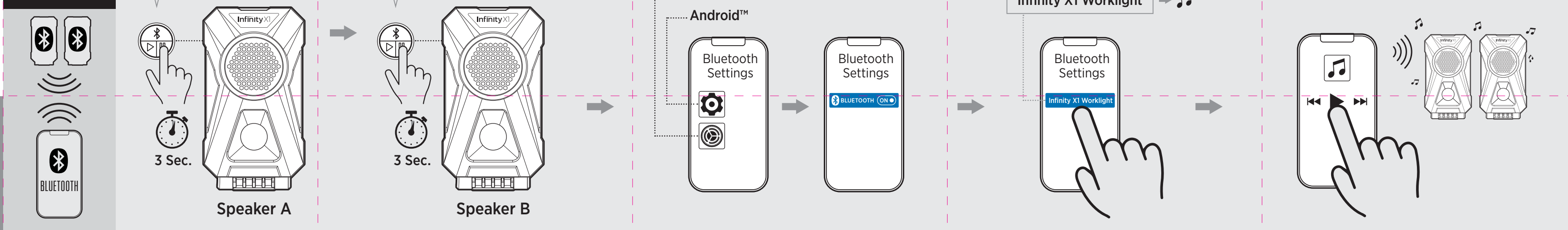

**STEP 3**

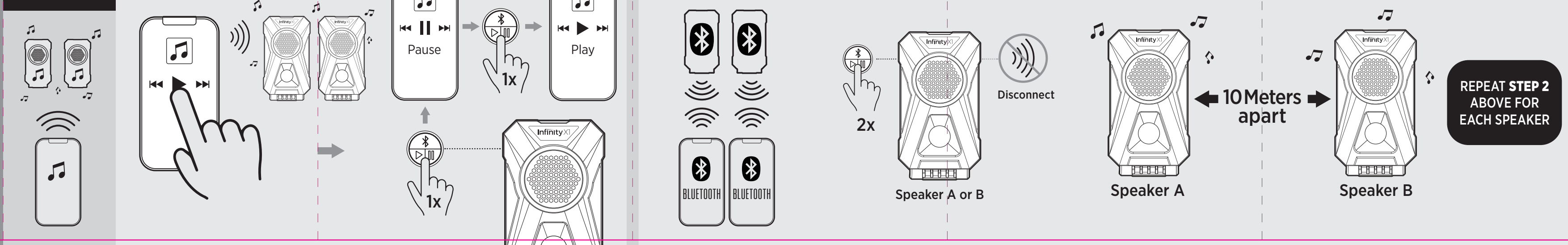

Client: INFINITY X1  
 File: **ITM. / ART. 1600276**  
 BLUETOOTH SPEAKER MANUAL-CC-USA-v.17  
 Start Date: FEB. 23, 2021    End Date: JULY 18, 2022

 NOASOUND PRODUCTIONS  
 noasound.com  
 514-235-6603  
 info@noasound.com



**CURRENT CHECKLIST / STATUS:**

As of **JULY 25 - 2022**

COSTCO ENGLISH APPROVAL: **YES** / KELSEY PATRICK - APR. 29 - 2021  
 ITM. / ART. # : **YES** ITM. / ART. 1600276  
 WARNINGS: **YES**  
 CUSTOMER SERVICE INFO: **PLACED - PENDING**  
 CERTIFICATION MARKS: **ADDED**

MAR. 29 - ADDED MISSING GRAPHICS  
 MAR. 31 - CHANGED DISCONNECT FUNCTION TO (CLICK TWICE)  
 APR. 5 - Revised another image to click twice

Apr. 7 - Added new CHINA Address  
 -Made Robinson's changes  
 -Apr. 13 - Changed Japan address  
 APR. 29 - ENGLISH APPROVED  
 MAY 13 - CHANGED FL1 INFO  
 MAY 17 - ADDED AUSTRALIAN GUARANTEE  
 JULY 20 - ADDED SWEDISH ADDRESS & FREQUENCY STATEMENT  
 AUG. 10 / 2021 - ADDED PEAK BEAM

MAY 9 - 2022 - RUNNING CHANGE TO COSTCO ADDRESSES  
 JULY 18 - ADDED SORTING LABEL TO MANUAL - v.17  
 JULY 25 - UPDATED ADDRESSES (04-13-22) - V.18

**ALTHOUGH THIS ARTWORK HAS BEEN CHECKED FOR ACCURACY, IT IS THE RESPONSIBILITY OF THE CUSTOMER TO MAKE ALL FINAL APPROVALS. PLEASE DOUBLE-CHECK ACCURACY OF ALL TEXT, THE COLORS, ARTWORK DIMENSIONS, IMAGE AND COPY POSITIONS. ANY CHANGES MADE TO THE ART AFTER YOU APPROVE MAY RESULT IN ADDITIONAL CHARGES.**

Approved by: \_\_\_\_\_ Title \_\_\_\_\_ Date \_\_\_\_\_

OK AS IS     PLEASE REVISE

FL1 STANDARD NORME FL1 NORMA FL1	HIGH HAUTE ALTA	MED MOY MEDIO	LOW FAIBLE BAJA
	<b>700</b> LUMENS LUMENES	<b>300</b> LUMENS LUMENES	<b>100</b> LUMENS LUMENES
	<b>2h 30min</b>	<b>5h</b>	<b>12h</b>
	<b>28 m</b>	<b>18 m</b>	<b>10 m</b>
	<b>196cd</b>	<b>81cd</b>	<b>25cd</b>

BATTERY LIFE
<b>LIGHT ONLY</b> 2.5 Hours 700 Lumens
<b>MUSIC ONLY</b> 12 Hours
<b>LIGHT &amp; MUSIC</b> 3.5 Hours 400 Lumens

### FCC STATEMENT OF COMPLIANCE

WARNING: Changes or modifications not expressly approved by the party responsible for compliance could void the user's authority to operate the equipment. This equipment has been tested and found to comply with the limits for a Class B digital device, pursuant to part 15 of the FCC Rules. These limits are designed to provide reasonable protection against harmful interference in a residential installation. This equipment generates, uses and can radiate radio frequency energy and, if not installed and used in accordance with the instructions, may cause harmful interference to radio communications. However, there is no guarantee that interference will not occur in a particular installation. If this equipment does cause harmful interference to radio or television reception, which can be determined by turning the equipment off and on, the user is encouraged to try to correct the interference by one or more of the following measures:

- Reorient or relocate the receiving antenna.
- Increase the separation between the equipment and receiver.
- Connect the equipment into an outlet on a circuit different from that to which the receiver is connected.
- Consult the dealer or an experienced radio/TV technician for help.

Note: This device complies with Part 15 of the FCC Rules. Operation is subject to the following two conditions: (1) this device may not cause harmful interference, and (2) this device must accept any interference received, including interference that may cause undesired operation.

Note: (a) frequency band(s) in which the radio equipment operates: 2.4 - 2.4835 GHz.

(b) maximum radio-frequency power transmitted in the frequency band(s) in which the radio equipment operates: 4.30 dBm (E.I.R.P.).

### PRECAUTIONS

- Please store and use this product at room temperature.
- Do not expose this product to rain or damp surroundings.
- Prevent this product from falling as that could result in serious damage.
- Do not dismantle, repair or modify this product on your own.
- In order to avoid any risk, do not dispose this product inappropriately or expose it to fire as there is a built-in, non-replaceable lithium battery.

### Tips

1. Do not turn up the volume to maximum for a long time as this could shorten the service life of this product or impair your hearing.
2. When encountering any fault during operation, please cut off the power supply and disconnect the USB cable to prevent further damage to the speaker or other components.
3. The Bluetooth transmission range or connectivity could be affected by low battery power. In that case, please recharge immediately.



**CAUTION:** Possible hazardous optical radiation emitted from this product. The luminaire should be positioned so that prolonged staring into the luminaire at a distance closer than 1.5 m / 5.1 ft is not expected.



**WARNING:** The ventilation should not be impeded by covering the ventilation openings with items such as newspapers, tablecloths and curtains. Allow at least a 10 cm gap all around the product.



**WARNING:** No naked flame sources, such as lighted candles, should be placed on the speaker.



**WARNING:** This appliance is intended for domestic household use only and should not be used for any other purpose or in any other application, such as for non-domestic use or in a commercial environment.

Distributed by:  
Costco Wholesale Corporation  
P.O. Box 34535  
Seattle, WA 98124-1535  
USA  
1-800-774-2678  
www.costco.com

Costco Wholesale Canada Ltd.\*  
415 W. Hunt Club Road  
Ottawa, Ontario  
K2E 1C5, Canada  
1-800-463-3783  
www.costco.ca  
\* faisant affaire au Québec sous le nom les Entrepôts Costco

Importado por:  
Importadora Primes S.A. de C.V.  
Bvd. Magocentro No. 4  
San Fernando La Herradura  
Huiquilucan, Estado de México  
C.P. 52765  
RFC: IPR-930907-570  
(55)-5246-5500  
www.costco.com.mx

Costco Wholesale Australia Pty Ltd  
17-21 Parramatta Road  
Lidcombe NSW 2141  
Australia  
www.costco.com.au

Costco Wholesale UK Ltd /  
Costco Online UK Ltd  
Hartspring Lane  
Watford, Herts  
WD25 8J5  
United Kingdom  
01923 21313  
www.costco.co.uk

Costco Wholesale Sweden AB  
Box 614  
114 11 Stockholm  
Sweden  
www.costco.se

Costco Wholesale Iceland ehf.  
Kaupþun 3-7, 210 Gardabaer  
Iceland  
www.costco.is

Costco Wholesale Spain S.L.U.  
Polígono Empresarial Los Gavilanes  
C/ Agustín de Betancourt, 17  
28906 Getafe (Madrid) España  
NIF: 886509460  
900 111 155  
www.costco.es

Costco Wholesale Japan Ltd.  
2 Kakuchi, 2 Gaku, Kaneda-Nishi  
361 Urukura, Kisarazu shi  
Chiba, 292-0007 Japan  
0570-200-800  
www.costco.co.jp

Costco France  
1 avenue de Brihat  
91140 Villebon-sur-Yvette  
France  
01 80 45 01 10  
www.costco.fr

Costco Wholesale New Zealand Limited  
2 Gunton Drive  
Westgate  
Auckland 0814  
New Zealand  
www.costco.co.nz

Costco Wholesale Korea, Ltd.  
40, Iijik-ro  
Gwangmyeong-si  
Gyeonggi-do, 14347, Korea  
1899-9000  
www.costco.co.kr

Costco (China) Investment Co., Ltd.  
Room 1003, Block 2, 2388 Xiapu Road,  
Pudong New Area, Shanghai  
China 201315  
+86-21-6257-7065

### PRODUCT INFORMATION

Product Model	1600276
Bluetooth Specifications	Bluetooth 5.0
Transmission Distance	≤10m (depending on operation environment and devices to which it connects)
USB Rechargeable Voltage	DC 5V 1A
Built-in Battery	2600 mAh
Output Power	5 W
Product Dimensions	5.5 x 3.0 x 2.5 inch

### PROBLEM

Unable to pair up with other devices
The sound is rather low or distorted
The music stops from time to time
The Bluetooth indicator remains off

### SOLUTIONS

1. Check whether the speaker is still in the process of search or switch it off and then on.
  2. Too many Bluetooth devices in the proximity that cause difficulty in connection. Please turn them off.
1. Check the Bluetooth device's volume and then adjust it to a proper level.
  2. Recharge the battery.
1. Check whether the speaker's effective transmission range is exceeded or there is an obstacle standing between the speaker and other Bluetooth devices.
1. It suggests the battery power drops quite low and retry once being recharged.
  2. Turn it on again.

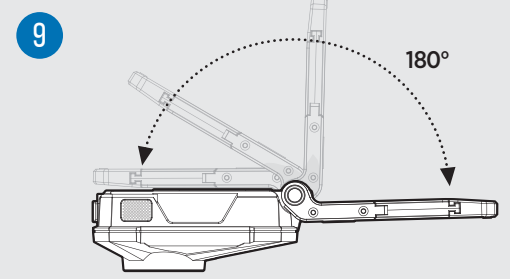
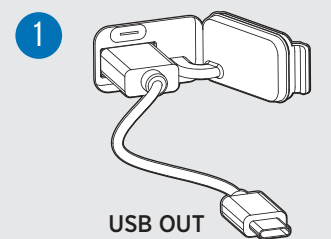
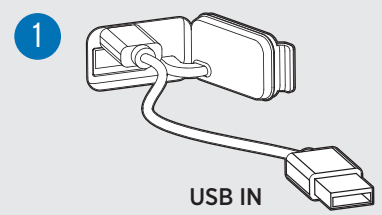

### DISCONNECT FROM PHONE BEFORE CONNECTING NEW PHONE

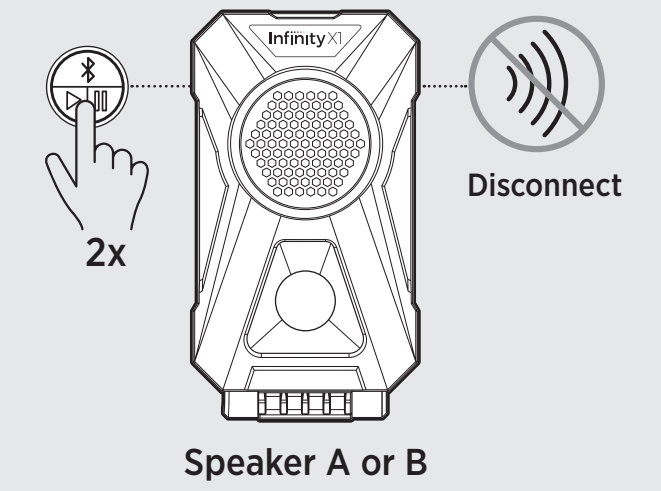

# Infinity X1

SMARTER INSIDE. BRIGHTER OUTSIDE.

**Manufacturer / Fabricant / Fabricante:**  
©2021 INFINITY X1 LLC  
3525 Del Mar Heights Rd, Suite 867  
San Diego, CA 92130, USA  
www.infinityx1.com



Questions, problems missing parts?  
Before returning to your retailer,  
call Customer Service:

### CUSTOMER SERVICE

USA: 1-866-544-4891  
International: 1-760-230-5611  
Hours: M-F 9AM to 5PM Pacific Time  
Web: www.infinityx1.com/support  
Email: support@infinityx1.com



MADE IN CHINA