

Garden Laser Light User Manual

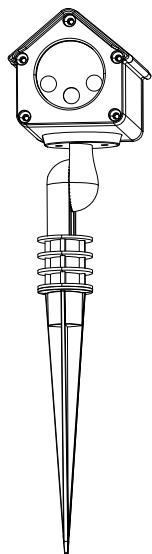

Thanks for your purchasing, please read this manual carefully before operating the product. It gives you general information for your safety and better operation.

◆Packing Accessories

Check for the contents in the package refers to the following list;

1.Laser light :1	
2.Adaptor:1	3.Power cord:1
4.Junction:1	5.Ground stake:1
6.Remote control:1	7.Screws:1
8.Tripod:1	9. User Manual:1

◆Product Features

Laser classification/power	class2/less than 1 mw(single beam)
Laser wavelength(s)	515nm Green/660nm Red/450nm Blue
Laser Diode Life About	> 10000 hours
Power Input	120-240V AC
Operating Environment	Indoor/ Outdoor; -30℃-30℃
Waterproof Level	IP65 for the light and IP44 for Adaptor
Projection Coverage	40 ft. X 40 ft.

◆Installation Steps

*Position the projector by loosening and tightening the angle adjustment screws.

*Attach the cable to the adaptor and the projector light by fully inserting the two-pronged plug and tighten the wire cap.

a. Ground stake mounting

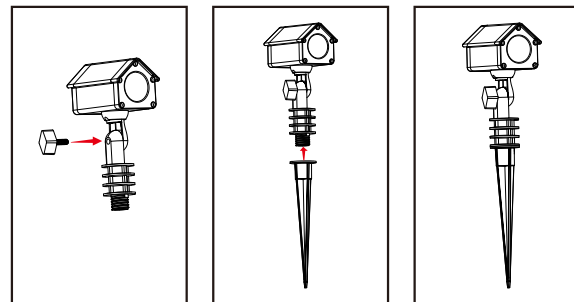

b. Tripod mounting

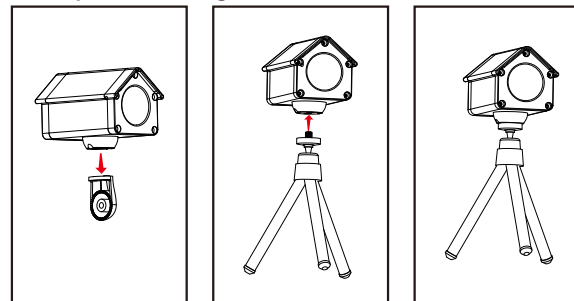

◆Remote Guide

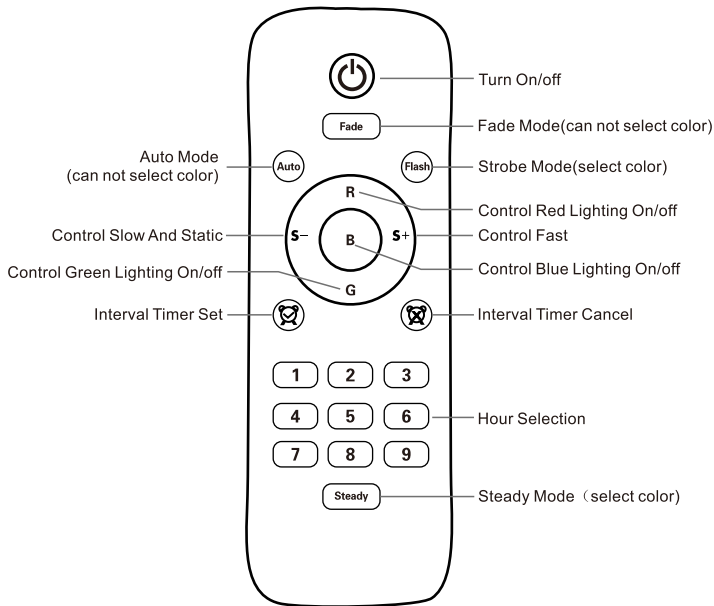

1. Before you use the remote control, please tear off the protective film of the battery in the remote control.

2. : On / Off;

3. Fade: Breath mode (can not select color);

4. Auto: Automatic mode (can not select color);

5. Flash: Stroboscopic mode ;

6. R G B: Control color on and off;

R: Control the red light On/Off;

G: Control the green light On/Off;

B: Control the blue light on and off;

7. S-S+ : Adjust the motor speed, with 3 speeds: slow, medium, fast.

S- Slow down; S+ Acceleration;

8. : Set timing On/Off;

9. 1 h-9h: Setting timing time;

10. Steady: Steady mode

Note: When the time is required, please press the light will flash twice to indicate that it has received the directive, then select the desired time (press once) to set the timing successfully.

When you need to cancel the timer, please press , the light will flash twice to indicate that it received the directive, the timer was been off.

If you want to change the timing time, please press to cancel the timing firstly, then press and press the desired time (2, 4, 6, 8 only select one).

For example: if you select 2h, the light will automatically turn off after 2 hours, and 2h will automatically turn on (24 hour cycle, under the condition of uninterrupted electricity power).

◆Warm Tips

※Better to work 6 hours then cool it down with 30 minutes, it will save the lifetime of lighting source.

※Laser is Class 2, the power of each laser point is not more than 1mW, no harmful to human body and eyes.

※This product is mainly used for outdoor with waterproof IP65. It has excellent radiating ease put it far way from the flammable objects or liquids.

※Please use our own power adaptor to support the light. If you need to change a new adaptor please check the parameter of our adaptor and buy a new One. If you need more longer power cable, please use legal cable with enough diameter and control the length or it will give more higher load to the adapter.

※When connecting the cable to the plug adapter, please make sure the 2 pin plug is the right way round, the "Flat" and "Keyway" need to match or there will be no contact.

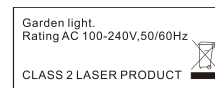

Customer Service: sales@ledmall.com



MADE IN CHINA