

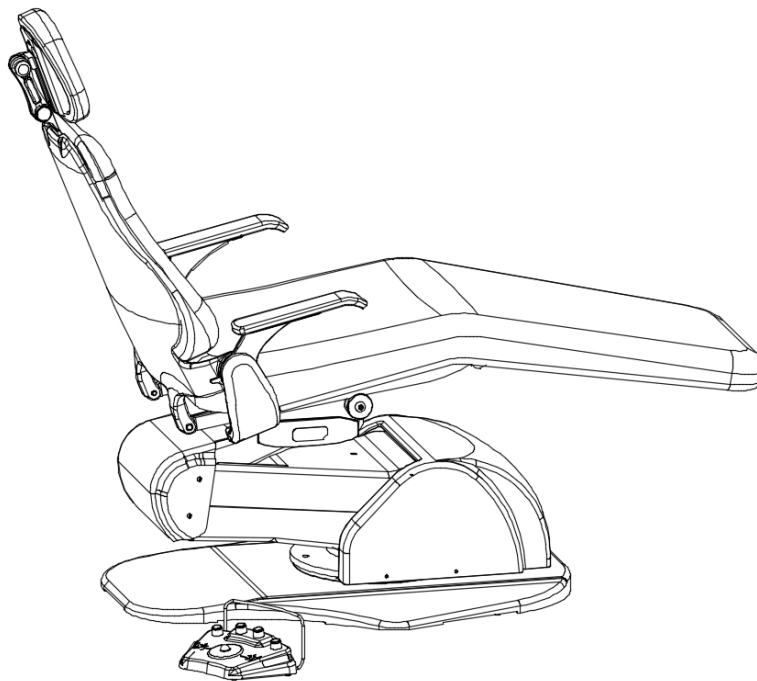

# FDC37H Dental Chair

## Installation Guide



Firststar Dental Company  
18915 84<sup>th</sup> Ave. S. Kent, WA 98032  
[www.firstardental.com](http://www.firstardental.com)  
E-Mail: [technical@firstardental.com](mailto:technical@firstardental.com)

### Table of Contents

---

<b>Start Here</b>	1
<b>Removing Packaging</b>	2
Dental Chair Installation	2
<b>Chair Upholstery</b>	3
Headrest Cushion	3
Backrest Cushion	3

Seat Cushion	4
Armrest Cushion	4
<b>Installation Completion Checklist</b>	<b>5</b>

**GENERAL INFORMATION**

Make sure that you follow local building codes and regulations for this installation. They differ from state to state and internationally. Dispose the packaging materials in accordance with current packaging regulations.

Also, make sure that the following steps are completed prior to installation.

1. Associated electrical Voltage Transformer and safety comply with the unit specified requirements.
2. The flooring for this unit should be flat, level and steady.

**INSTALLATION PREPARATION**

1. The instructions contained in this booklet should be read and understood thoroughly before installation. After unit installation has been completed, keep this manual in a safe place for future reference.
2. Familiar with all components. Each box contains a part list. Make sure that all the parts are included in each box are accounted for and damage free.
3. Prepare the following recommended installation tools:
  - SAE Socket Wrench Set (1/16" – 3/8")
  - Philips and standard screwdriver
  - Level
  - Scissor

**Important**

- If you have any questions about this manual or this product, please contact us or visit our website for more information.
- If manual becomes unreadable or is lost, please request a new manual by contacting your dealer or visit our website for an electronic version.
- Installation should be conducted by authorized personnel only.

- Please make sure to follow instructions on this installation manual.

**Dental Chair Installation**

1. Unpack Box A and verify all the components inside match with the inventory list. Make sure all the parts are in good condition with no signs of damage.
2. Use a Philips screw driver to remove 4 shipping screws ④ on the bottom of the wooden shipping pallet ③. Use scissors to cut the shipping straps ②, then move dental chair ① from the shipping pallet to the ideal location for installation.
3. Take out two connector pins ⑧ located at the bottom of the backrest ⑤. Slowly rotate backrest ⑤ so that the backrest connector holes are aligned with the seat frame support holes ⑦ as shown on Figure 1.A. Put connector pins ⑧ through the backrest connector holes and seat frame support holes on both sides. Do not forget to put nylon washers ⑥ in between of connector holes as shown on Figure 1.A.
4. Verify connector pins are installed correctly. Secure them with set screws ⑨.

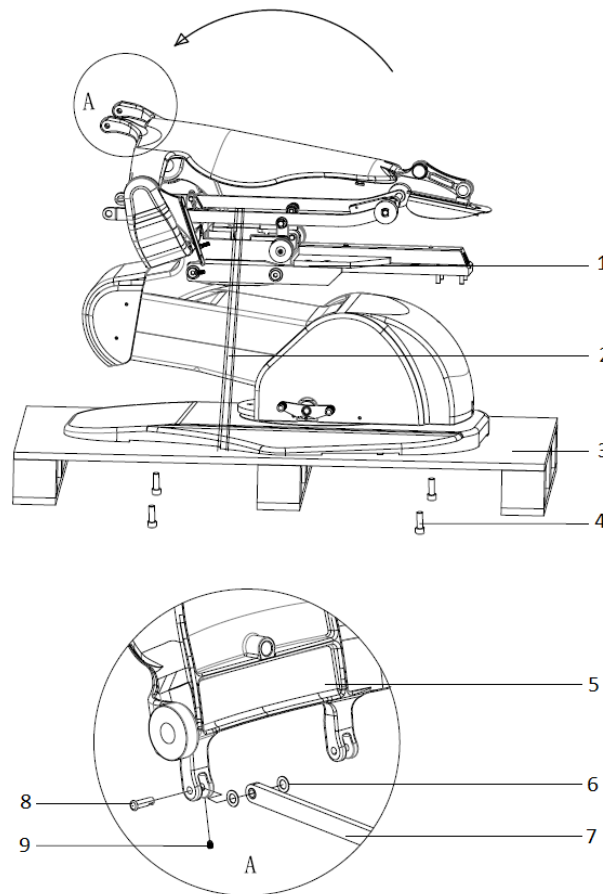

Figure 1. Dental Chair Unboxing and Assembly

- |                |                     |                      |                       |
|----------------|---------------------|----------------------|-----------------------|
| ① Dental Chair | ② Shipping Straps   | ③ Shipping Pallet    | ④ Shipping Screws x 4 |
| ⑤ Backrest     | ⑥ Nylon Washers x 2 | ⑦ Seat Frame Support |                       |

**Dental Chair Movement Control Test**

FDC-37HC dental chair movement can be controlled by a pre-programmed footswitch. Before moving on to the next step, it is important to check the chair movement functionality. Connect the power cable to the wall outlet and then test the chair movements in the following steps:

1. Push footswitch button “III”. Dental chair will automatically raise to the highest position.
2. Push footswitch button “0”. Dental chair will automatically lower to the lowest position.
3. Push footswitch button “I”. Dental chair will automatically raise and the back support will lean backward to the factory default setting 2. Push footswitch button “0” to reset.
4. Push footswitch button “II”. Dental chair will automatically raise and the back support will lean backward to the factory default setting 3. Push footswitch button “0” to reset.
5. Repeat these steps two to three times. Make sure that all movements are smooth with no abnormal noise.

**Caution:**

1. The dental chair hydraulic system working environment temperature is from -5°C to 40°C. If the ambient temperature is too hot or too cold, the hydraulic system might experience abnormal operation.
2. If dental chair is staying in the same position for too long, there might be air bubbles forming in the hydraulic tubes. It is normal to hear the squeaky noise from the chair movement after the chair is idled for too long. Repeat steps 1 to 4 can remove this noise.
3. It is very important the dental chair is installed correctly. It is highly recommended to replace any broken parts before proceeding to the next step to avoid unnecessary problems later.

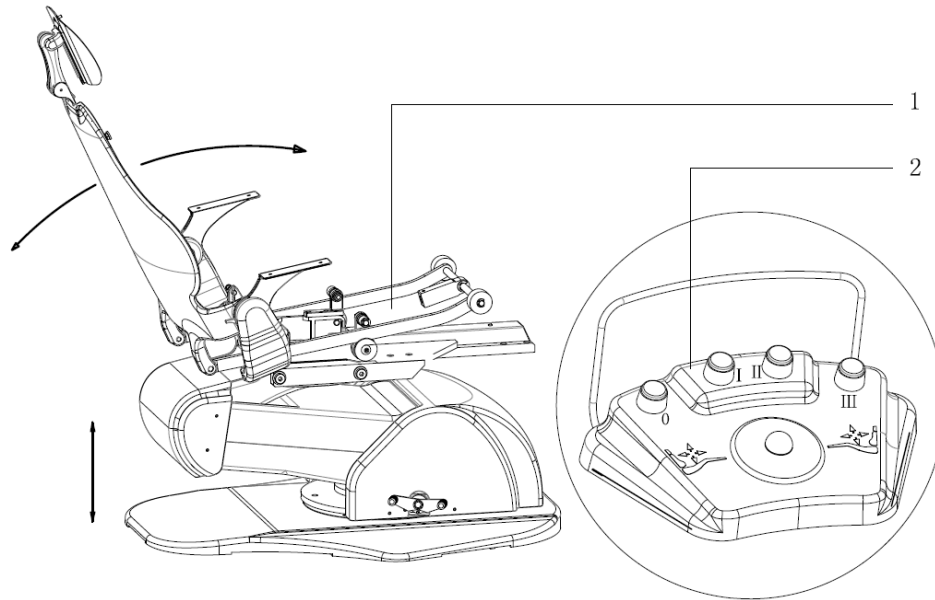



Figure 2: Dental Chair Movement Control Testing ① Dental Chair ② Chair Footswitch

**FDC-601 Installation Guide**

**Chair Upholstery**

 If chair is part of the dental package, wait until the entire installation is complete before installing upholstery. Failure to do so may result in damaging the upholstery.

**Headrest Cushion**

1. Rotate the headrest support ② to allow access to the two screw holes.
2. Align the headrest cushion ① mounting holes with the headrest support ②.
3. Install the upper screw on the headrest support.
4. Install the lower screw on the headrest support.
5. Tighten both screws ③.

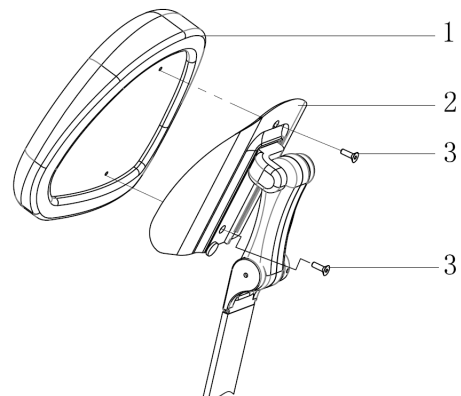

Figure 3. Headrest cushion installation  
 ① Headrest Cushion ② Headrest Support  
 ③ Screws x 2

### Backrest Cushion

1. Remove the headrest support before doing the backrest cushion installation.
2. Raise the dental chair and the backrest support ② upward with the footswitch.
3. Put the backrest cushion ① on the backrest support and align 4 button studs ④ with the 4 holes ③ on the black cushion.
4. Gently push down on the backrest cushion until they latched properly.
5. Install the headrest support.

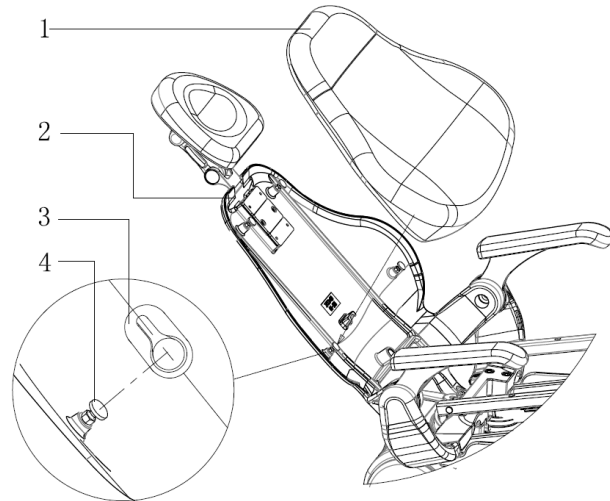

Figure 4. Backrest cushion installation

- |                    |                    |
|--------------------|--------------------|
| ① Backrest Cushion | ② Backrest Support |
| ③ Button Holes     | ④ Button Studs     |

Warning: All 4 button studs need to be latched properly. Do not loosen any of the button studs.



### Seat Cushion

1. Put the seat frame ① on the side of the yoke casting ③.
2. Align two screw holes as indicated on Figure 5. Detail A.
3. Place a washer ④ between the seat frame and the yoke casting.
4. Install a connecting pin ② through the hole on each side of the chair.
5. Install an R latch ⑤ through the hole on the connecting pin on both sides.
6. Put the seat cushion ⑦ on top of the seat support.
7. Align all 5 screw holes between the seat support frame and the seat cushion.
8. Install 3 screws loosely at the front of chair.
9. Lift up the seat support, then secure the other 2 screws at the back.
10. Tighten all 5 screws ⑥.

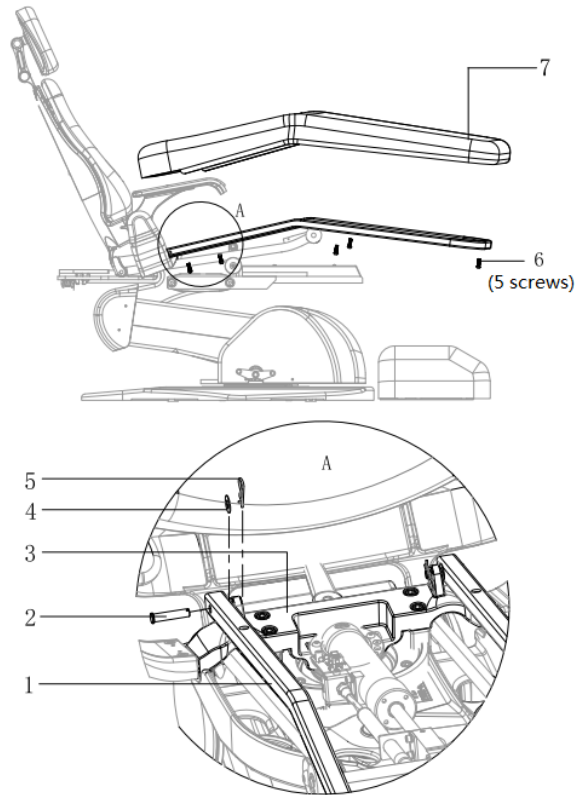

Figure 5. Seat Cushion Installation

- |                |                      |
|----------------|----------------------|
| ① Seat Frame   | ② Connecting Pin x 2 |
| ③ Yoke Casting | ④ Nylon Washer x 2   |
| ⑤ R Latch x 2  | ⑥ Screws x 5         |
|                | ⑦ Seat Cushion       |

### Armrest Cushion

1. Put the armrest cushion ① on top of the armrest support ②.
2. Align screw holes on the armrest cushion with the armrest support.
3. Install both screws.
4. Tighten both screws ③.
5. Install the other armrest cushion in the same manner.

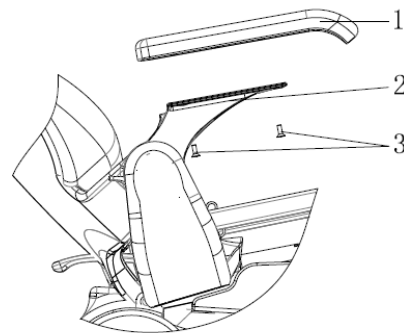

Figure 6. Armrest Cushion Installation

- |                   |                   |
|-------------------|-------------------|
| ① Armrest Cushion | ② Armrest Support |
| ③ Screws x 4      |                   |

**Installation Completion Checklist**

Refer to the user manual for operation of the touchpad and foot control functions.

Dental Chair

- The rotational brake functions properly.
- The touchpad functions correctly.
- The headrest stays in position after being adjusted.
- The foot control functioning correctly.
- All chair function operate smoothly and quietly.
- The armrest locked into position.

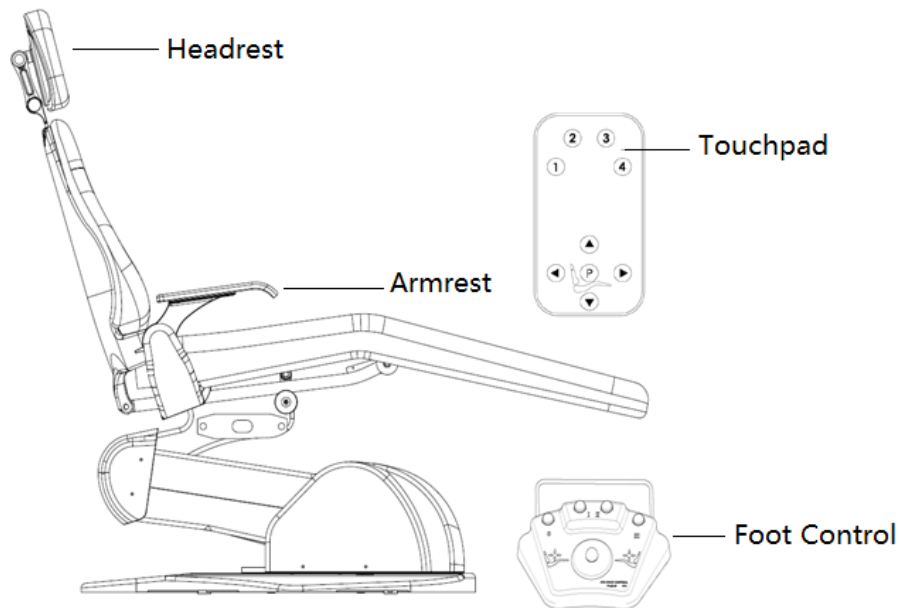

Medical – General Medical Equipment Certified as to electrical shock, fire and mechanical hazards only in accordance with:

ANSI/AAMI ES 60601-1:2005 + C1;A2

CSA std. C22.2#60601-1:2008 Ed.2+C2

IEC 80601-2-60:2012 Ed. 1

IEC 60601-1-2:2014

ETL CLASSIFIED



**Intertek**  
4010684



