



## **MILK FROTHER**

A Scandinavian-designed milk frother  
by Sjöstrand.

## Welcome to Sjöstrand Coffee Concept.

We hope you will be satisfied with your new Milk Frother.

We have designed a coffee concept with sustainable design in mind. Our products should fit in every kitchen, and are made to stand time. Find out more about our concept at [sjostrandcoffee.com](http://sjostrandcoffee.com)

## Read All Instructions Before Use.

- **WARNING:** This appliance must be earthed.
- Do not immerse in water or other liquids. Danger of short-circuiting!
- Never operate damaged appliances (incl. mains cables).
- Do not place the appliance on a polished wood surface, it could damage the wood.
- Never touch any moving parts.
- Operate appliance only through a professionally installed socket supplying the correct voltage.
- Do not use extension cables.
- Never let main cable hang loose, nor remove plug with wet hands, nor lay or hang on hot surfaces, nor let it come in contact with oils.
- Unplug the appliance:
  - after each use
  - when the appliance is not in use
  - before changing accessories or cleaning the appliance
- Do not touch the metal parts, the filter holder or its housing when the appliance is in use, as this may cause burns or scalding.
- Do not operate this appliance with a damaged cord or plug. If the supply cord is damaged, it must be replaced by manufacturer, its service agent or similarly qualified person in order to avoid a hazard.
- This appliance conforms to directive 89/336 CEE regarding electromagnetic compatibility.
- Any persons (including children) with reduced physical, sensory or mental capabilities, or lack of experience and knowledge, should only use the appliance under supervision by a person responsible for their safety.



- Children should be supervised to ensure they do not play with the milk frother.
- Do not operate outdoors.
- Do not operate without milk in the jug.
- **THIS IS AN ATTENDED APPLIANCE.**
- Turn the appliance and main power off when not in use.
- Never touch rotating parts. Risk of injury!
- By exceeding the filling capacity the jug may overflow.
- Appliance to be used only in conjunction with the basic unit provided.
- Never operate appliance on uneven surfaces.
- Use only fire blankets to extinguish fires on appliances.
- The appliance is not designed for commercial or industrial use; it is for household use only.
- Do not insert any objects and/or fingers in the appliance apertures.
- Disable appliances prior to disposal, cut off mains cable and take to an official refuse site.

## **Before Your First Use.**

- Remove all packaging and foils and store it until you are satisfied that everything is present and working in order.
- Check if the appliance has been delivered completely and that it is in perfect order.
- Before using the appliance for the first time please clean the jug and the accessories, as described under the chapter "Cleaning and Care" to remove dust or production residues.

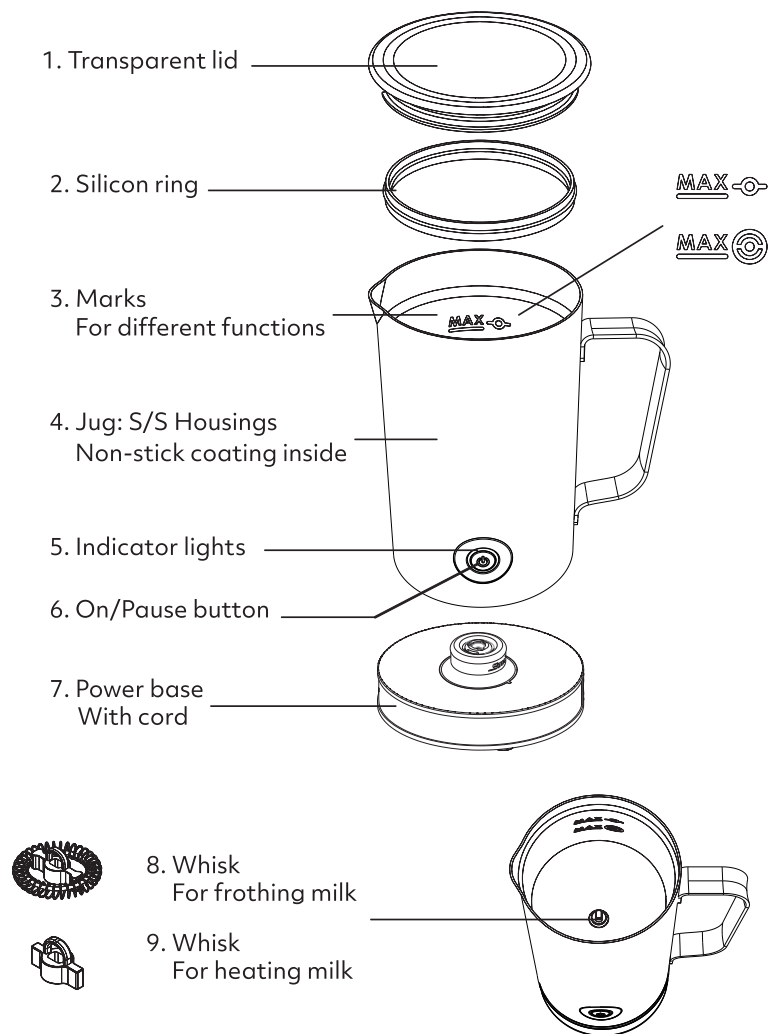
## Get To Know Your Frother.



Whisk	Function	Max capacity	Time
	Frothing cold milk	150ml	~60-65s
	Frothing & Heating	150ml	~100-140s
	Heating	300ml	~165-205s

## How To Use.

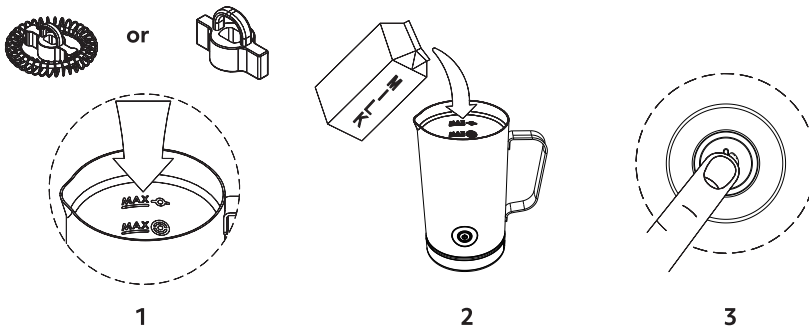

1. Choose the appropriate whisk and set it inside the jug.  
See the function above for reference.
2. Pour the milk into the jug below the mark.  
See the max capacity above for reference.
3. Push the button to start the machine.

- 1) Frothing and heating / Heating without frothing: Touch the button until the red light turns on. The red light keeps flashing for 30s after finishing working.
- 2) Frothing the cold milk: Pour the cold milk into the jug and push the button for 1-2 seconds until the blue light turns on. After 65s the machine finishes working, the blue light keeps flashing for 30s.
- 3) Error status: The blue light keeps flashing. It means the machine works at an overload. Cut off the power and pour out the milk (the milk level must be below the max mark), then try to start again.

## Helpful Tips.

Here are some handy tips to help you get the best out of your frother.

- Always use your frother first to froth or heat your milk. While it is operating prepare your coffee or hot chocolate and serve immediately.
- Use whole milk (fat content >3.0%) for best results.
- Cold milk can be frothed with this frother. But it doesn't mean you can cool down the milk with it. The frother works in normal temperatures in this condition.
- Milk heats to approximately 65+/-5 °C. This is the ideal temperatures to ensure the flavor of your coffee is not impaired and so you don't have to wait too long until you can start sipping on your drink.
- We recommend you store the whisks in the intended place in the jug and the lid. If the whisk is lost you can order a new at [Sjostrandcoffee.com](http://Sjostrandcoffee.com).
- After frothing or heating, set 2 minutes for the thermostat to reset and the frother to be ready for use again. To shorten this time, rinse with water and wipe dry after each use.
- The frother is designed to heat and froth milk. If you add flavorings, coffee granules or hot chocolate powder in the frother ensure you thoroughly clean immediately after using.

## Cleaning & Care.

Remove the jug from the power base before cleaning, and separate the lid and the silicon ring from the jug. **Never immerse the jug or the base into the water.**

- 1. THE JUG:** Clean immediately after each use. Flush and clean the walls using warm soap water and a non-abrasive cloth. Then dry with a soft cloth.
- 2. THE LID:** Separate the lid and the silicon ring from the jug. Wash out with water directly.
- 3. THE BODY:** Clean with a soft cloth. **Never use sharp cleaning agents, hard nylon brush or metal brush to avoid scratches on the stain less steel surface! Never clean with metal objects and never use abrasives.**
- 4. THE WHISKS:** Remove from the jug. Wash with warm water. Do not use the dishwasher. Dry and store in a safe place. We recommend you store the whisks in the intended place in the jug and the lid.

## Technical Information.

220-240 V ~ 50 Hz, 500 W. This appliance is tested according to GS regulations and corresponds to the CE directives.

## Disposal.

Please dispose of the packaging according to your local waste regulations. Cardboard and paper go to "recovered paper", foil goes to resource collection (potential recyclable).

This product should never be disposed of in normal household waste at the end of its service life. It must be delivered to a collection point for the recycling of electrical and electronic goods. This is indicated by the symbol (dust bin with cross) on the product, in the the instruction manual or on the packaging. Ask your local disposal point about disposal. The materials are reusable according to their labelling. In the reuse, material recycling or other forms of using old appliances, you are making an important contribution in protecting our environment. Please ask your local government for a suitable disposal point (old appliance collection point of municipal disposal point).



## Find Out More About Your Product and Sjöstrand.

To find out more about your Milk Frother and other products from Sjöstrand Coffee Concept, please visit us at [sjostrandcoffee.com](http://sjostrandcoffee.com).

Our FAQ is regularly updated with helpful tips.



**SJÖSTRAND**  
— COFFEE CONCEPT —

**Sjöstrand Trading AB**  
Box 12127  
102 24 Stockholm