

Dual-Head Lamp with Motion Sensor

User Manual

01 / WARNING

1. DO NOT install close to flames or flammable gases.
2. DO NOT install on unstable positions and surfaces.
3. DO NOT stare directly at the lights while they are in operation.
4. DO NOT install in close proximity to other light sources.
5. To prevent the unit from falling, install the base unit securely with screw anchors.
6. The lamp fixture should be charged in the "OFF" position for at least 3 DAYS before being used.
7. The rechargeable batteries may last up to 800 charges. For the best performance, PLEASE replace the batteries every 12 months.
8. Keep this device away from children.

02 / INSTALLATION

Solar Panel Installation

1. Secure the bracket of the solar panel to wall or deck with six screws provided.

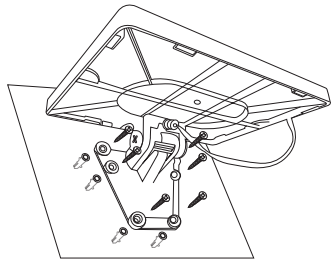

2. Adjust the bracket angle to ensure that the solar panel is facing the sun without obstructions.

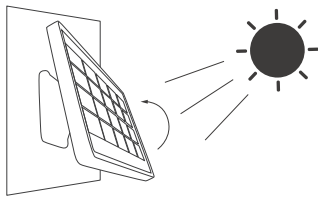

Note: The solar panel is equipped with a 14.8ft cord, so the two units can be installed up to 14.8ft apart.

Lamp Fixture Installation

1. Loosen the two screws on the base.

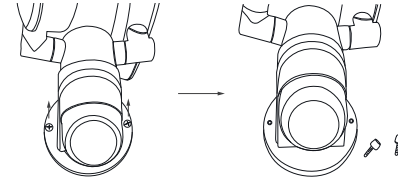

2. Disconnect the quick connector of two internal wires.

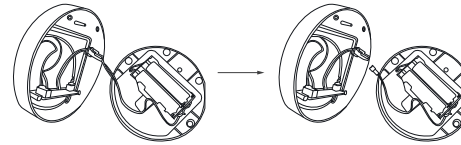

3. Install a screw anchor in the wall, and then hang the base on it with the mounting hole.

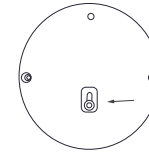

4. Fix the base to the wall by putting a second screw anchor through the hole above the battery box.

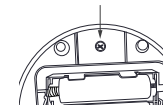

5. Connect the quick connector in step 2. Fasten the lamp to the base, then tighten the two screws in step 1.
6. Plug the solar panel wire to the fixture.

Note: The lamp fixture should be mounted 6.5-9.8ft from the ground to ensure motion detection is optimized.

03 / OPERATION GUIDE

2 MODES

By flipping the toggle switch located on the front side of the fixture, 2 kinds of lighting modes could be adjusted as follows:

1. AUTO mode: The LED Solar Security Light will turn on automatically once motion is detected when the switch is on the "AUTO" position at dark (the brightness sensitivity is adjustable). This is the most ideal position for general operation.
2. ON-OFF mode: The light will remain on or off as a regular light when the switch is on the "ON" or "OFF" position.

3 KNOBS

By turning the 3 knobs on the back of the sensor, 3 kinds of settings can be adjusted as follows:

PC Knob:

1. Adjust the brightness sensitivity of the luminaire to the surrounding environment by rotating this knob.
2. The light will turn on in most situations ranging from dusk to daylight if set to "SUN" level. If set to "MOON" it will only trigger at dark.

MOTION Knob: The max distance of the motion sensor is changeable (26-42ft), turn the second knob clockwise and the detection distance will increase and vice versa.

TIME Knob: Lasting time of the lighting is changeable (10sec - 60sec), turning the third knob clockwise raises the delay time and vice versa.

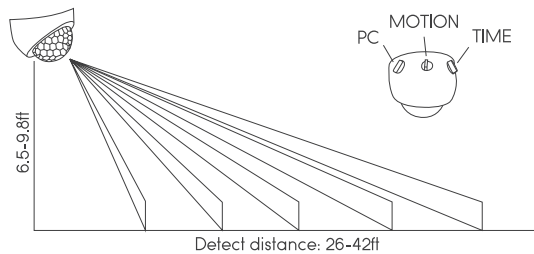

04 / TROUBLESHOOTING

If the lamp does not work when moving obviously in front of the sensor, please check the followings:

- Ensure the solar panel is in the location where it will receive maximum sunlight during the daytime hours.
- Clean solar cells with a damp towel without excessive pressure and avoid the use of any solvents or cleaning agents on the solar cells.
- Ensure switch is set to AUTO.
- Check batteries are installed correctly.
- Replace batteries.

05 / REPLACING BATTERIES

- Batteries are located in the battery housing of the fixture.
- Loosen the screws from the battery housing to access batteries.
- Replace the rechargeable batteries with the same type and rating.
- Reassemble the battery housing.

06 / MAINTENANCE

- Ensure the lamp is clean in order to optimize its performance.
- Use a damp towel to clean solar cell without excessive pressure.
- Do not use any solvents or cleaning agents on the solar modules.

07 / WARRANTY

TORCHSTAR warrants that this product is free from defects in materials and workmanship for a period of 12 months from the day of purchase. If the product has been misused, damaged by accident or in any other way of improper use, this warranty becomes void.

08 / MANUFACTURER CONTACT INFO

Website: www.torchstar.us

E-mail Address: info@torchstar.us

Phone Number: 800-990-7688

TORCHSTAR