

Color Changing Ultra-Thin Downlight

User Manual

01 / WARNING

WARNING: For safety, read and understand the instructions completely before installing. TURN OFF THE POWER at the fuse or circuit breaker before installing the fixture. All electrical connections must follow the National Electrical Code and local electrical codes.

CAUTION: DISCONNECT THE POWER BEFORE CONNECTING THE TRIM TO THE HOUSING. FAILURE TO DO SO MAY PERMANENTLY DAMAGE THE LED.

02 / PACKAGE CONTENT

Color changing ultra-thin downlights × 6

Templates × 3

Wire nuts × 18

03 / INSTALLATION

TOOLS REQUIRED

- Saw
- Measuring tape

INSTRUCTIONS

1. Due to the risk of electric shock, turn off the power before inspection, installation, or removal.
2. Locate a suitable position to place the super-thin LED fixture and open a hole according to the template.
3. Select the desired temperature by sliding the switch on the power box of the J-box. (Available CCTs are 2700K, 3000K, 3500K, 4000K, 5000K) (Figure 1)

Figure 1

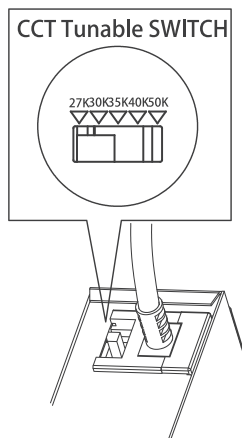

4. Insert the electrical wire from the switch (power supply) through the mounting hole.
5. Open the J-box cover and remove the appropriate knockouts.
6. Insert the electrical supply cable through the knockout.
7. Use the wire nuts.
 - Connect the green ground wire of the cable to the green wire on the J-box.
 - Connect the white wire of the cable to the white wire of the J-box.
 - Connect the black wire of the cable to the black wire of the J-box. (Figure 2)

Figure 2

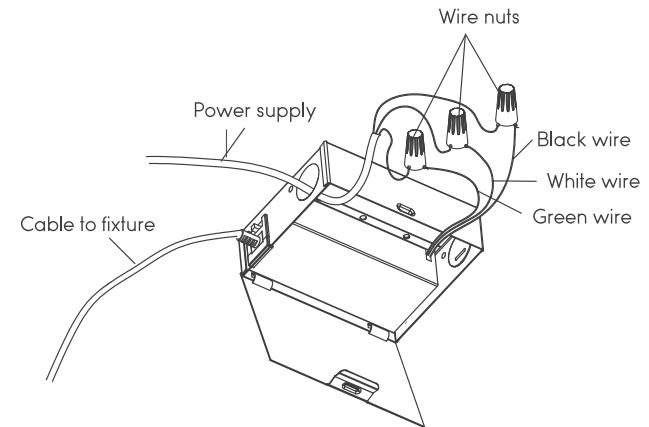

8. Place all wiring and connections back into the J-box and close the cover.
Remodel application: Insert the J-box into the ceiling. (Figure 3)

Figure 3

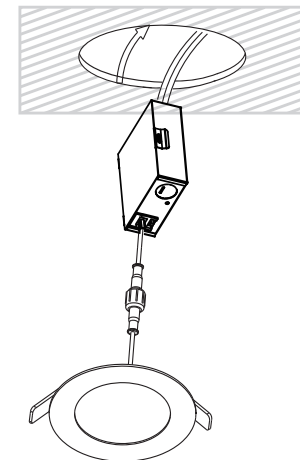

9. Push spring-loaded clips on the fixture upwards and insert the fixture base into the mounting hole. Release the clips, and the fixture will be pulled flush to the ceiling. (Figure 4)

Figure 4

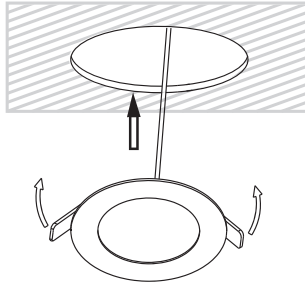

10. Once assembly is complete, turn on the power to confirm the fixture is working properly.

WARNING: For wet location installation, after the fixture is installed on the ceiling, put silicone glue to seal the gap between the fixture and ceiling.

04 / SPECIFICATIONS

Color Changing Ultra-Thin Downlight		
Size:	4 Inch	6 Inch
Power:	10W	15W
Luminous flux:	650lm	1000lm
Voltage:	120V 60Hz	
Working temperature:	5°F-104°F	
CRI:	>90	
Material:	Aluminum	
Beam angle:	110°	

05 / COMPATIBLE DIMMERS

LUTRON: DVCL-153PR-WH, CTCL-153PDH-WH, TGCL-153PH-WH, MACL-153MH-WH, P-PKG1W-WH-R

LEVITON: R62-06674-P0W, R12-06672-1LW, R50-IPL06-10M

EATON: SAL06P-LA-K

06 / WARRANTY

TORCHSTAR warrants that this product is free from defects in materials and workmanship for a period of 5 years from the day of purchase. If the product has been misused, damaged by accident or in any other way of improper use, this warranty becomes void.

07 / MANUFACTURER CONTACT INFO

Website: www.torchstar.us

E-mail Address: info@torchstar.us

Phone Number: 800-990-7688

TORCHSTAR