

Ultra-Thin Downlight

User Manual

01 / WARNING

PLEASE READ THE FOLLOWING NOTES IN THIS MANUAL AND HEED ALL WARNINGS BEFORE ASSEMBLING THIS LIGHTING FIXTURE. Please keep this manual for future reference.

1. All electrical connections must follow local codes and ordinances. Consult with a qualified licensed electrician for the installation.
2. TURN OFF THE POWER at the fuse box or circuit breaker before installing. Turning off the power at the wall switch is not sufficient enough to prevent electric shocks.
3. This fixture may not be compatible with all dimmers.
4. Suitable for use in wet locations.
5. Indoor use only.

02 / INSTALLATION

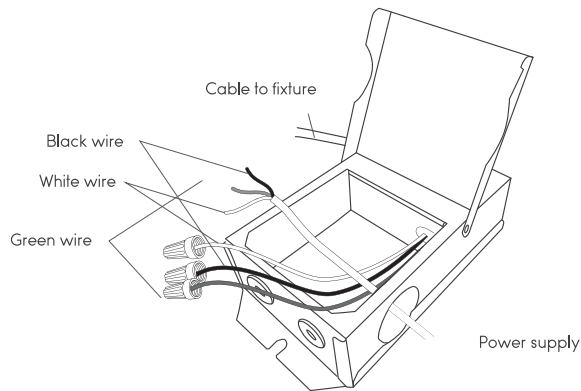

1. TURN OFF THE POWER before installing. Using the template, cut a hole in the ceiling.
2. Open the junction box's cover and remove enough knockouts.
3. Using wire nuts, connect the fixture wires with the supply wires. Connect the black wire to the live wire, the white wire to the neutral wire, and the green wire to the ground wire.

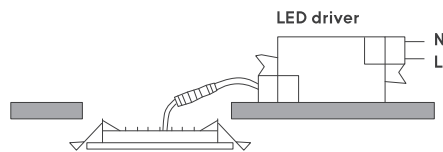

4. Place all wiring and connections in the junction box and close the cover.
5. Connect the male and female connectors together.
6. Push up on the spring clips and place the light in the ceiling. Release the clips and the light will be pulled flush with the ceiling. The installation is now complete.

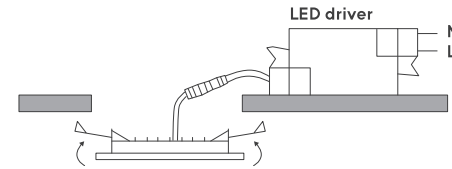

03 / SPECIFICATIONS

Ultra-Thin Downlight	
Power	10.5W/13.5W
Voltage	120V
Working temperature	-13°F-113°F
Luminous flux	800lm/1000lm
CRI	>80
Equivalent	50W/75W
Material	Die-casted aluminum
Dimming range	10%-100%
Beam angle	110°

04 / WARRANTY

TORCHSTAR warrants that this product is free from defects in materials and workmanship for a period of 5 years from the day of purchase. If the product has been misused, damaged by accident or in any other way of improper use, this warranty becomes void.

05 / MANUFACTURER CONTACT INFO

Website: www.torchstar.us
E-mail Address: info@torchstar.us
Phone Number: 800-990-7688

TORCHSTAR