

# LED Panel Light

## User Manual

### 01 / PACKAGE CONTENT

LED Panel Light × 2  
Mounting plate × 2  
Triangle hook × 8  
Wire rope × 4  
Screw anchor × 8  
Wire nut × 10  
Plastic head thumb screw × 2  
Mounting screw × 8  
Self-tapping screw × 8

### 02 / INSTALLATION

#### Surface Installation

1. Fix the mounting plate to the driver box's location on the ceiling with the screw anchors in the accessory kit. Note: The mounting plate's center hole should be aligned with the driver box.

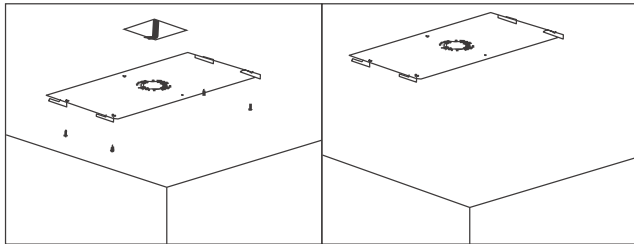

2. TURN OFF THE POWER. Connect the AC wires with the wire nuts; black wire to L, white wire to N and green wire to GND. Connect the dimming wires (purple & gray) with the corresponding wires in the driver box if necessary.

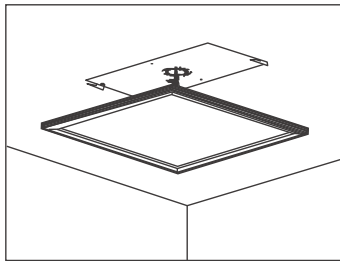

3. Using the hook on the mounting plate (Fig. a), upwardly fix the light to the hook (Fig. b), then push it towards the end in the given direction (Fig. c)

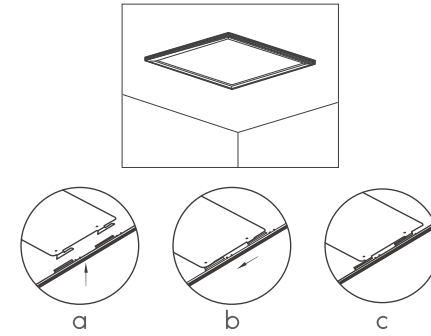

4. Screw in the knob for fixation in the designated hole (Fig. d) with the plastic head thumb screw. The installation is now complete. (Fig. e)

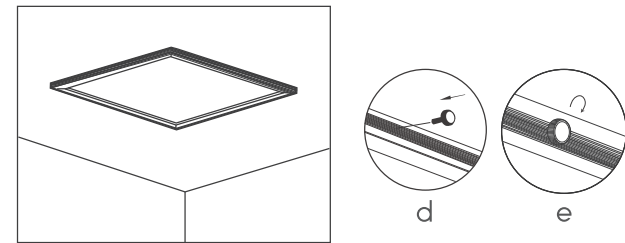

#### Suspended Installation

1. Drill two holes into the ceiling, put the screw anchors into the holes, then insert the wire ropes and screws. **Note: 2 pcs suspension kits needed for installation.**

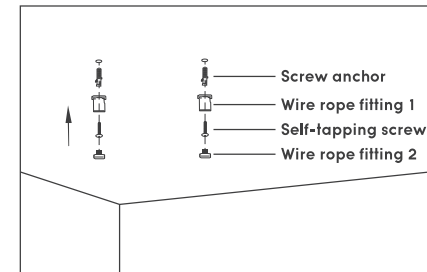

2. Adjust the wire rope to make the panel hang horizontally.

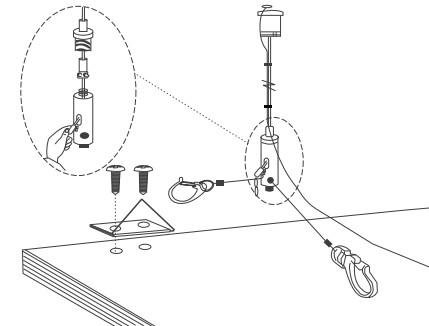

3. The installation is now finished.

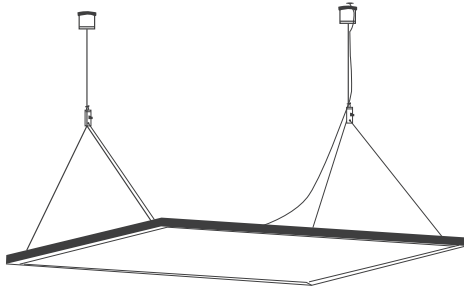

#### Recessed Installation

1. Remove the existing lighting fixture from the ceiling and replace with the LED panel.

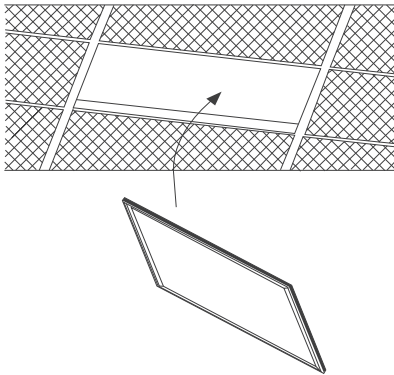

2. For your safety, use the protective brackets. The installation is now complete.

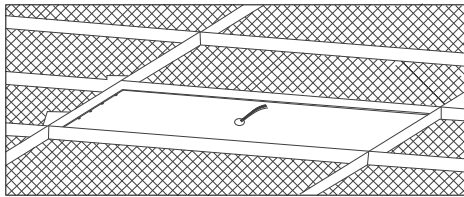

#### 03 / SPECIFICATIONS

LED Panel Light	
Power	40W
Luminous flux	4000lm
Equivalent	300W
Color temperature	5000K Daylight
Voltage	100-277V AC
Beam angle	120°
CRI	Ra>80
Certification	UL
Lifespan	50,000hrs
Working temperature	-4°F-122°F
Dimming range	0-10V
Color	White
Material	Aluminum & MS
Power cord length	5.1 inches

#### 04 / WARNING

**PLEASE READ THE INSTRUCTIONS BEFORE INSTALLING AND RETAIN THEM FOR FUTURE REFERENCE.**

- DO NOT use LED Panels in wet locations.
- PLEASE keep this LED Panel away from any corrosive substance. PLEASE use a dry cloth when cleaning it.
- ONLY qualified electricians can install this LED Panel.
- PLEASE disconnect the power before installing or beginning maintenance to prevent electric shocks.
- All parts MUST be used as was shown in the instructions. DO NOT substitute, leave out or use any broken or worn out parts.

#### 05 / WARRANTY

LEONLITE warrants that this product is free from defects in materials and workmanship for 5 years from the day of purchase. If the product has been misused, damaged by accident or in any other way of improper use, this warranty becomes void.