

Mounting Plate For 3/4/6-Inch Recessed Lighting

User Manual

01 / PACKAGE CONTENT

Mounting plate for 3/4/6-inch recessed lighting × 6

02 / INSTALLATION

1. Choose the proper size according to the size of your downlight. Using pliers cut the joint. (Fig. 1)

Fig. 1

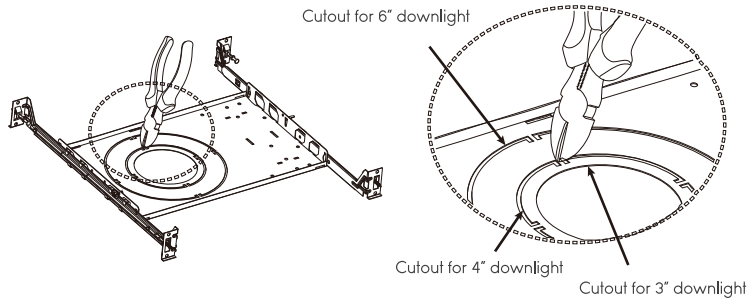

2. Adjust the extendable hanger bars according to your needs. (Adjusting range: 9.06inch-25.20inch) (Fig. 2)

Fig. 2

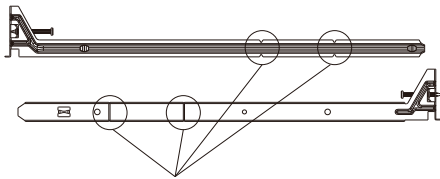

If the extendable hanger bars are too long, adjust the bars' length by cutting the bars on these positions.

3. Extend the extendable hanger bars to fit between the joist. Using the built in leveler align the mounting plate with the bottom of the wood joist. Hammer the step nails into the wood joist to secure the mounting plate. (Fig. 3)

Fig. 3

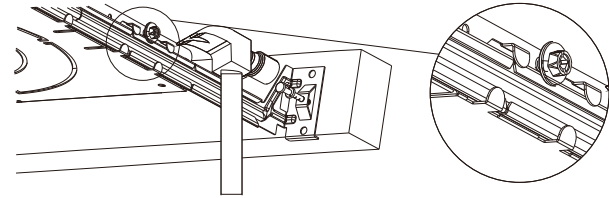

4. The installation is now complete. (Fig. 4)

Fig. 4

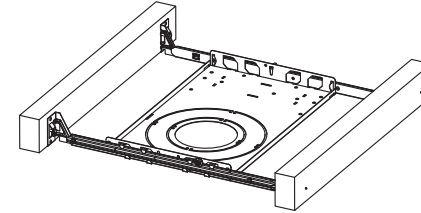

Recessed light size (inch)	3	4	6
Cutout size (inch)	3.00	4.25	6.50

03 / WARRANTY

TORCHSTAR warrants that this product is free from defects in materials and workmanship for a period of 2 years from the day of purchase. If the product has been misused, damaged by accident or in any other way of improper use, this warranty becomes void.

04 / MANUFACTURER CONTACT INFO

Website: www.torchstar.us

E-mail Address: info@torchstar.us

Phone Number: 800-990-7688

TORCHSTAR