

# 83W Dusk To Dawn Floodlight

## User Manual

### 01 / WARNING

CAREFULLY READ AND COMPLETELY UNDERSTAND THIS MANUAL BEFORE INSTALLING OR OPERATING THIS FIXTURE. Retain this manual for future reference.

To reduce the risk of personal injury, death, and/or property damage from fire, electric shock, falling parts, cuts/abrasions, and other hazards, PLEASE read all warnings and instructions included with and on the fixture box and all fixture labels.

1. The installation of this fixture should be performed by a qualified licensed electrician. Maintenance of this fixture should be performed by personnel familiar with the fixture's construction and operation as well as any hazards involved. Regular maintenance programs are recommended.
2. DO NOT install any damaged product! This fixture has been carefully packed so that no parts should be damaged during transit. Thoroughly inspect this fixture for any freight damage; freight damage should be reported to the delivery carrier.
3. This fixture must be wired in accordance with the National Electrical Code and all applicable local codes. Proper grounding is required for safety.
4. All wiring connections should be capped with UL approved & recognized wire connectors.
5. TURN OFF the power supply before installing or performing maintenance on this fixture.
6. DO NOT exceed the max supply voltage or wattage marked on the fixture label.
7. DO NOT exceed the fixture's max ambient temperature or RH.
8. DO NOT use near persons, combustible materials, or substances that are affected by heat or drying.
9. DO NOT place fixtures that are in use face down on a flush surface as this can cause overheating or a fire.
10. ALWAYS wear gloves and safety glasses AT ALL TIMES when removing the fixture from the carton, installing, servicing, or maintaining the fixture.
11. NEVER perform maintenance or clean this fixture while it is energized; allow the fixture to cool before handling.
12. NEVER look directly at the light source while it is on.
13. HANDLE WITH CARE! Improper installation, use, and servicing might damage the product and void the warranty.
14. DO NOT mount or support this fixture in a manner that can cut the outer jacket or damage the wire insulation.
15. DO NOT touch or clean individual LEDs or other electrical components as this can cause Electrostatic Discharge (ESD), damage the fixture, shorten the lifespan, or alter the performance. Personal grounding equipment must be worn at all times when installing or servicing this unit.
16. CHECK the compatibility before wiring any control system that's not factory-wired.
17. THERE ARE NO SERVICEABLE COMPONENTS INSIDE THIS FIXTURE.

### 02 / PACKAGE CONTENT

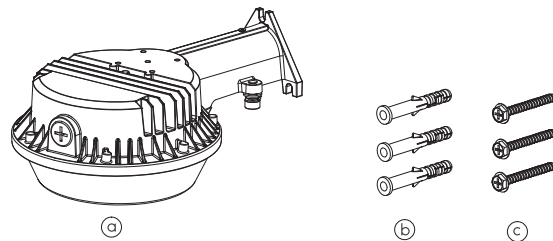

- a. Dusk to dawn floodlight × 1
- b. Plastic anchors × 3
- c. Screws × 3

### 03 / INSTALLATION

1. Using a pencil, mark the position of the 3 mounting holes. Next, drill the mounting holes. Then fix the plastic anchors into the mounting holes. (Fig. 1)

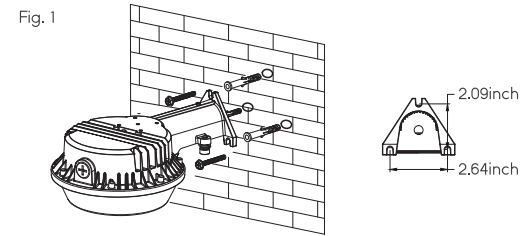

2. Insert two screws into the lower plastic anchors. DO NOT tighten the screws fully.
3. Attach the fixture to the two screws. Then insert the upper screw and tighten it. Next, tighten the lower screws.
4. TURN OFF THE POWER. The wire connections must be electrically insulated in dry locations.
5. Connect the fixture's black wire to the LINE (black) supply lead, the white wire to the NEUTRAL (white) supply lead, and the green wire to the GROUND supply lead. (Fig. 2)

Fig. 2

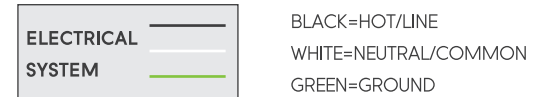

6. Turn the power back on. The installation is now complete.

### 04 / SPECIFICATIONS

83W Dusk To Dawn Floodlight	
Power	83W
Voltage	120-277V
Working temperature	-4°F-104°F
Luminous flux	9790lm
Color temperature	3000K Warm White   5000K Daylight
Material	Aluminum & PC
Beam angle	144°

### 05 / WARRANTY

TORCHSTAR warrants that this product is free from defects in materials and workmanship for a period of 5 years from the day of purchase. If the product has been misused, damaged by accident or in any other way of improper use, this warranty becomes void.

### 06 / MANUFACTURER CONTACT INFO

Website: [www.torchstar.us](http://www.torchstar.us)  
E-mail Address: [info@torchstar.us](mailto:info@torchstar.us)  
Phone Number: 800-990-7688

# TORCHSTAR