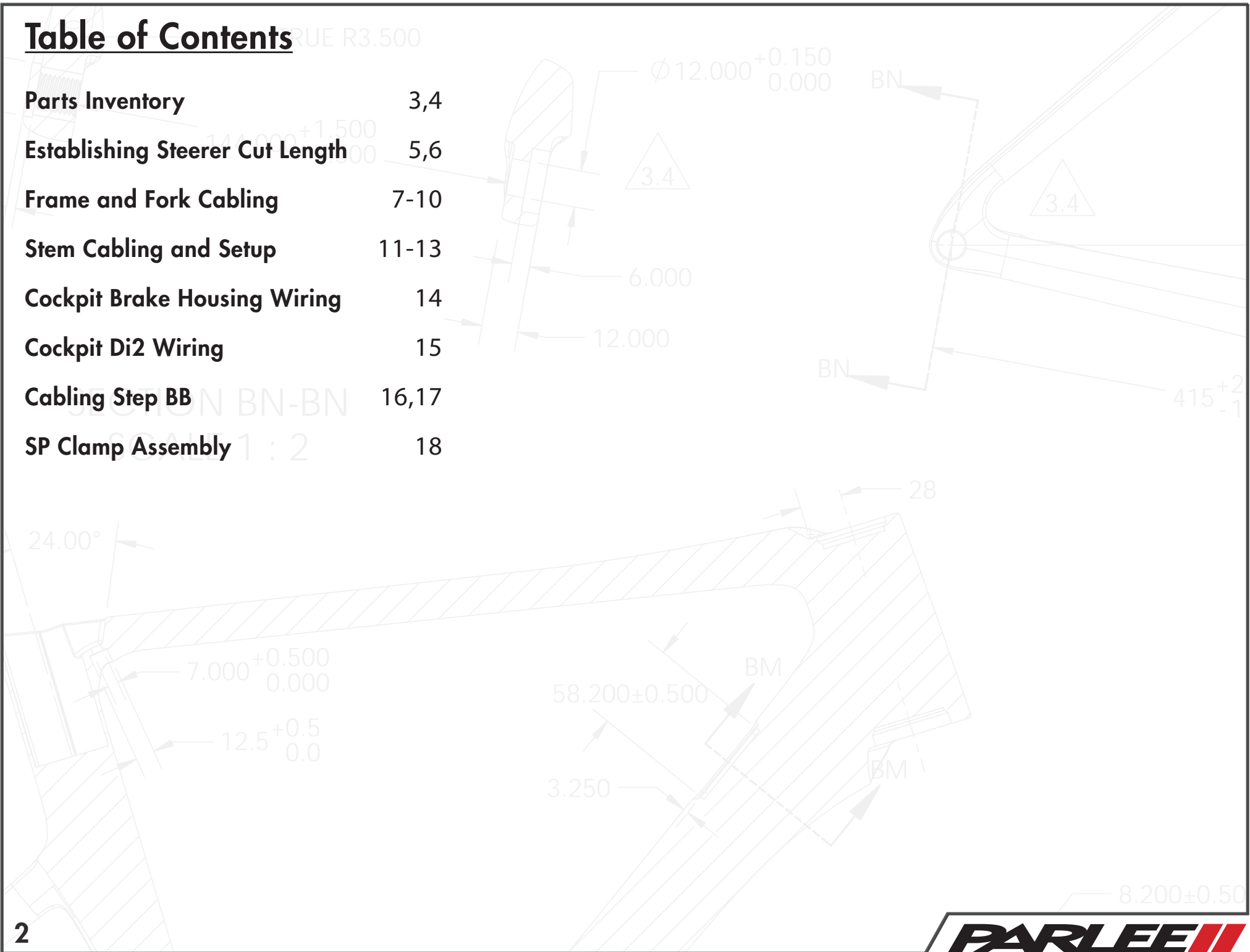

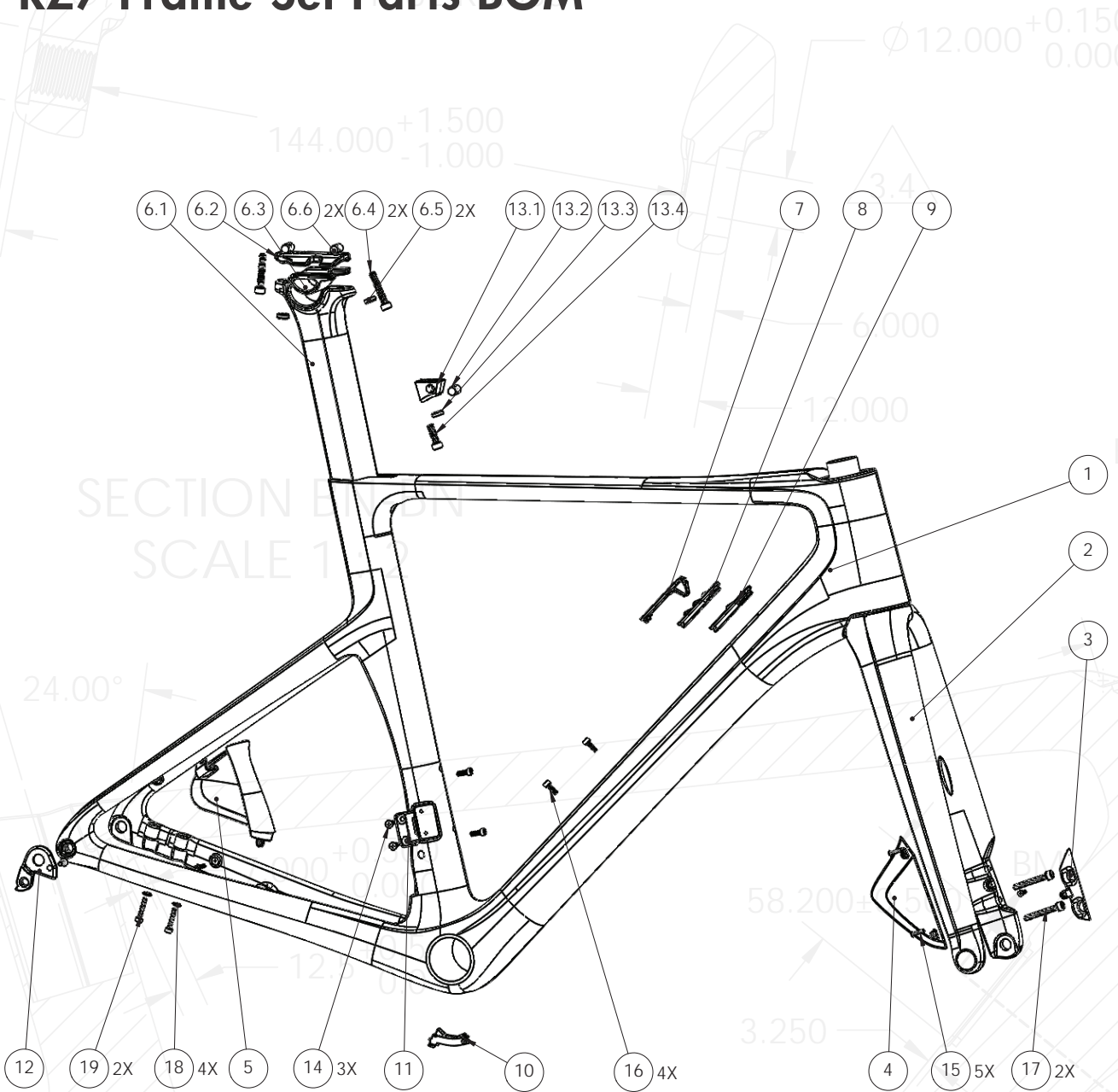

Table of Contents

Parts Inventory	3,4
Establishing Steerer Cut Length	5,6
Frame and Fork Cabling	7-10
Stem Cabling and Setup	11-13
Cockpit Brake Housing Wiring	14
Cockpit Di2 Wiring	15
Cabling Step BB	16,17
SP Clamp Assembly	18



RZ7 Frame-Set Parts BOM



ITEM NO.	PART	PART NUMBER	QTY.
1	RZ7 Frame		1
2	RZ7 Fork		1
3	Fork Blade Plug	PCZ7-20#	1
4	Fork Caliper Fairing	PCZ7-19#	1
5	Rear Caliper Fairing	PCZ7-18#	1
6	RZ7 Seatpost Assembly		1
6.1	RZ7 Seatpost		1
6.2	SP Cradle Top	PCZ7-3#	2
6.3	SP Cradle Bottom	PCZ7-4#	2
6.4	M6 x 40L	PCZ7-30#	2
6.5	M6 Conical WASHER	PCZ7-6#	2
6.6	M6 Barrel Nut	PCZ7-8#	2
7	DT Blanking Panel	PCZ7-12#	1
8	DT Mech/Brake Cable	PCZ7-10#	1
9	DT Brake Di2 Guide	PCZ7-11#	1
10	BB Cable Guide	PCZ7-13#	1
11	Parlee FD mount	PC-F-2#	1
12	RZ7 RDH	PCZ7-14#	1
13	RZ7 SP Wedge	PCZ7-8#	1
13.1	SP Wedge	PCZ7-6#	1
13.2	M6 Barrel Nut R1	PCZ7-6#,7#	1
13.3	M6 Conical WASHER	PCZ7-9#	1
13.4	M6 x 20L	PCZ7-29#	1
14	Steerer Cable Guide	PCZ7-28#	1
15	RZ7 Blind Grommet R1	PC-F-38#	1
16	Mech Cable Grommet	PCZ7-40#	1
17	BEC- Di2 (grommet)		1
18	M4 x .7 x 10 L Flat Head	PCZ7-39#	3
19	M3 Flat Head 14mm	PCZ7-31#	5
21	M5 x 40	PCZ7-30#	2
22	M5 Washer	PC-S-5#	9
23	M5 x 15 L Pan Head	PC-F-48#	2

RZ7 Cockpit Parts BOM

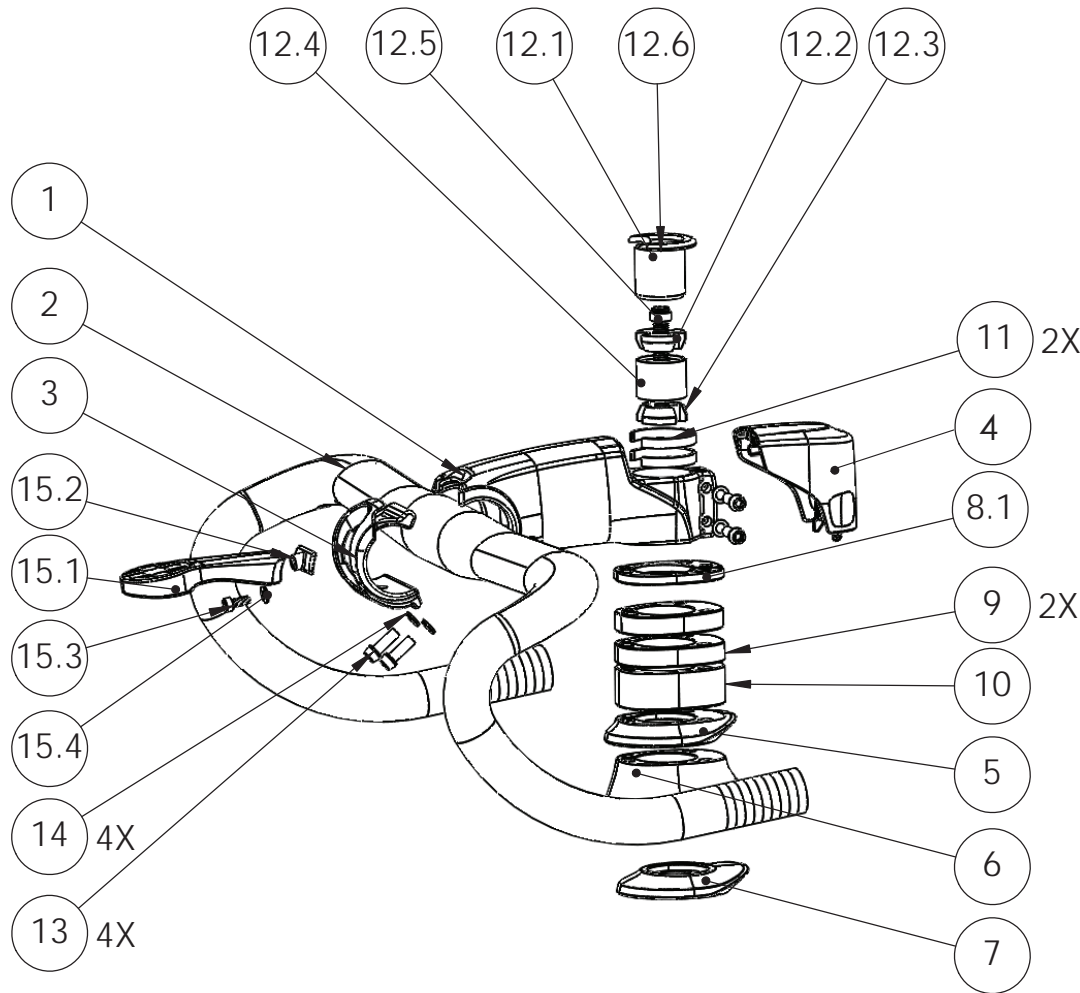

ITEM NO.	PART	Part Number	QTY.
1	RZ7 Stem -100 (-90, -110, -120)		1
2	Parlee Handlebar - 44, 42 ,40, cm	PCHB-01-420	1
3	Rz7 Stem Faceplate	PCZ7-27#	1
4	RZ7Stem Cap	PCZ7-21#	1
5	RZ7 Top Cap 11mm	PCZ7-17#	1
6	RZ7 Top Cap 25mm	PCZ7-23#	1
7	RZ7 Top Cap 11mm Round	PCZ7-22#	1
8	RZ7 Stem Spacer 5mm	PCZ7-24#	2
9	RZ7 Stem Spacer 10mm	PCZ7-25#	2
10	RZ7 Stem Spacer 20mm	PCZ7-26#	1
11	32mm ID round spacer Split	PCRZ-33	2
12	RZ7 Compression Plug R	PCZ7-16#	1
12.1	C Plug Top Hat R11	PCZ7-16#	1
12.2	RR C Plug Top Wedge R4	PCZ7-16#	1
12.3	C Plug Bottom Wedge R4	PCZ7-16#	1
12.4	C Plug Expander R3	PCZ7-16#	1
12.5	M8 (M5 Internal Thread)	PCZ7-16#	1
12.6	M5 x 20L	PCZ7-16#	1
12.7	M5 Washer	PCZ7-16#	1
13	M5 x 15 L Titanium screw	PC-S-2#	4
14	M5 Washer	PC-S-5#	4
15	RZ7 Stem Computer Mount		
15.1	RZ7 Computer Mount	PCZ7-33#	1
15.2	RZ7 Computer Mount Nut	PCZ7-34#	1
15.3	M4 x 8 mm L Screw	PCZ7-35#	1
15.4	M4 Washer	PCZ7-37#	1

Establishing Steerer Cut Length

A. To arrive at proper steerer cut length it is important to understand how the split spacer system works. Two 5mm aero split spacers sit underneath the stem that can be removed to adjust stack without removing the stem or cabling.

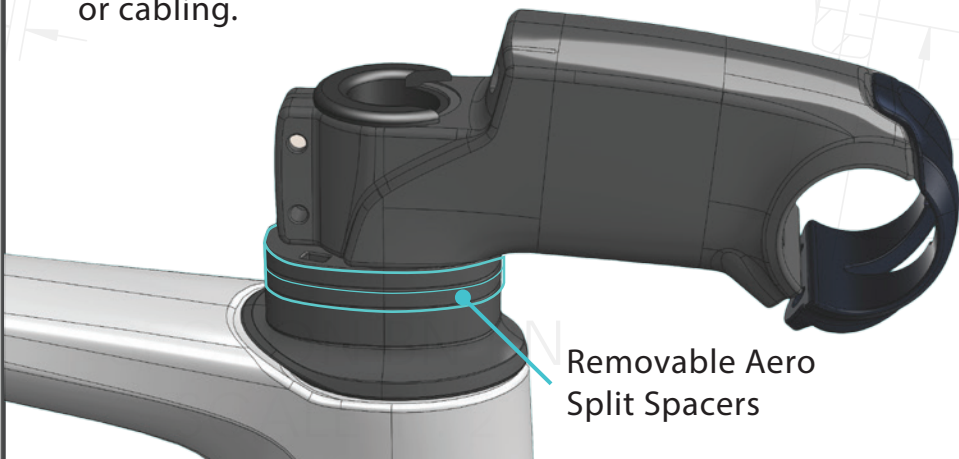

B. To remove 5mm spacers loosen compression plug top cap bucket, and loosen stem bolts at steerer and lift stem about 1cm. Now you can open the hinged spacers allowing them to be removed from steerer.

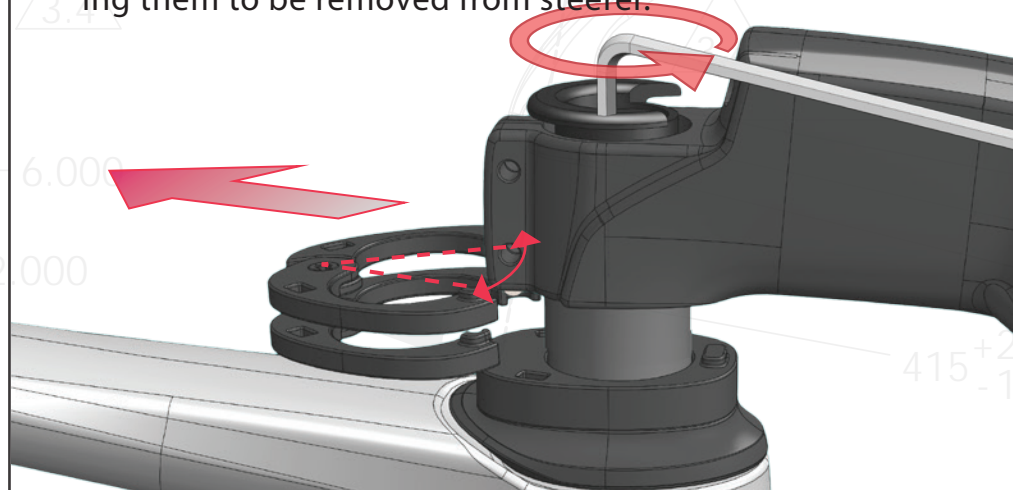

C. Now the split round spacers can be snapped into place around steerer.

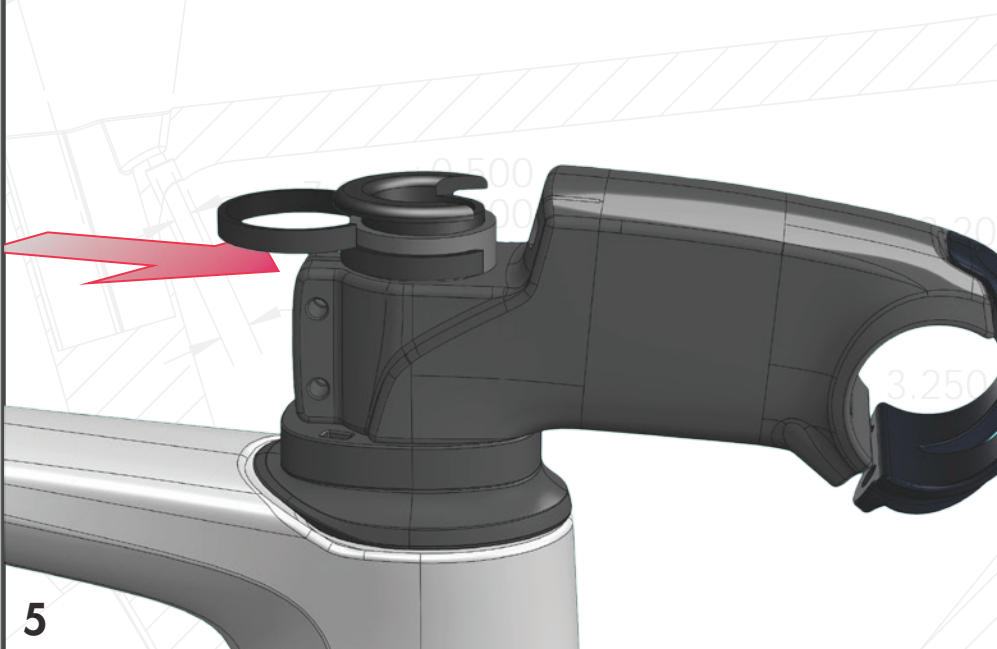

D. The top cap bucket is then re tightened along with stem bolts. The cockpit stack has now been reduced by 10mm. This operation can also be done in 5mm increments.

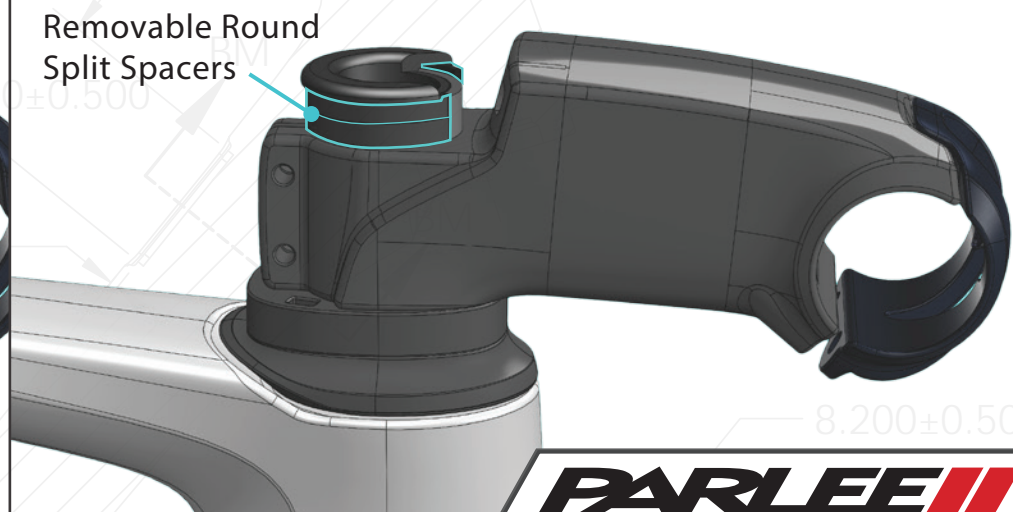

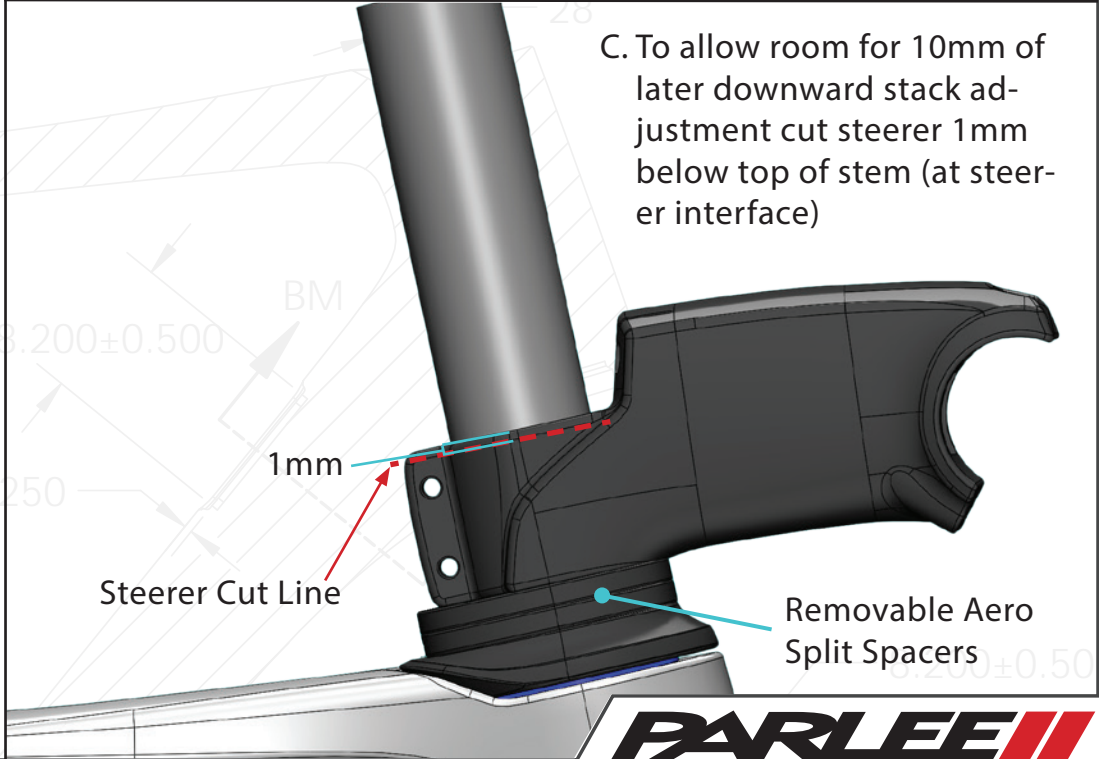
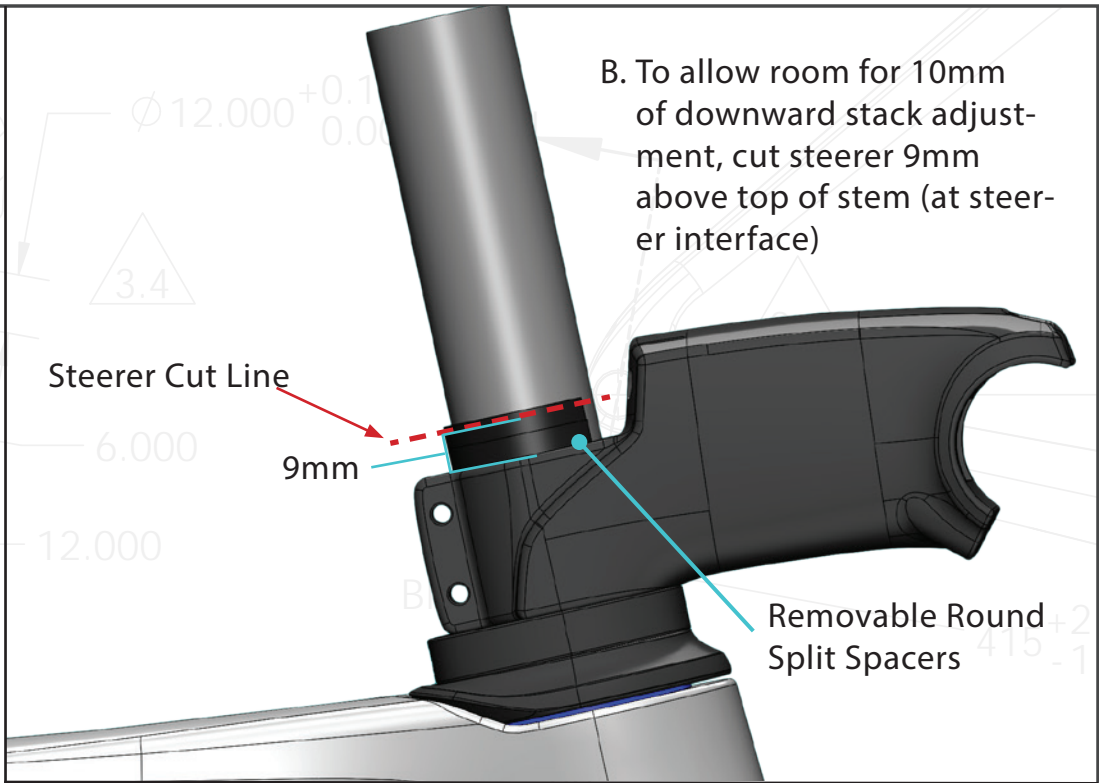
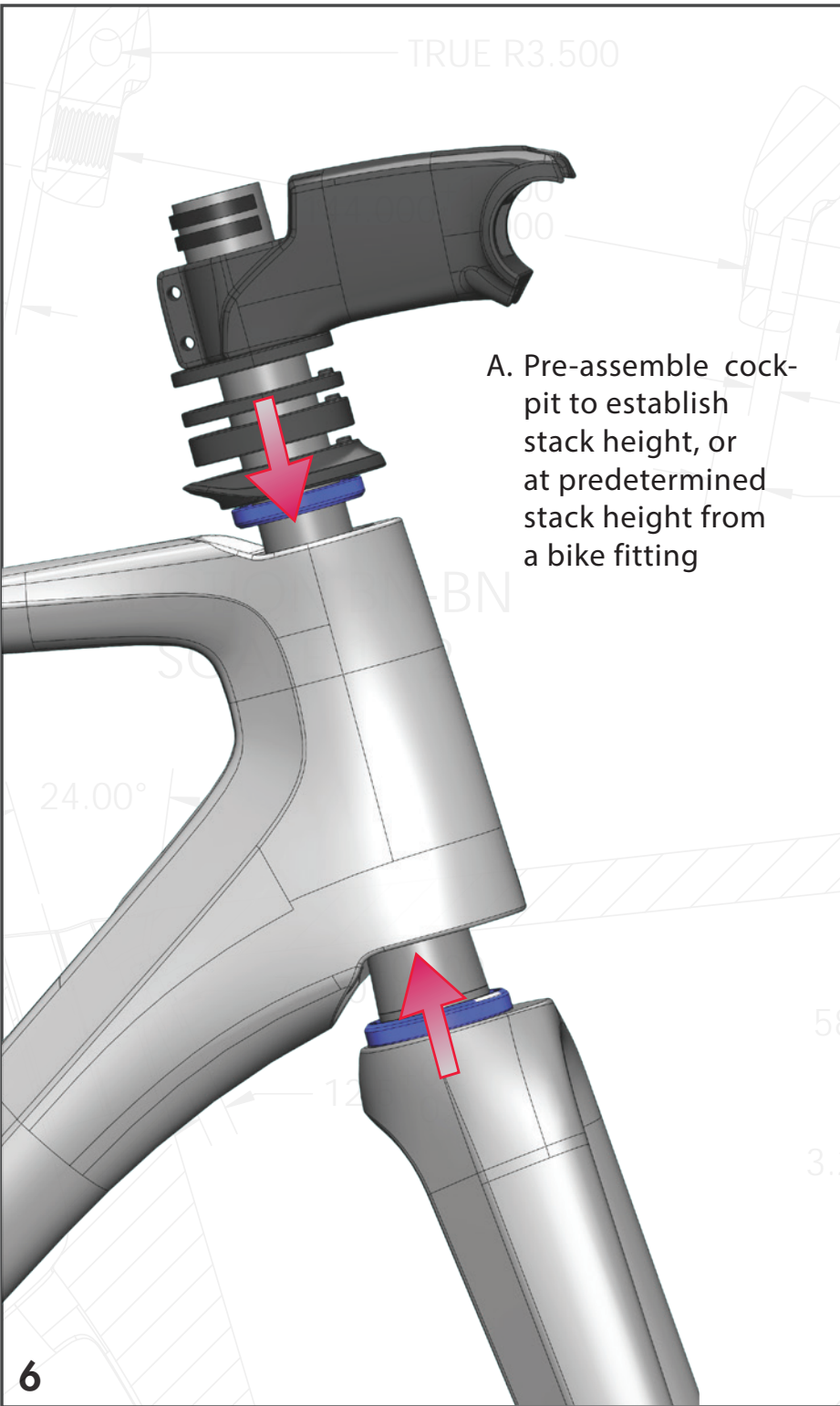

Frameset Cabling

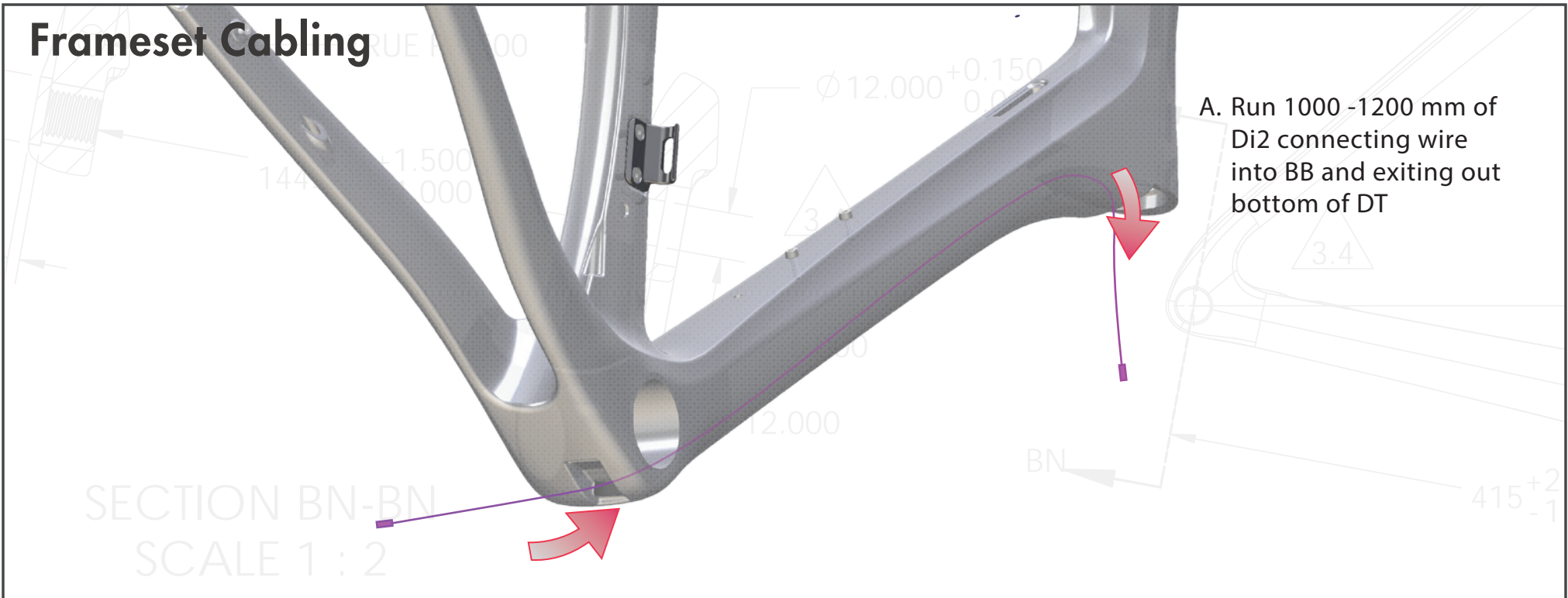

A. Run 1000 -1200 mm of Di2 connecting wire into BB and exiting out bottom of DT

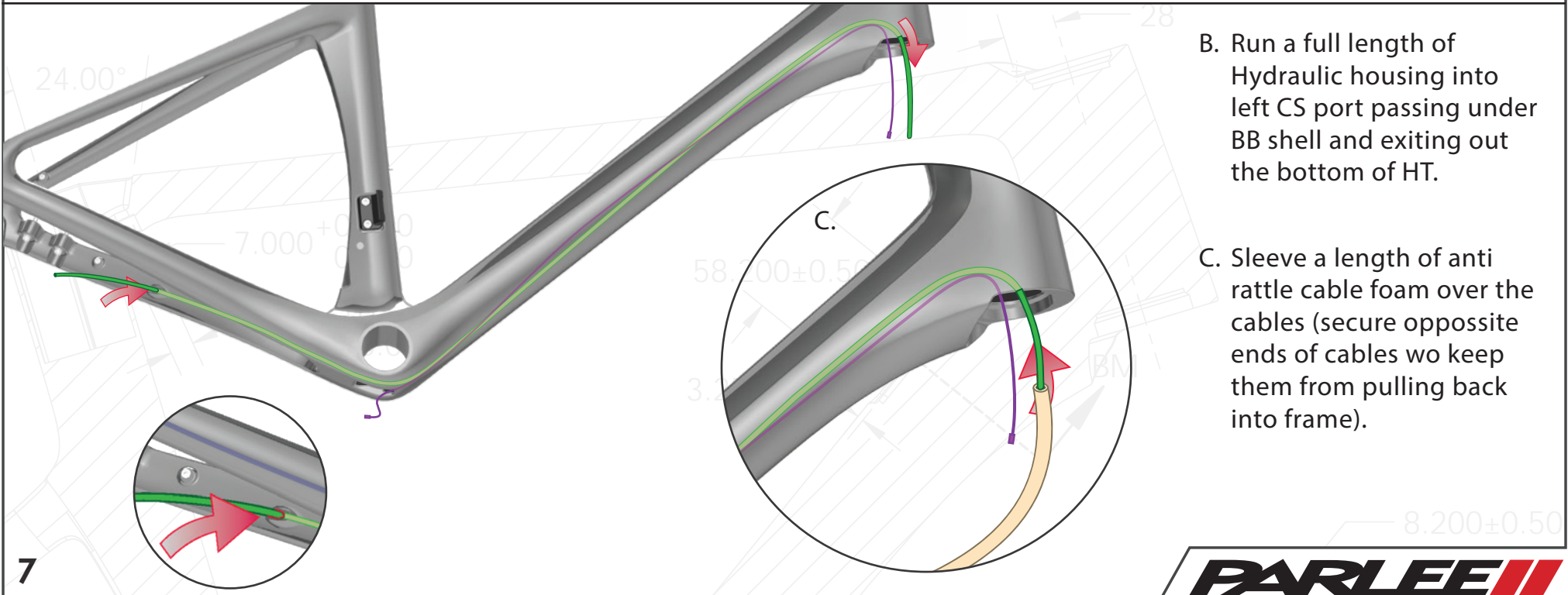

B. Run a full length of Hydraulic housing into left CS port passing under BB shell and exiting out the bottom of HT.

C. Sleeve a length of anti rattle cable foam over the cables (secure opposite ends of cables to keep them from pulling back into frame).

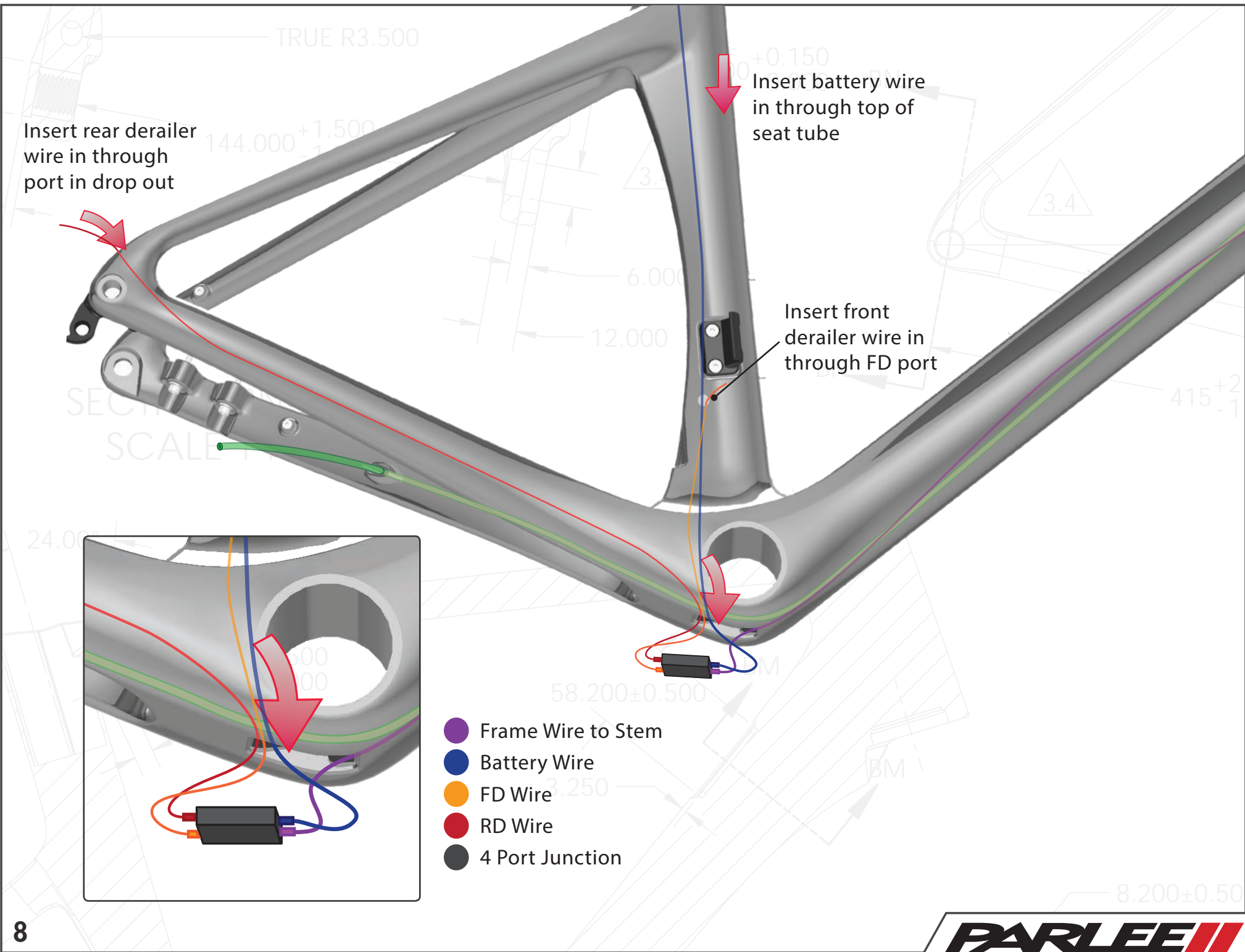

Insert rear derailer wire in through port in drop out

Insert battery wire in through top of seat tube

Insert front derailer wire in through FD port

- Frame Wire to Stem
- Battery Wire
- FD Wire
- RD Wire
- 4 Port Junction

A. Assemble 1.5" bottom bearing over steerer tube and seat on fork crown race



B. Push snap-in steerer cable guide into oblong hole in back of steerer tube



C. Insert rear brake cable and Di2 wire into hole in steerer leaving enough cable length outside of steerer and frame to allow maneuvering of fork under and into bottom of HT

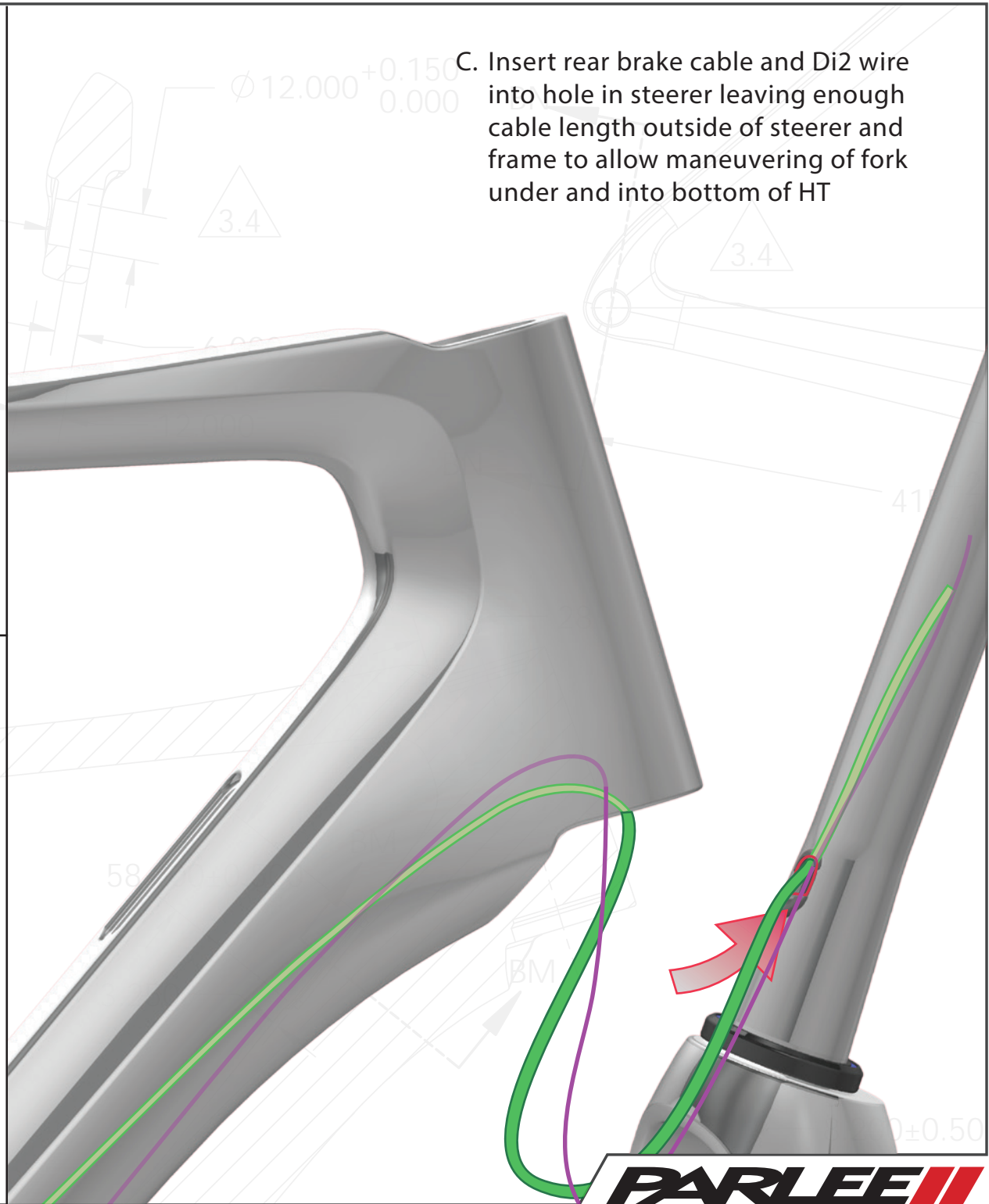

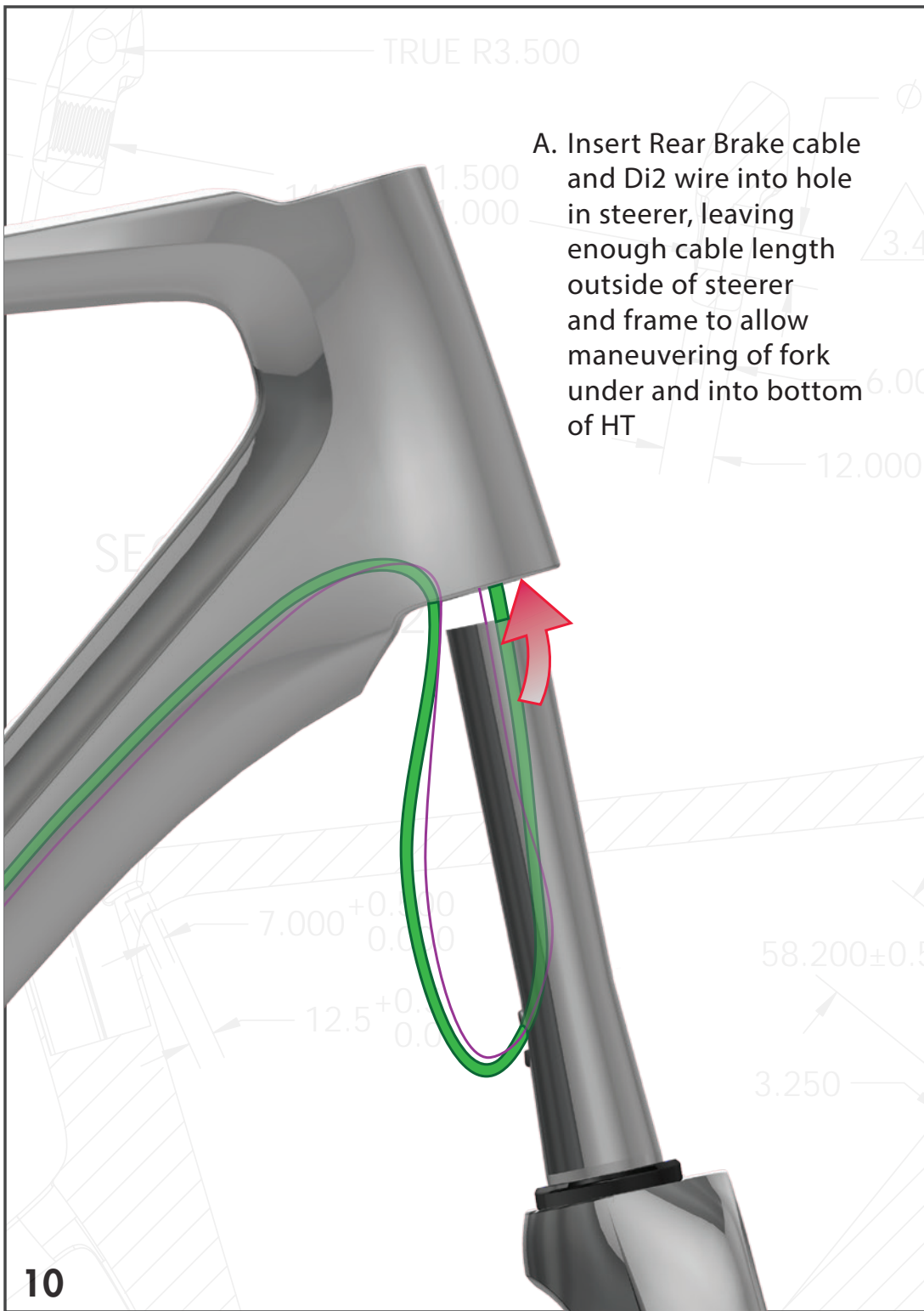

A. Insert Rear Brake cable and Di2 wire into hole in steerer, leaving enough cable length outside of steerer and frame to allow maneuvering of fork under and into bottom of HT

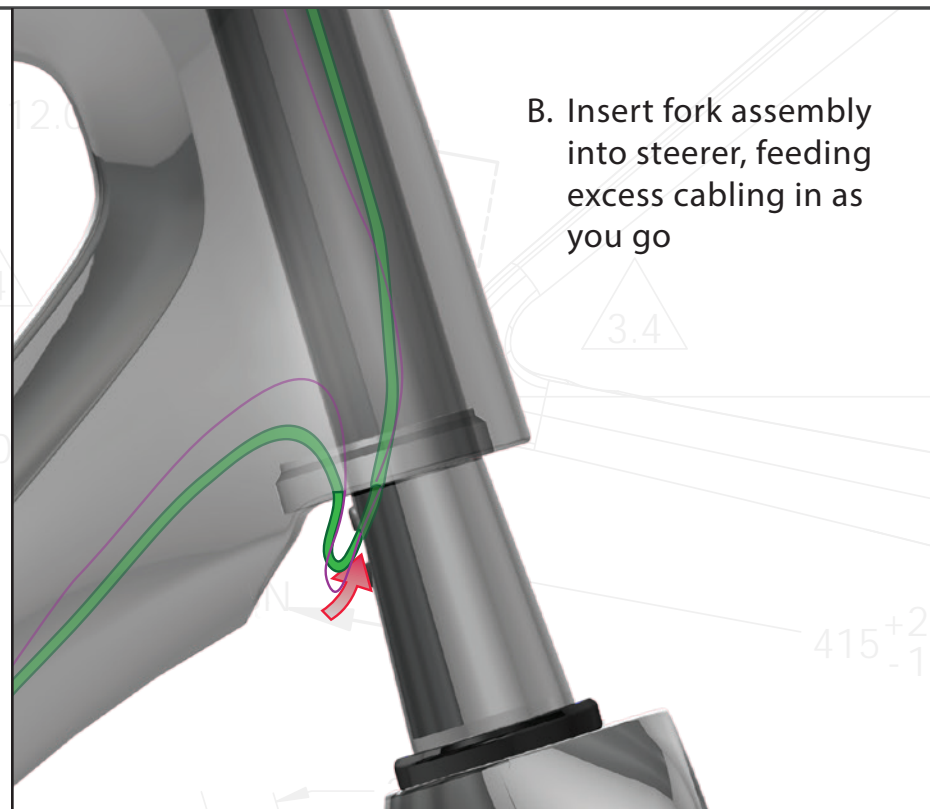

B. Insert fork assembly into steerer, feeding excess cabling in as you go

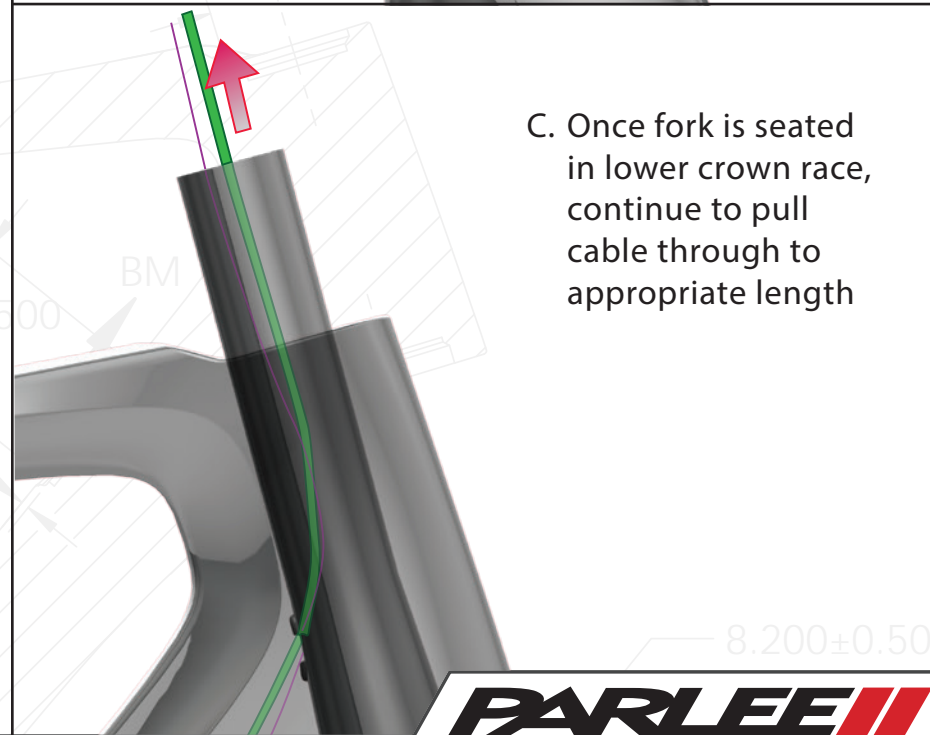

C. Once fork is seated in lower crown race, continue to pull cable through to appropriate length

Stem Cabling and Setup

A. Assemble upper 1.25" bearing and appropriate top cap and spacers over steerer

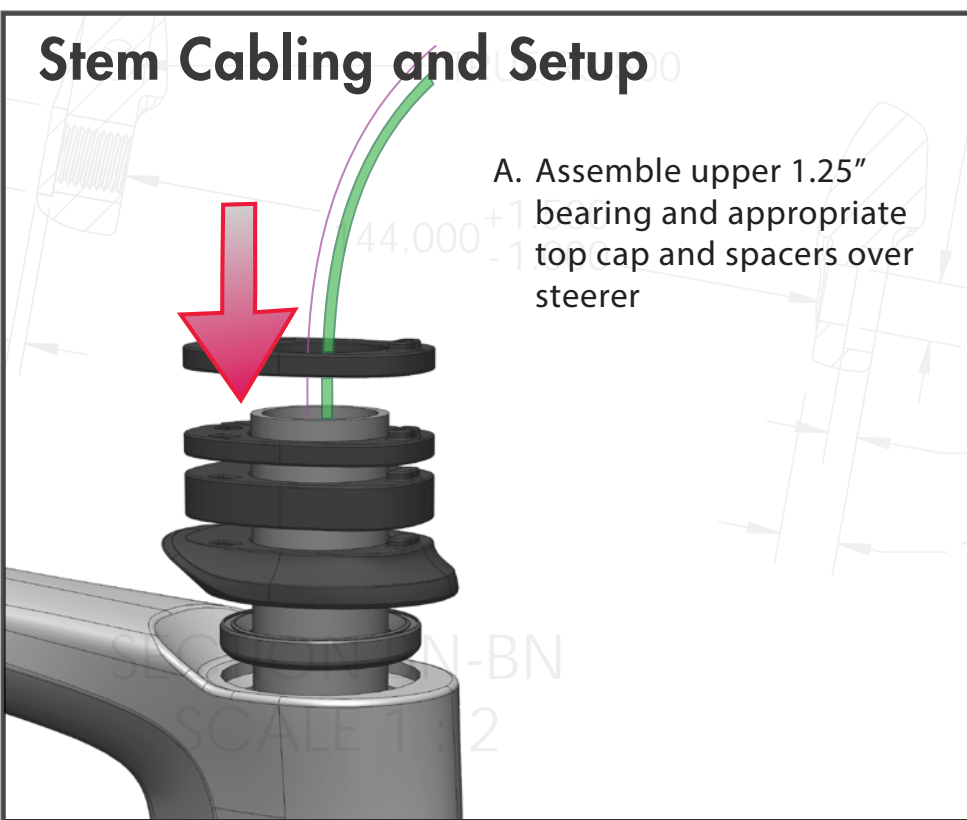

B. Assemble stem onto steerer

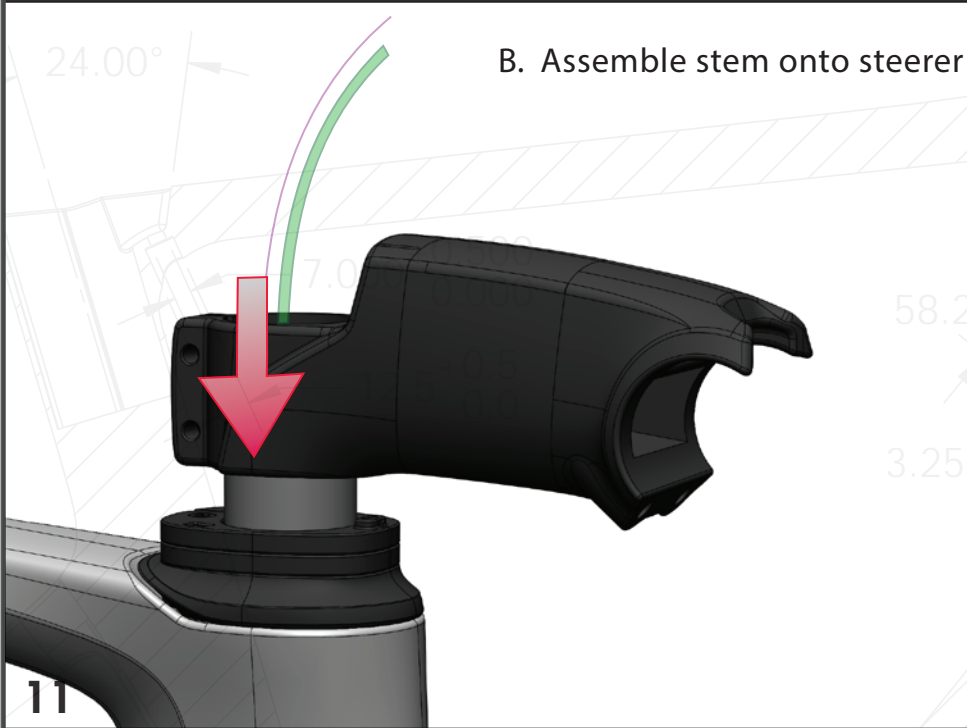

C. Once fork is seated in lower crown race continue to pull cable through to appropriate length

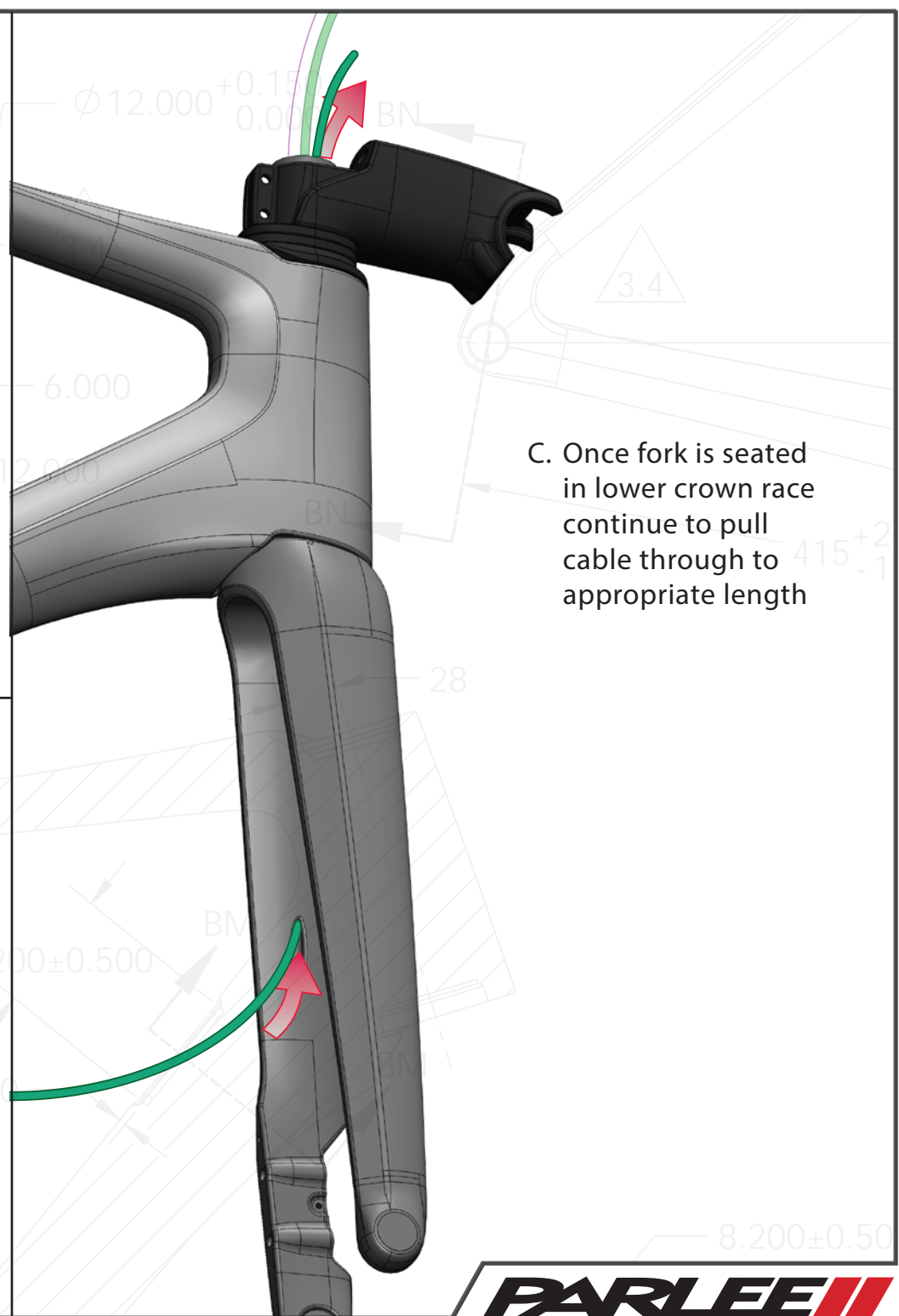

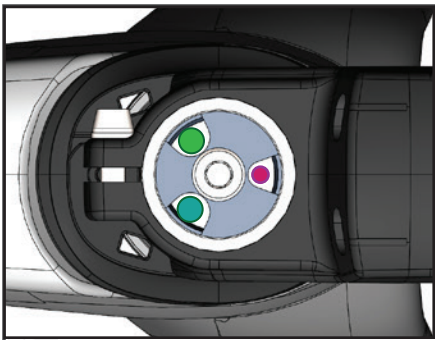

- Rear Brake Cable
- Front Brake Cable
- Di2 Cable

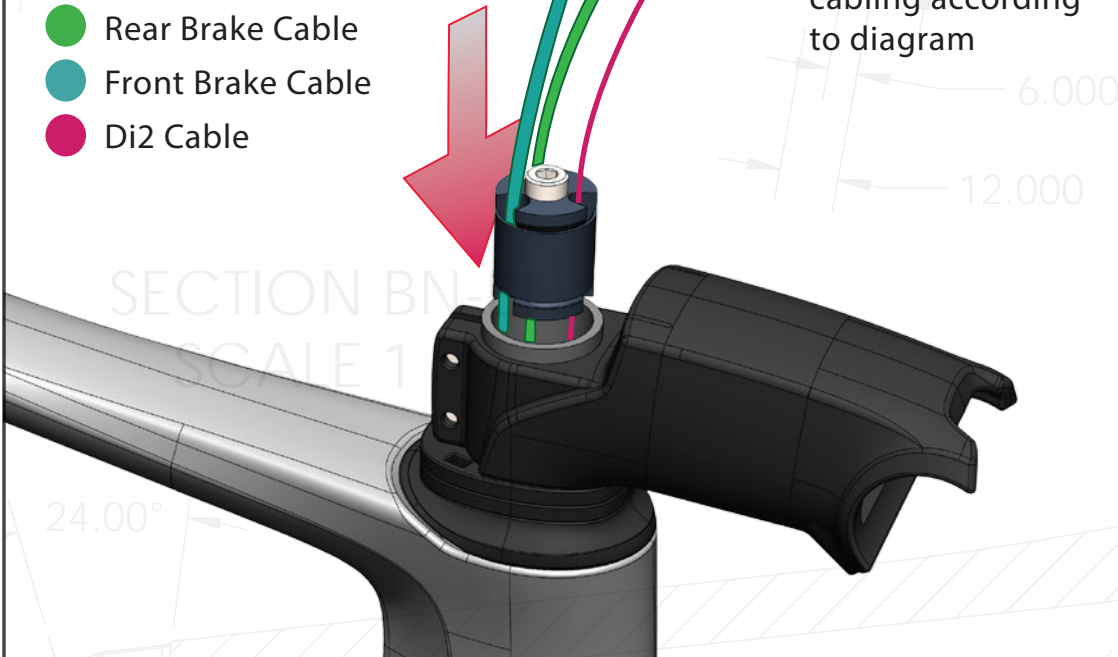

A. Insert compression plug bottom wedge assembly, routing cabling according to diagram

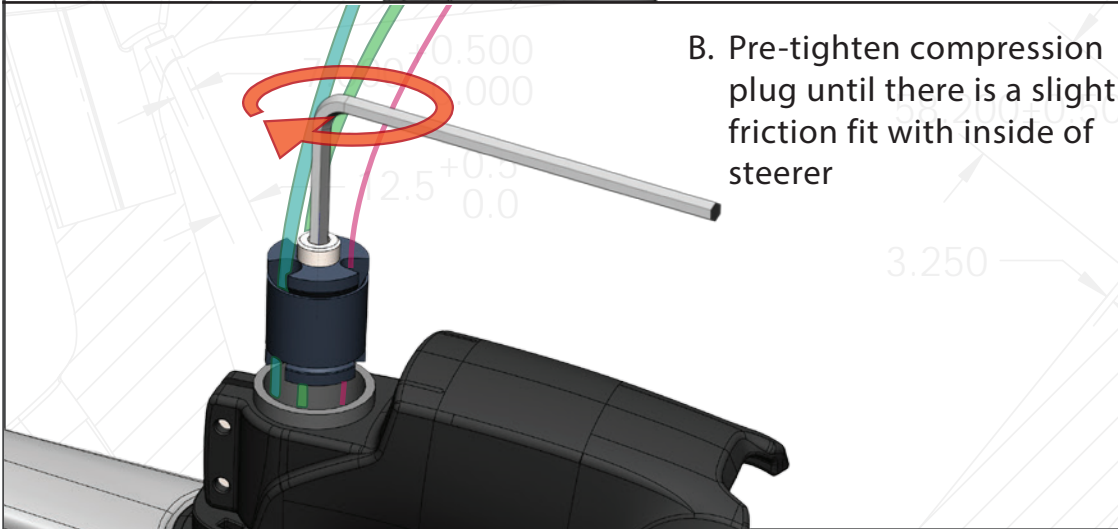

B. Pre-tighten compression plug until there is a slight friction fit with inside of steerer

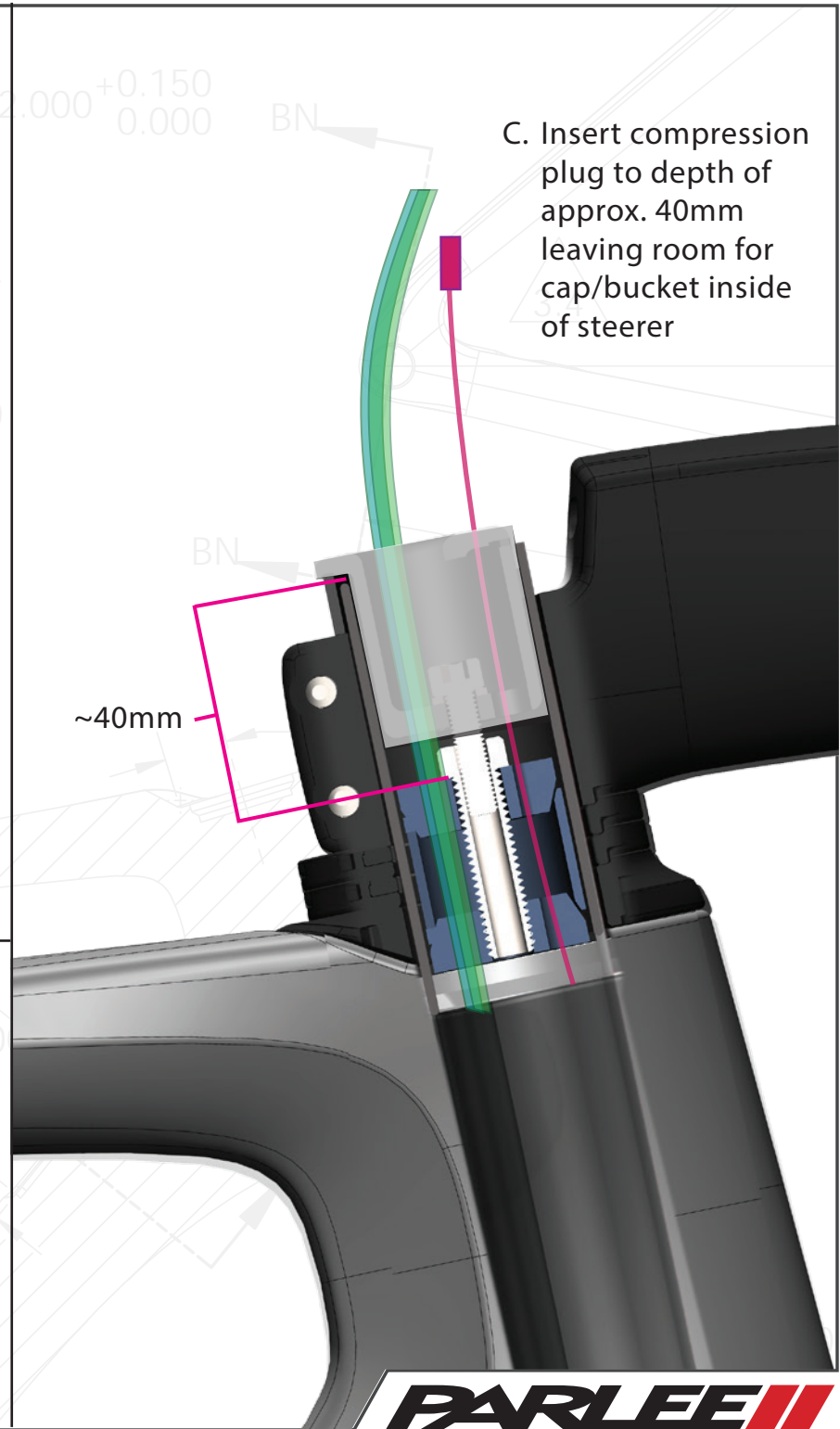

C. Insert compression plug to depth of approx. 40mm leaving room for cap/bucket inside of steerer

A. Insert an M3 wrench into the Di2 cable hole to keep compression plug centered while tightening the M8 Bolt until wedge assembly is snug inside of steerer

M6 Wrench
M3 Wrench

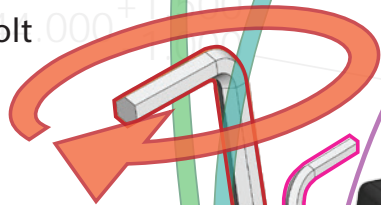

C. Insert Top Cap Bucket with M5 screw over cables and into steerer

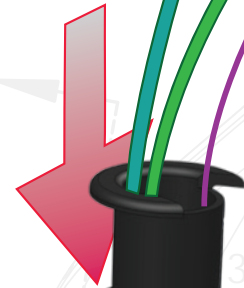

B. Using a torque wrench tighten M8 Bolt to 6Nm



D. Hand Tighten with M4 Wrench until desired headset compression is achieved

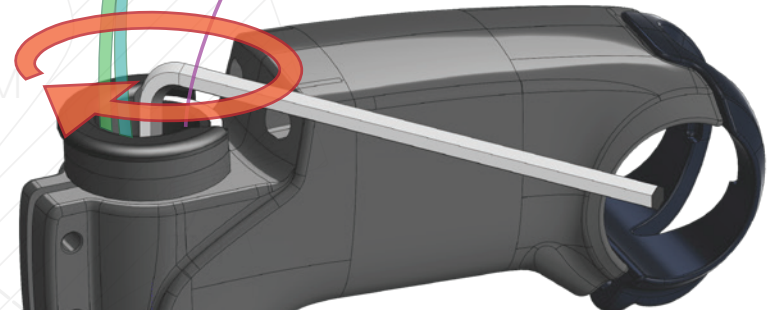

Cockpit Brake Housing Wiring

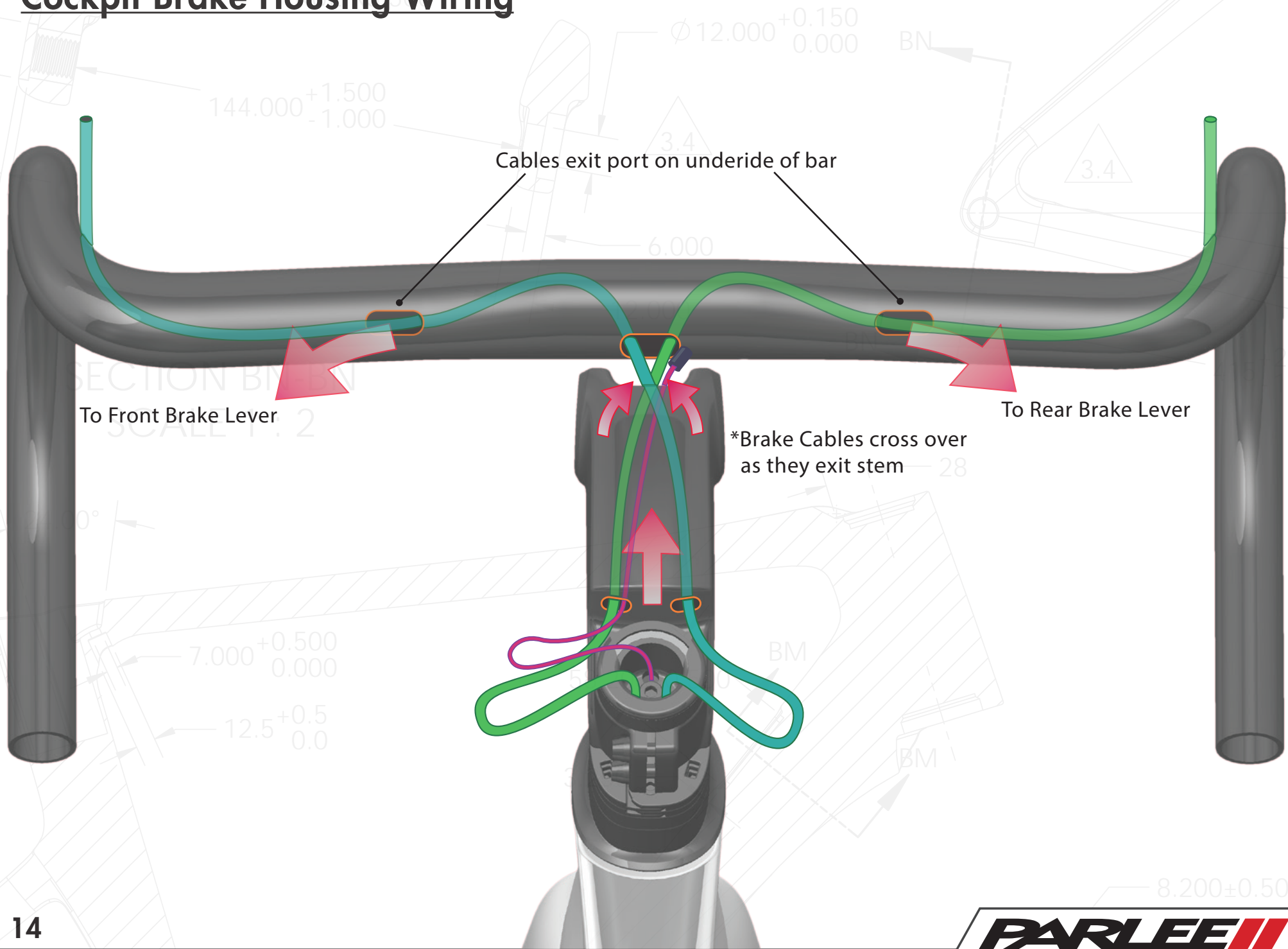

Cockpit Di2 Wiring

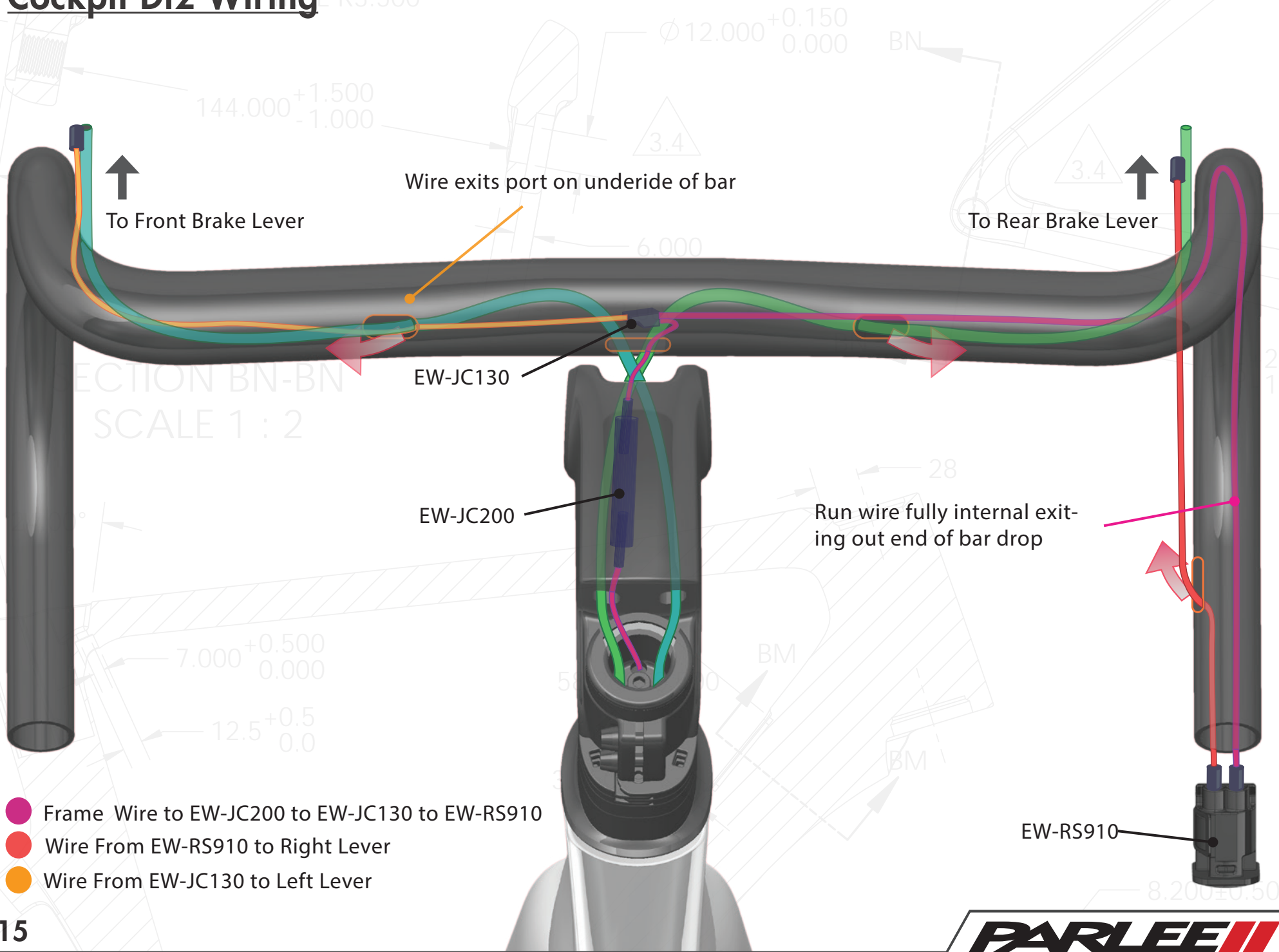

- Frame Wire to EW-JC200 to EW-JC130 to EW-RS910
- Wire From EW-RS910 to Right Lever
- Wire From EW-JC130 to Left Lever

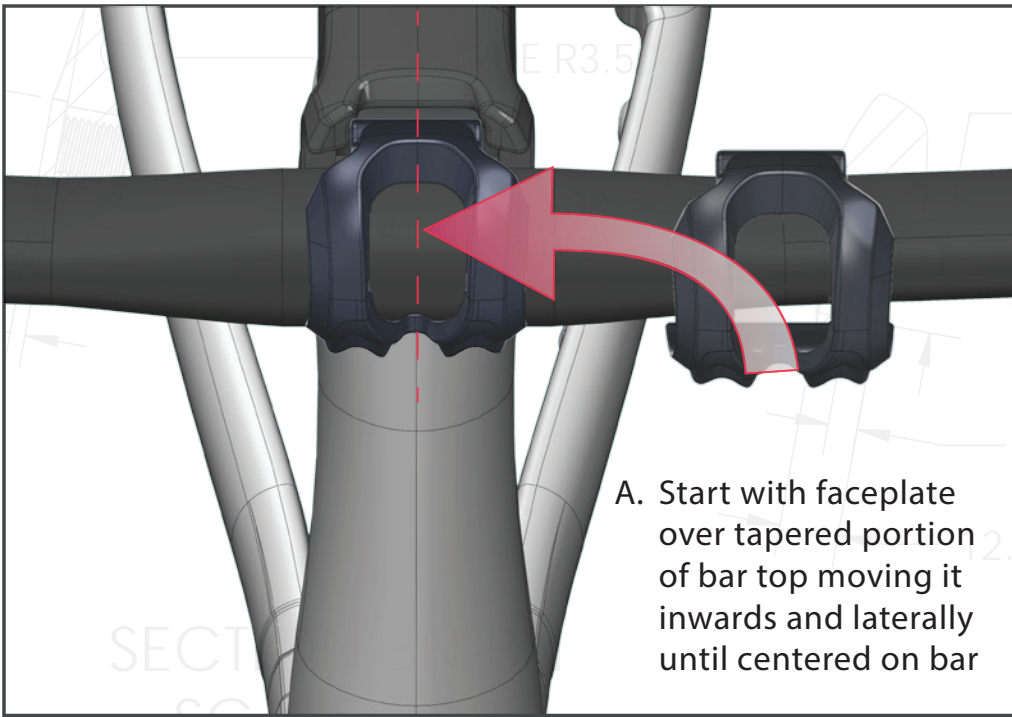

A. Start with faceplate over tapered portion of bar top moving it inwards and laterally until centered on bar

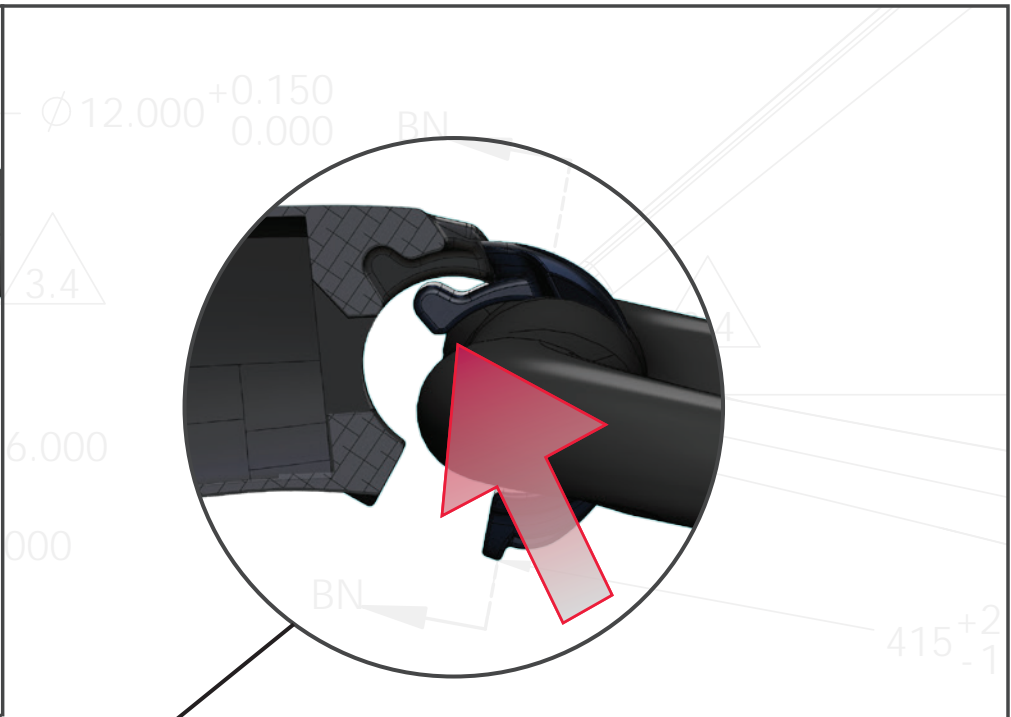

B. Install bar and faceplate at an upward angle until locking feature at top of faceplate nests with matching female feature on stem

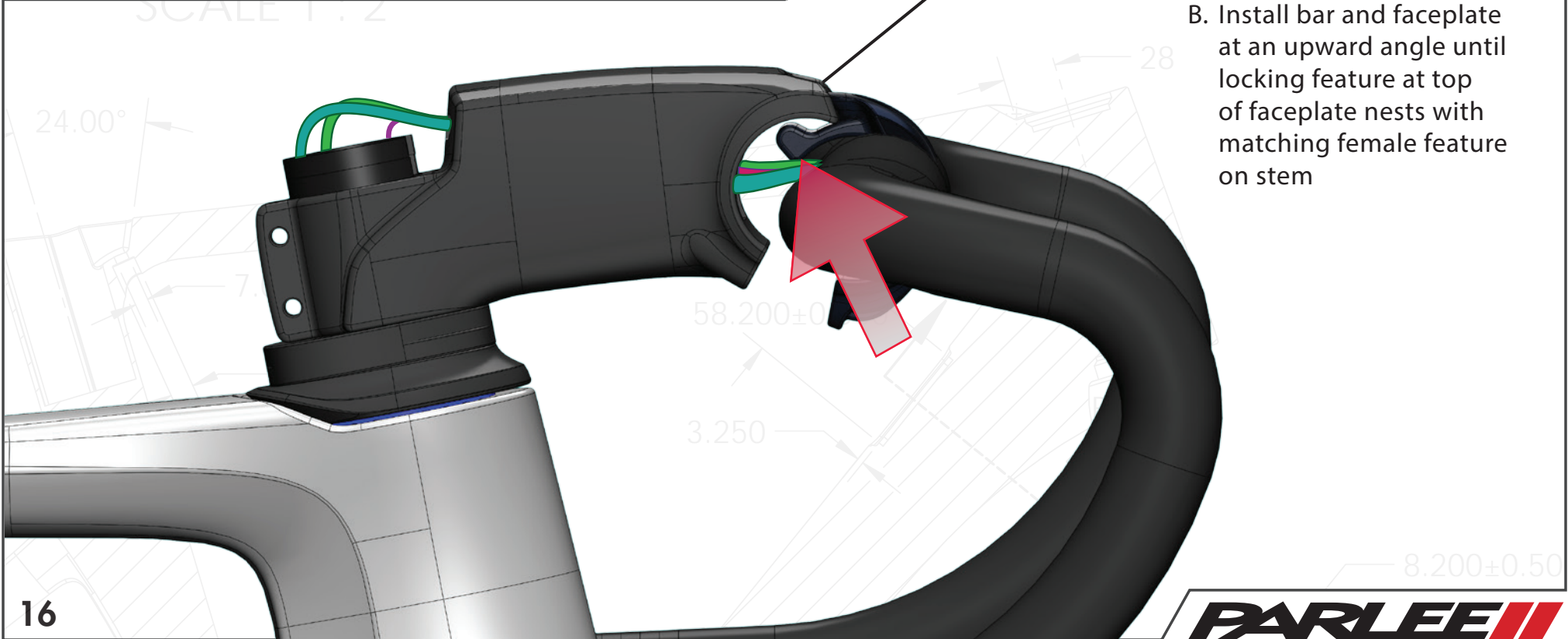

Cabling Step, BB

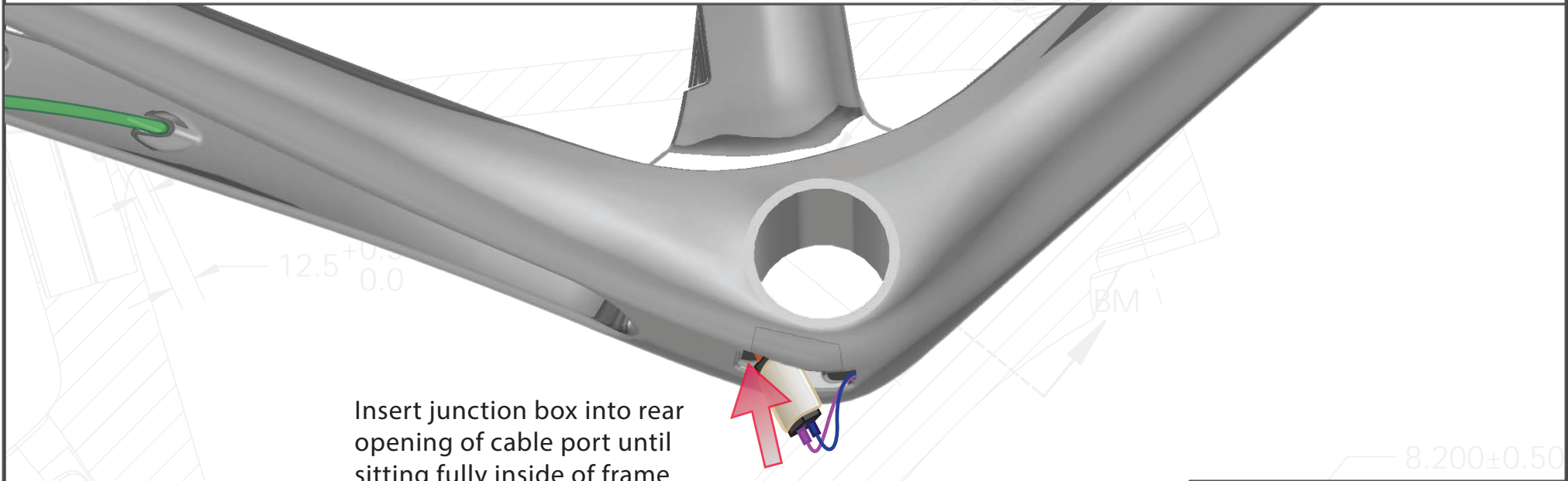
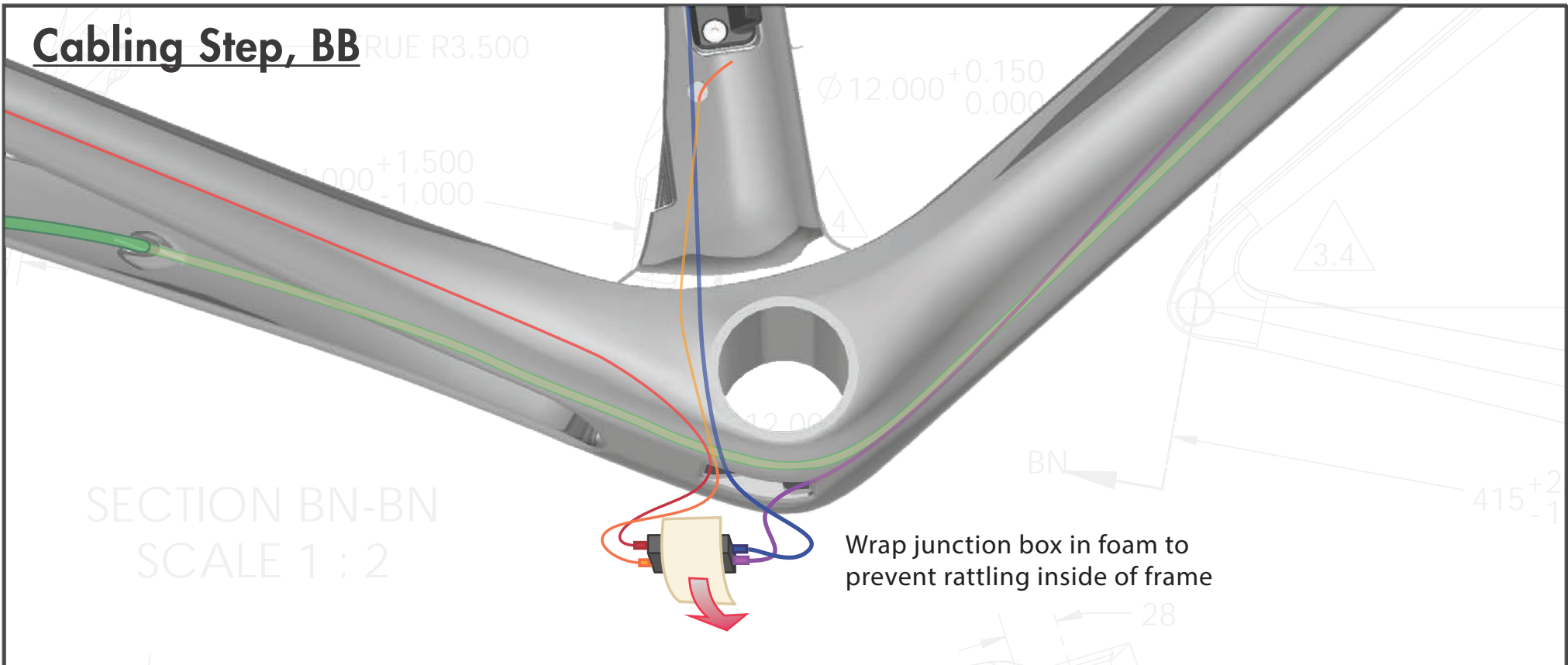

Insert junction box into rear opening of cable port until sitting fully inside of frame

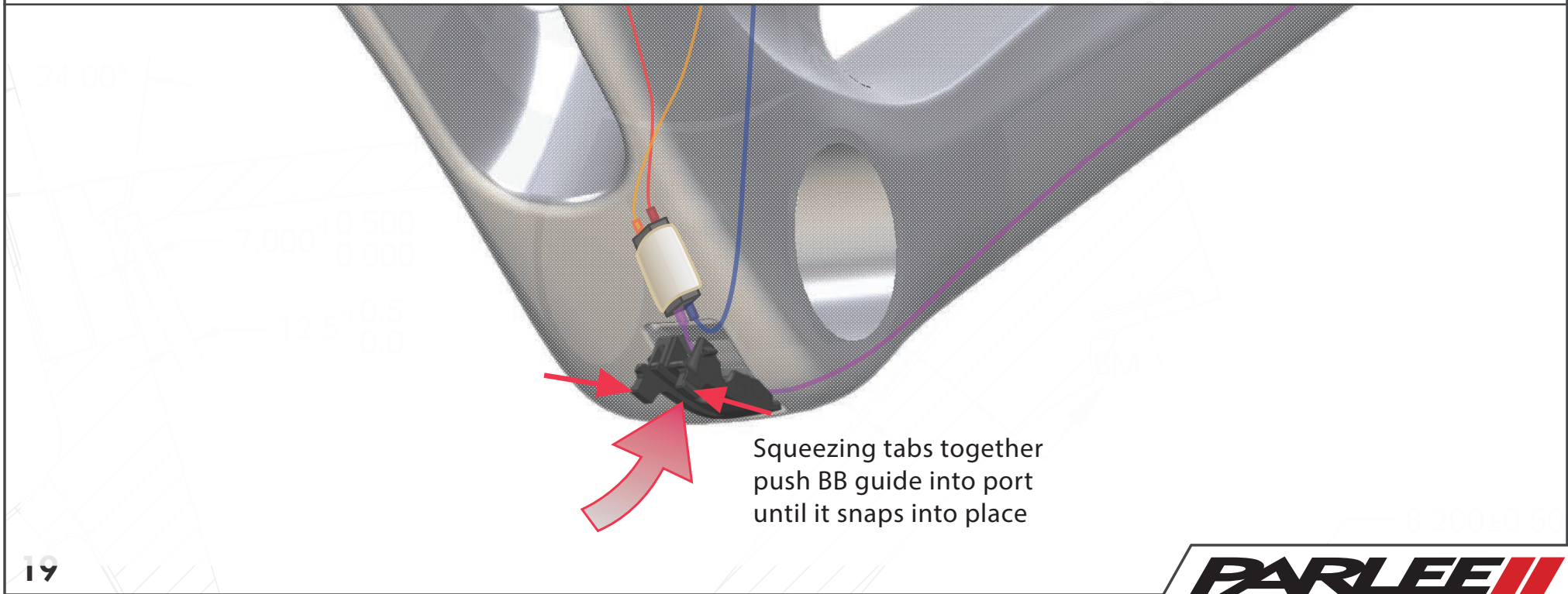
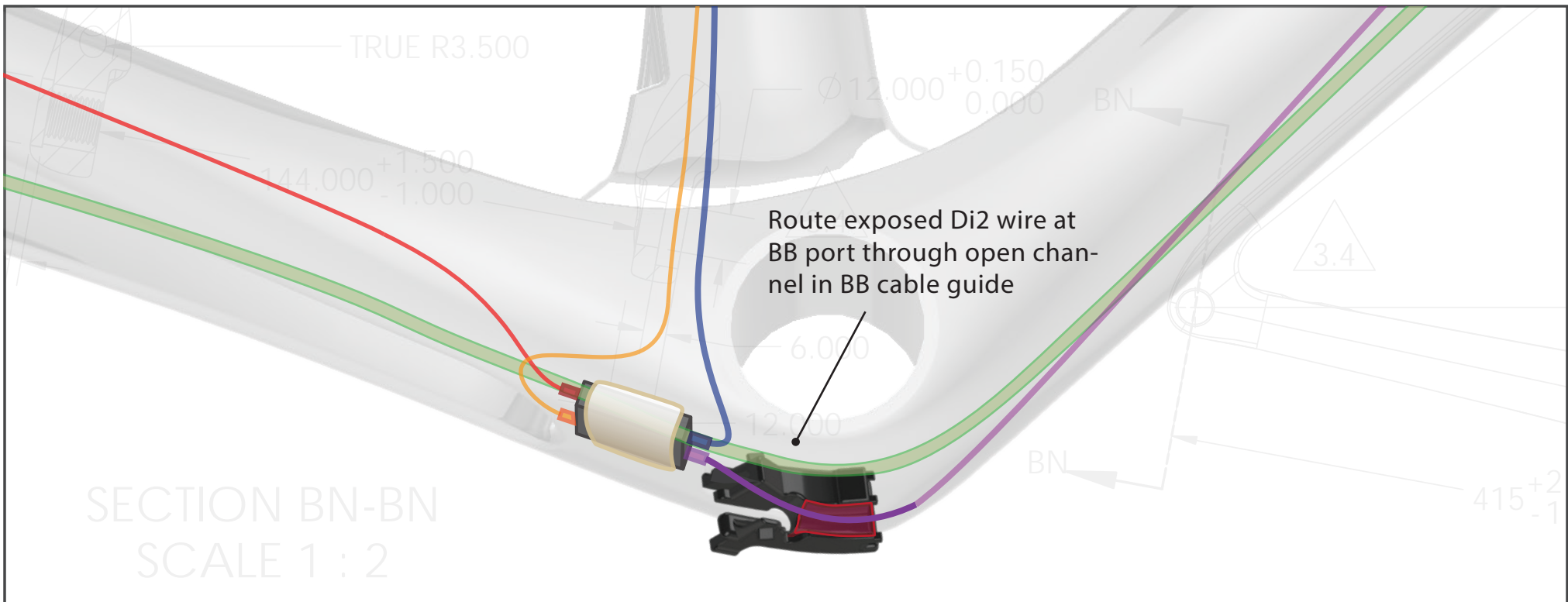

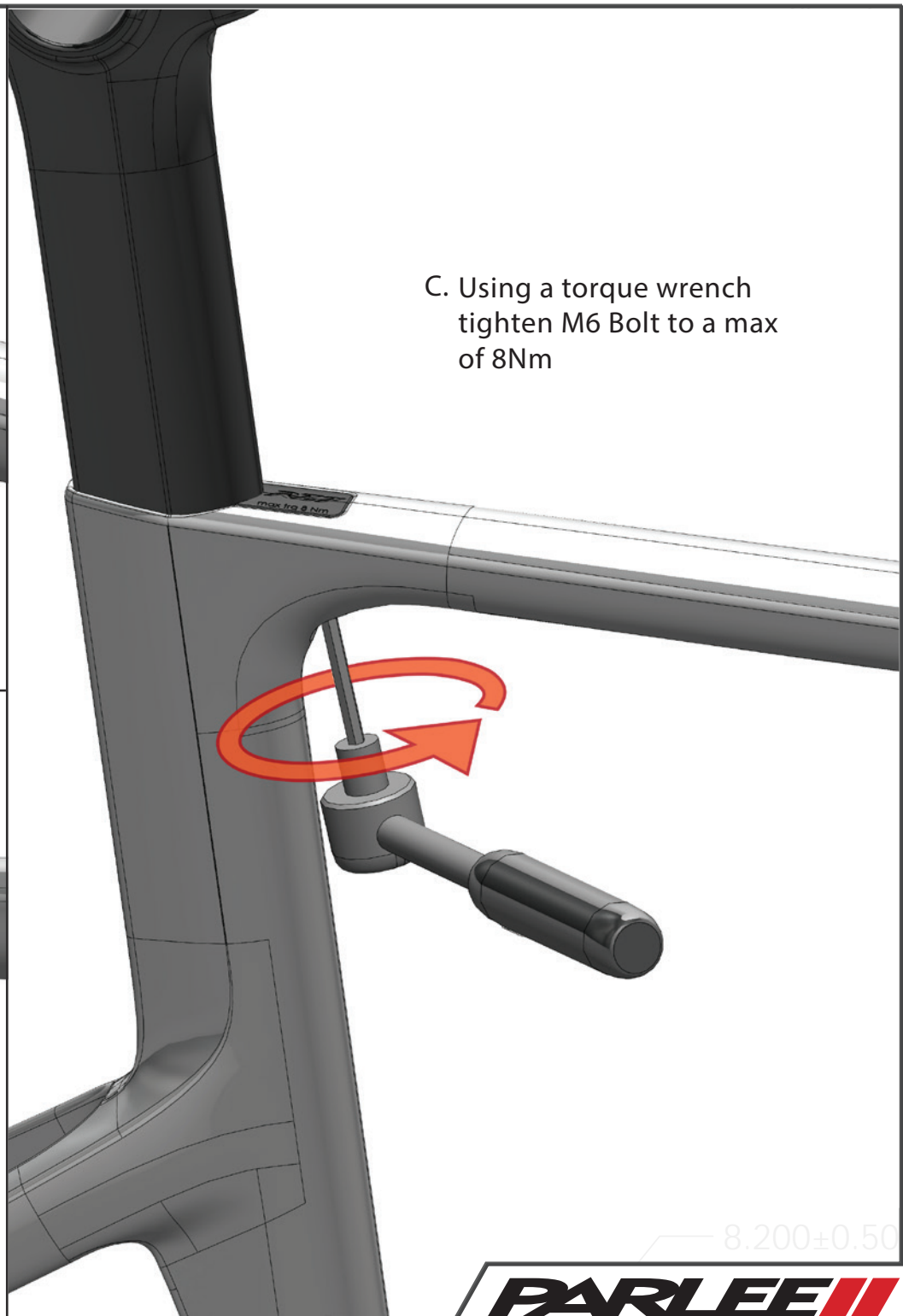
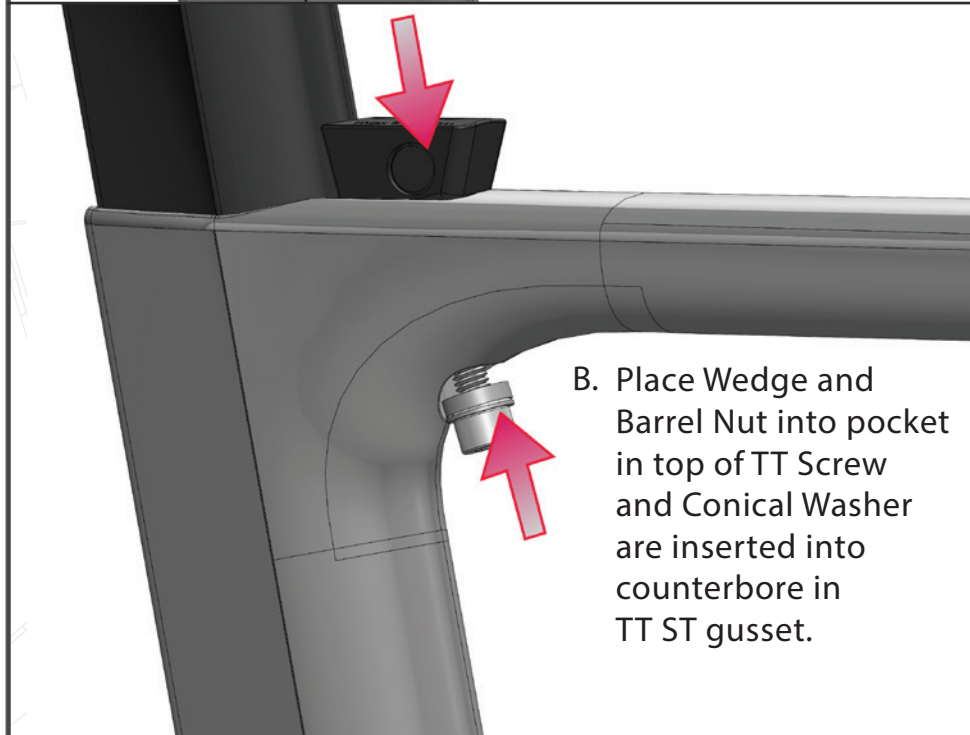



Parlee Cycles Service Bulletin

Service Bulletin – RZ7
October, 2021

Overview:

This service bulletin is intended as a supplemental installation guide for RZ7 seat posts.

Products Affected:

All RZ7 bicycles or framesets sold from mid-2019 onward.

Details:

In certain configurations, the seat post of the RZ7 can come in contact (see attached diagram) with the rear interior of the seat tube below the seat stays and damage the seat tube.

Resolution:

The resolution is simple. Safely trim the RZ7 seat post to the insertion specification(s) below and do not allow the seat post to drop into the frame and bottom out. Advise all clients who travel with their RZ7 to remove the post from the bicycle instead of lowering it past the maximum insertion point.

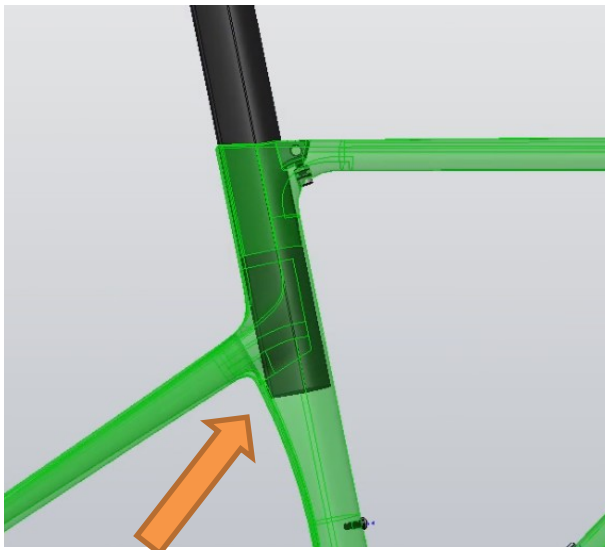

Diagram indicates location where seat post can contact interior of seat tube if not trimmed to specifications.

Specifications:

The maximum insertion of 125mm on XS and S, 150mm on M, L and XL. Do not exceed these amounts of seat post inserted into the frame at the desired saddle height.

The minimum insertion is still 82mm – do not cut a post to have less than this amount inserted into the frame at the desired saddle height.

Contact information:

For any service or technical questions, please call our Factory Customer Service number at: 1-(978) 998-4880 or email us at info@parleecycles.com.

Parlee Cycles, Inc.
69 Federal St.
Beverly, MA 01915
(978) 998-4880
www.parleecycles.com