

# INSTRUCTIONS FOR USE

AVALON CONTOUR LSO BRACE, LS-637U

 NewOptions

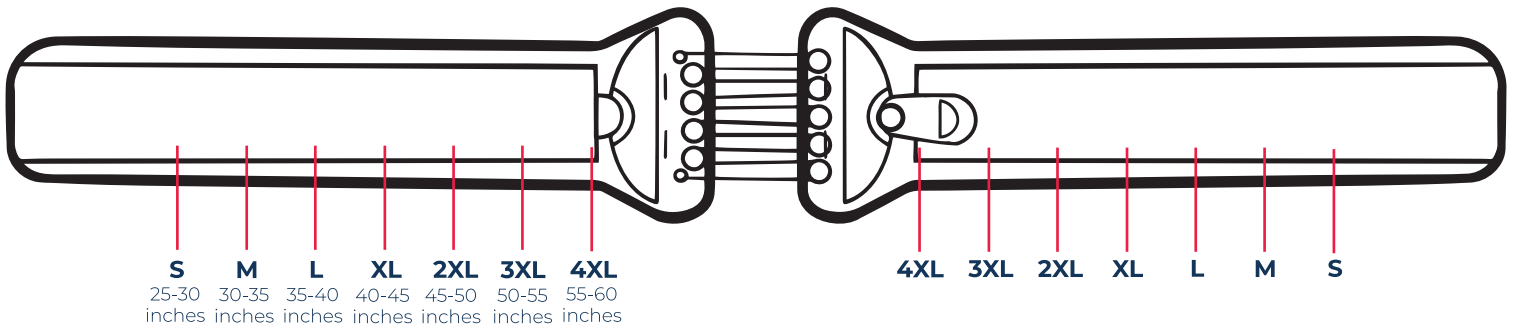

**1.** Locate size before fitting using the chart above.

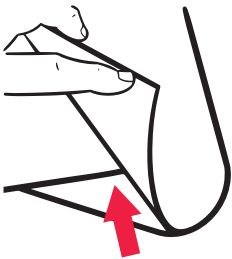

**2.** Lift sleeve and remove extension panels to adjust to appropriate size.

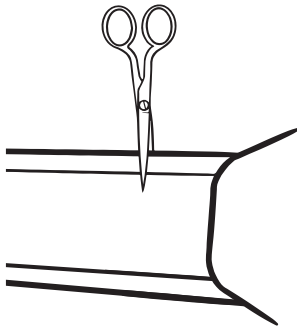

**3.** Cut to desired length with scissors. If size adjustment is minimal, simply fold the extension panel to desired length.



**4.** Once adjustment is made, (cut or folded) simply lift the sleeve and attach the extension to Velcro. Press down to secure.

# INSTRUCTIONS FOR USE

AVALON CONTOUR LSO BRACE, LS-637U

 NewOptions

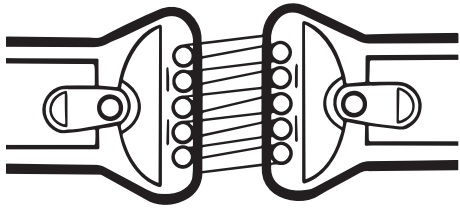

**5.** Initially align each pulley handle to the side of the brace prior to fitting. Adjust tension for sitting or standing.

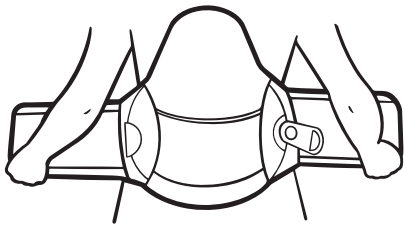

**6.** Center back panel on the spine with the pointed part of the panel up.

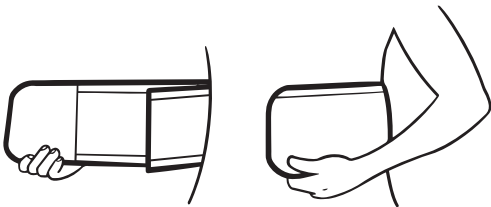

**7.** Wrap the left side to the front, positioning the front panel. Then wrap right side on top of the left panel to close and attach in front.

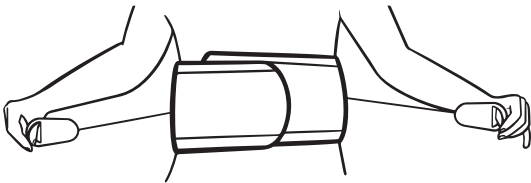

**8.** Pull each side pulley at the same time out and away to desired compression and support.

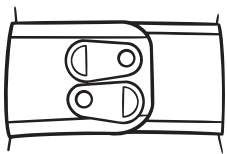

**9.** Place the handles on the fabric for a secure fit.

Still need help?  
Scan here to watch a video tutorial!



LS-637U