

## What's in the Box

### Product Overview

### LED Indicators

### Using Your Double Power Hub

Connect with Portable Power Station

Charging Devices Through Double Power Hub

### Disconnect with Portable Power Station

### Using the App

The Anker App for Smart Control

Firmware Update

### FAQ

### Specifications

## What's in the Box

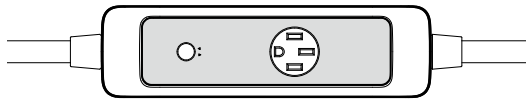

Anker SOLIX Double Power Hub

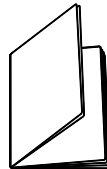

Important Safety Instructions and  
Warranty Card

## Product Overview

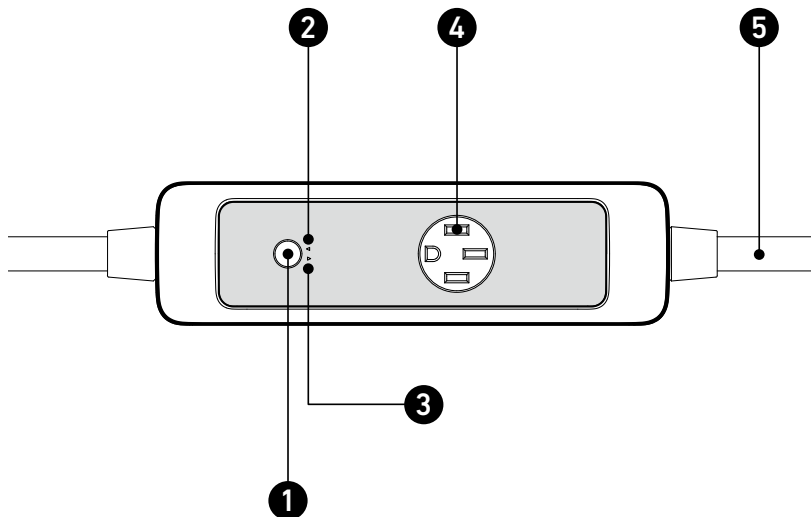

- ① On/Off Button
- ② Power Station Indicator (Left)
- ③ Power Station Indicator (Right)
- ④ NEMA L14-50 AC Output Port
- ⑤ Double Power Hub to F3800 Cable

## LED Indicators

Indicator	Status	Description
On/Off Button Indicator	Steady White	Operating normally.
	Flashing White	Product malfunction.
	Off	Anker SOLIX Double Power Hub is turned off and cannot output at this time.
Power Station 1 / 2 Indicators	Steady White	Power station connected with Anker SOLIX Double Power Hub.
	Flashing White	Power station malfunction.
	Off	Power station not connected with Anker SOLIX Double Power Hub.

## Using Your Double Power Hub

### Connect with Portable Power Station



**Warning:** To ensure electrical safety and extend the service life of electrical appliances, never plug or unplug the connection cables while the power supply of Anker SOLIX F3800 Portable Power Station is on.



- Anker SOLIX Double Power Hub requires two Anker SOLIX F3800 Portable Power Stations to be connected and both power stations need more than 1% power to be used.
- When Double Power Hub is working, the AC charging of Anker SOLIX F3800 is turned off. To charge Anker SOLIX F3800 via the AC wall charger, you must first turn off Double Power Hub before charging Anker SOLIX F3800 via AC.
- When Anker SOLIX Double Power Hub is connected to two Anker SOLIX F3800 Portable Power Stations, connect an equal number of expansion batteries to each F3800 Portable Power Station.
- For your safety, disconnect the Double Power Hub from Anker SOLIX F3800 Portable Power Station will simultaneously turn off the power station's AC Output.

Connect the cable of Anker SOLIX Double Power Hub to two Anker SOLIX F3800 Portable Power Stations via the Home Power Panel ports. Ensure that the main switches of both Anker SOLIX F3800s are turned off during the connection process.

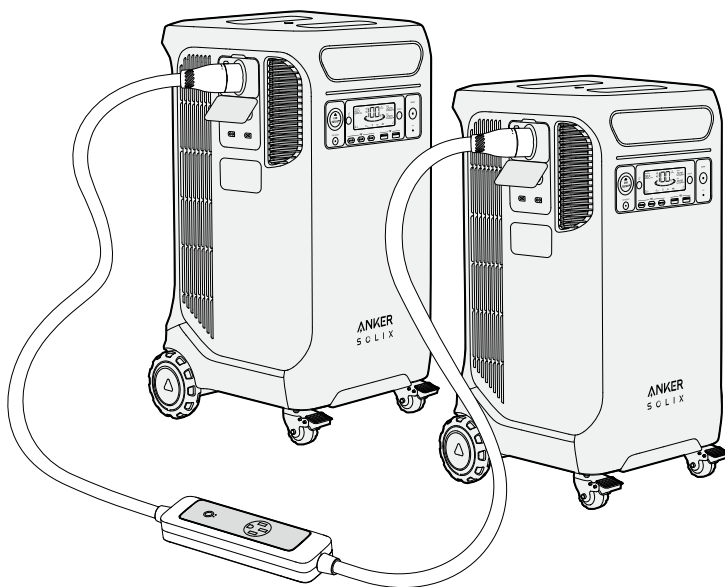

## Charging Devices Through Double Power Hub



- Turn on Anker SOLIX F3800 Portable Power Station before turning on Double Power Hub.
- Turn on Double Power Hub to also turn on the AC switch of Anker SOLIX F3800 Portable Power Station.

1. Press for 3 seconds to turn on Anker SOLIX F3800 Portable Power Station and press for 2 seconds to turn on Double Power Hub.

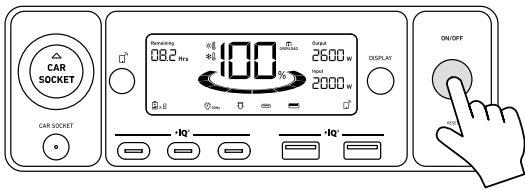

⌚ 3s

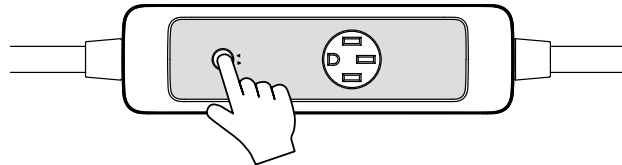

⌚ 2s

2. Make sure the on/off button and power station indicator on Double Power Hub are steady white, indicating successful connection and normal operation.

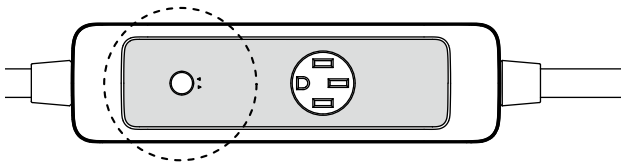

3. To power your transfer switch, RV, or EV, use the NEMA L14-50R port.

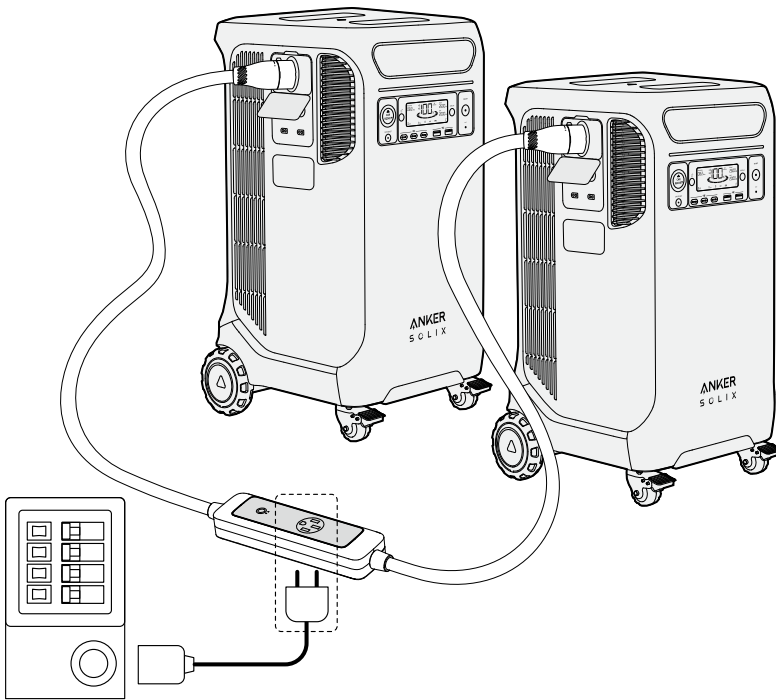

4. When Anker SOLIX Double Power Hub is connected to two F3800 Portable Power Stations and working properly, the maximum output power of Double Power Hub's NEMA L14-50R outlet is 12KW.

5. The AC output ports on Anker SOLIX F3800 are disabled when Double Power Hub is activated.

## Disconnect with Portable Power Station



Turning off Double Power Hub will simultaneously turn off AC power for both Anker SOLIX F3800 Portable Power Stations.

1. Press the on/off button for 2 seconds to turn off Double Power Hub.

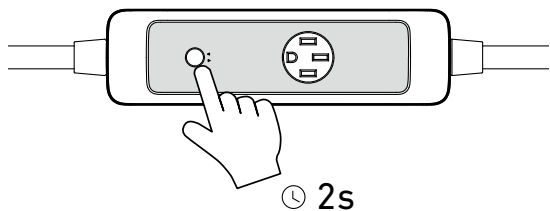

2. Then disconnect Anker SOLIX F3800 Portable Power Station from Double Power Hub.

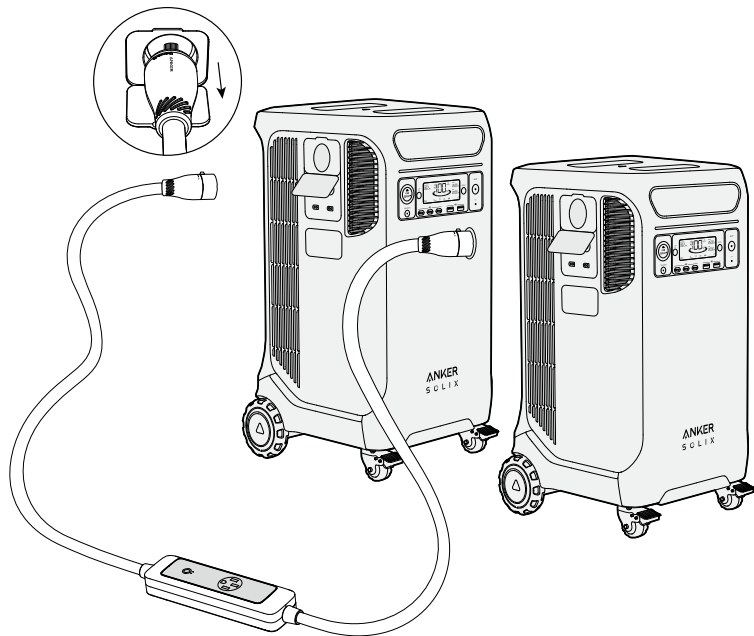

3. Wait for 15 seconds before using the Anker SOLIX F3800 AC input/output ports.

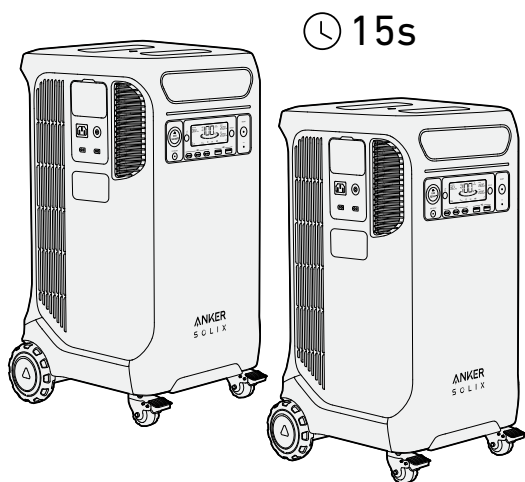

## Using the App

### The Anker App for Smart Control

Search "Anker" and download the Anker app via App Store or Google Play. Or scan the QR code below to go to the corresponding application store.

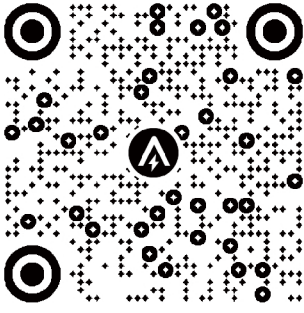

## Firmware Update

To update Anker SOLIX Double Power Hub, follow these steps:

1. Connect Anker SOLIX Double Power Hub and Anker SOLIX F3800 Portable Power Station.
2. Turn on the switch for Anker SOLIX F3800 Portable Power Station and Anker SOLIX Double Power Hub.
3. In the Anker app, you can go to the [Settings] in the upper right corner of the [System] page and click **[Firmware Update]** to check for version updates. If there's a new update, simply follow the on screen instructions to complete the upgrade.

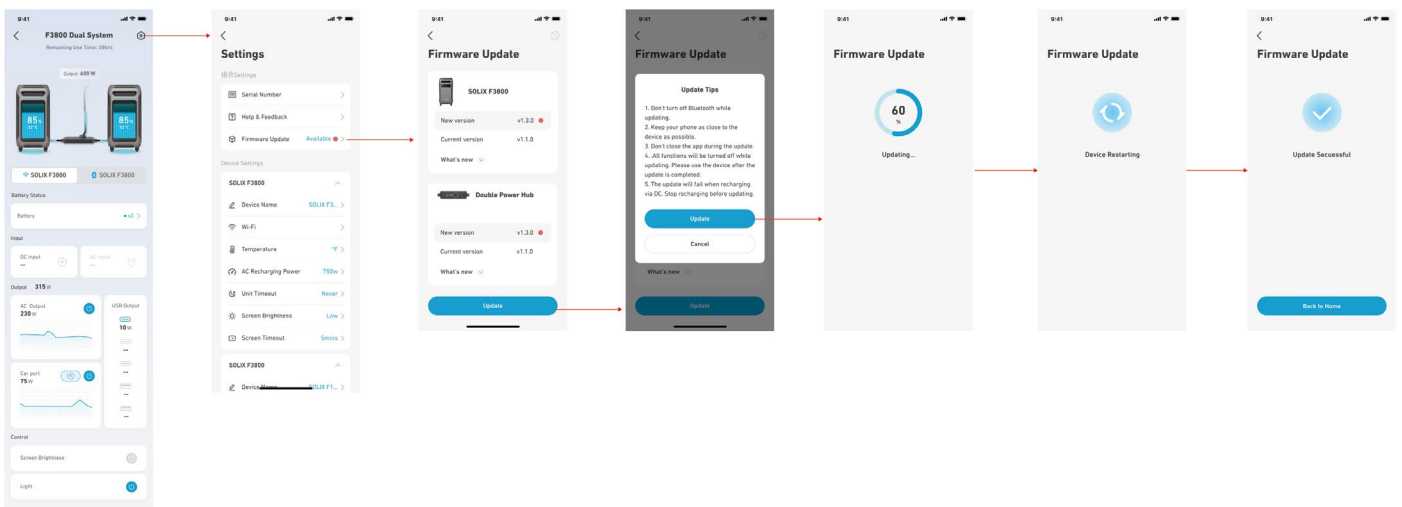

## FAQ

**Q1: Why can't I use the portable power station's on/off switch when Anker SOLIX Double Power Hub is activated?**

A1: Anker SOLIX Double Power Hub is designed to use two inverters connected to the portable power station to function. AC power must remain on when using Double Power Hub.

**Q2: Can I use Anker SOLIX Double Power Hub outdoors?**

A2: Yes, but Double Power Hub is not waterproof. Make sure the product remains in a dry and ventilated environment.

**Q3: Can I turn off the portable power station when Double Power Hub is activated?**

A3: No, you need to turn off Double Power Hub first to turn off the portable power station.

## Specifications

<b>Model</b>	A17B2
<b>Input Voltage</b>	120 / 240V, 60Hz
<b>Output Voltage</b>	240V, 60Hz
<b>Max AC Input / Output Power</b>	12000W Max, 120 / 240V, 50A Max, 60Hz, L1+L2+N+PE
<b>Operational Temperature Range</b>	-4°F-104°F / -20°C-40°C
<b>Dimensions</b>	376×104.5×61.3mm / 14.8 x 4.1 x 2.4 in
<b>Net Weight</b>	3.57kg / 7.87lb