

STL INDUSTRIAL LLC

Model: STL3640K3

36' X 40' 1440 SQUARE FT
Roofing system only
containers not included.

Snow load 30 pound per square foot,
Wind load is 120 mph.

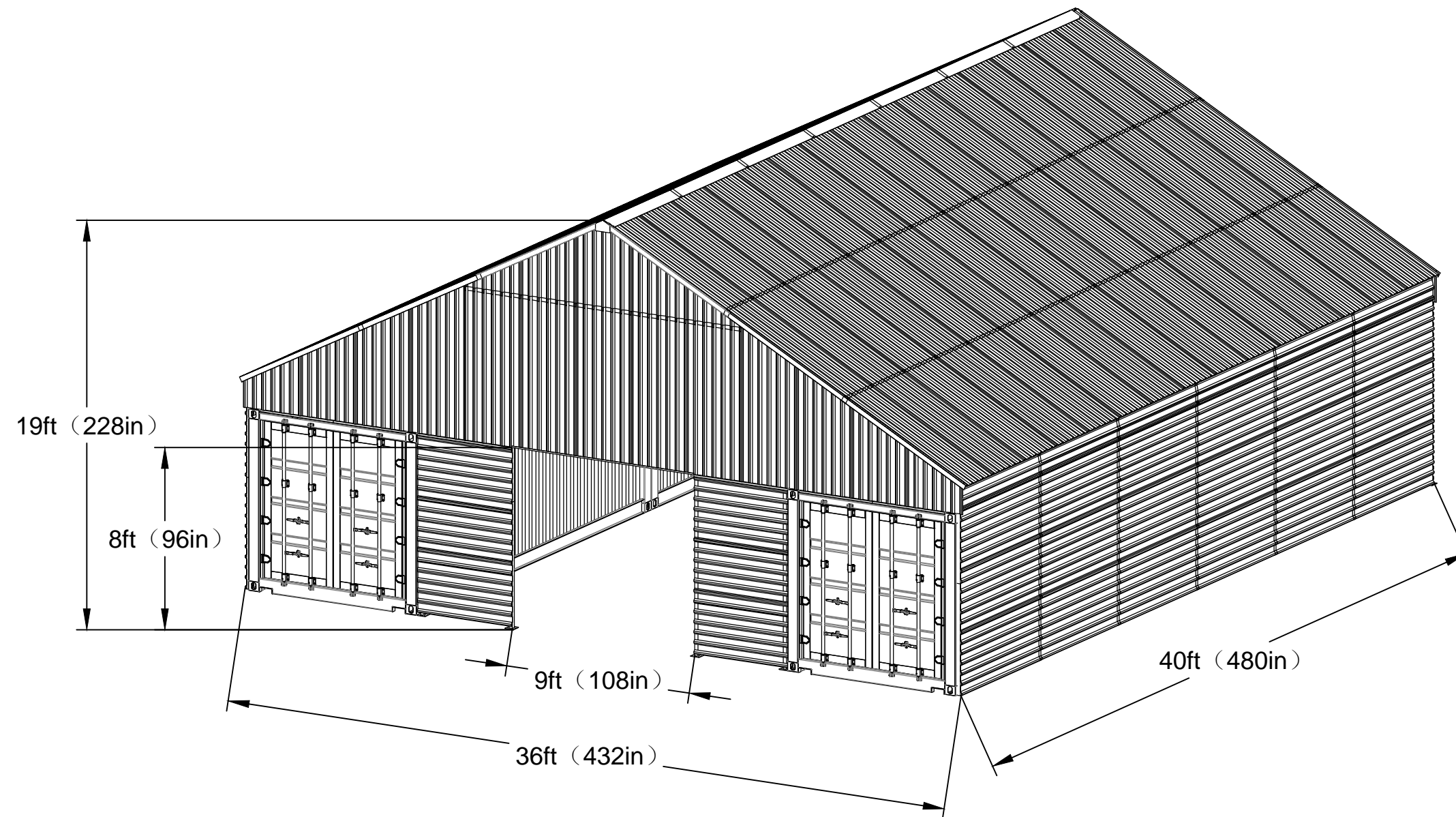

Address: 1356 N 107th st MESA AZ 85207 TEL: 480-560-4390

FRONT ELEVATION

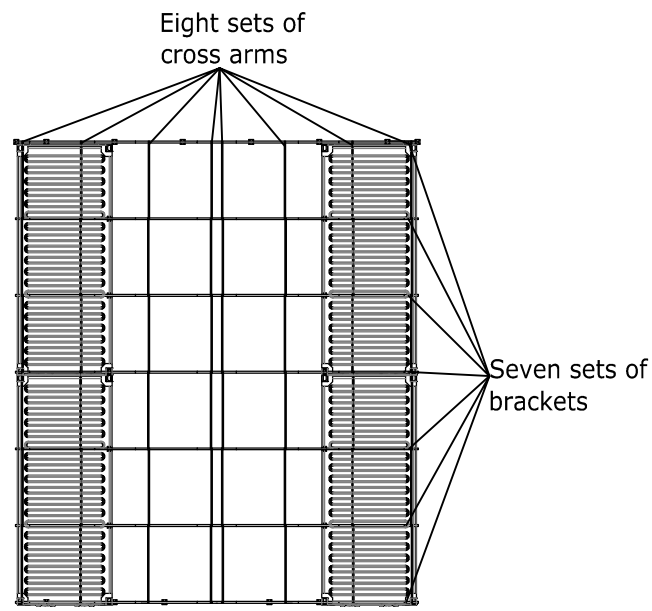
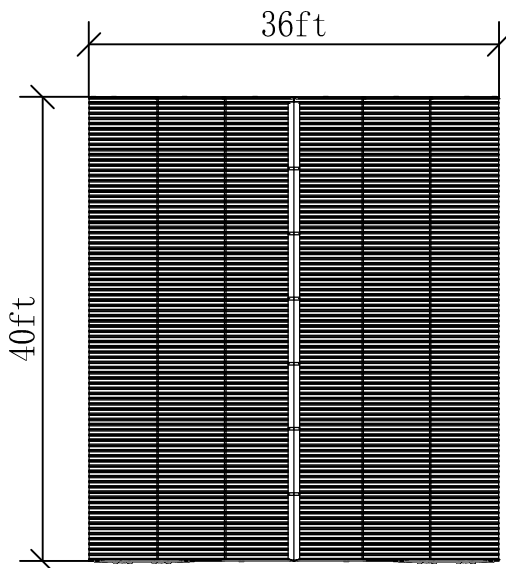
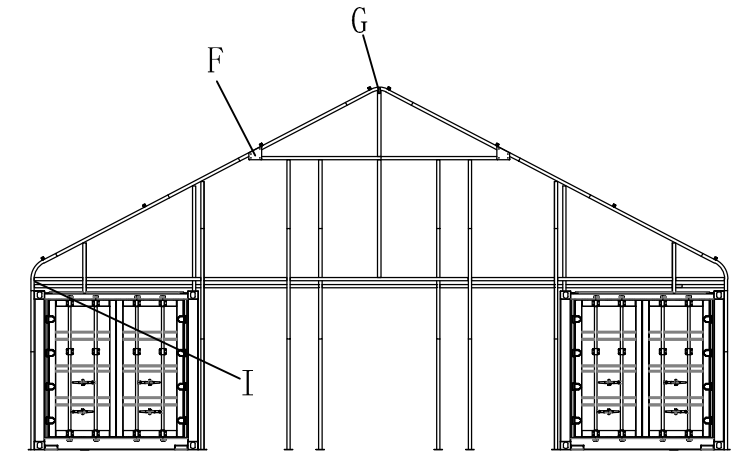
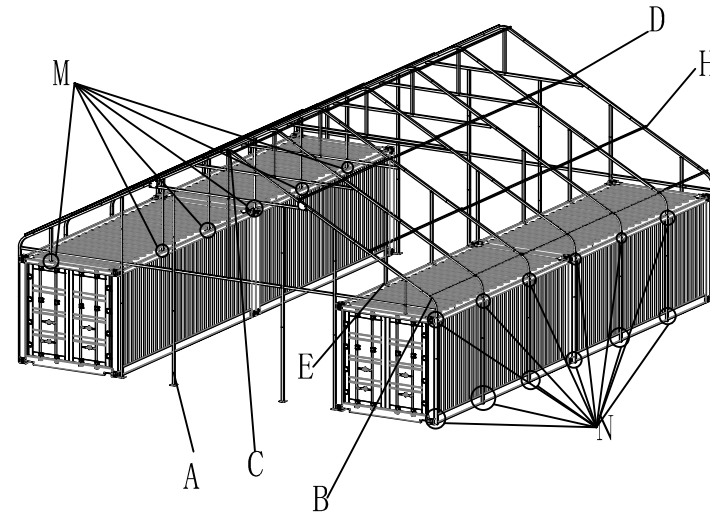
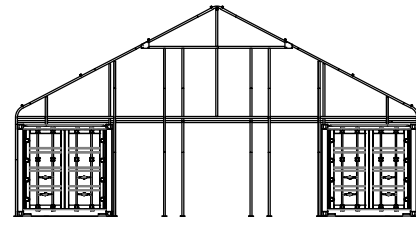
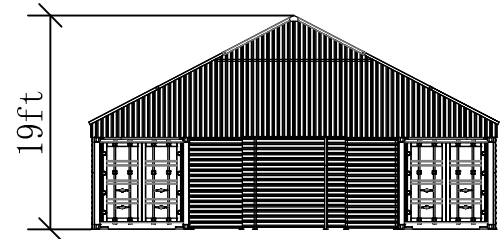

A
Steel Grade SGCC
Material thickness=0.06Ga

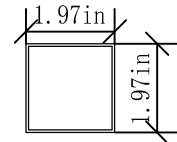

E
Steel Grade SGCC

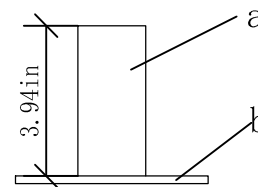

G
Steel Grade SGCC
Material thickness=0.08Ga

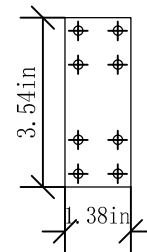

B
Steel Grade SGCC
Material thickness=0.06Ga

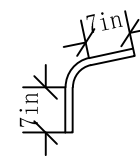

a
Steel Grade SGCC
Material thickness=0.06Ga

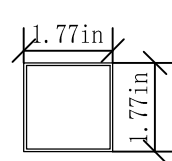

H
Steel Grade SGCC
Material thickness=0.04Ga

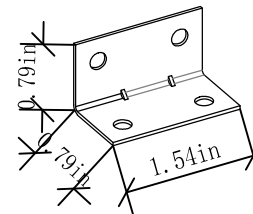

C
Steel Grade SGCC
Material thickness=0.06Ga

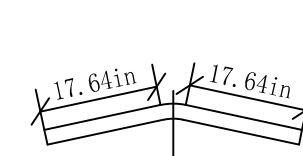

b
Steel Grade SGCC
Material thickness=0.2Ga

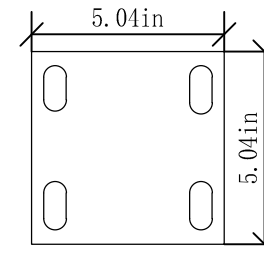

I
Steel Grade SGCC
Material thickness=0.07Ga

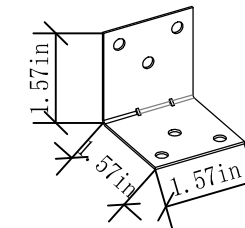

D
Steel Grade SGCC
Material thickness=0.05Ga

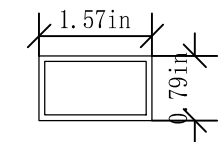

F
Steel Grade SGCC
Material thickness=0.05Ga

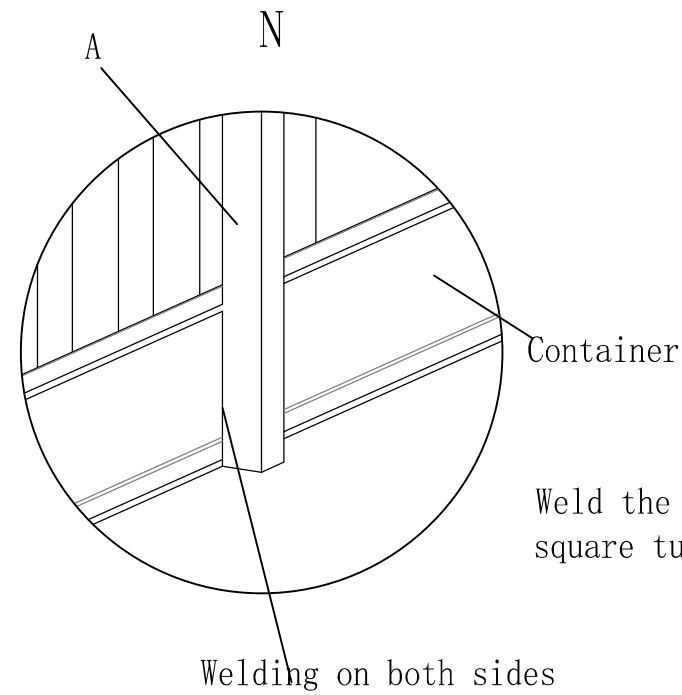
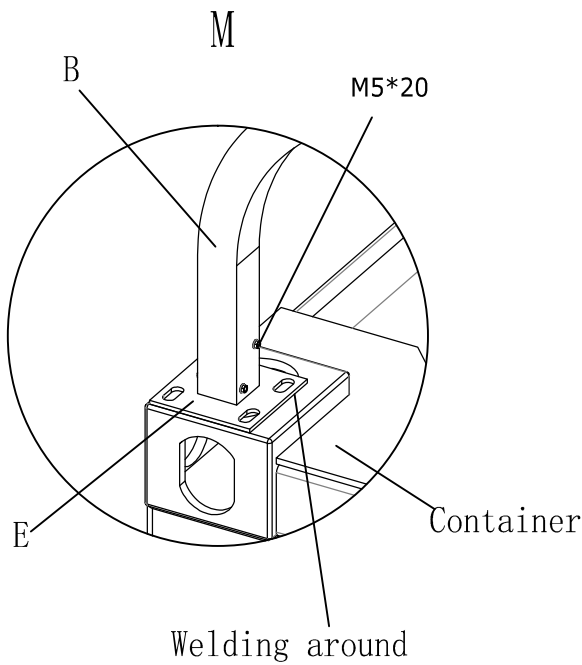
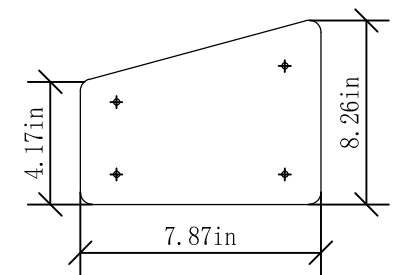

Weld the contact part between the square tube and the container

Drn. ZQT	Date
Checked.LTM	
Design. ZQT	
Issued.	

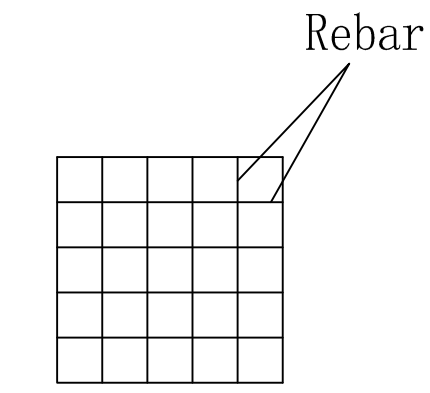
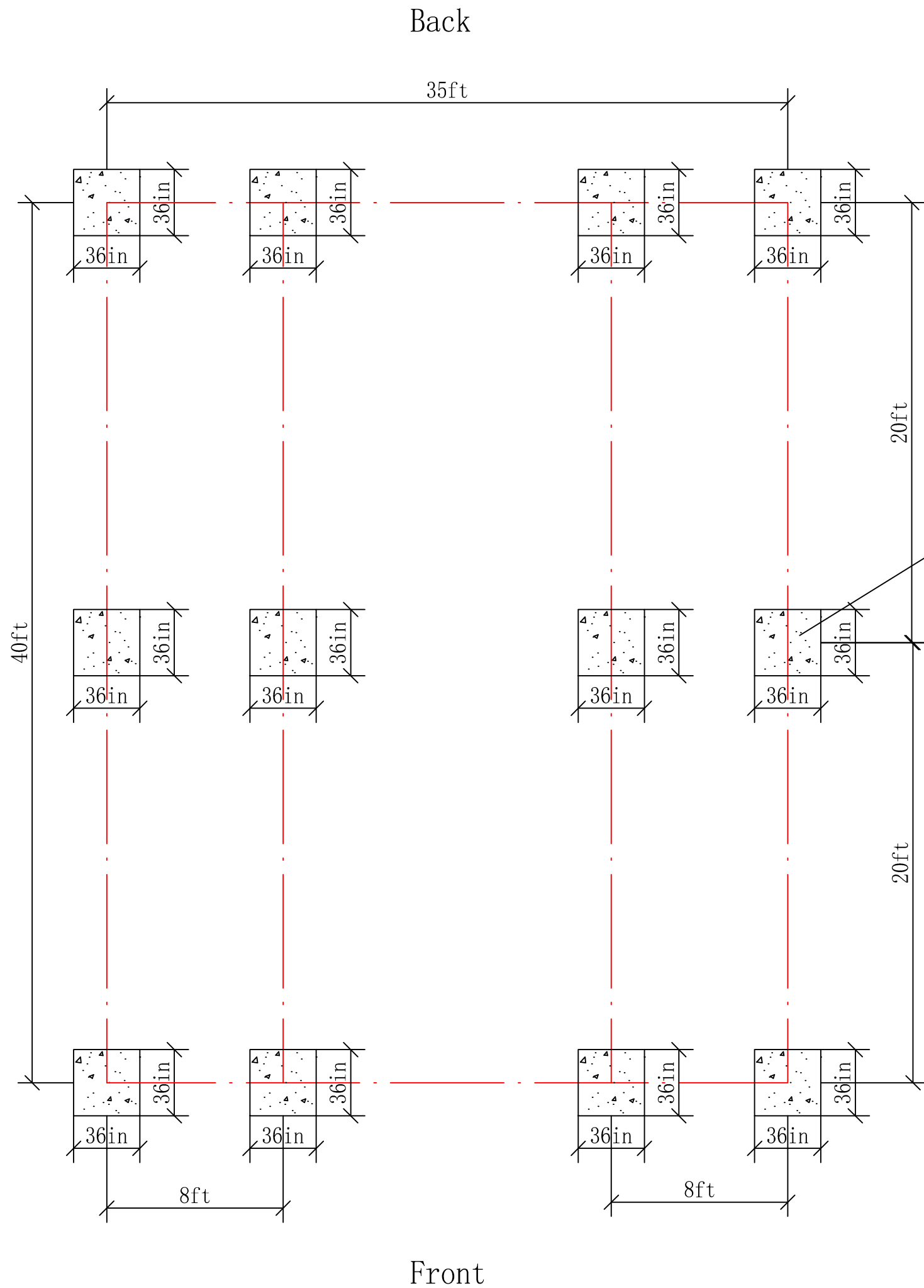

- 1. 6 pieces 1/2" rebar both ways
- 2. Simpson sd14 for rack corner and one in center both sides. Top part will be welded to container.

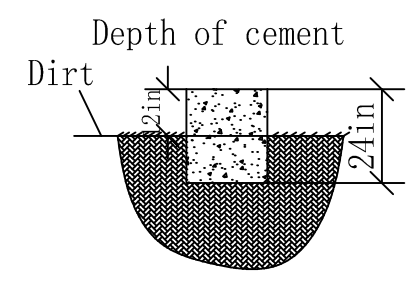

Drn. ZQT	Date	
Checked.LTM		
Design. ZQT		
Issued.		