

秘密琴房

Secret piano room



Ages14+

DIY BOOK NOOK



安全警告

- 为了保障您在拼装时的乐趣及安全，请在拼装之前阅读此说明书。
- 此产品含有小部件，电子配件，适合14周岁以上的人群，儿童需在成人指导下拼装。
- 此产品需要使用一些辅助工具进行制作，请小心使用，以免受伤。



注意事项

- 拼装前请仔细阅读说明书，确认零件无损坏，无丢件。
- 小心的从板材上取下板件，可使用美工刀辅助裁切断点处，防止板件断裂，断点处可以用磨砂棒或指甲锉刀磨平。
- 按照说明书步骤依次拆下板件，配合环保胶水拼装，胶水使用后需等待胶水凝固才可挪动，才能确保各部分黏贴牢固。
- 此产品拼接的松紧度是由加工工艺及环境因素决定的。如果过紧，用磨砂棒或指甲锉刀打磨拼接部位，如果过松，用胶水固定。
- 请勿使用酒精、氨水、溶剂、擦窗剂等化学清洁剂来清洁本产品。
- 请使用干净柔软的布清洁产品，如果板件有毛边，可以使用磨砂棒或指甲锉刀轻轻打磨平整。



常见问答Q&A

Q:拼装过程中使用胶水后为什么不牢固?

A:在使用胶水后，需要等待胶水干透才能牢固，中途移动会使各部件松动。

Q:拼装过程中有些拼接处过紧或者拼接插上要怎么处理?

A:检查拼接位置是否无误，再用磨砂棒或指甲锉刀打磨细一些，然后再进行拼接，如果过松，则用胶水粘牢。

Q:电池盒接上灯板，也插上灯线了，为什么灯不亮?

A:检查电池正负极是否装反，是否有电，再看电池盒开关是否打开在ON的位置，最后要触碰灯板上触碰开关的灯线进行开关灯控制。

配件:



拼装前进行电池盒、LED灯、触摸开关测试:

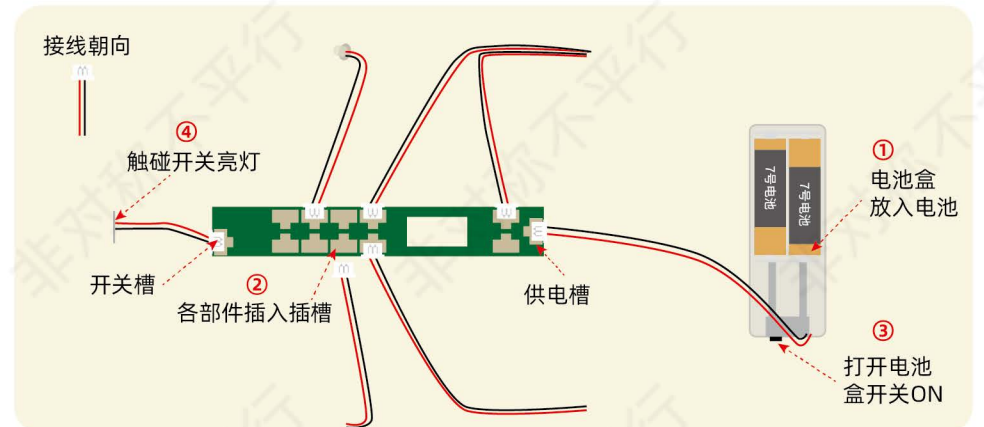

自备工具：两节7号电池,美工刀,透明胶,剪刀

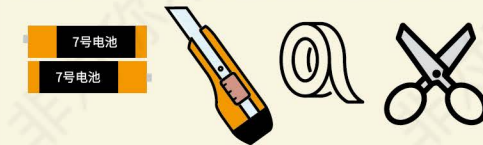

扫一扫
查看全步骤拼装视频教程

拼装过程中，遇到任何问题，可联系客服咨询。



·板材总览·

取件辅助
多出的件为备件

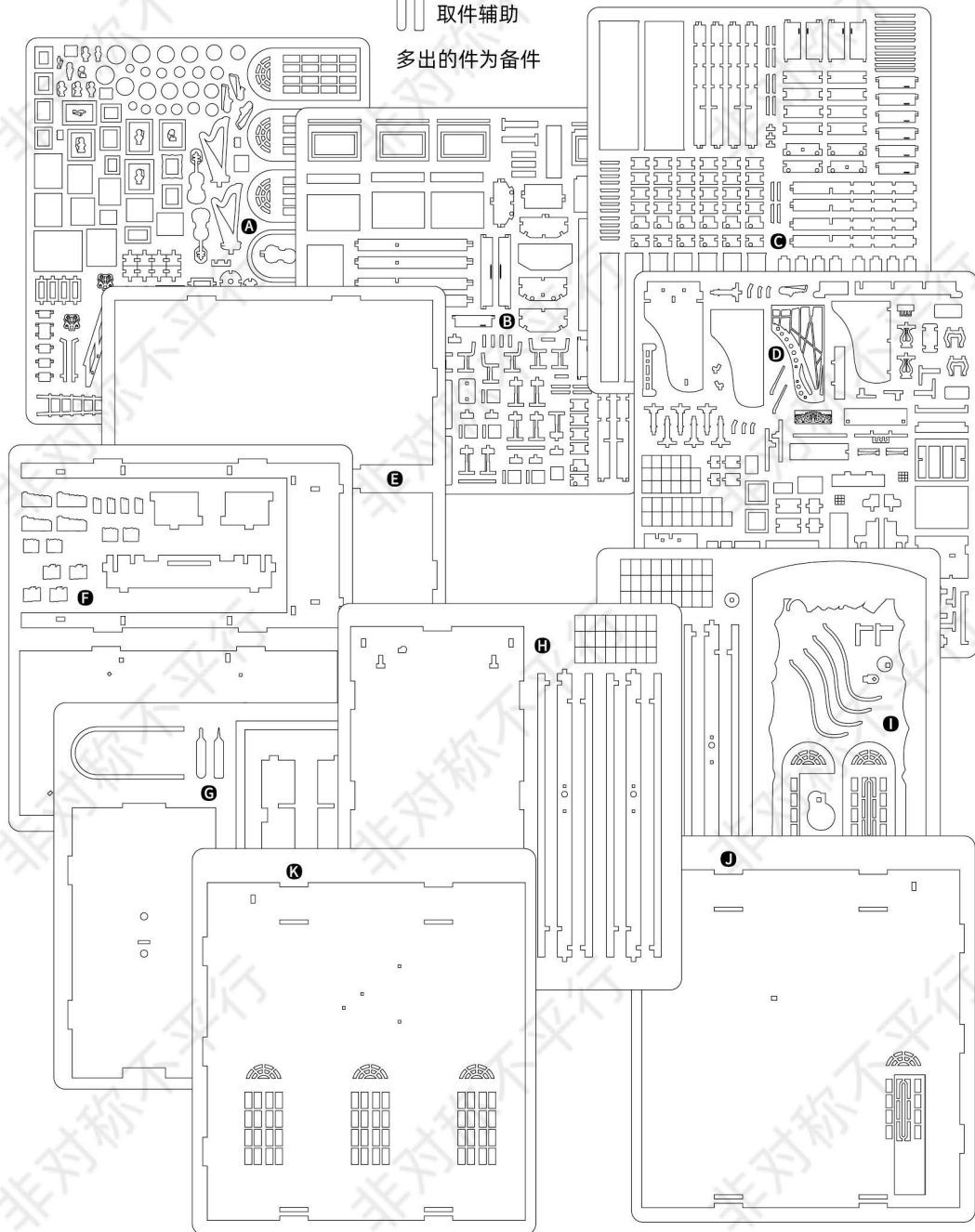

STEP 1



STEP 2



与板组合

组合效果见下一页

! 特别注意：I8和I14不要低于板件插槽处，否则后续拼装不上。

合页：



板件对齐
粘胶时不要接触到转轴处，以免无法开合
粘胶后圆点处再点胶，待干后可开合。

STEP 2

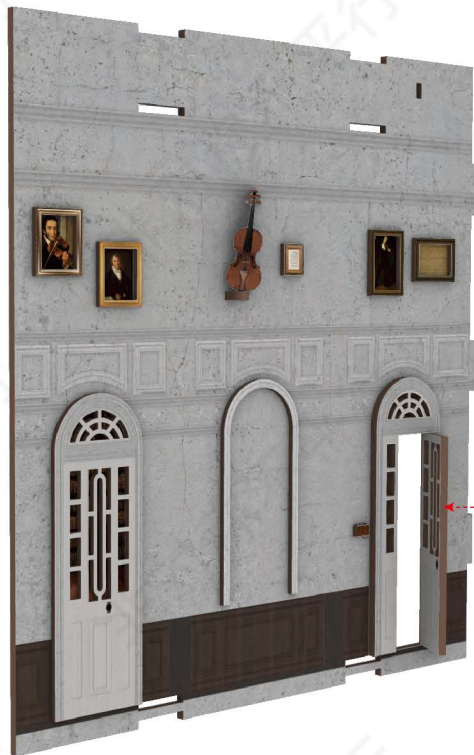

开合效果

STEP 3



19,I10,I11粘牢组合, 可旋转

2

STEP 4

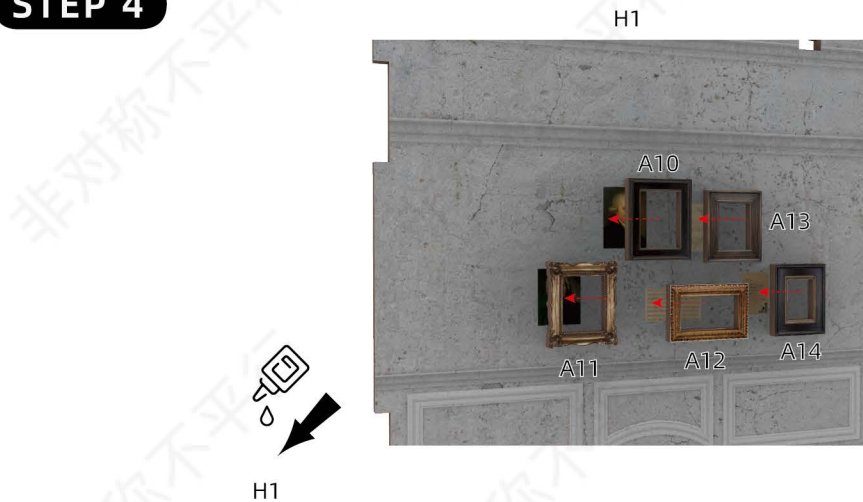

H1

H1



后拼步骤:
A8与H1左右居中, 先不粘牢固, 后续步骤需要调整底部距离。



3

STEP 5

亚克力板组合

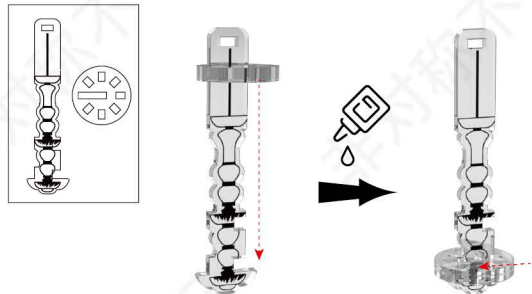
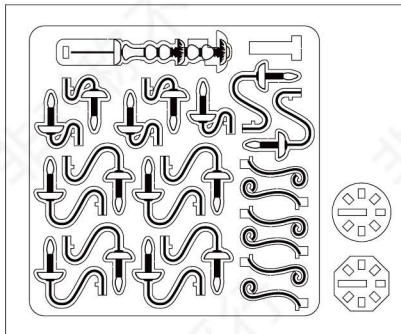

圆板往下插入，在沿着卡槽往左移动

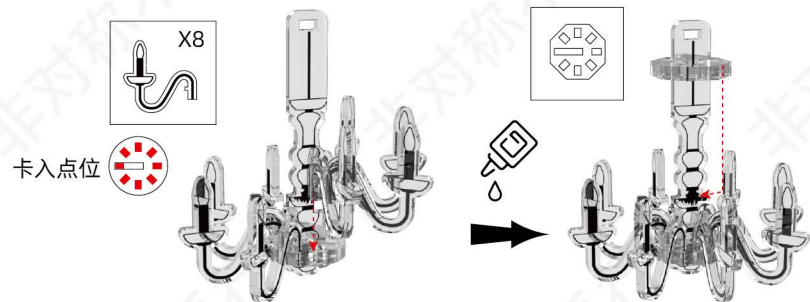

8个亚克力件插入圆板，可点胶水固定

八边板往下插入，在沿着卡槽往左移动

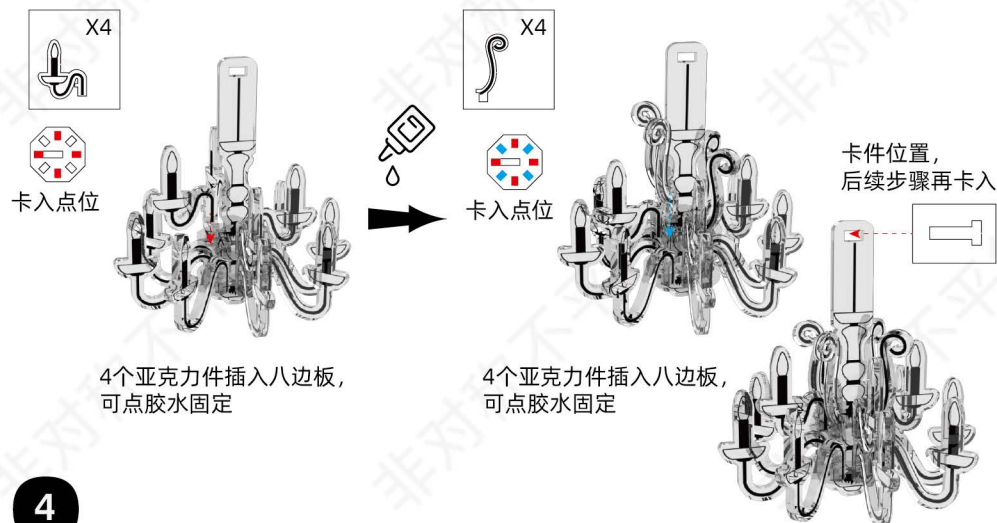

4个亚克力件插入八边板，可点胶水固定

4个亚克力件插入八边板，可点胶水固定

卡件位置，后续步骤再卡入

4

STEP 6

相同板件
H2/H5/11/14



相同板件
H3/H6/12/15

STEP 7

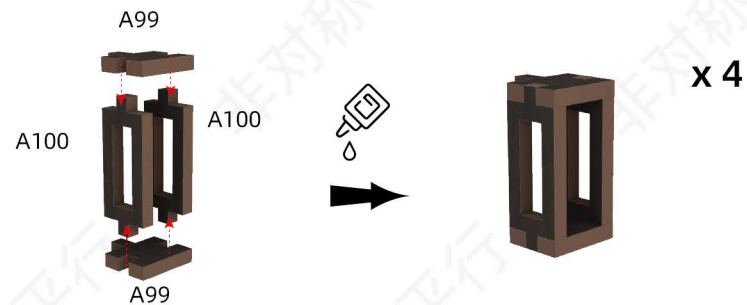

PC透明板*4

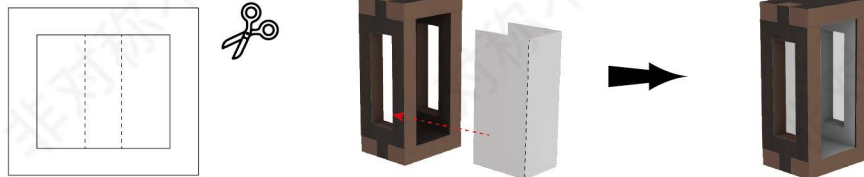

5

STEP 8

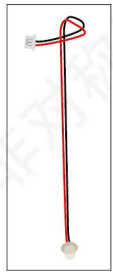

短灯线*4



STEP 9

长灯线

卡入

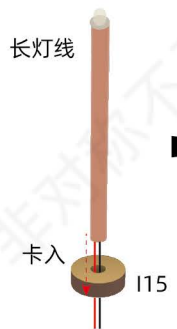

PC透明板

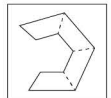

A104

A102

先放置PC透明板再固定其他件

A103

6

STEP 10

STEP 9

灯线穿过①再从②穿出

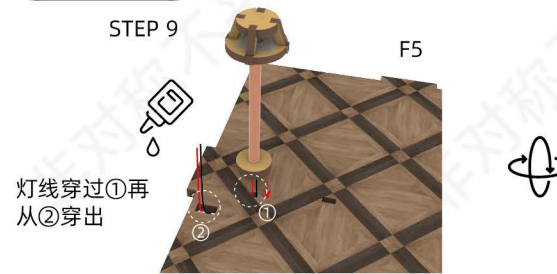

F5

STEP 8

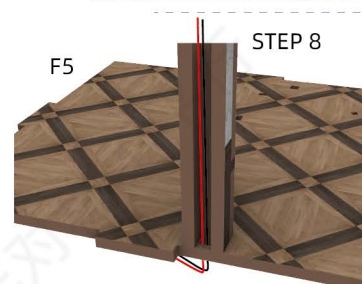

沿着STEP 8往上穿过F4孔, 此步骤后续拼装再操作

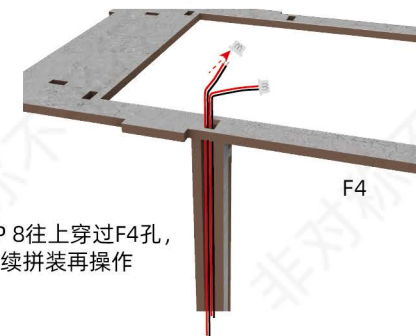

STEP 11

G2

F5

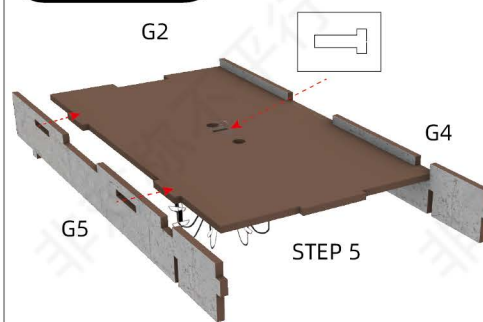

有图案面朝STEP 5方向

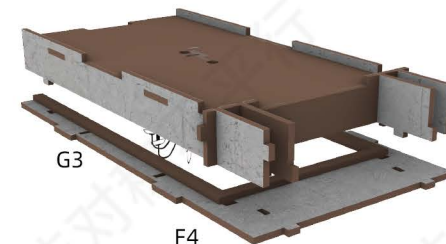

后拼步骤:
此步骤在STEP 12执行, 5条灯线穿过F4后再拼装。

7

STEP 12



STEP 11

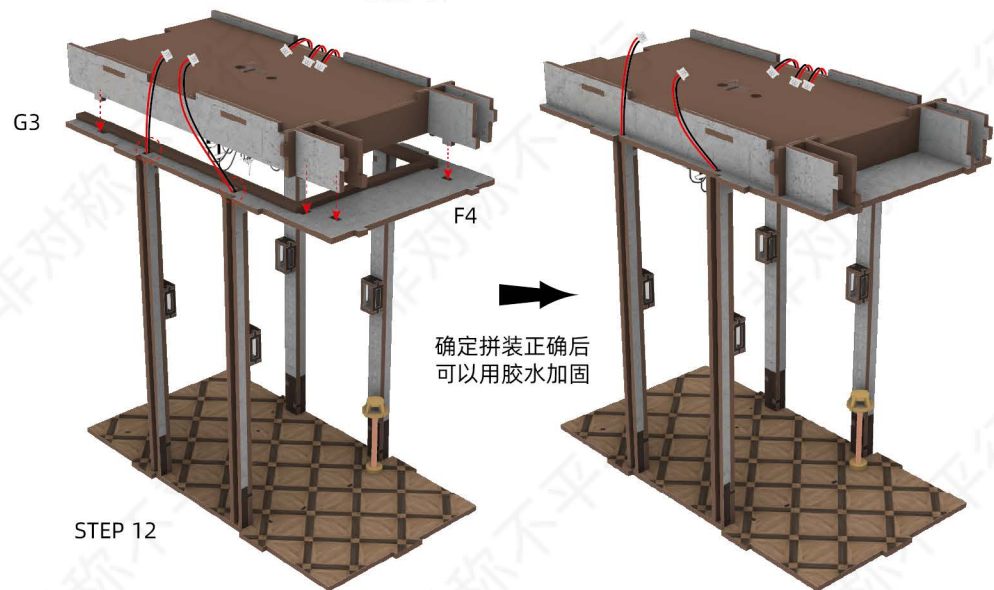

难点步骤：
灯线穿过F4后再执行后续拼装，4个STEP 8组件与G3和F5固定，注意灯线的梳理。

8

STEP 13



STEP 14

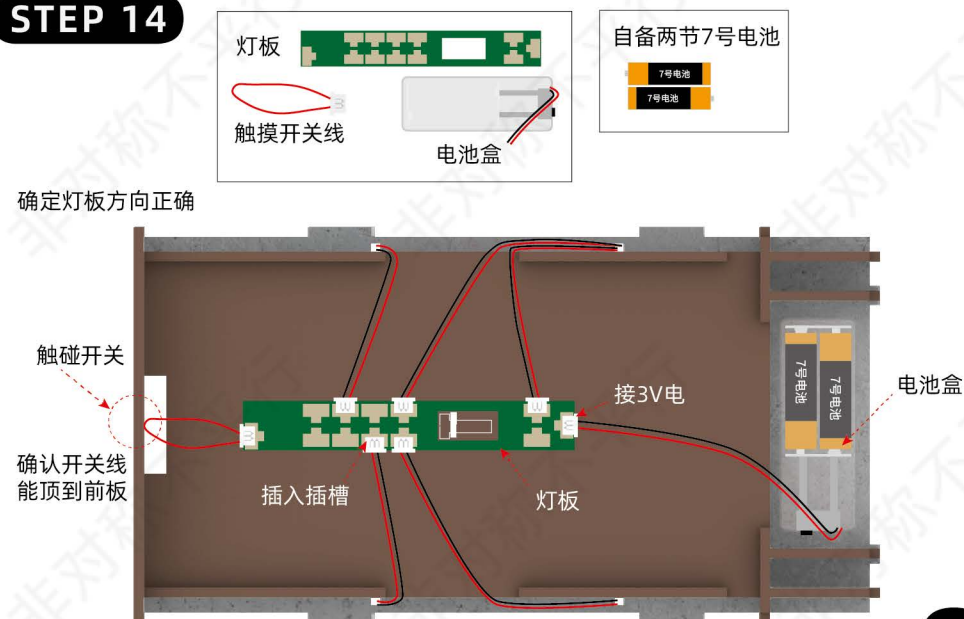

9

STEP 15



STEP 16



! A22与K板镂空处对平对齐

STEP 17



完成图

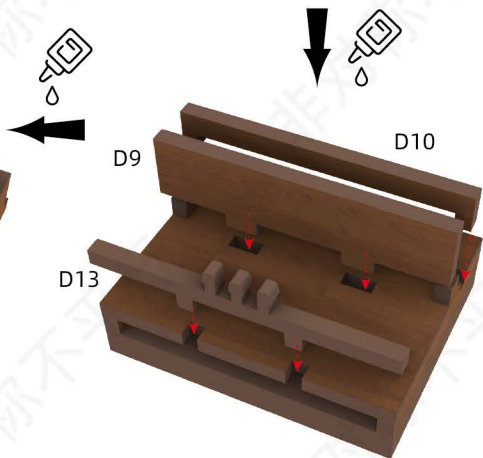
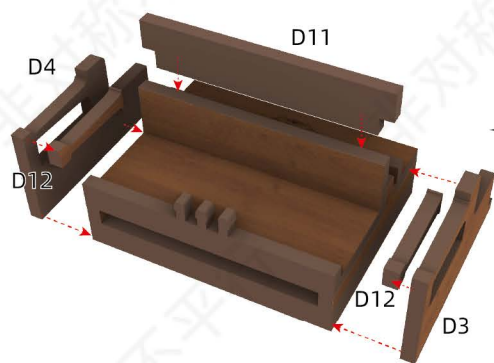
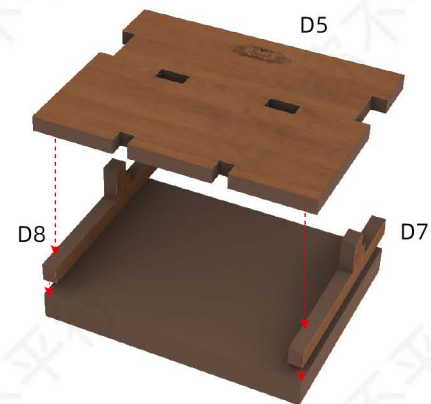
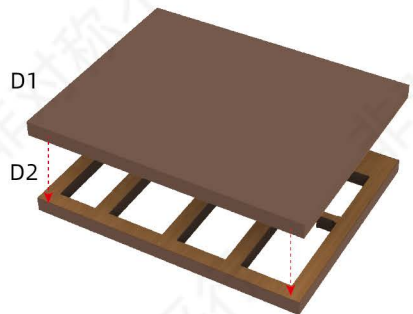

STEP 17

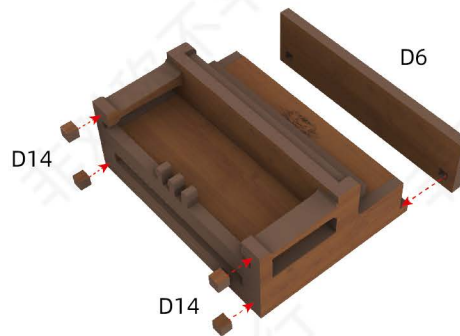

STEP 18



完成图

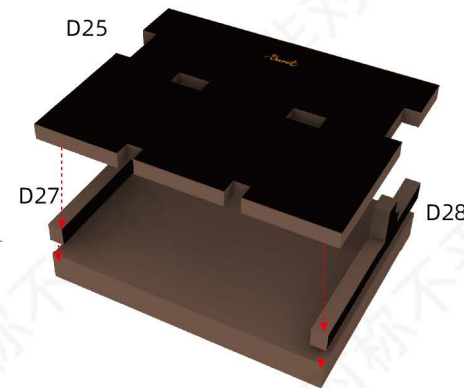
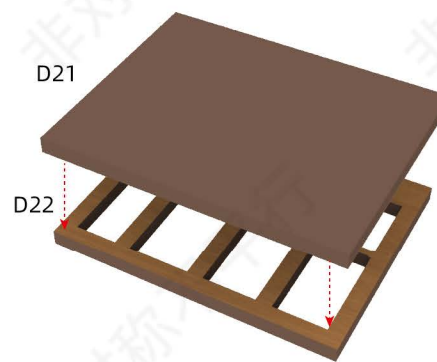

STEP 18

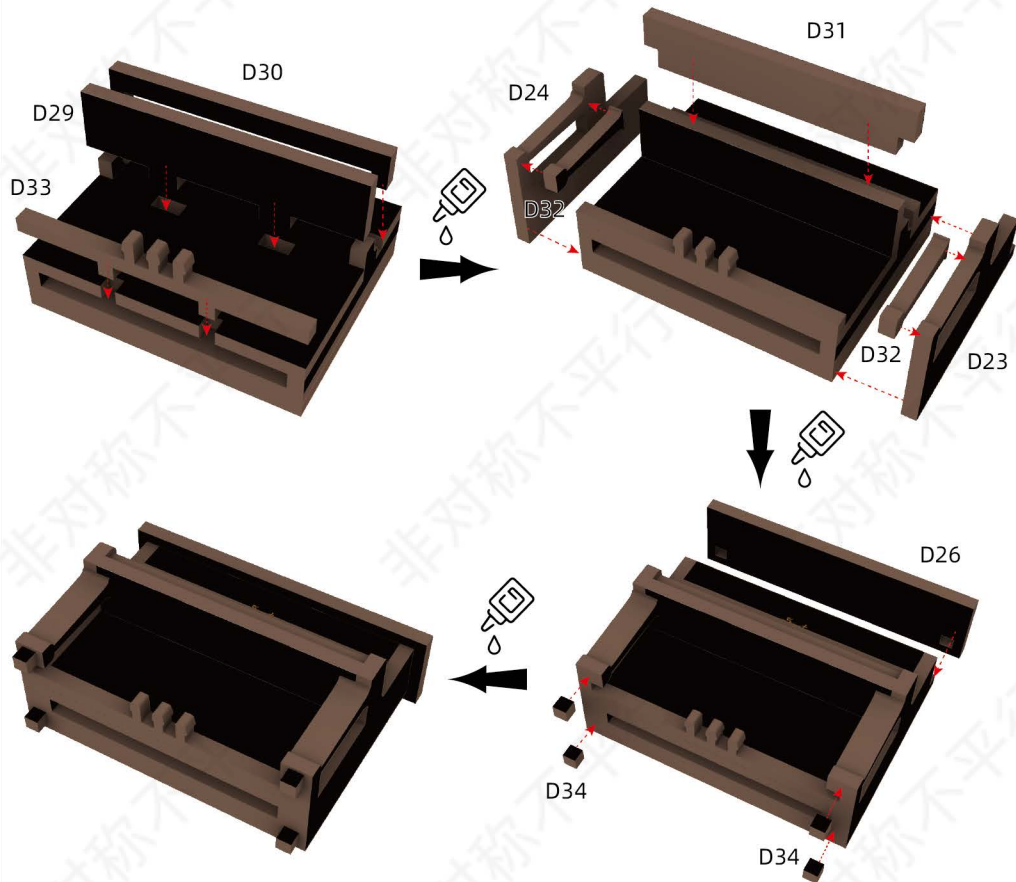

STEP 19

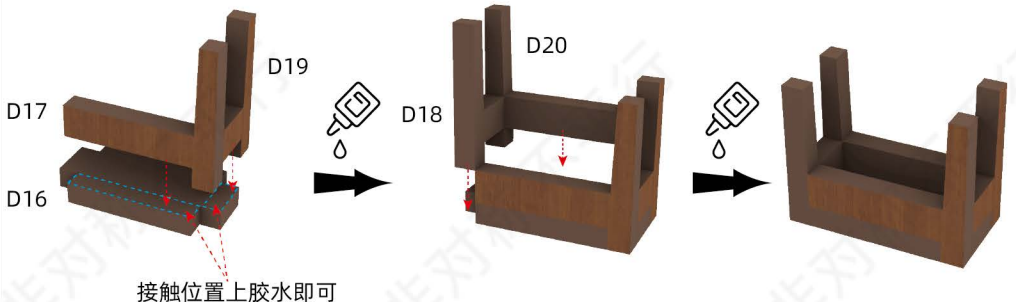

接触位置上胶水即可

STEP 19



STEP 20

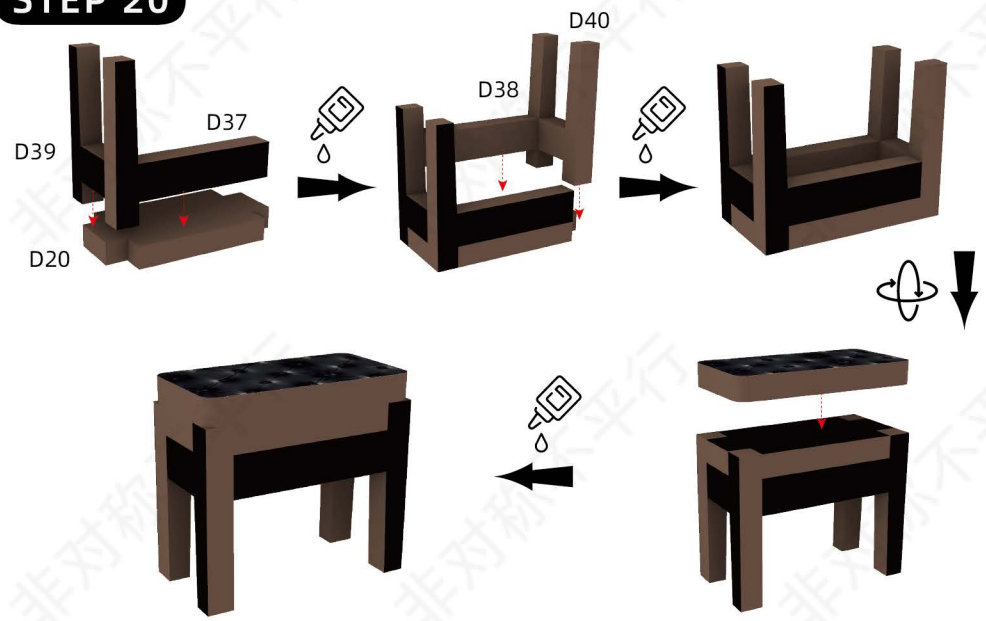

STEP 21



STEP 22



STEP 23

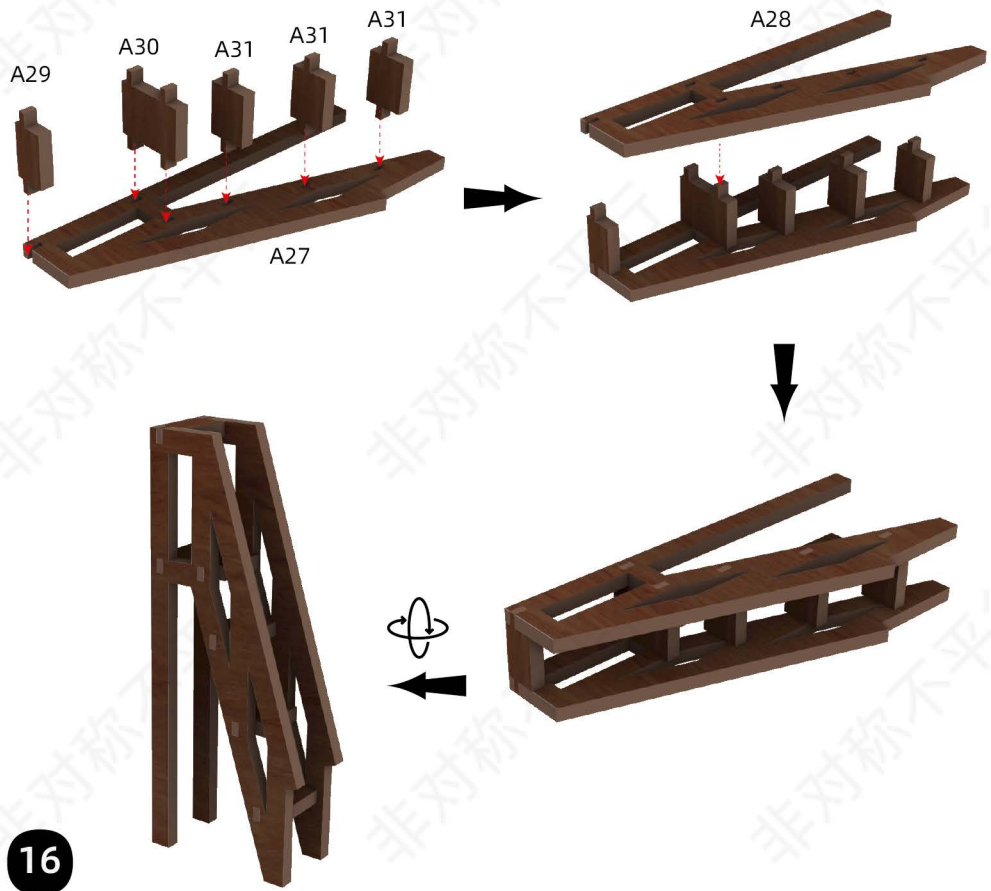

STEP 24

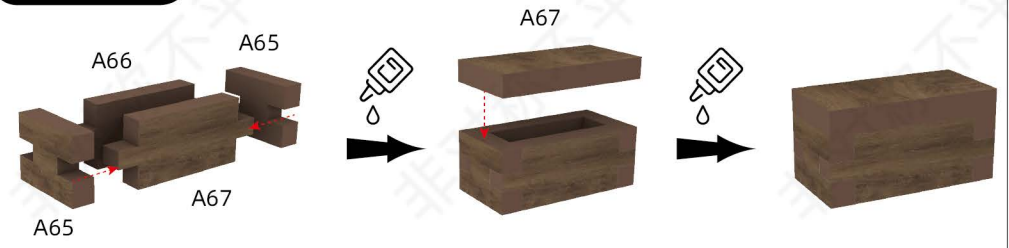

STEP 25

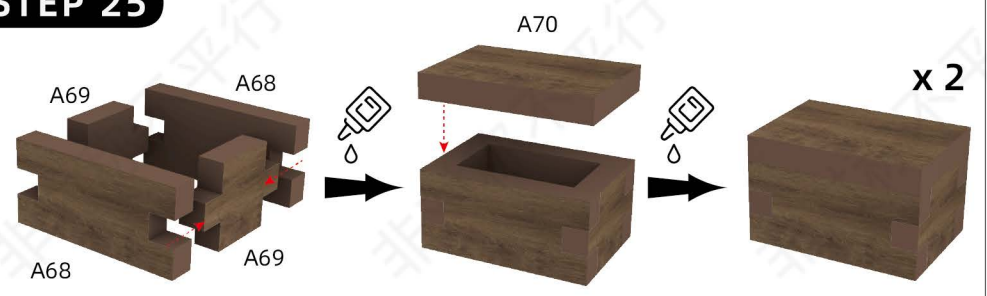

STEP 26

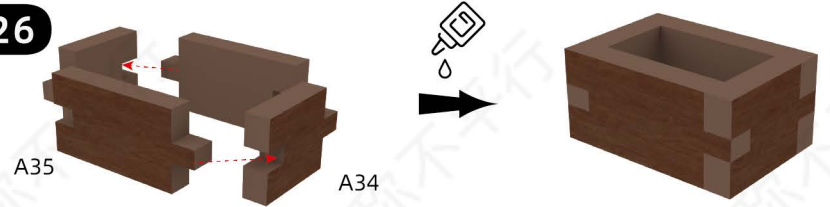

STEP 27



STEP 28

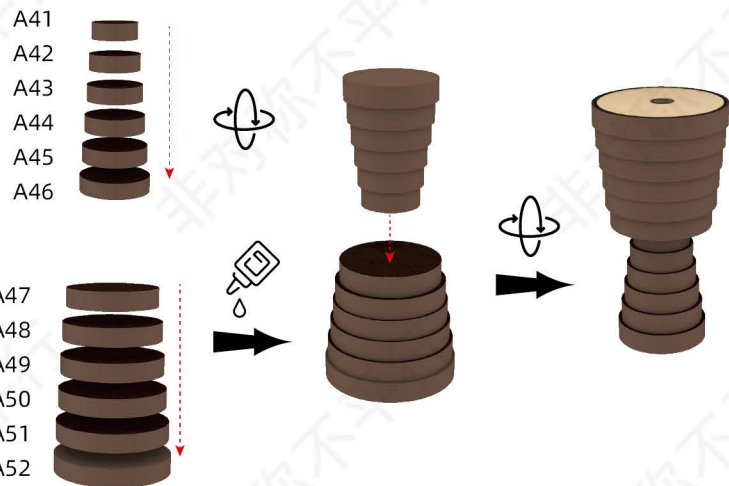

STEP 29

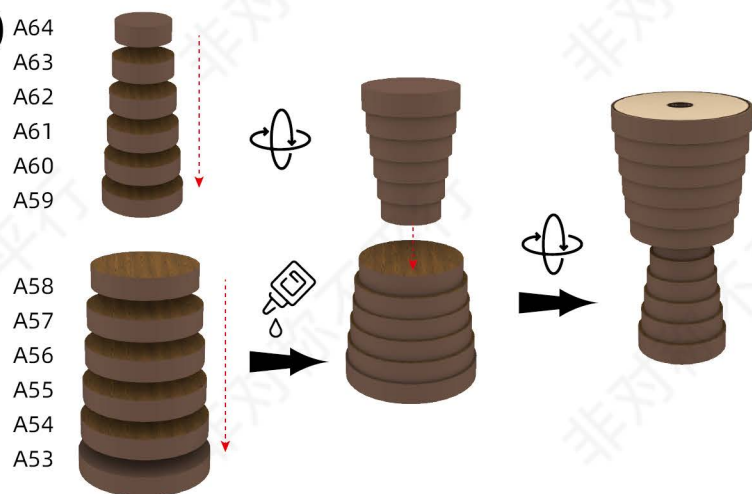

STEP 30

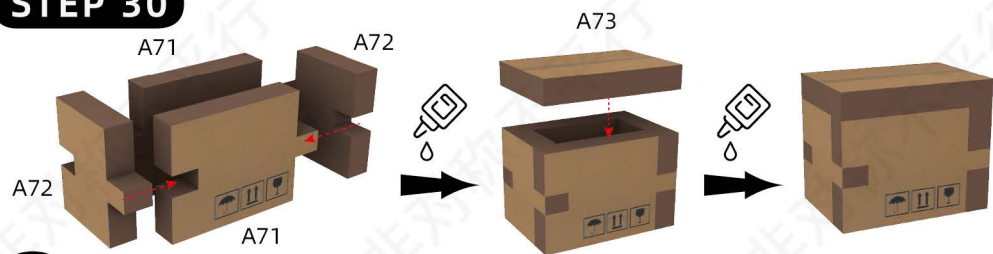

STEP 31

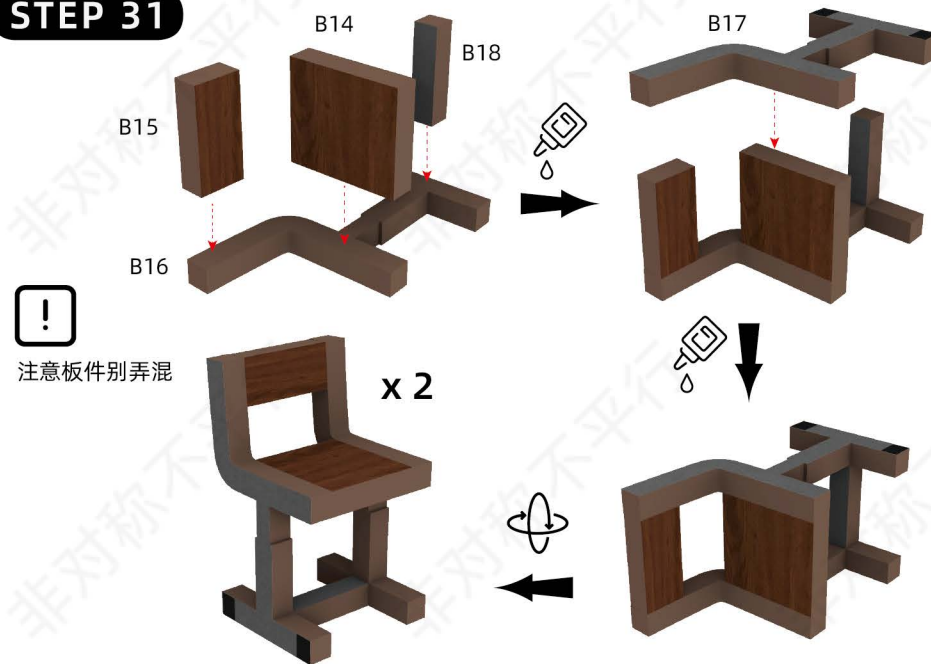

STEP 32

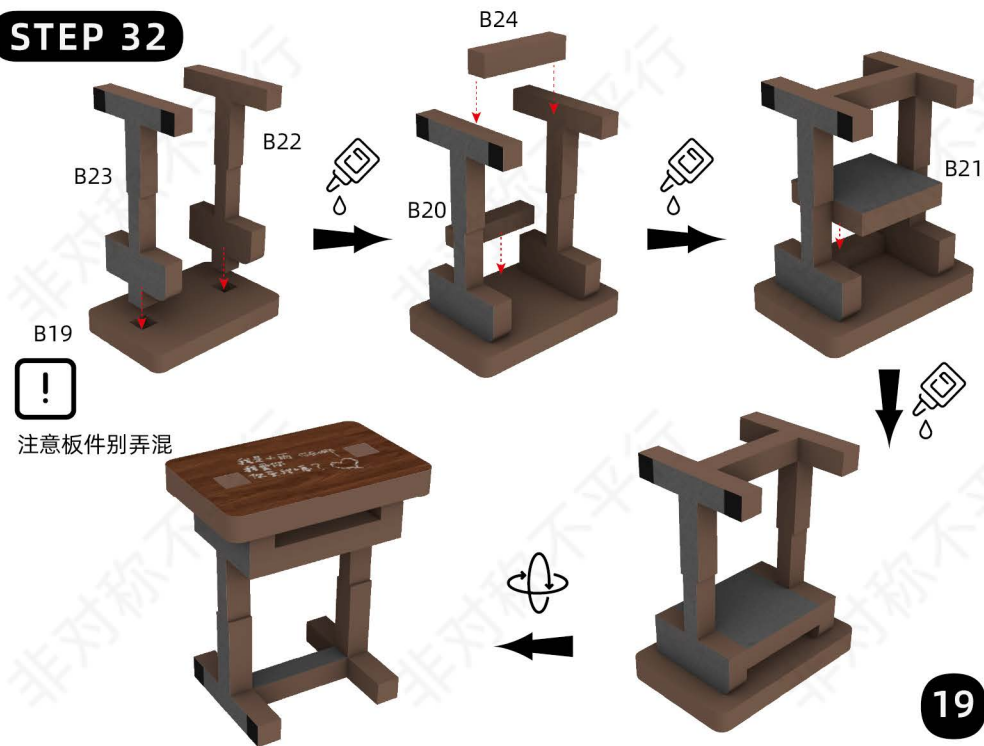

STEP 33

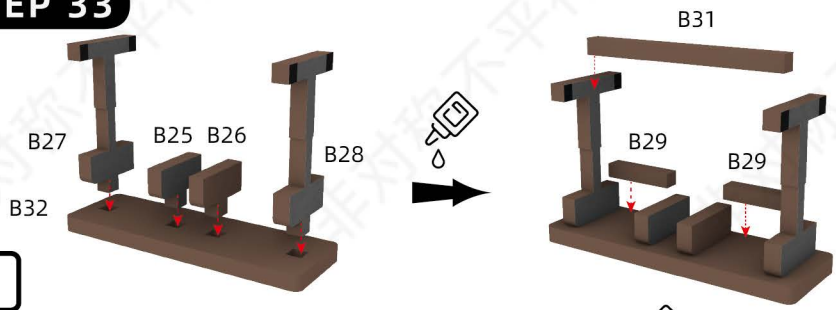

注意板件别弄混

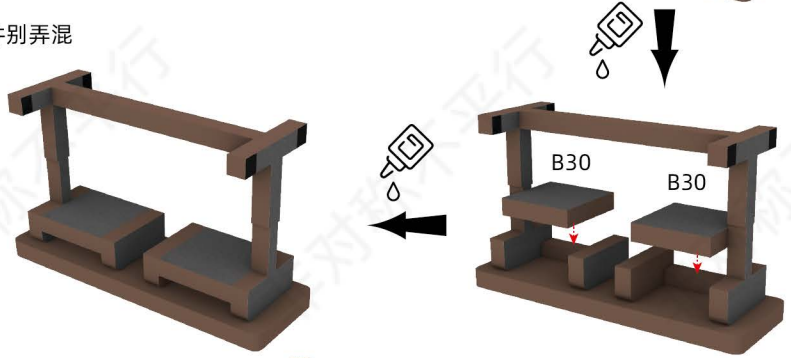

STEP 34



STEP 35

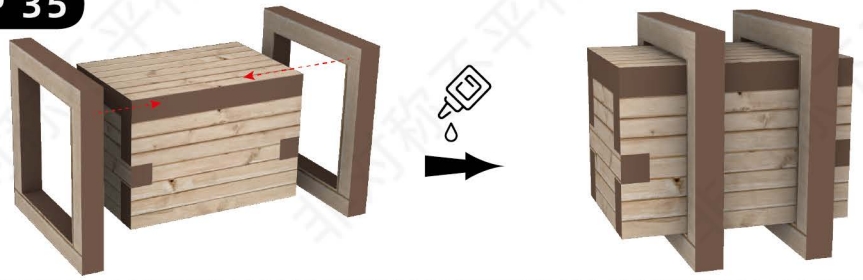

STEP 36

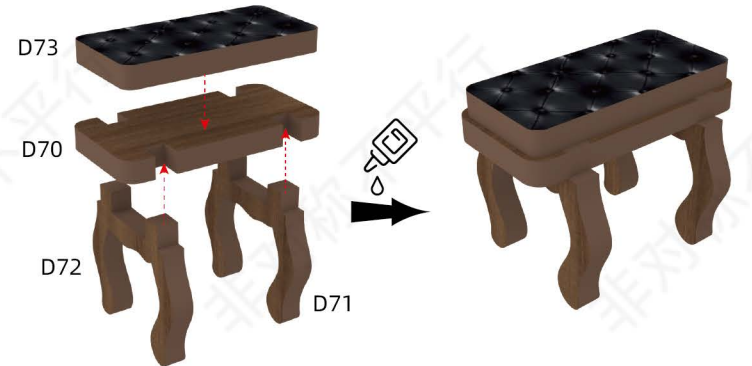

STEP 37

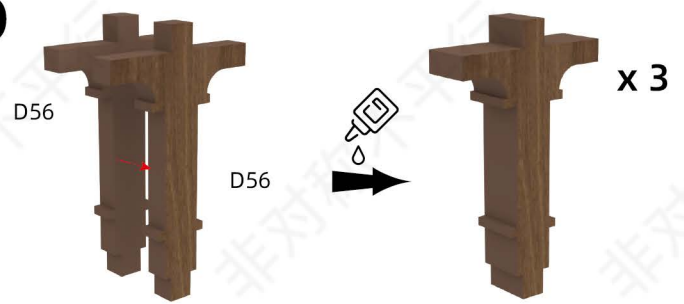

STEP 38



STEP 39

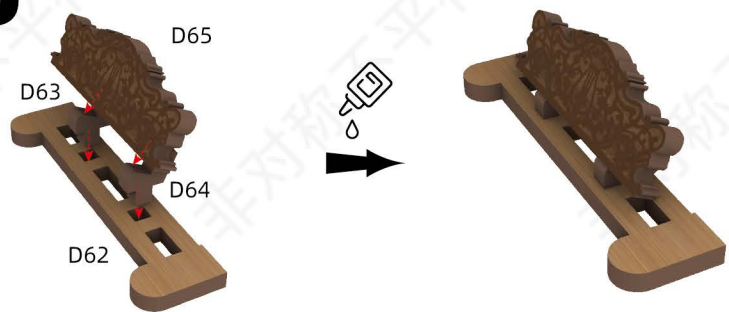

STEP 40

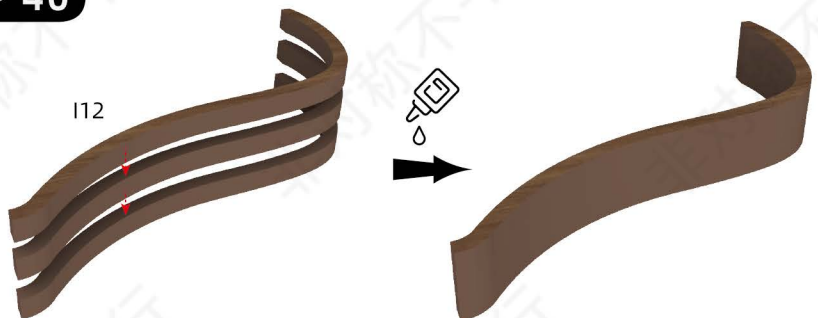

STEP 41



STEP 42



STEP 42

STEP2



STEP 42



STEP 43

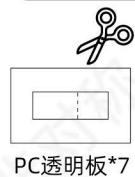

穿过孔位

相同板件 B62/C4

胶水位置

相同板件 B60/C5



门板不使用胶水为可活动件，位置示意

相同板件 B59/C6

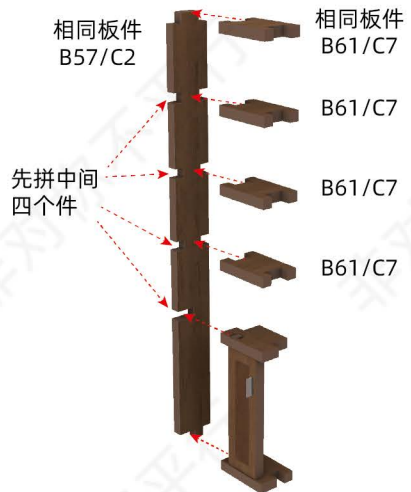

上下两个件可点胶加固，注意活动板件不上胶

相同板件 B58/C3

相同板件 B63/C8

两边有尖角为顶部

C1

x 7



STEP 44

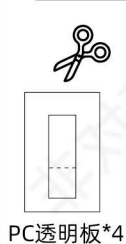

穿过孔位 C17

胶水位置

C16



C13

C12

C18



门板不使用胶水为可活动件，位置示意

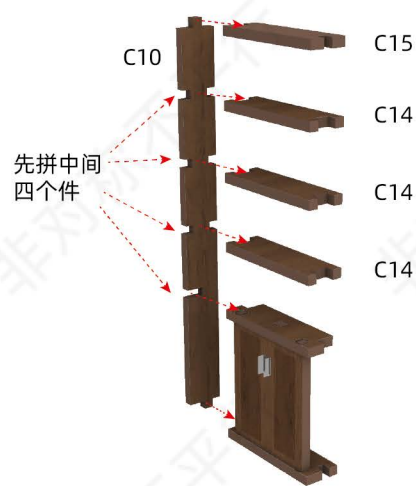

上下两个件可点胶加固，注意活动板件不上胶

C11

C19

两边有尖角为顶部

C9

x 2



STEP 45

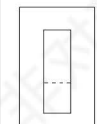

PC透明板*2

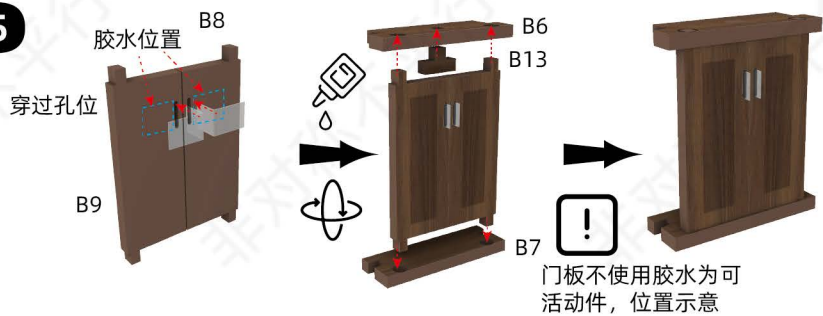

28

STEP 46

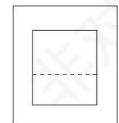

PC透明板*2

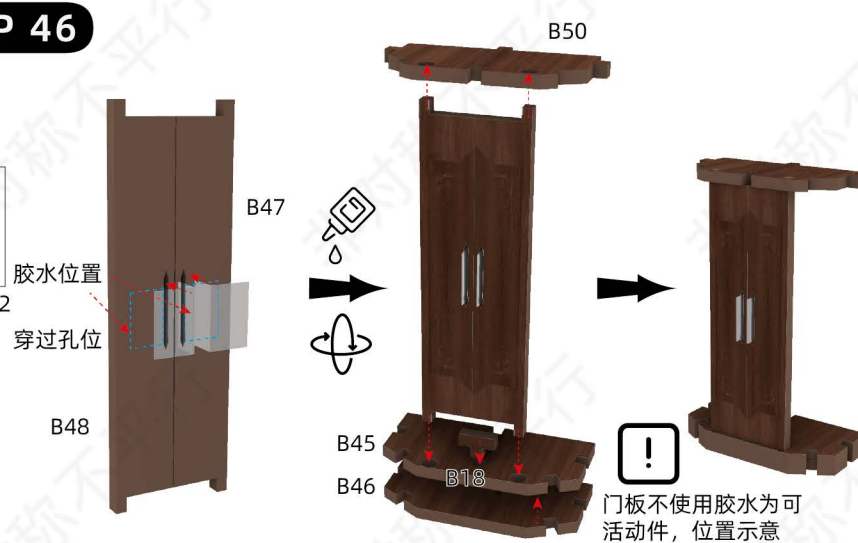

29

STEP 46



STEP 47



STEP 48



STEP 48

STEP 48-1



STEP 48-2



STEP 49

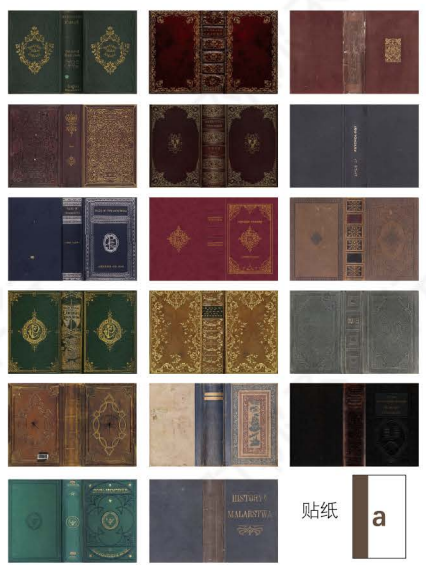

贴纸 a

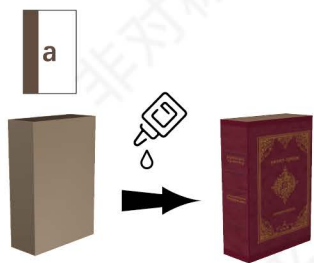

贴纸自带粘性
不粘可加胶水固定

STEP 50

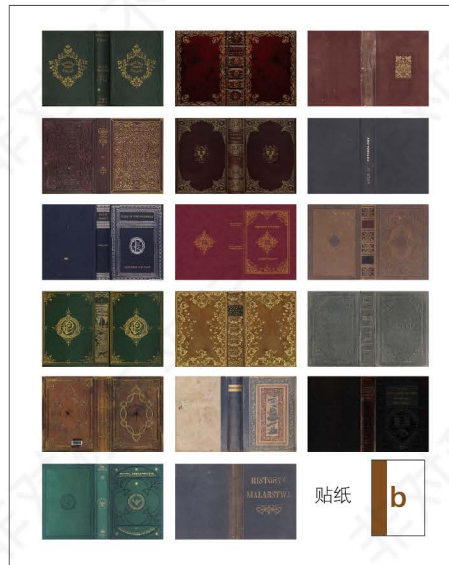

贴纸 b



贴纸自带粘性
不粘可加胶水固定

STEP 51

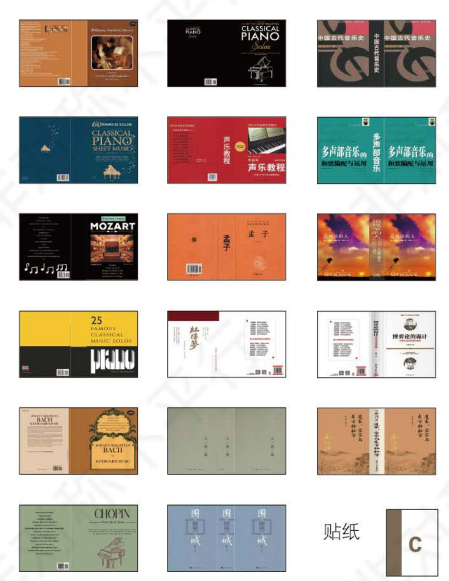

贴纸 c

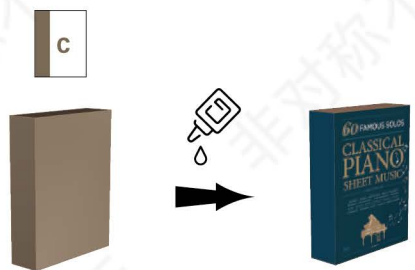

贴纸自带粘性
不粘可加胶水固定

STEP 52

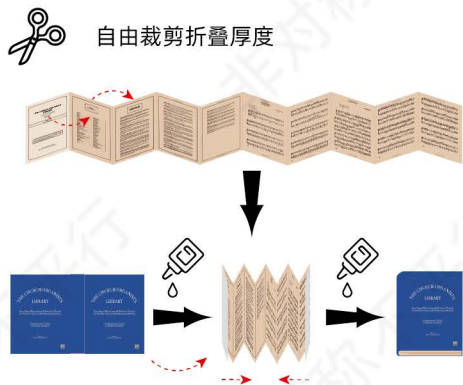
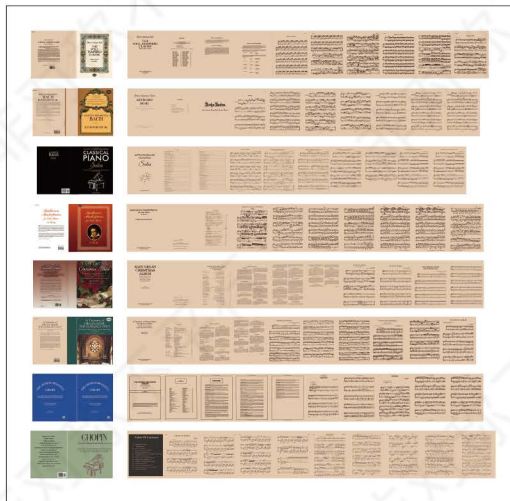

STEP 53

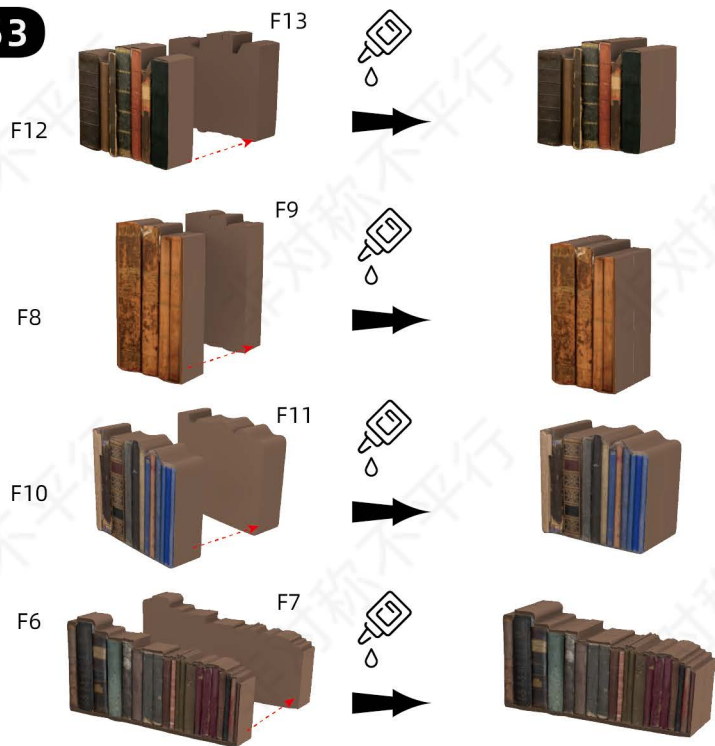

STEP 54

x 7

STEP 43



STEP 51



STEP 50



STEP 49



自由组合



STEP 54

STEP 55

STEP 44



x 2

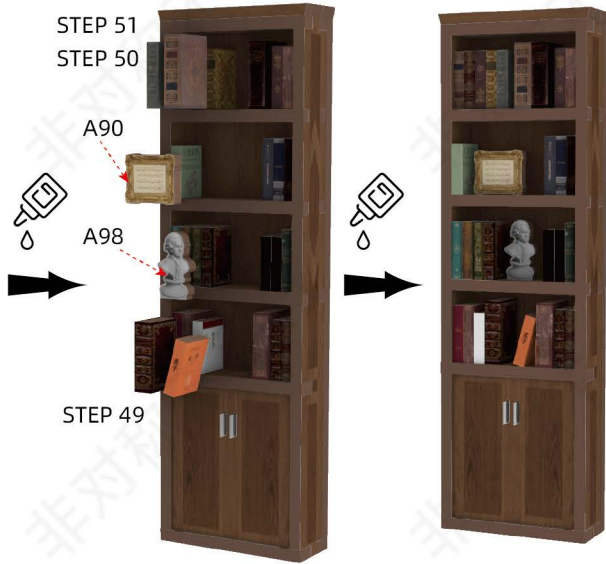

自由组合

! 独立柜子

STEP 45

x 1



STEP 53

STEP 15

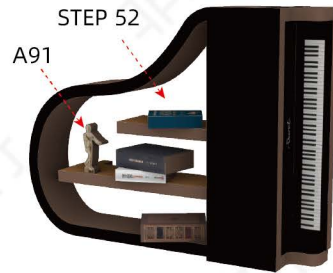

STEP 52

A91

STEP 56

STEP 13

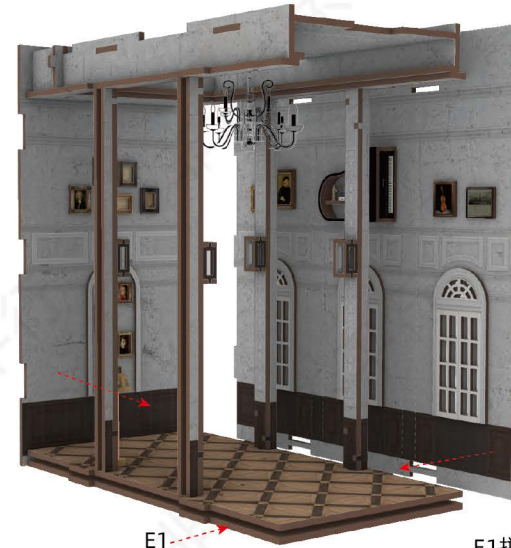

STEP 16

E1

E1拼接需粘胶水



STEP 57

STEP 54 X5

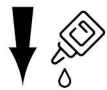

STEP 58

STEP 55 X2



STEP 59

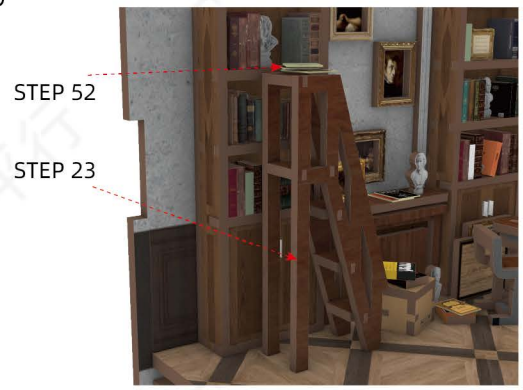
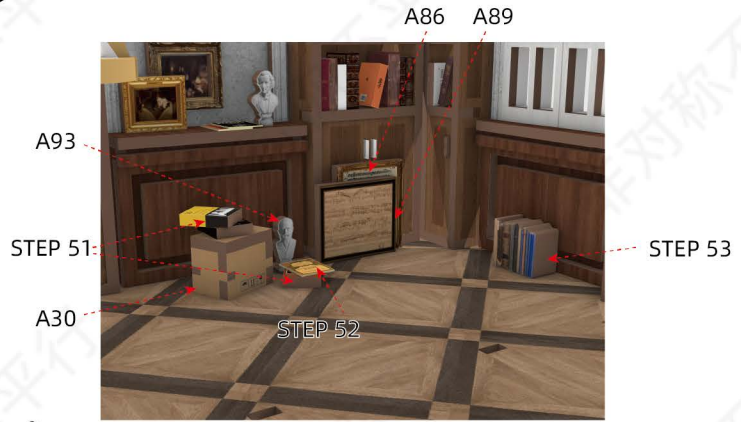

STEP 59

有插槽处可无需胶水

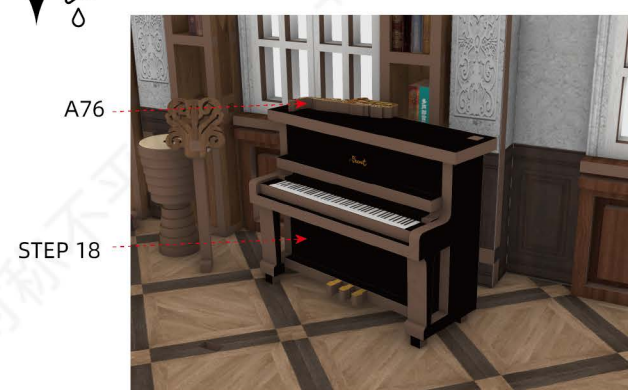

STEP 59

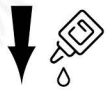
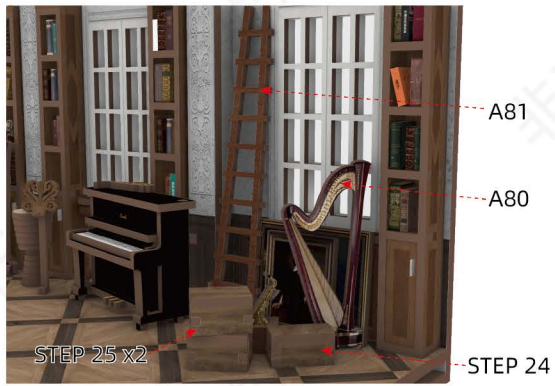

STEP 60

有插槽处可无需胶水

STEP 36

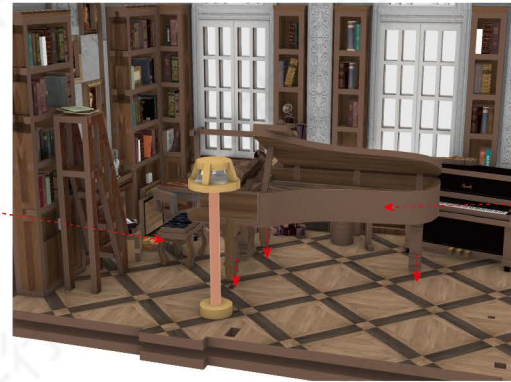

A101

STEP 19

STEP 60

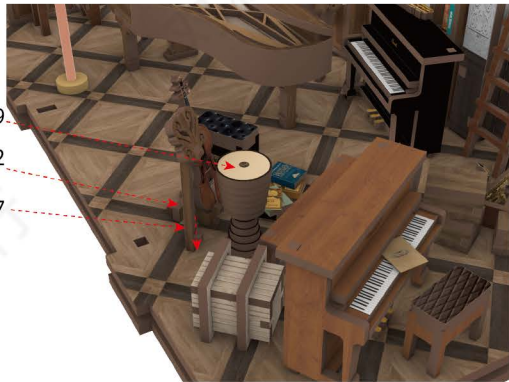
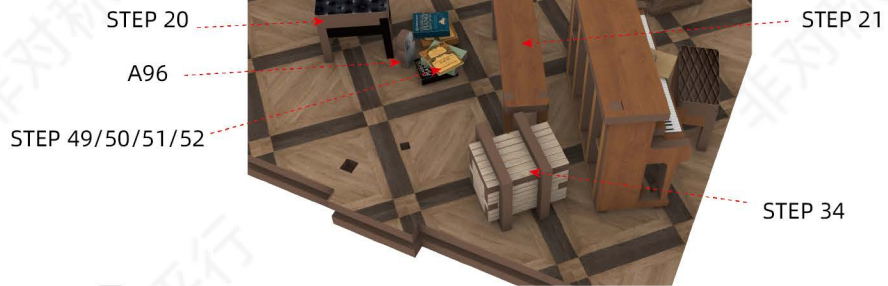

STEP 61

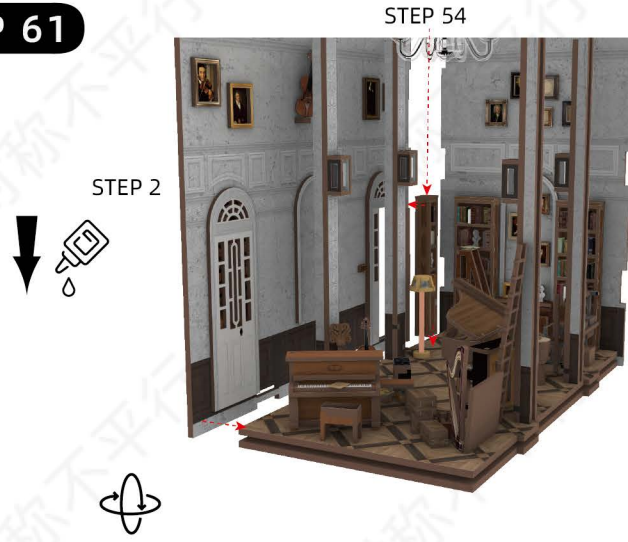

STEP 61



A83 A84 A85 A23

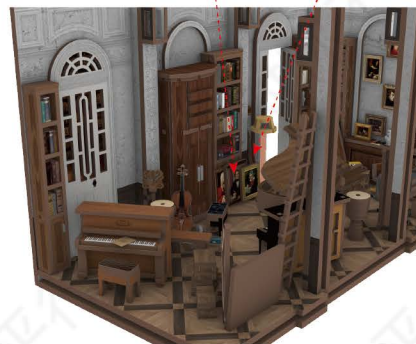

STEP 62

STEP 61



17



STEP 62

盖上顶盖
无需胶水
方便更换电池

E2

触摸位置
开关灯

触摸开关位置
顶住开关线

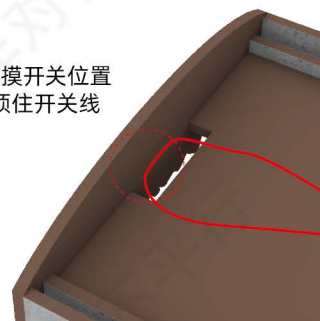

STEP 62

完成

