

BOOK NOOK KIT NEBULA RESTROOM



350 PCS



6-8 HRS



14+

Avertissement de Sécurité

- Pour votre sécurité, veuillez lire ce manuel avant de commencer.
- Ce produit est adapté aux personnes de plus de 14 ans, les enfants doivent être sous la surveillance de leurs parents.
- Toute modification ou altération non autorisée de ce produit endommagera vos droits et intérêts liés à ce produit.

Attentions

- Retirez soigneusement les accessoires de la planche pour éviter que les pièces ne se cassent. Les points de rupture peuvent être lissés avec une lime.
- Ne détachez pas toutes les pièces en même temps.
- De la colle est nécessaire à certains endroits. Après avoir collé, laissez le produit intact pendant deux heures pour assurer une adhésion solide.
- Pour gagner du temps, vous pouvez d'abord faire l'étape de collage, puis assembler le reste.
- Si la pièce à emboîter est trop serrée, vous pouvez la limer un peu avant de l'assembler; si l'installation est trop lâche, vous pouvez utiliser de la colle pour ajuster lors de l'assemblage.
- Les enfants doivent être accompagnés par un adulte lors de l'assemblage.
- Veuillez conserver ce manuel pour référence future.

Maintenance

Ne placez pas le produit près de la chaleur ou de l'eau.
Utilisez un chiffon doux pour nettoyer le produit.
Ne pas utiliser de produits chimiques pour nettoyer le produit, comme des nettoyeurs pour vitres, des solvants, de l'alcool, de l'ammoniaque, ou des abrasifs.

Safety Warning

- For your safety, please read this manual before starting.
- This product is suitable for people over the age of 14, children should be under the supervision of their parents.
- Any unauthorized modification or alteration of this product will damage your rights and interests related to this product.

Cautions

- Carefully remove the accessories from the board to prevent the parts from breaking. The breaking points can be smoothed out with a file.
- Do not detach all the parts at the same time.
- Glue is needed in some places. After gluing, leave the product intact for two hours to ensure a strong bond.
- To save time, you can first do the gluing step, then assemble the rest.
- If the part to be fitted is too tight, you can file it a little before assembling; if the installation is too loose, you can use glue to adjust during assembly.
- Children must be accompanied by an adult during assembly.
- Please keep this manual for future reference.

Maintenance

Do not place the product near heat or water.
Use a soft cloth to clean the product.
Do not use chemical products to clean the product, such as glass cleaners, solvents, alcohol, ammonia, or abrasives.

Notes: Merci pour votre achat, si des pieces sont manquantes ou abimévous pouvez contacter le support client service.booknook@gmail.com

Notes: Thank you for your purchase. If any pieces are missing or damaged, you can contact customer support at service.booknook@gmail.com

● Accessoires | Atccessories

 <p>LED 灯 LED Light*1</p>	 <p>Capteur tactile Touch line*1</p>	 <p>Boitier piles Battery box*1</p>	 <p>Autocollant Sticker*1</p>	 <p>Lime Frosted rod*1</p>
 <p>Papier Wax Wax paper*1</p>	 <p>Papier Autocollant Paper*1</p>	 <p>PVC *1</p>	 <p>Protection poussiere Dustproof sheet*1</p>	 <p>Grande perle bleue Large blue bead*1</p>
 <p>Perle transparente Clear bead*1</p>	 <p>Perle Jaune Yellow bead*1</p>	 <p>Perle Bleue Blue bead*1</p>		

● Liste planche en bois | Wood Block List

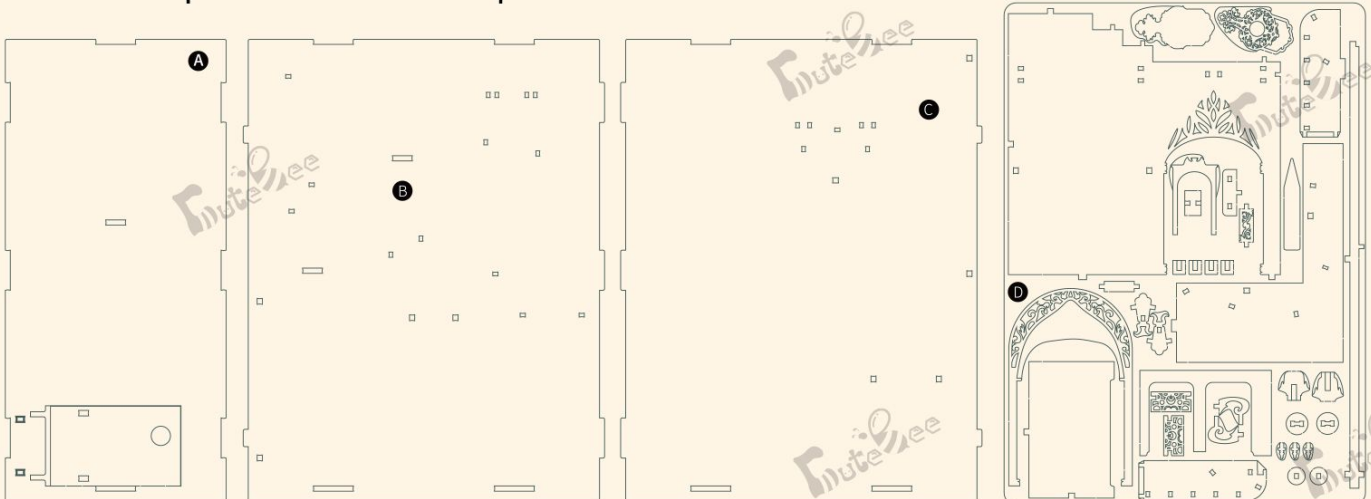

Attention



Handle Accessories Carefully
Manipuler avec précaution

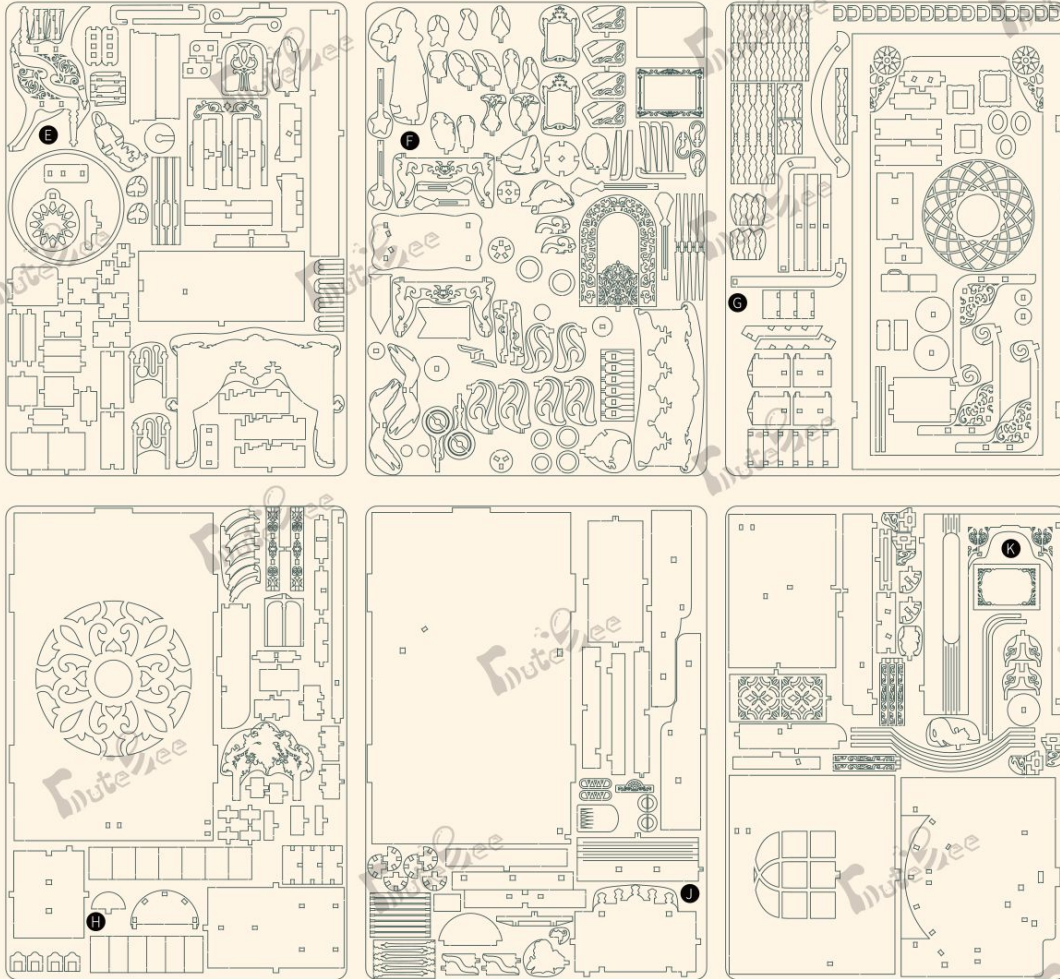

STEP 1

Avant de commencer, vérifiez le fonctionnement des LEDs
Before assembling, please check the LED lights can work properly.

Comme illustré sur l'image, avant de commencer à assembler, veuillez utiliser les piles pour tester si le module d'alimentation de la lumière fonctionne correctement.

La méthode de test est la suivante :

1. Connectez le port de câble de la lumière LED et le port de câble du panneau capteur tactile au port correspondant du compartiment à piles;
2. Insérez deux piles AAA;
3. Touchez le panneau capteur tactile. Si la lumière fonctionne, cela signifie qu'il n'y a pas de problème avec l'unité d'alimentation de la lumière; si la lumière ne fonctionne pas correctement, veuillez contacter le service client pour un remplacement.

As shown in the image, before starting to assemble, please use the batteries to test whether the light's power supply unit can work properly. The testing method is as follows:

Connect the wire port of the LED light and the wire port of the touch sensor panel to the corresponding port of the battery compartment; Insert two AAA batteries;

Touch the touch sensor panel. If the light works, it means there is no problem with the light's power supply unit; if the light does not work properly, please contact customer service for a replacement.

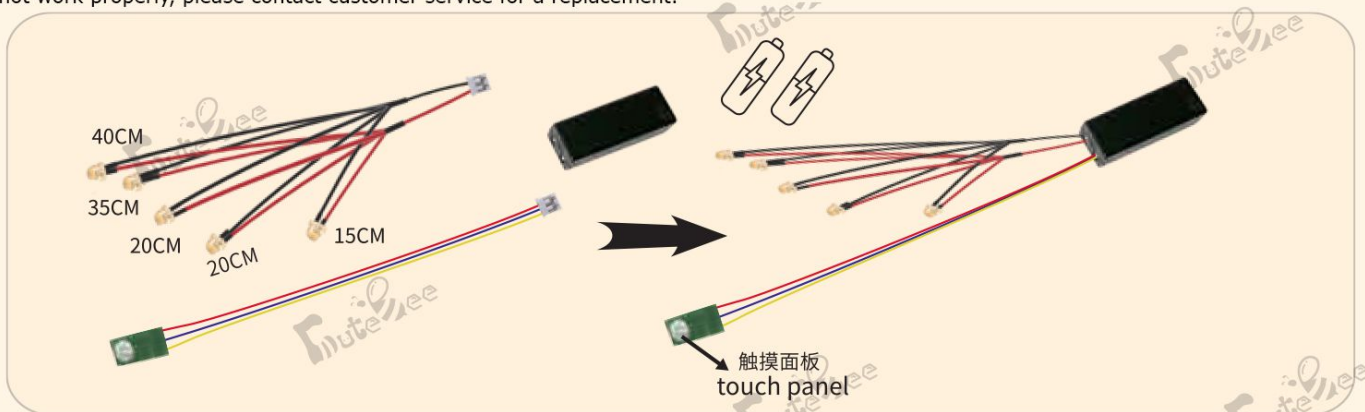

STEP 2

Cet Outil peut vous aider à sortir les petites pièces
This tool can help you take out Small Parts



D25

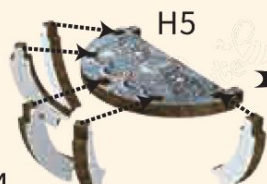

H27

H4

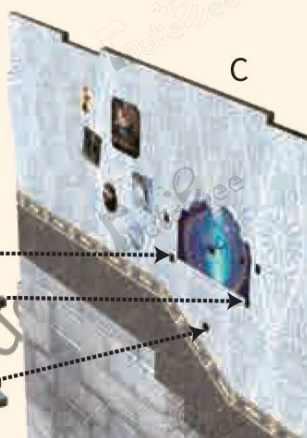

STEP 3

STEP 2



H9*2



J8

J9

J6



STEP 4

Papier - 3
Paper - 3



G25

G23

G24

G24

G24

G23

D2

D3

F19

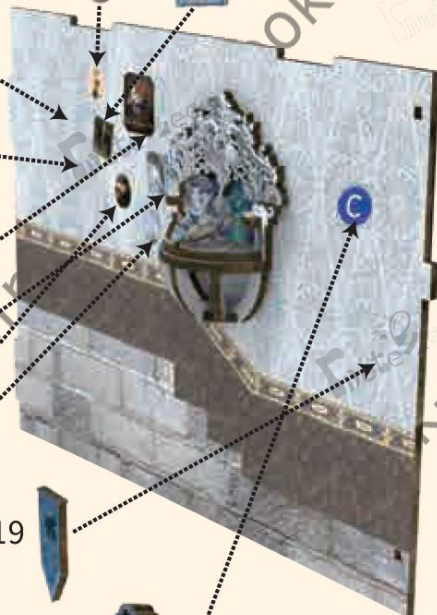

STEP 5

Retirez les adhésifs | Peel off the adhesive backing to paste

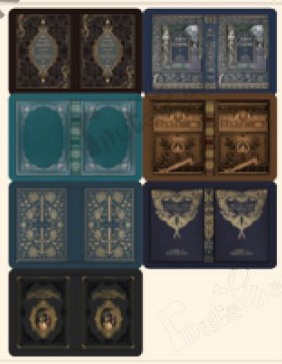

Papier -1 | Paper -1



H3



Livre Book X7

STEP 6

Papier -5 | Paper -5



Papier-4 | Paper-4



Livre Origami | Origami book

Plier le livre comme ci-dessus
Fold the book like this

STEP 7



STEP 8

F9

书本*3
Book*3



STEP 9



F18

F14

STEP 7



STEP 8



F7



Livre Origami | Origami book

STEP 10

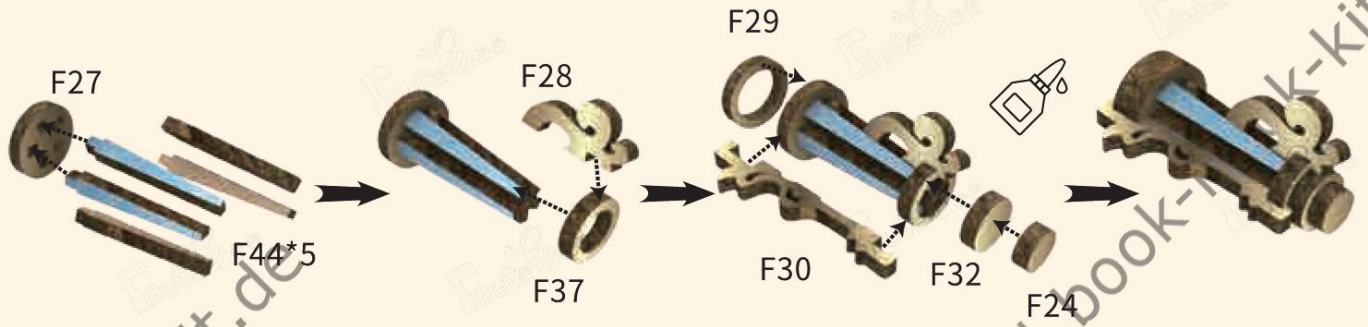

STEP 11

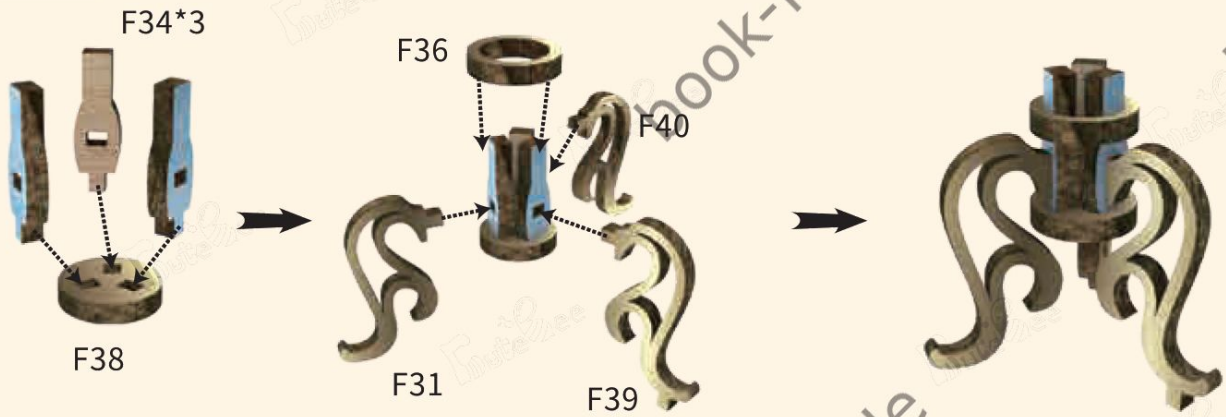

STEP 12

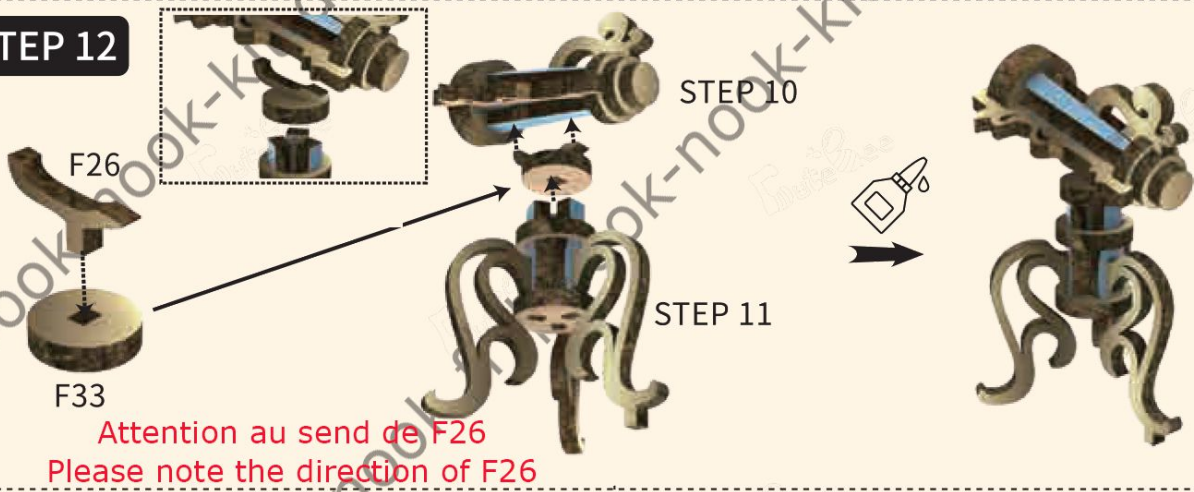

STEP 13

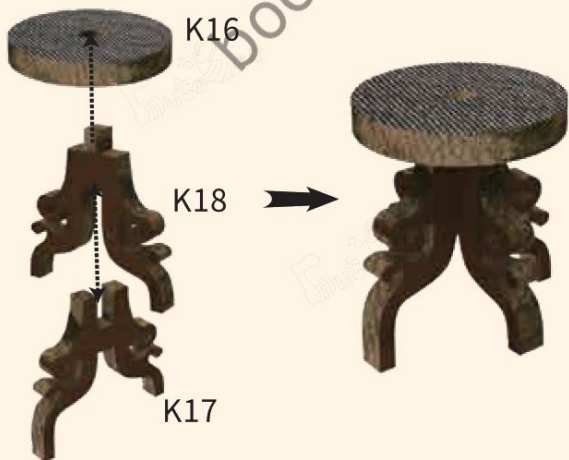

STEP 14



STEP 15

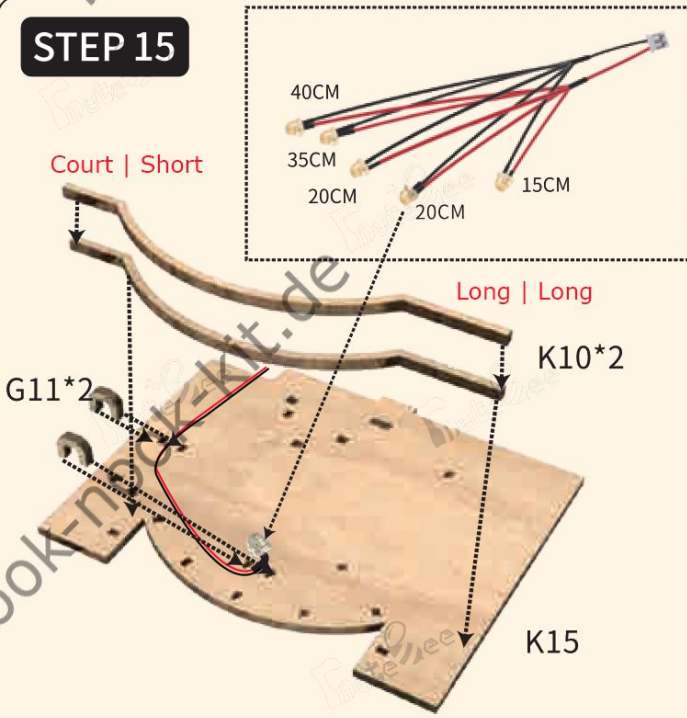

Plier la lumière comme montré
Bend the light wire as shown

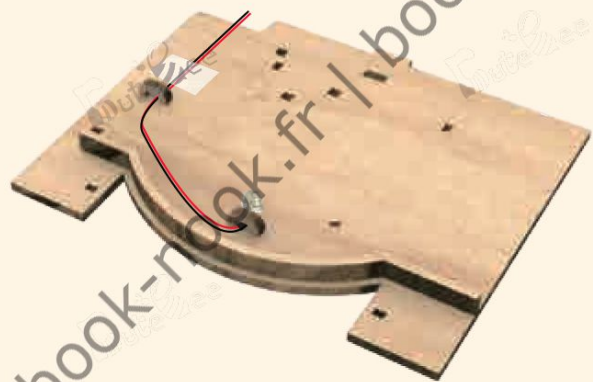

STEP 16

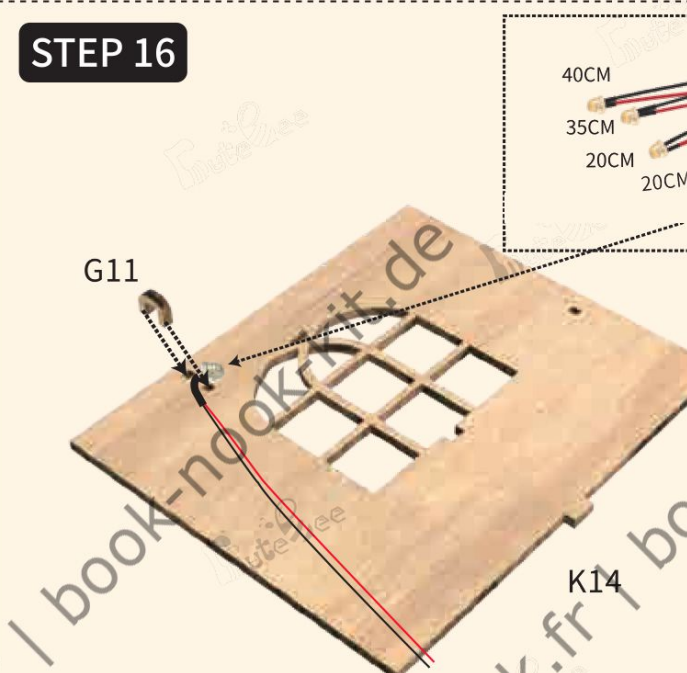

Plier la lumière comme montré
Bend the light wire as shown

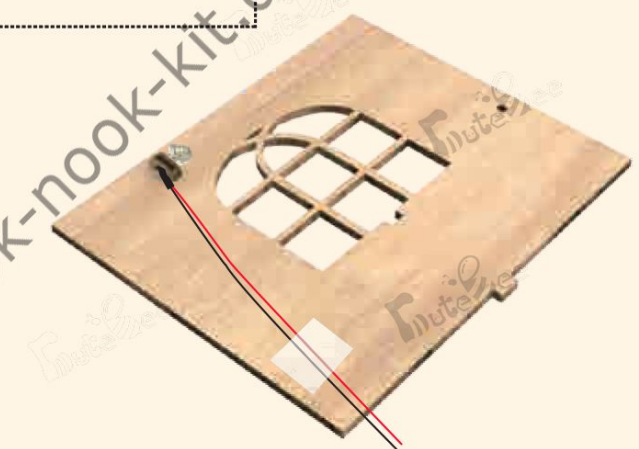

STEP 17

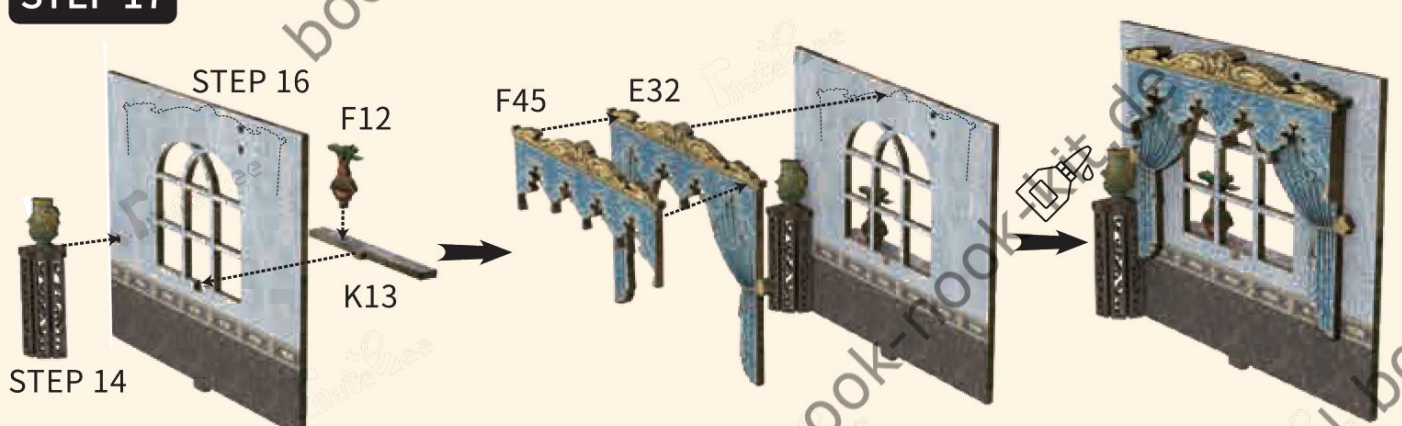

STEP 18

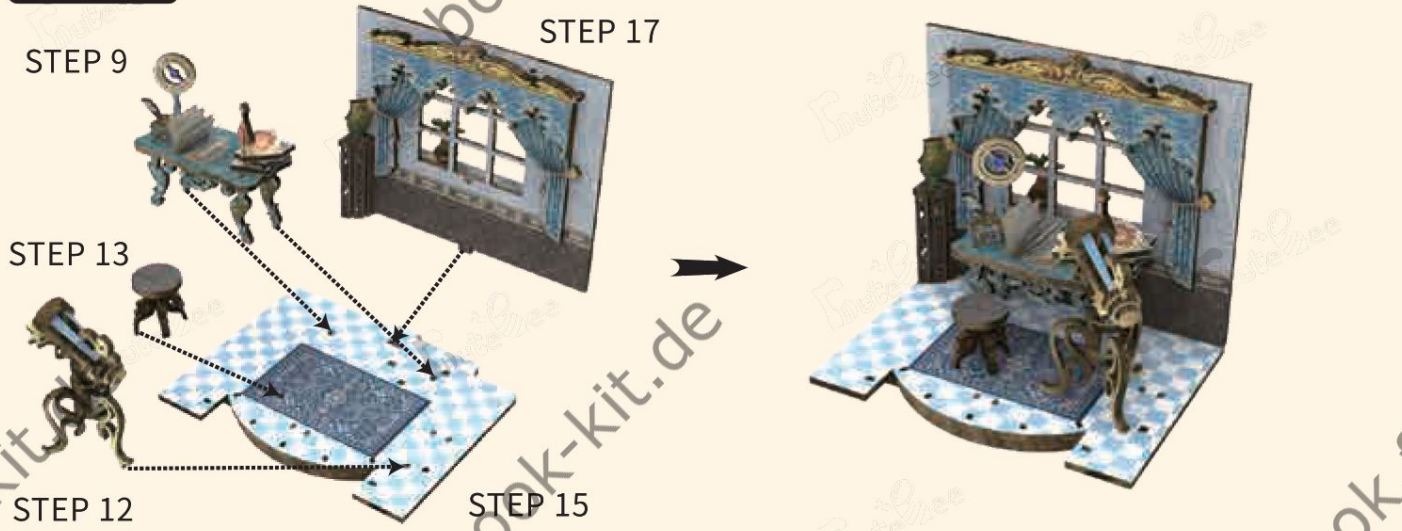

STEP 19

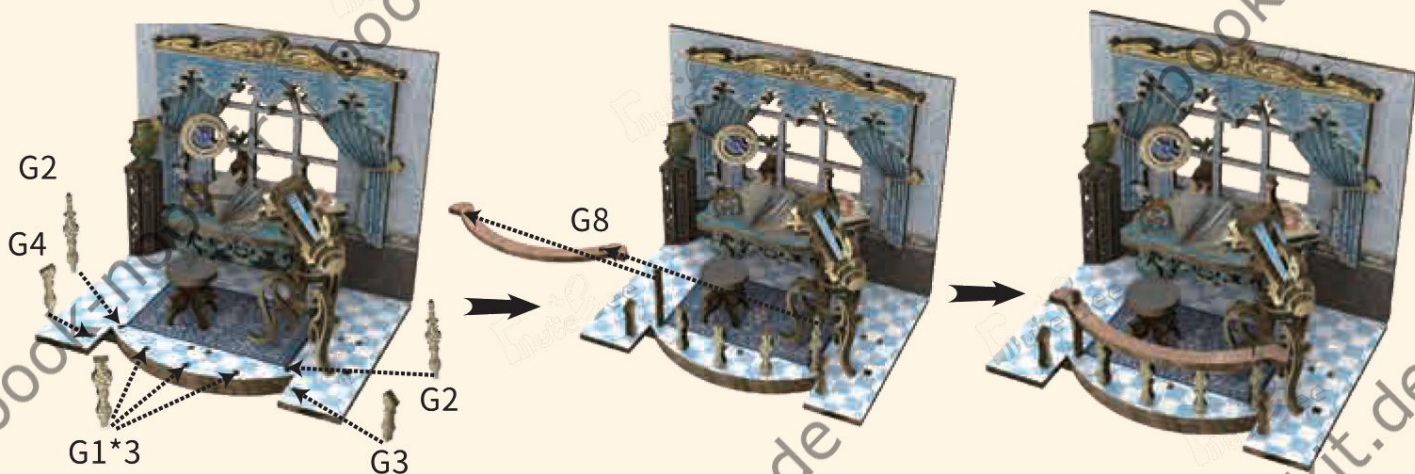

STEP 20



STEP 21



STEP 22

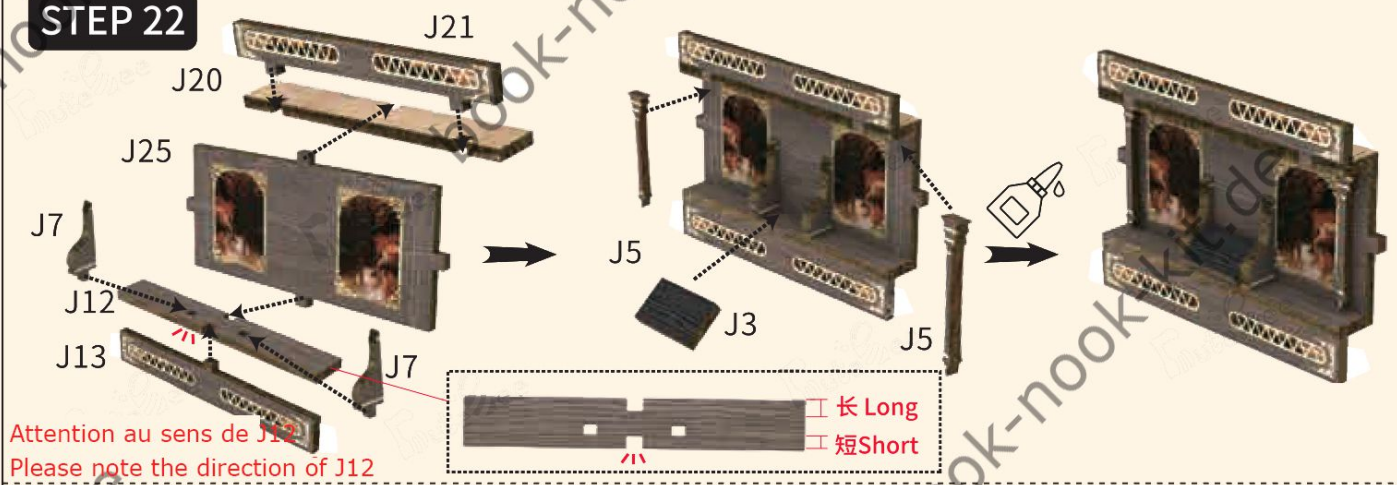

STEP 23

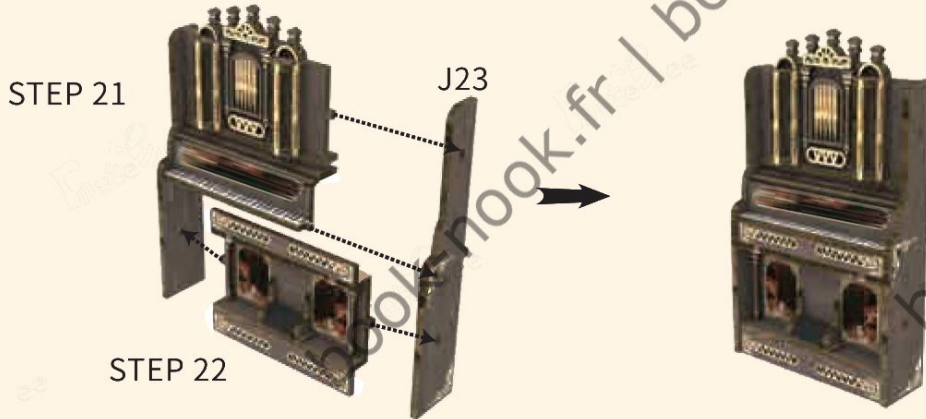

STEP 24

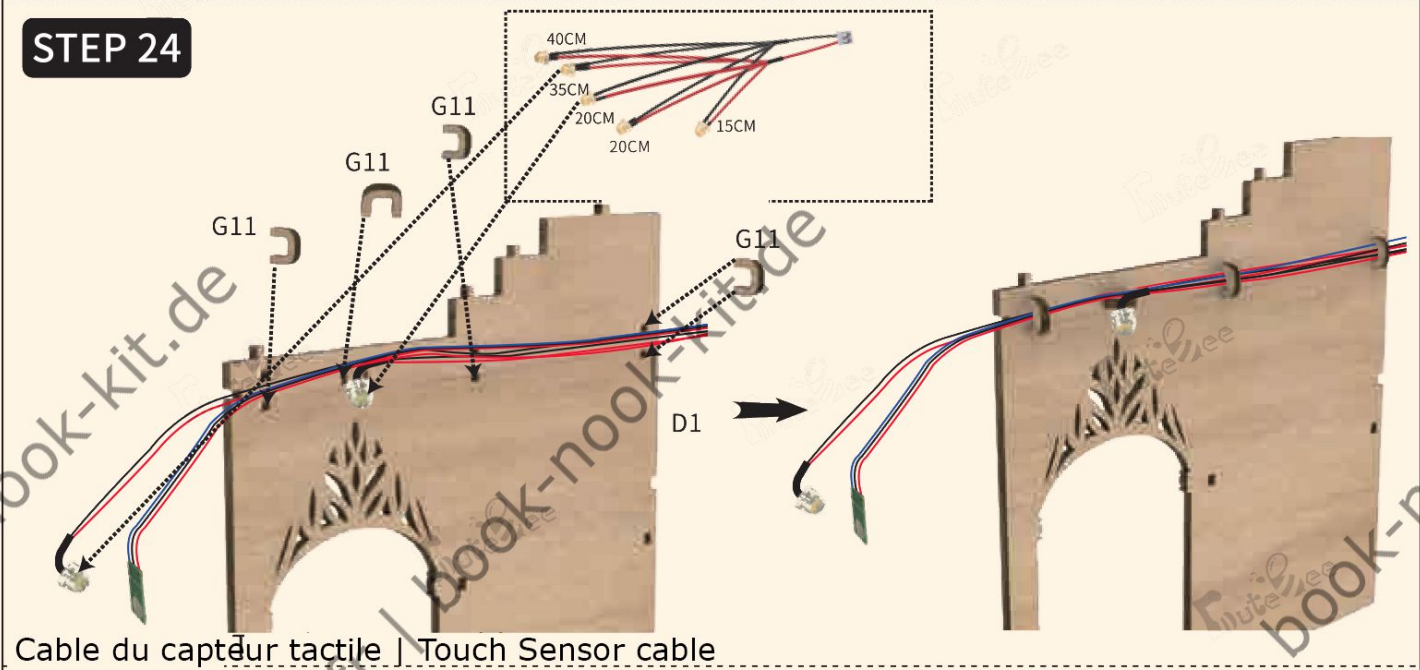

STEP 25

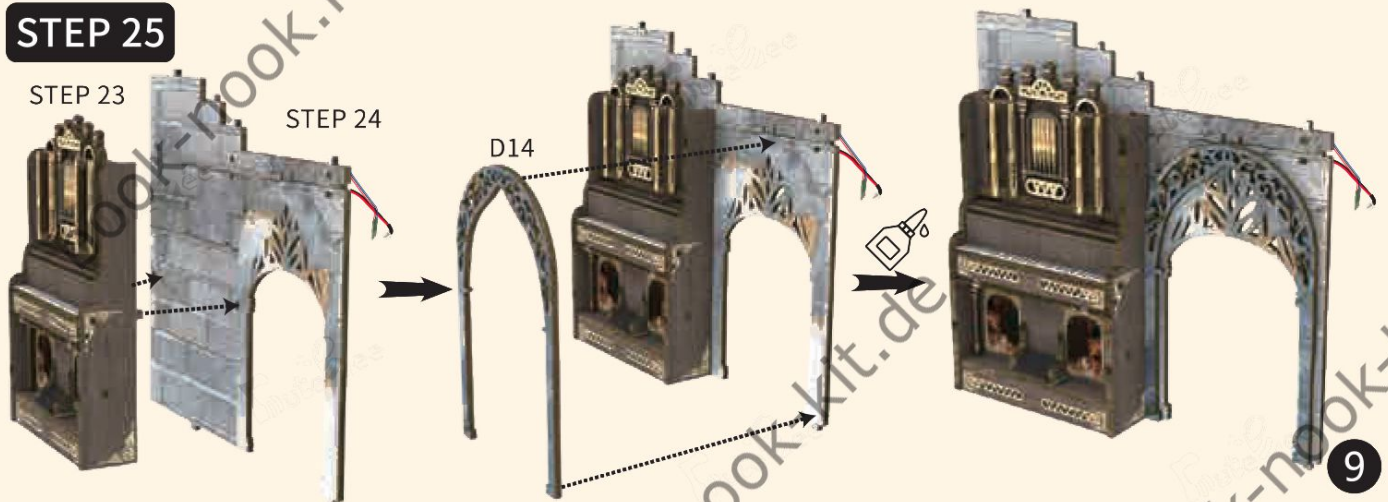

STEP 26



STEP 27

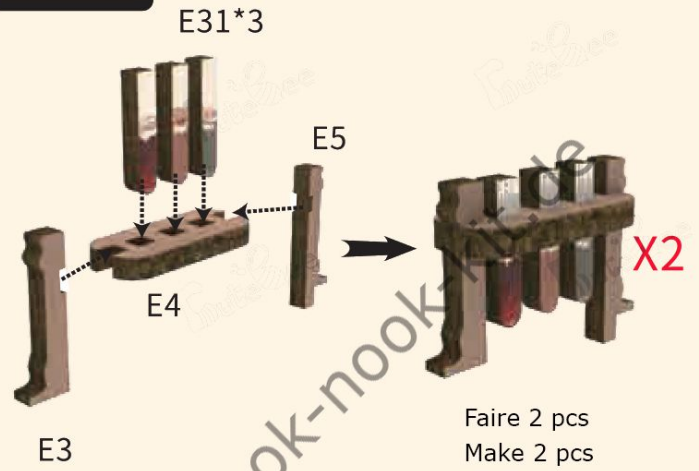

STEP 28

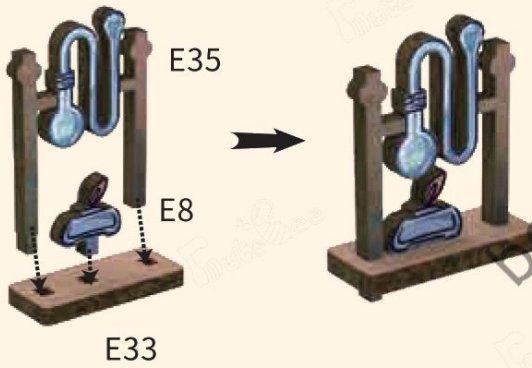

STEP 29

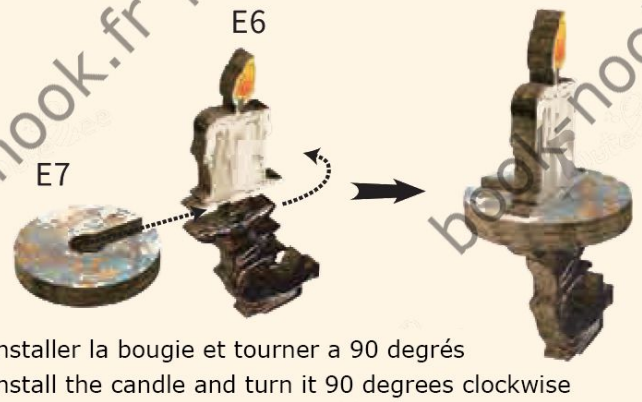

STEP 30

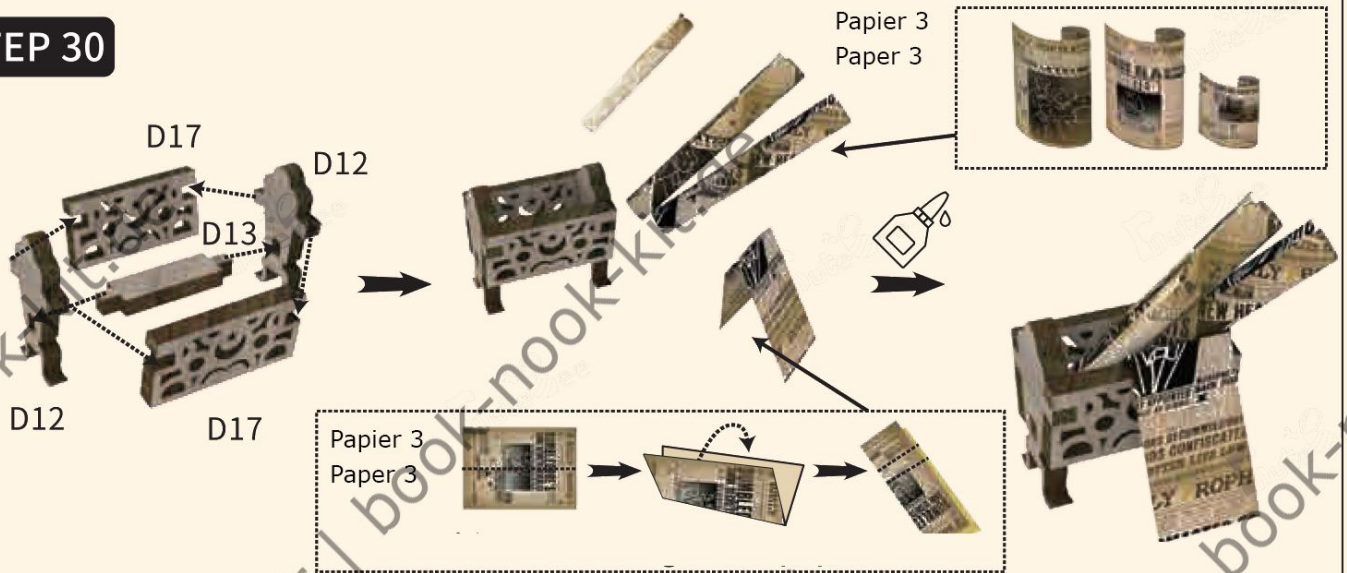

STEP 31

立体书
Origami
Book

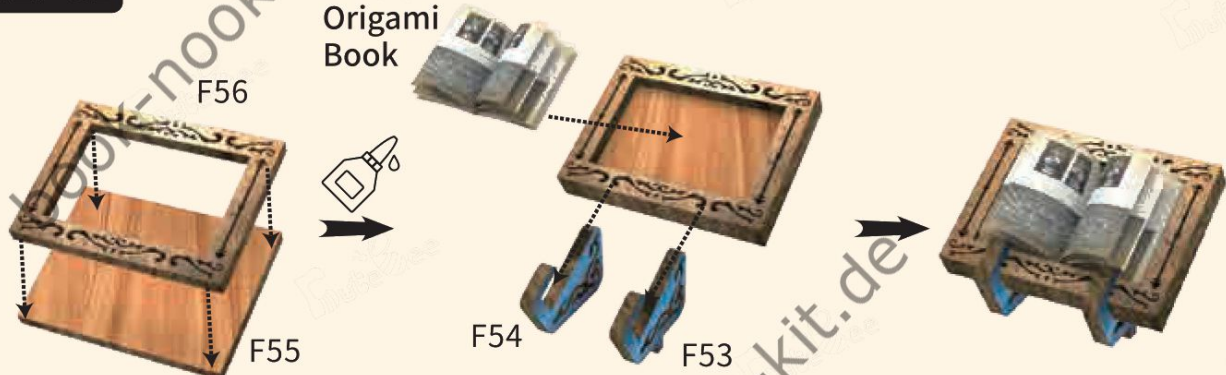

STEP 32

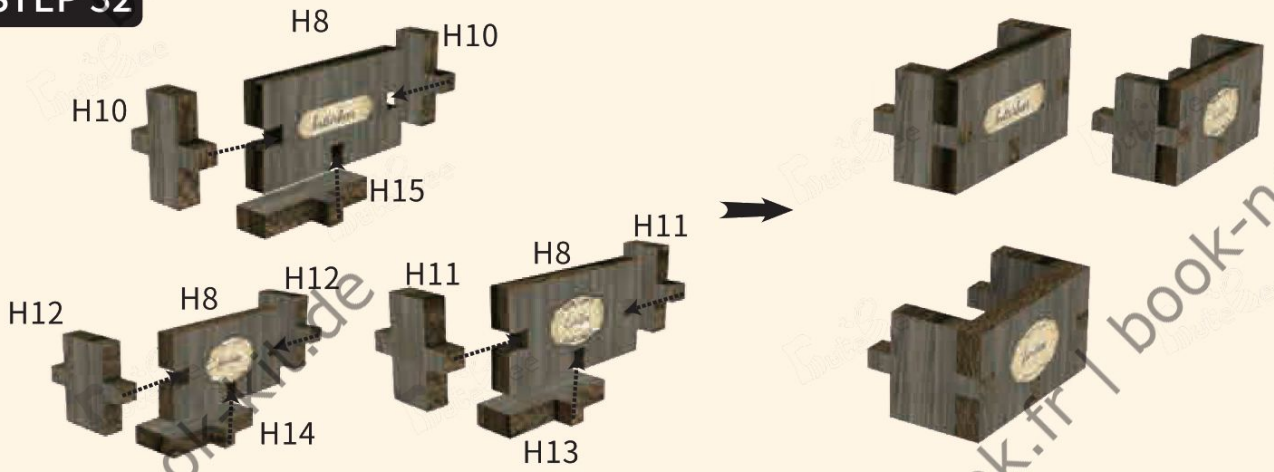

STEP 33

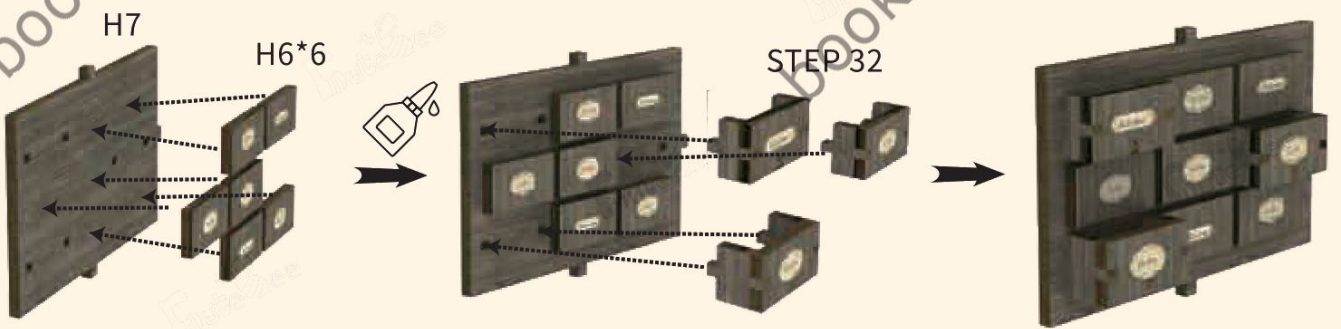

STEP 34

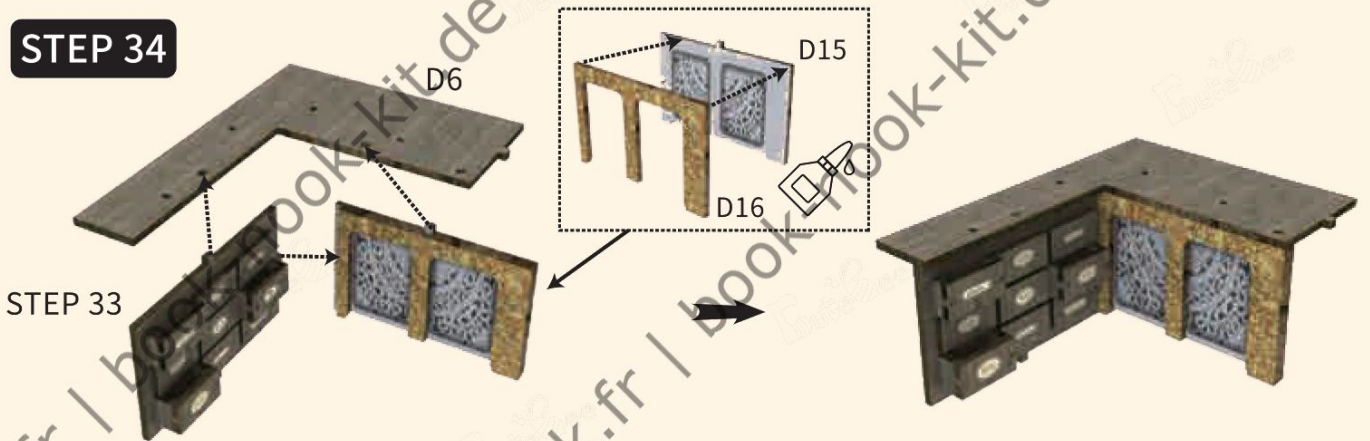

STEP 35

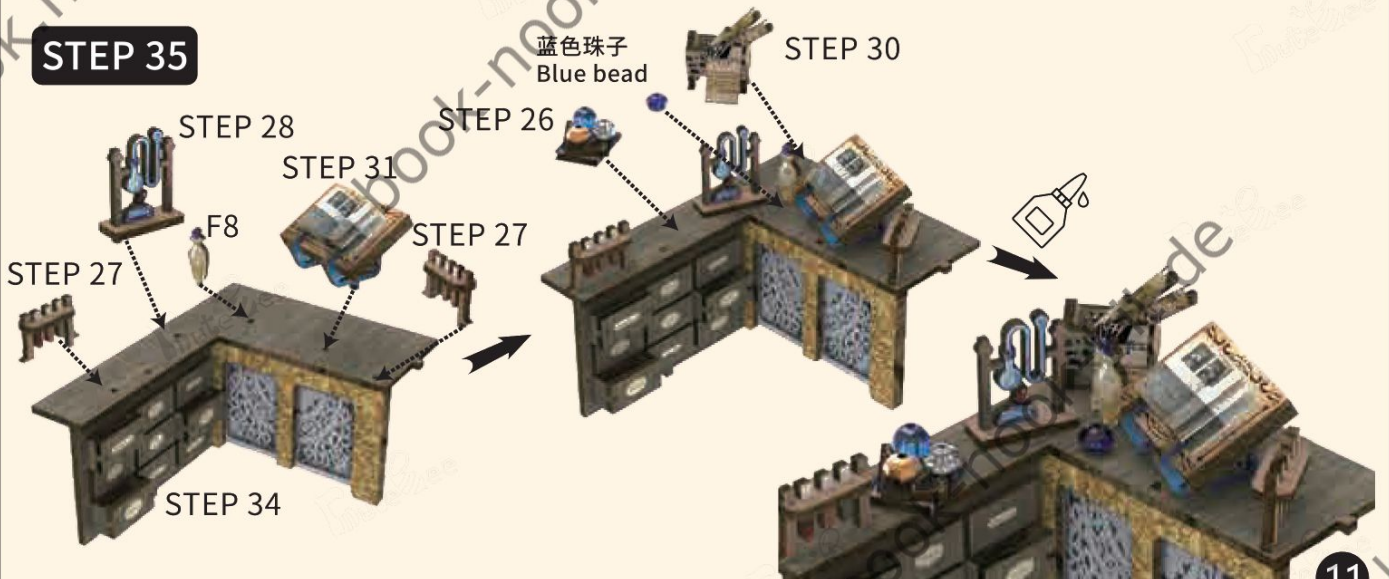

STEP 36

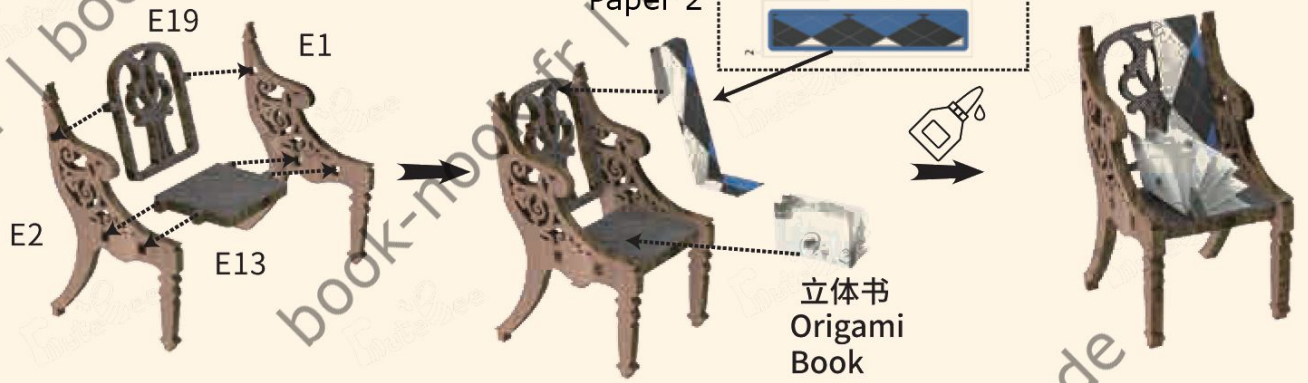

STEP 37

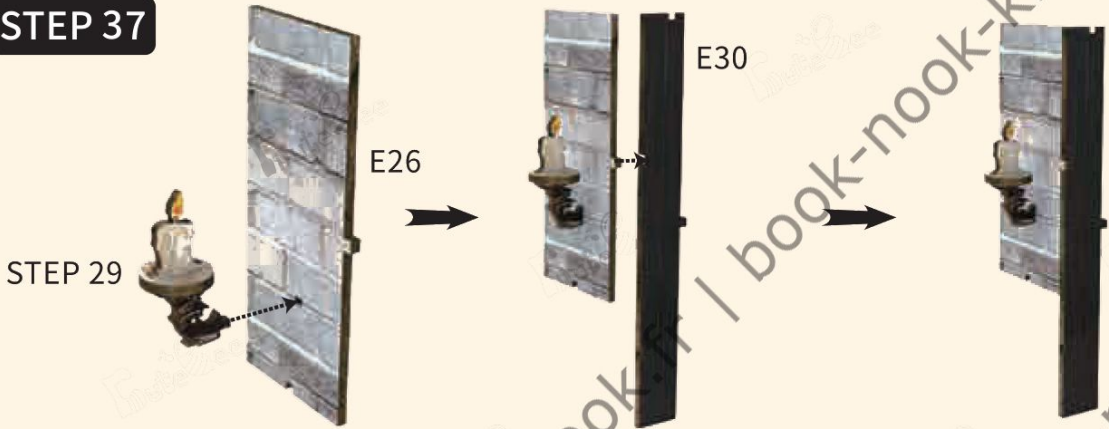

STEP 38

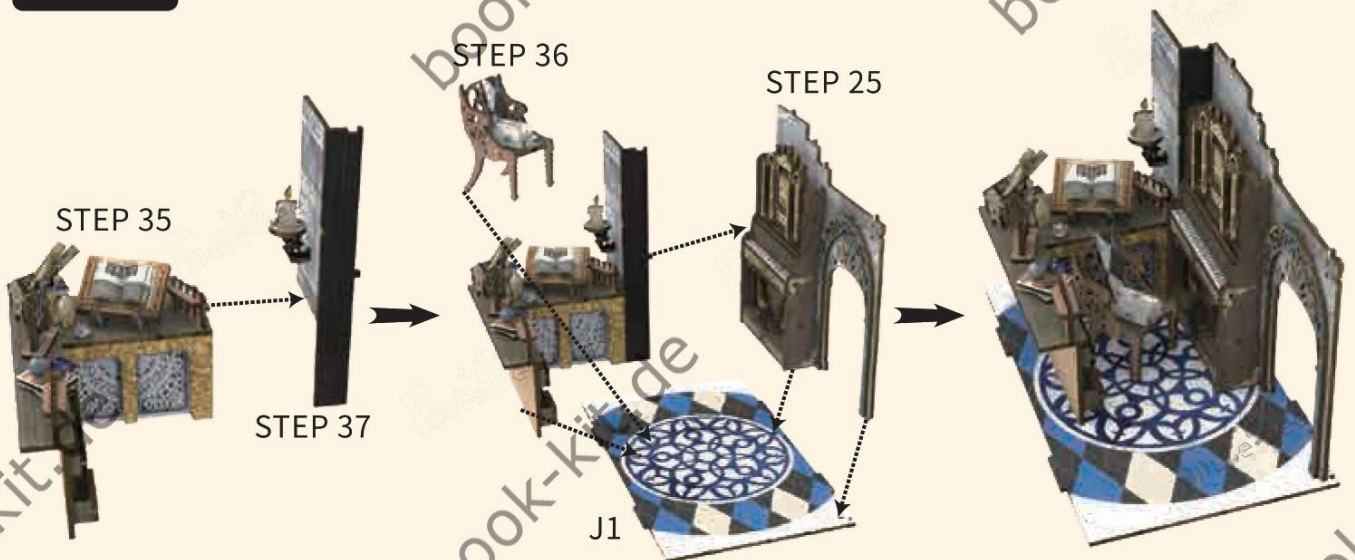

STEP 39

D'abord mettre E16 sur la plaque A, puis E14 a travers E15,
First put E16 on the A plate, then E14 through E15



STEP 40



STEP 39



STEP 41

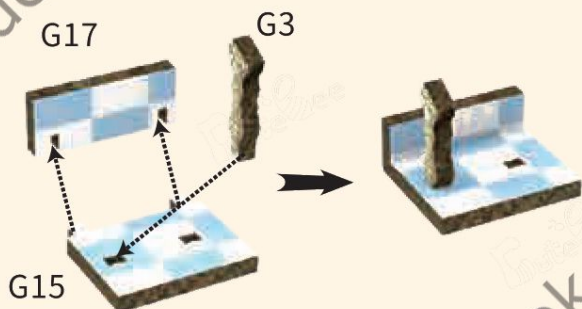

STEP 42

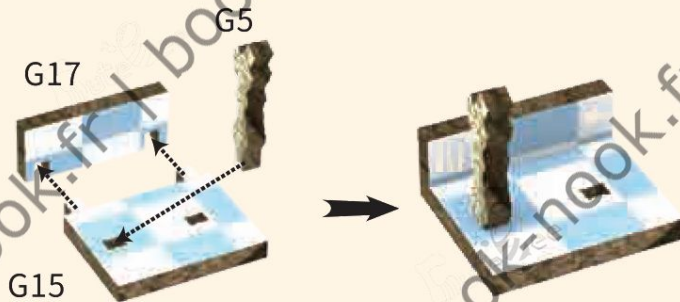

STEP 43

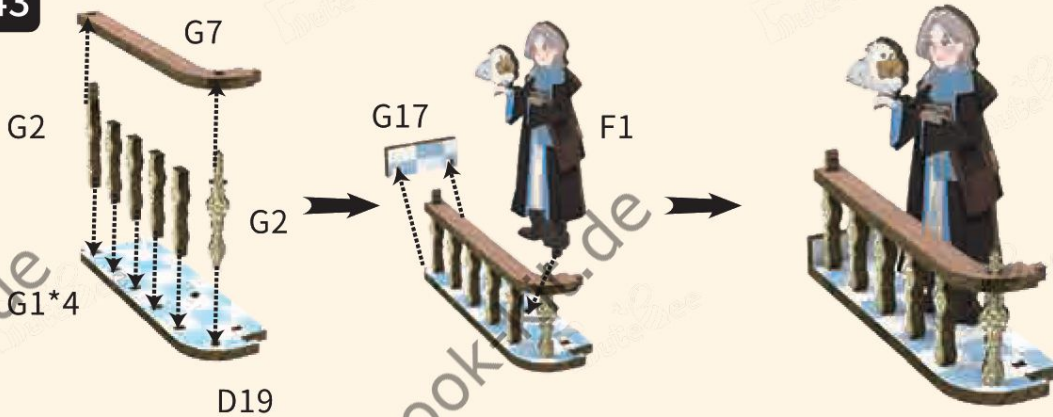

STEP 44

STEP 19

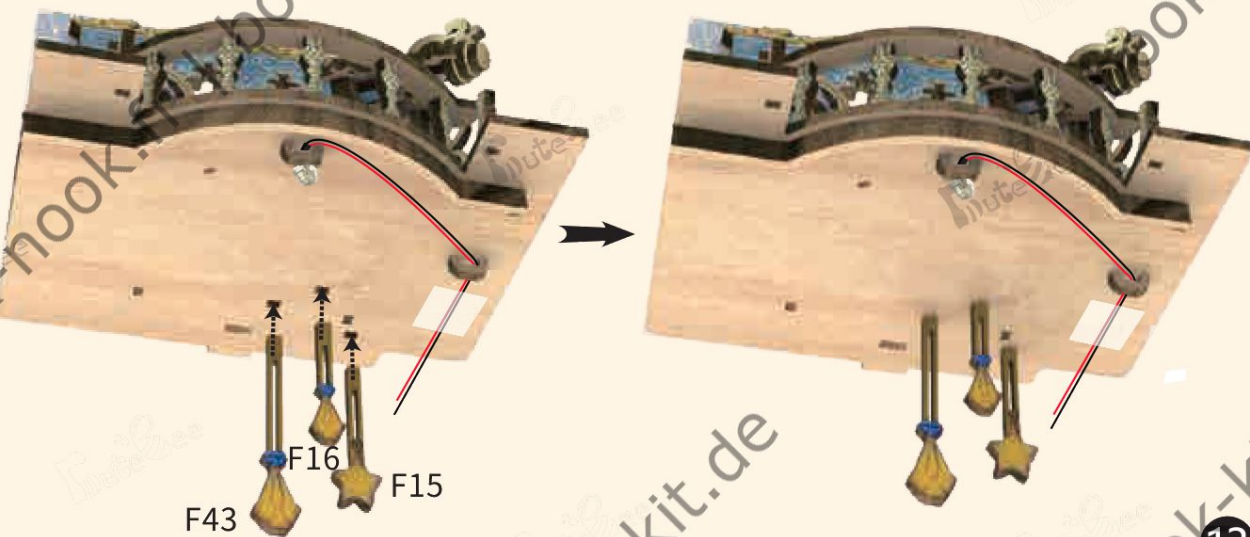

STEP 45

STEP 38

STEP 42

STEP 41

STEP 43

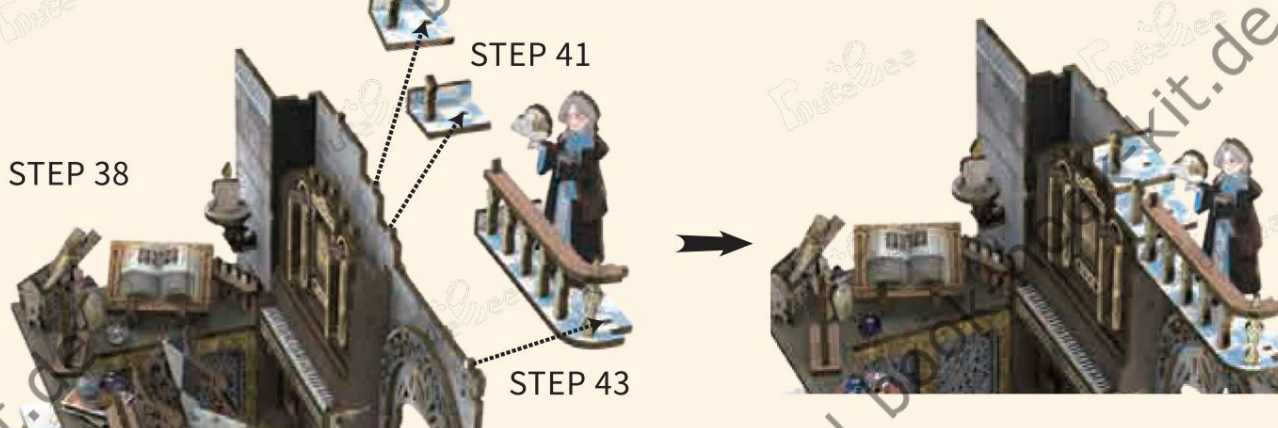

STEP 46

STEP 40

STEP 44

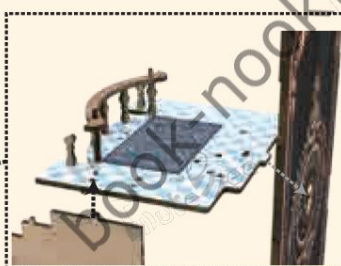

Installez les étapes 40 /44 en premier, puis G10.
Attention au sens de G10
Install STEP40 / 44 first, then install G10, pay attention to the direction of G10

STEP 47

H1



STEP 46

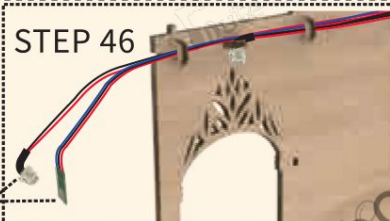

PVC

H1

G11

G11

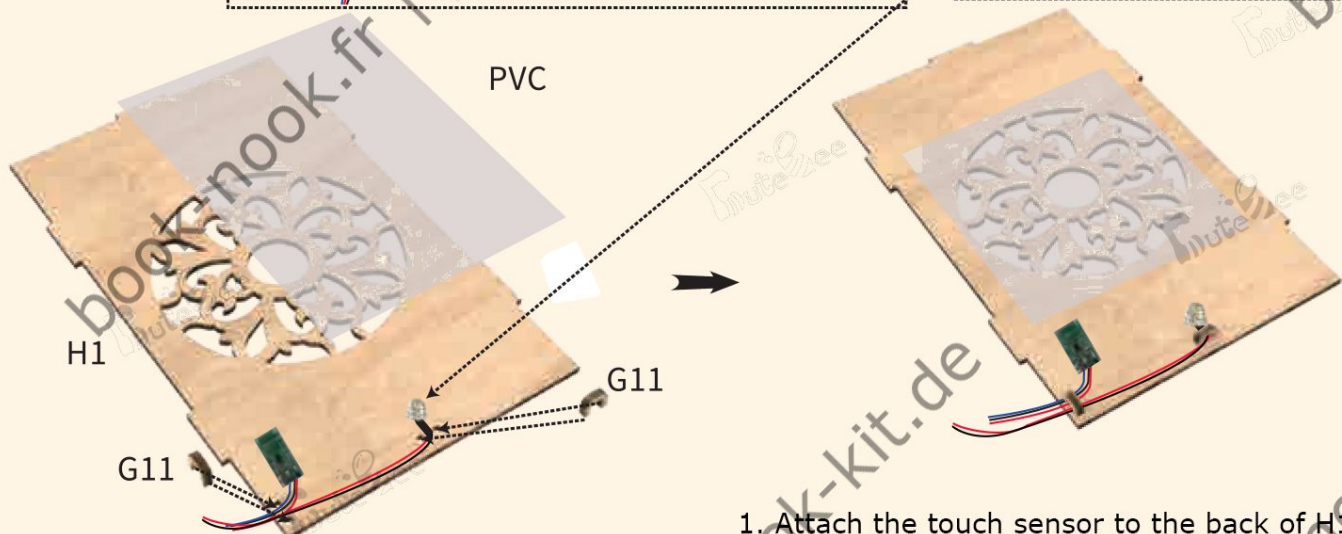

1. Fixez le capteur tactile à l'arrière du H1.
2. Retirez les films du PVC et collez-le centré sur le H1.
3. Utilisez G11 pour relier le fil de 35 cm et le pavé tactile au H1.

1. Attach the touch sensor to the back of H1.
2. Remove the films from the PVC and stick it centered on H1.
3. Use G11 to connect the 35 cm wire and touchpad to H1.

STEP 48

STEP 47

STEP 46

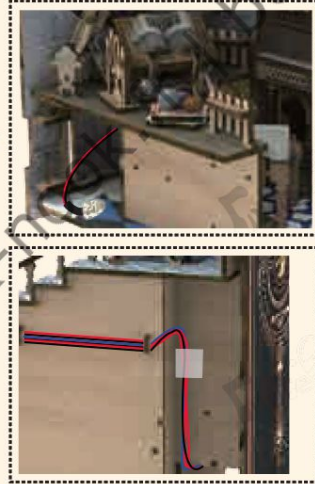

Fixez H1, redressez le fil de 35 cm et le fil du capteur tactile. Installez la dernière lampe à la base de la table, rangez le surplus de fil et fixez avec du ruban comme illustré

Fix H1, straighten the 35 cm light wire and touch sensor wire. Set the last lamp at the table's base, tuck excess wire, and tape as shown..

STEP 49

STEP 48

H25
D5



STEP 50

STEP 3

STEP 49

STEP 51

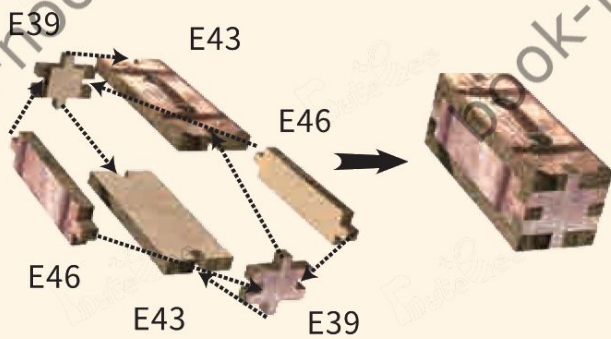

STEP 52

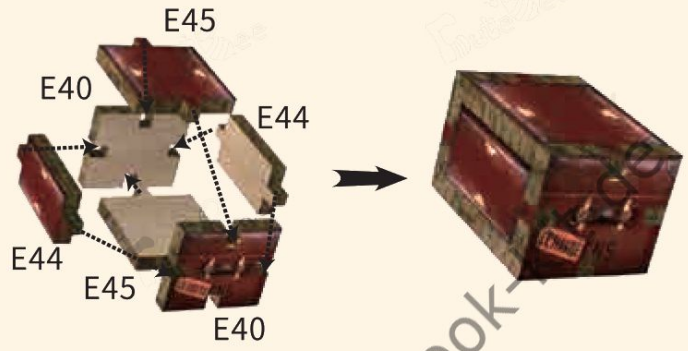

STEP 53

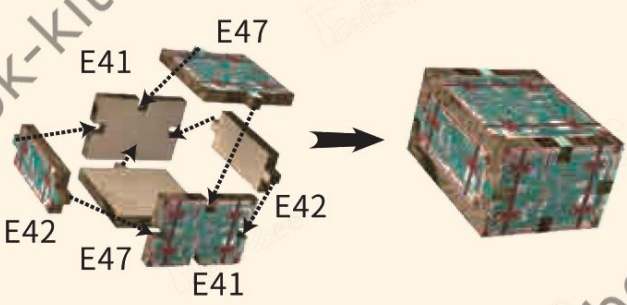

STEP 54

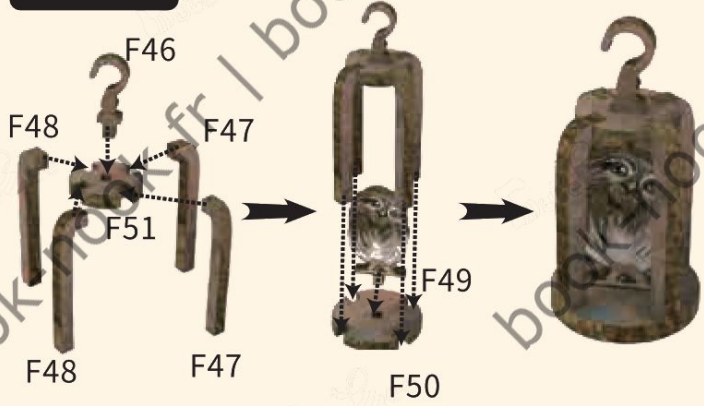

STEP 55

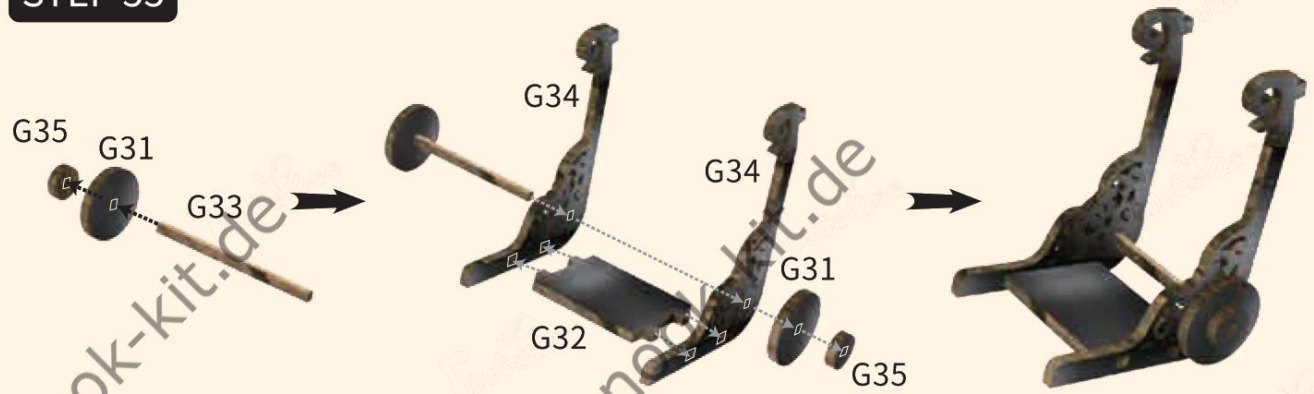

STEP 56



STEP 57

STEP 50

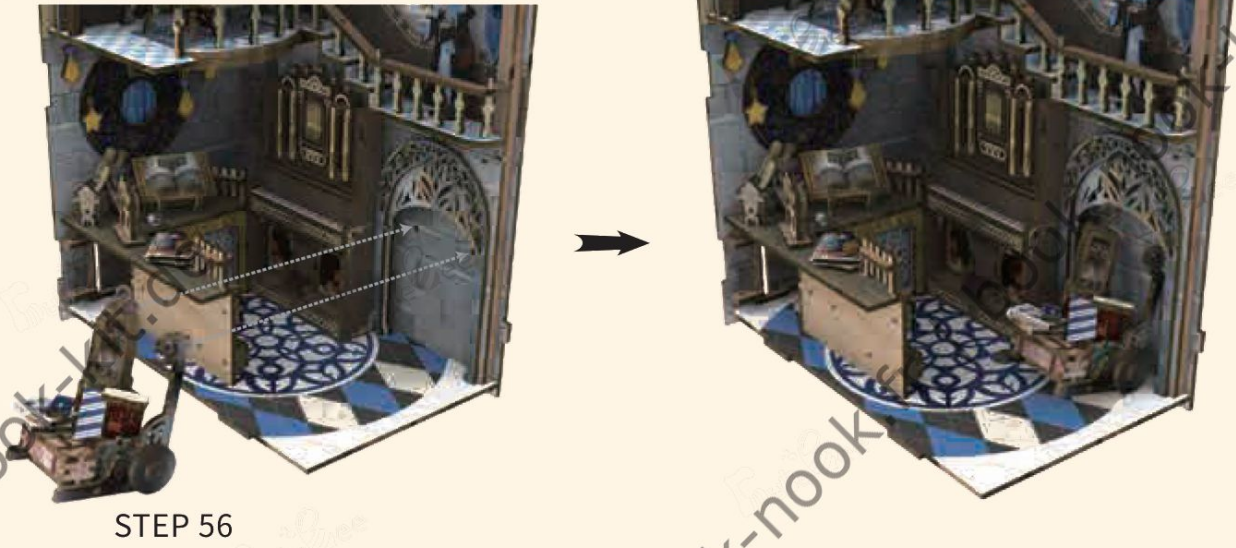

STEP 58



STEP 59

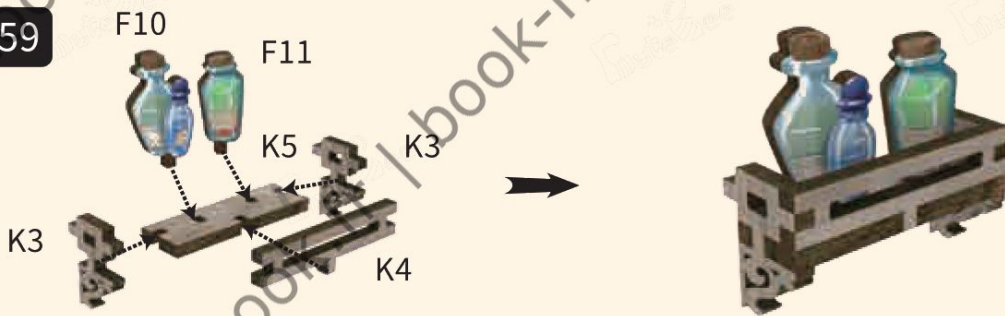

STEP 60

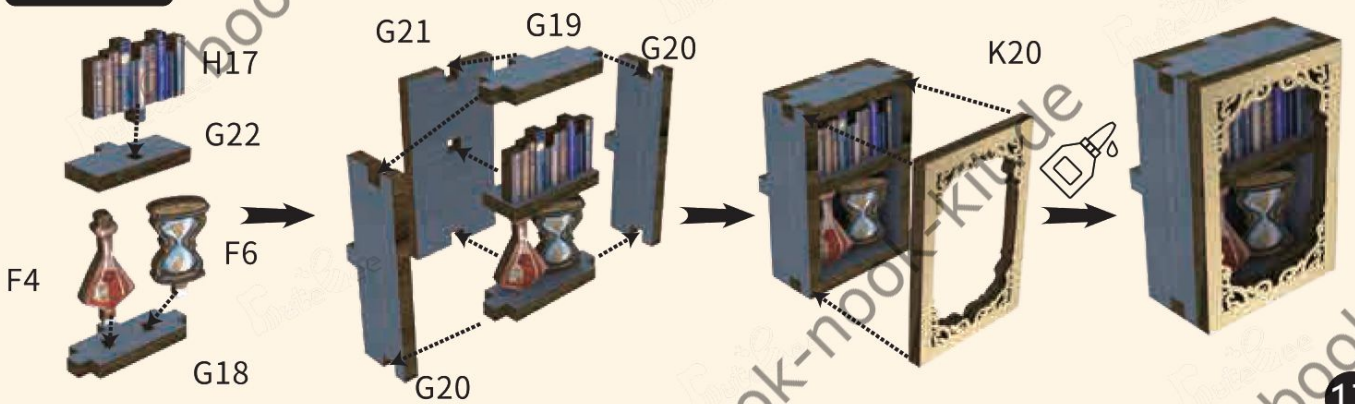

STEP 61

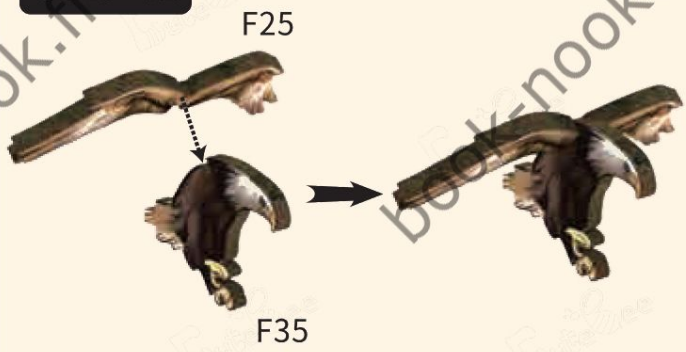

STEP 62



STEP 63



STEP 64



STEP 65

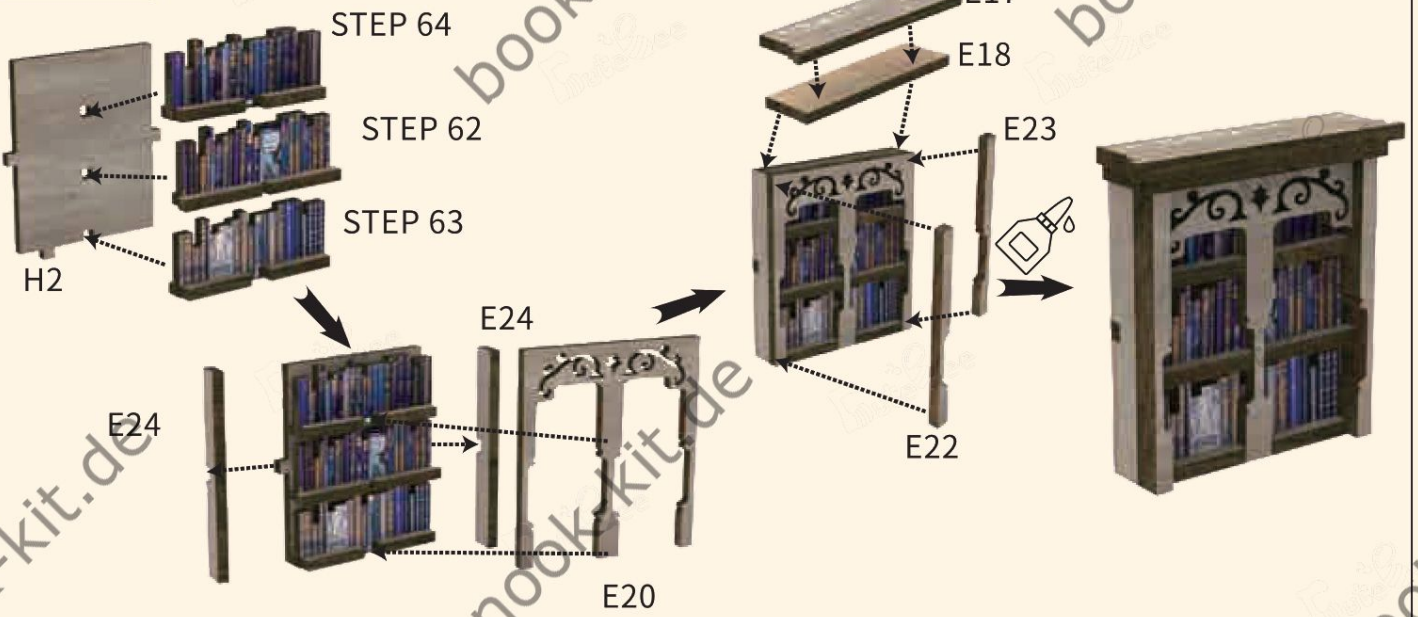

STEP 66

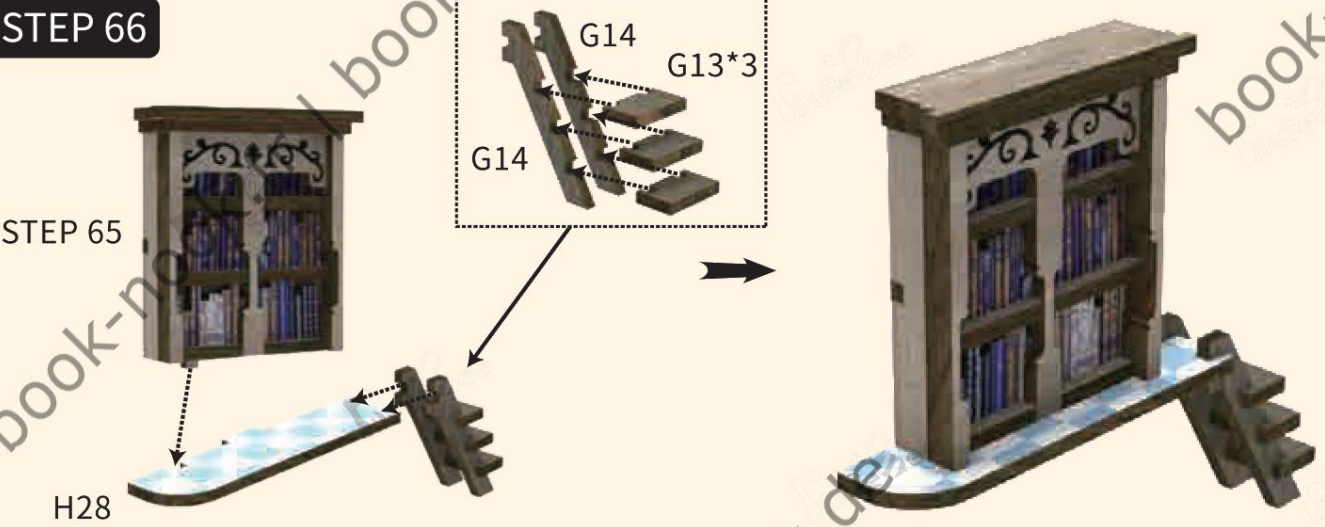

STEP 67

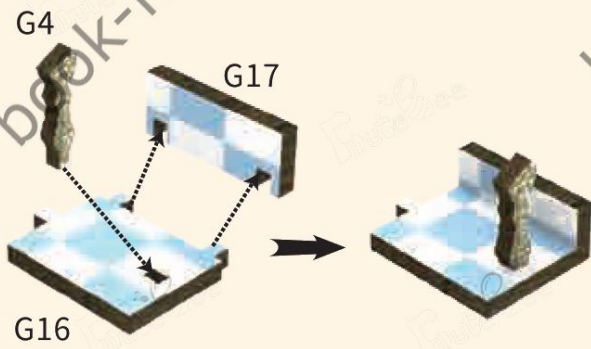

STEP 68

Attention au sens de G10
Please note the direction of G10

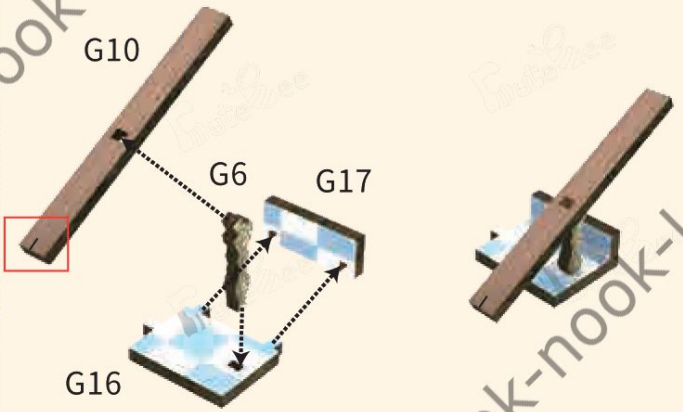

STEP 69

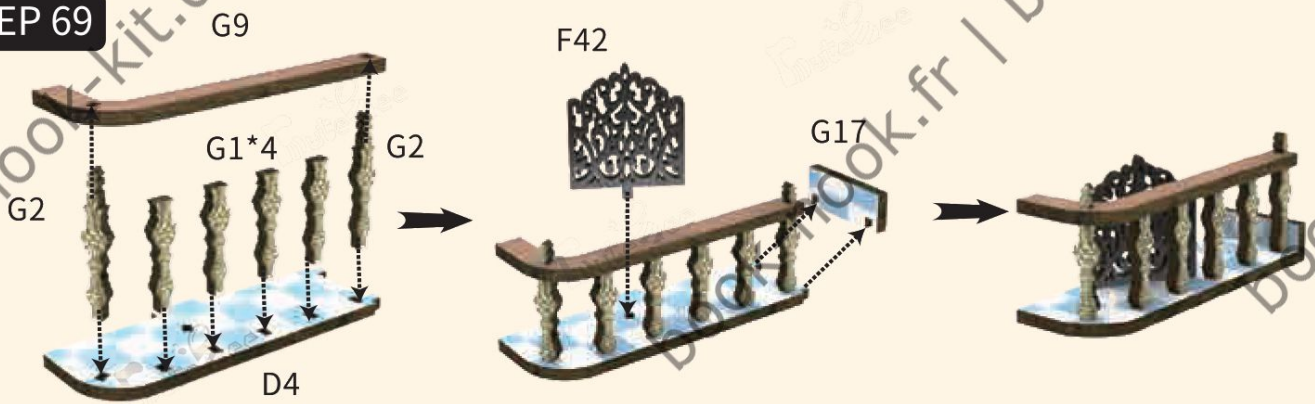

STEP 70



STEP 71



STEP 72

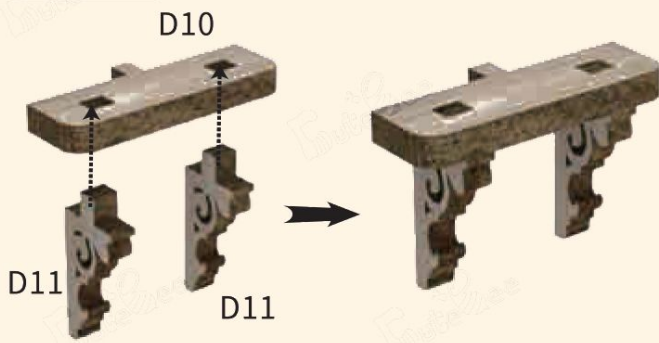

STEP 73

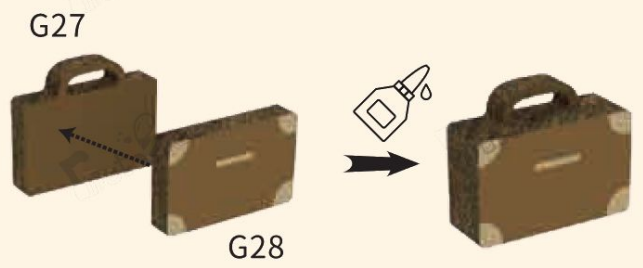

STEP 74

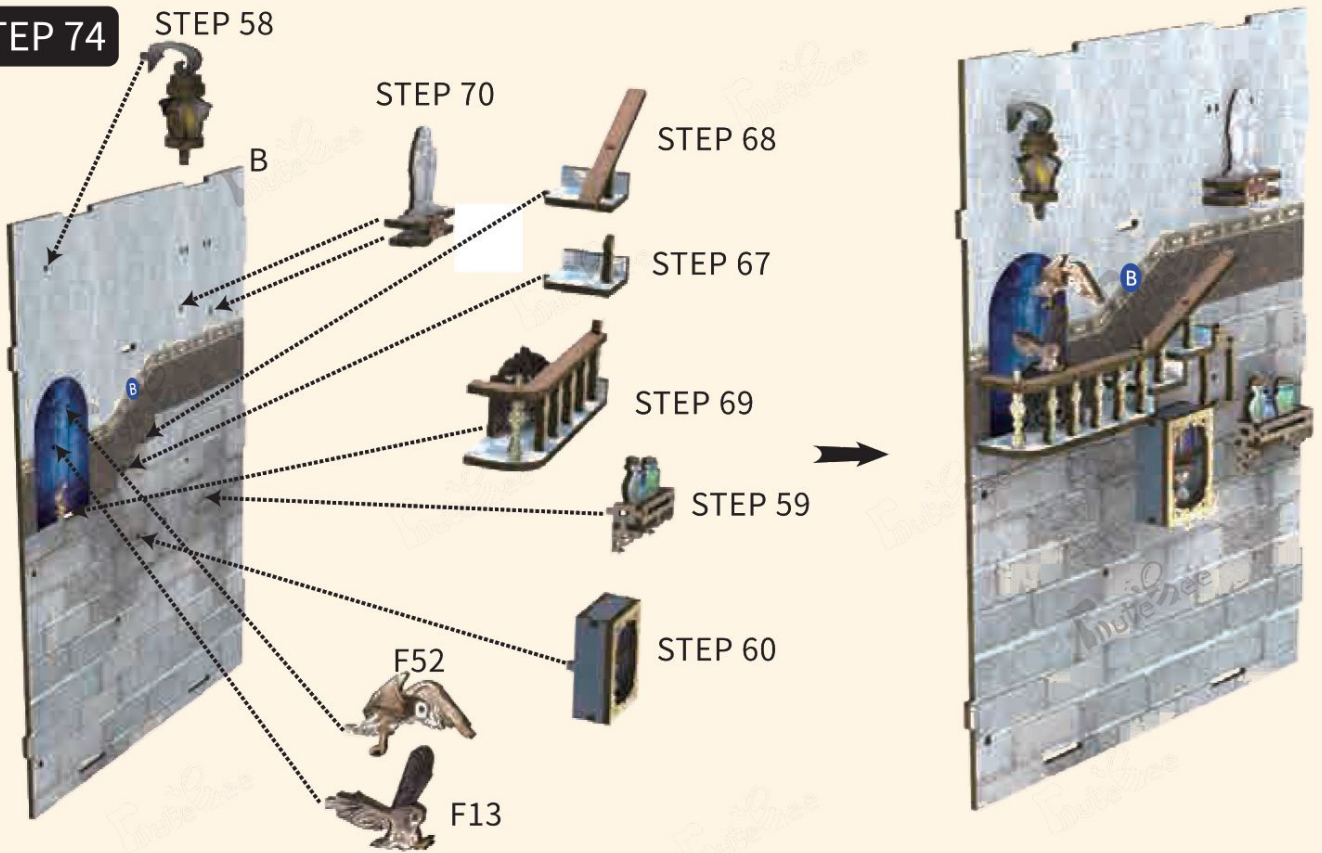

STEP 75

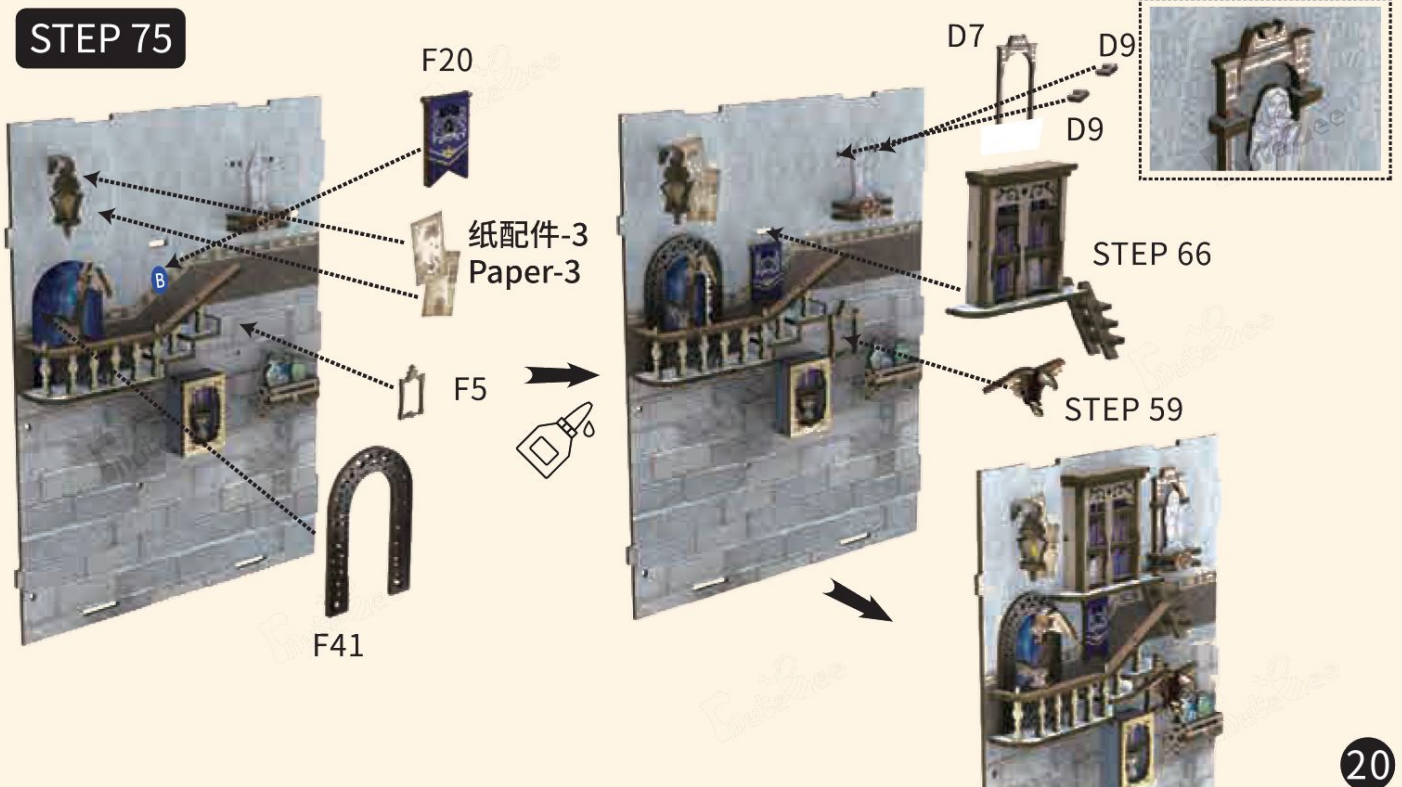

STEP 77

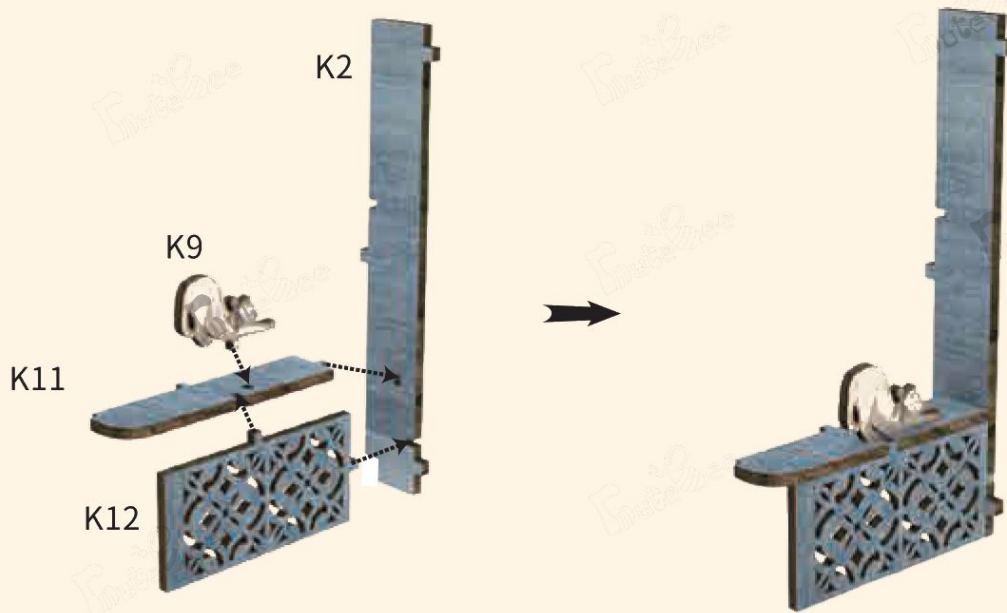

STEP 78

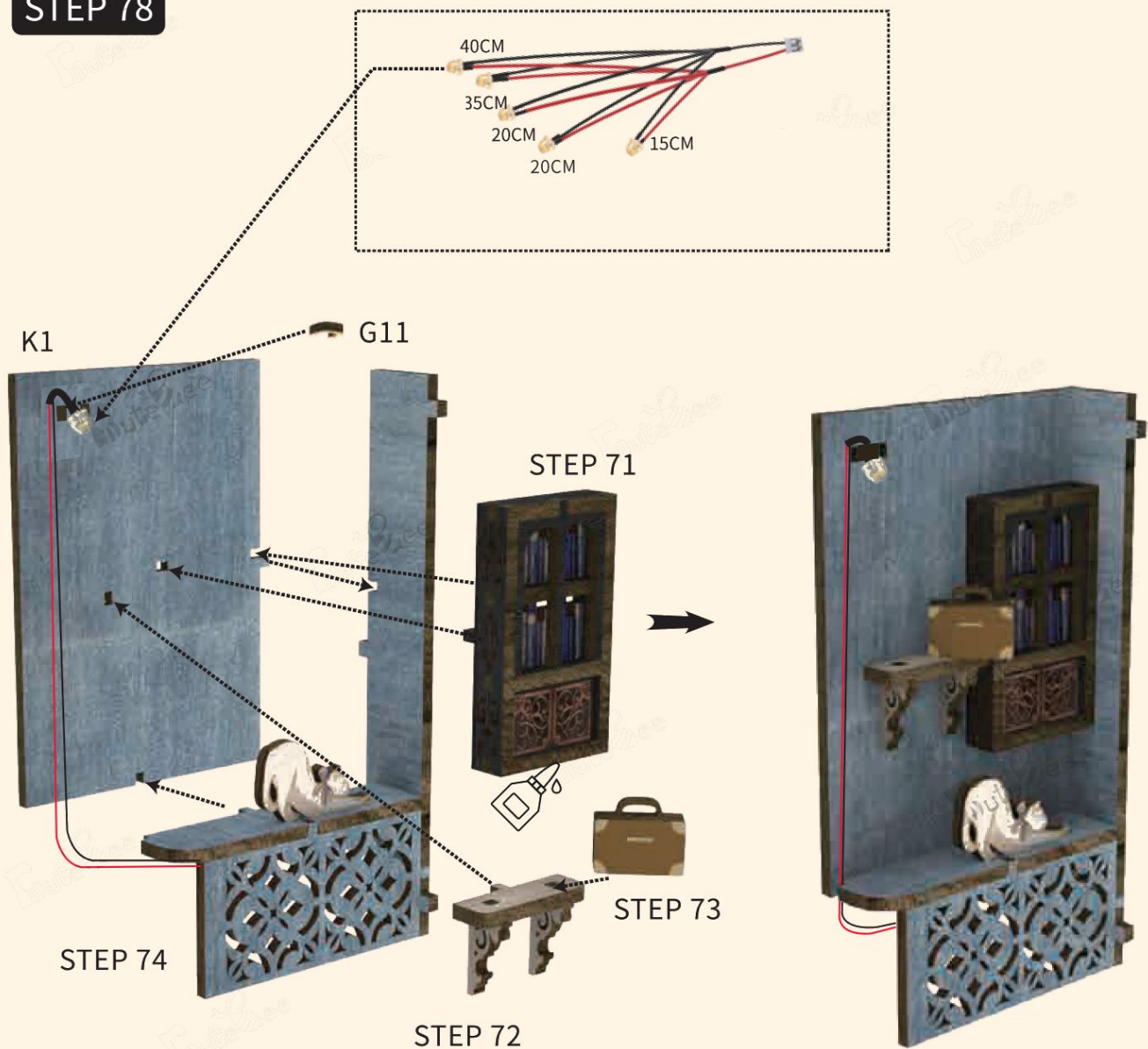

STEP 79

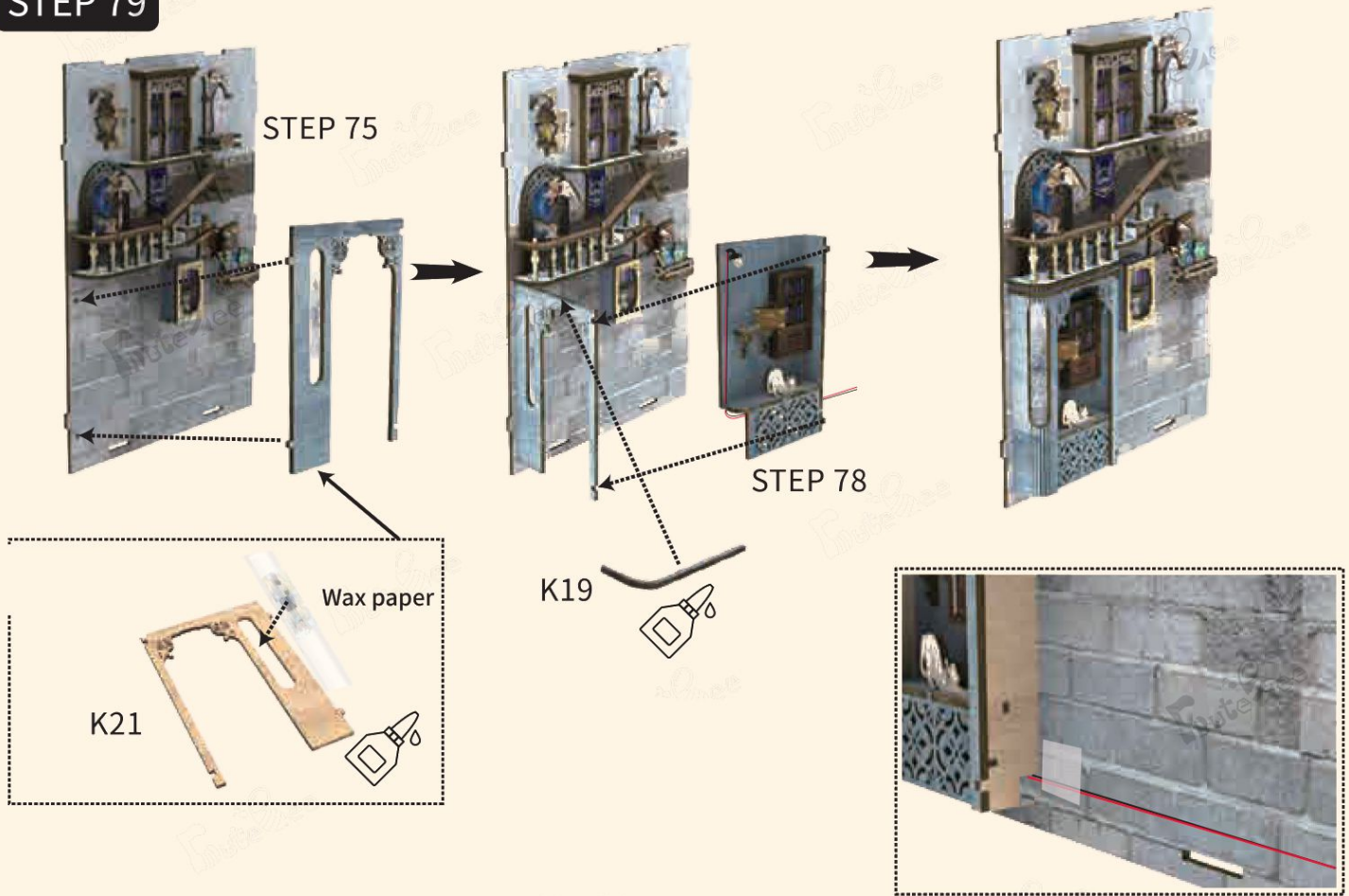

STEP 80

