

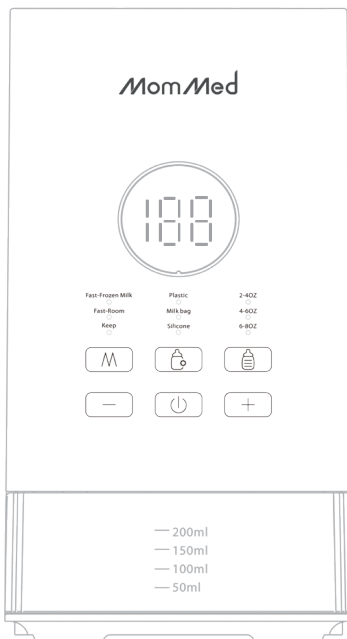

Baby Bottle Warmer

User Manual



Read this user manual carefully before using your baby bottle warmer, and save the user manual for future reference.

Attention

Milk in a glass bottle heats up faster than in a plastic bottle.

The working time from the reference table is indicative, and may not correspond to the actual heating time, because it is dependent on the bottle you use.

The bottle needs to be taken out immediately after warming to the right temperature, otherwise, milk will be overheated.

If for any reason you are not satisfied with the MomMed product you have purchased, contact us at support@mommed.com.

Product parameters

Product Name	Baby Bottle Warmer
Product Model	BBW-9300S
Material	BPA Free
Product Size	4.45*4.45*8.27inch/11.3*11.3*21cm
Rated Power	500W - 120V/ 60Hz
Warranty Period	2 years



WARNING

1. Always **check the temperature** of milk or food before you feed your child!
 2. The water in the appliance will be very hot. Careless use may cause burns.
 3. Do not rinse or soak the machine to avoid electric leakage.
 4. Do not place the product in a place where infants and young children can reach it; Please unplug the power supply if it is not used for a long time.
 5. Do not pour milk and ingredients directly into the bottle warmer for heating.
 6. Please **ONLY** use pure room temperature water or filtered room temperature water to warm milk. Water with impurities or tap water might block the drain solenoid valve.
 7. Do not add water that exceeds the capacity of the **MAX line**, otherwise the drainage water will overflow and cause scalding.
- Note:** The water tray can be used as a measuring cup to check the amount of water added. **Always use room temperature water for warming, otherwise the machine will display inaccurate heating time.**
8. Do not touch the water tray directly right after fast milk warming (Fast-Frozen Milk or Fast-Room) completed to avoid scalding. Please take out the water tray after cooling or under protective conditions.
 9. When moving or cleaning the machine, please make sure that there is no water in the water tray ; the water tray should be put back in place after use.
 10. The bottle warmer is designed for a voltage of **120V(60Hz)**.
 11. Do not use the appliance if the cord or plug is damaged.

Note: The body of the bottle warmer may become hot during using. Do not touch the water tray directly right after the Fast-Frozen Milk mode or Fast-Room mode completed. Take out the water tray after cooling or under protective conditions to avoid scalding.

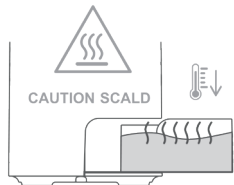



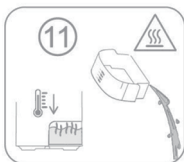
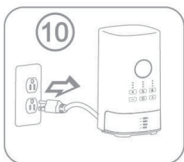
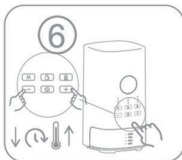
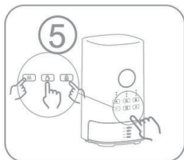
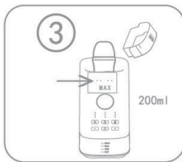
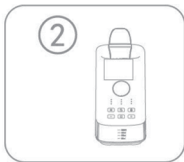
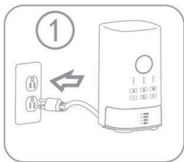

Operation chart

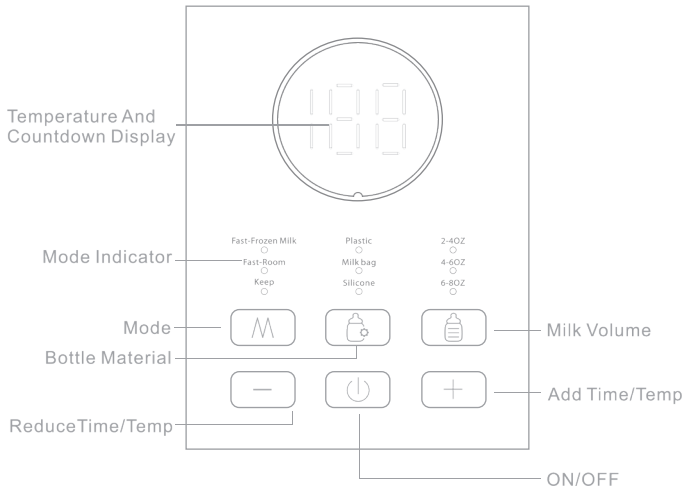

Use and operation panel introduction







After adding water and making sure water tray is in place:

1. Plug in power supply, the machine will beep once.
2. Press the “” button to turn on the machine. When the machine is turned on, the screen displays “---” and all 9 indicators are all on.
3. Press the “” mode button to chose function (Fast-Frozen Milk, Fast-Room and Keep).
4. Press “” to choose bottle material and “” button to choose milk volume. Then machine will enter working mode automatically.

Detail instruction for each function as follows

Fast-Frozen Milk

Recommended for heating milk with an initial temperature of 0-5°C/32-41°F





- (1) Put the milk bottle into the bottle warmer and add an appropriate amount of purified water (the water level should not be below the **MIN line** or exceed the **MAX line**).
- (2) Press the “” button to turn on your warmer. The LED will light up and beep once to show it's in standby mode.
- (3) Press the “” to select the Fast-Frozen Milk mode, "Fast-Frozen Milk" light is on.
- (4) Press the “” to select the bottle material, the selected material light is on.
- (5) Press the “” to select milk volume and the selected milk volume light is on.
- (6) You can adjust the thawing time with the “+” button or “-” button. (Press once to increase/decrease for 3 seconds, adjustable range is 30 seconds)
- (7) The bottle warmer will beep and start to count down to show the cycle has started(The time calculated is the time for the machine to heat the milk/water in the bottle to 37°C/99°F).
- (8) The water will automatically drain into the tank when the mode is finished. (Alert: 1 beep)
- (9) Please shake the bottle gently and test the milk temperature by sprinkle a few drops on the inside of the wrist before feeding to avoid scalding the baby.
- (10) After waiting for the water in the water tank to cool down, pour out the rest of the water in the tank and wipe the inside of the base dry with a soft, clean cloth.

Note:

1. If milk is too hot after warming, cool it down before feeding. Decrease heating time manually by press “-” button next time.
2. If milk is not warm enough, pour hot water in the water tray back to the heating chamber (Be careful not to get burned) and place bottle back into appliance for extra 0.5-1 minute warming with no need to choose any function. Increase heating time manually by press“+” button next time.

Fast-Room

Recommended for heating milk with an initial temperature of 5 -25°C/41 - 77 °F





- (1) Put the milk bottle into the bottle warmer and add an appropriate amount of purified water (the water level should not be below the **MIN line** or exceed the **MAX line**).
- (2) Press the “” button to turn on your warmer. The LED will light up and beep once to show it's in standby mode.
- (3) Press the “” to select the Fast-Room mode, "Fast-Room" light is on.
- (4) Press the “” to select the bottle material, the selected material light is on.
- (5) Press the “” to select milk volume and the selected milk volume light is on.
- (6) You can adjust the thawing time with the “+” button or “-” button. (Press once to increase/decrease for 3 seconds, adjustable range is 30 seconds)
- (7) The bottle warmer will beep and start to count down to show the cycle has started(The time calculated is the time for the machine to heat the milk/water in the bottle to 37°C/99°F).
- (8) The water will automatically drain into the tank when the mode is finished. (Alert: 1 beep)
- (9) Please shake the bottle gently and test the milk temperature by sprinkle a few drops on the inside of the wrist before feeding to avoid scalding the baby.
- (10) After waiting for the water in the water tank to cool down, pour out the rest of the water in the tank and wipe the inside of the base dry with a soft, clean cloth.

Note:

1. If milk is too hot after warming, cool it down before feeding. Decrease heating time manually by press “-” button next time.
2. If milk is not warm enough, pour hot water in the water tray back to the heating chamber (Be careful not to get burned) and place bottle back into appliance for extra 0.5-1 minute warming with no need to choose any function. Increase heating time manually by press “+” button next time.

Keep

Heat milk to the desired temperature and keep milk warm for up to 48 hours.

- (1) Put the milk bottle into the bottle warmer and add an appropriate amount of purified water (the water level should not be below the **MIN line** or exceed the **MAX line**).
- (2) Press the “” button to turn on your warmer. The LED will light up and beep once to show it's in standby mode.
- (3) Press the “” to select the Keep mode, “Keep” light is on.
- (4) Press the “” to select the bottle material, the selected material light is on.
- (5) Press the “” to select milk volume and the selected milk volume light is on.
- (6) The screen shows default target temperature 37°C/99°F, Press “+” button or “-” button to adjust target temperature. Adjustable range is from 30°C/86°F to 50°C/122°F.
- (7) The machine will start working after temperature selected. The screen shows target temperature flashing while heating.
- (8) When the set temperature is reached, the warmer will beep and stop flashing. And automatically shuts off after 48 hours of keeping warm.
- (9) Check the reference time table for heating time of Keep mode to know when the milk will be ready. Please shake the bottle gently and test the milk temperature by sprinkle a few drops on the inside of the wrist before feeding to avoid scalding the baby.
- (10) After waiting for the water in the water tank to cool down, pour out the rest of the water in the tank and wipe the inside of the base dry with a soft, clean cloth.

Note:

Always check the content temperature before feeding your baby.
The time table is for reference ONLY. Heating time may vary due to different room temp, initial water temp etc.

Milk warming time reference sheet

Fast-Frozen Milk			
Volume Material	50-120ml (2-4 oz)	120-180ml (4-6 oz)	180-240ml (6-8 oz)
Plastic	4:00min	4:20min	4:45min
Milk bag	1:40min	2:50min	3:00min
Silicone	5:40min	6:35min	7:30min

Fast-Room			
Volume Material	50-120ml (2-4 oz)	120-180ml (4-6 oz)	180-240ml (6-8 oz)
Plastic	2:50min	3:35min	3:55min
Milk bag	1:35min	2:10min	2:20min
Silicone	3:45min	4:10min	4:40min

Keep			
Volume Material	50-120ml (2-4 oz)	120-180ml (4-6 oz)	180-240ml (6-8 oz)
Plastic	8:30min	9:30min	12:30min
Milk bag	5:00min	6:00min	8:00min
Silicone	12:30min	13:30min	15:50min

Note:

1. Experimental data is for reference only.
2. If milk is too hot after warming, cool it down before feeding. Decrease heating time manually by press "-" button next time.
3. If milk is not warm enough, pour hot water in the water tray back to the heating chamber (Be careful not to get burned) and place bottle back into appliance for extra 0.5-1 minute warming with no need to choose any function. Increase heating time manually by press "+" button next time.
4. Always check the content temperature before feeding your baby.

Cleaning and maintenance

1. When cleaning, please unplug the power plug and wait until the heating plate cools to room temperature.
2. Pour out water from the water tank and heating chamber.
3. Please put the water tray back in place after cleaning, it's easy to tip over if left it outside.
4. Wipe with a moist cloth. If necessary, wipe the base exterior with a damp cloth. Do not use scouring pads, abrasives or solvents for cleaning.

Cleaning method

1. Normal daily cleaning is recommended every 10-15 days.
2. Descale.

Using distilled water or filtered water can effectively reduce scale.

It is recommended to remove scale every week. Methods are as follows:

- (1) Pour 10 grams of citric acid and 200ml of distilled water into the warming chamber, soak for 10 minutes, then pour out the water and rinse the chamber with clean water. (DO NOT flush the control panel in front, it's not waterproof)
- (2) Pour 50ml acetic acid or vinegar and 150ml distilled water into the warming chamber, soak for 10 minutes, then pour out the water and rinse the chamber with clean water. (DO NOT flush the control panel in front, it's not waterproof)

FAQ

Q: How to know the time required to heat the milk?

A: Depending on the material of the bottle and the amount of milk, the required time varies. Please refer to the recommended time in the user manual.

Q: Is it safe to heat plastic milk bags and bottles?

A: Safe, we use a gentle heating method to gradually increase the temperature, and will not cause damage to plastic milk bags and bottles.

Q: The machine cannot be operated and there is no display.

A: Please check whether the power cord is plugged in properly.

Q: The machine's drain overflowed during "Fast" milk warming.

A: It may be that too much water was added when warming the milk (please use the water tray to add 200ml of water) or the water discharged from the last warming milk in the water tray was still not poured out.

Q: The heating plate produces generates the scale after repeated use.

A: The scale is produced by the poor water quality of the water added to the machine. Better water quality is recommended. At the same time, a descaling agent can be added to the machine and heated to clean the heating plate.

Q: The screen displays E3.

A: When the machine is heated, there is no water in the chamber for dry burning. Adding water and the machine can be used normally after cooling down.

Q: After the Fast warming, the water output of the solenoid valve is small and the water cannot be discharged below the water outlet.

A: Please check whether the water outlet hole in the chamber is blocked by foreign matters.

Q: When warming milk, you find that the temperature of warm milk is different from your desired temperature.

A: You can adjust the time or temperature appropriately by pressing the plus or minus key when warming the milk next time.

Have more questions?

Please contact  support@mommed.com.