

החברה



User Manual V1.2

## ■ Contents

- 01 Download the Hohem Pro App
- 02 iSteady X2 Overview
- 03 iSteady X2 Remote Control
- 05 Mounting and Balancing
- 06 Activate APP Feature & Bluetooth Connection
- 07 Button Function
- 08 Working Mode & Follow Speed
- 10 How to fold the gimbal?
- 10 How to do if the gimbal is not level after powering on?
- 11 Use as emergency power bank
- 11 Power indicator and Bluetooth indicator function
- 12 Specifications
- 13 Warranty Card
- 14 Contact us



## Disclaimer and Warning

Thank you for purchasing the Hohem product. By using this product, you hereby signify that you have read this disclaimer and warning carefully and that you understand and agree to abide by the terms and conditions herein. You agree that you are solely responsible for your own conduct while using this product, and for any consequences thereof. You agree to use this product only for purposes that are proper and in accordance with all applicable laws, rules, and regulations, and all terms, precautions, practices, policies and guidelines Hohem has made and may make available.

Hohem accepts no liability for damage, injury or any legal responsibility incurred directly or indirectly from the use of this product. The user shall observe safe and lawful practices including, but not limited to, those set forth in this document.



**Important  
Notes:**

- Please turn on the gimbal for the first use. Some features are disabled until Hohem Pro app is activated. Download the APP to register for free membership and one-year extended warranty.
- Mount your mobile phone before powering on iSteady X2.
- If no mobile phone is detected or the motor is overloaded due to phone is not level, the gimbal will shut down after a warning beeping.

## ■ Download the Hohem Pro App, register and Login



Scan the QR code to enter the download page  
Search " Hohem Pro " in the App Store or Google Play

\*Hohem Pro app requires iOS 10.0 or above, Android 6.0 or above  
\*More product tutorials can be found on the app homepage

## iSteady X2 Overview

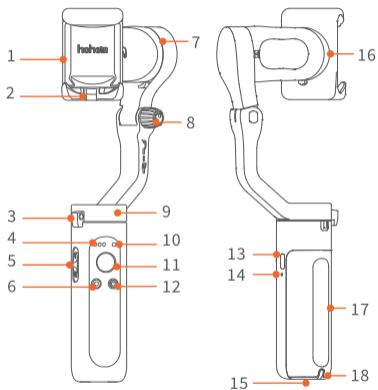

1. Phone Clamp
2. Folding Lock A
3. Folding Lock B
4. Battery Indicator
5. Zoom Slider
6. Shutter Button
7. Tilt Motor
8. Knob
9. Pan Motor
10. Bluetooth Light
11. Joystick
12. Power (ON/OFF) / Function Button
13. Bidirectional charging port (Type C)
14. Reset
15. 1/4 inch Screw Port
16. Roll Motor
17. Handle (Battery built-in)
18. Lanyard Hole

## iSteady X2 Remote Control

### Pairing the remote control with the gimbal:

Please press the function button of the gimbal 7 times once the gimbal is turned on, the bluetooth light will flash alternately in yellow and green and enter the pairing mode.



Make sure the gimbal is on the pairing mode before turning on the remote control to connect.

### During the pairing process:

- The pairing can be completed in 3 seconds, after the gimbal bluetooth light stop flashing alternately in yellow and green;
- If the remote control is not paired within 30 seconds, the pairing will be cancelled;
- Click the function button to cancel pairing;
- Double-click the function button to clear the paired remote control and cancel pairing;

(And the paired remote control will be unavailable and need to be repaired)

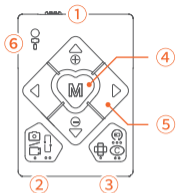

#### ① Power Button

ON: Power On OFF: Power Off

#### ② Shutter Button

(Make sure the app connect to the gimbal successful)

Single Press: Take photo, Start/End video

Double Press: Switch the photo and video modes

Triple Press: Switch the front and rear cameras

(Only available in the app)

### ③ Function Button

**Single Press:** Switch the landscape and portrait modes

**Double Press:** Recenter the gimbal

**Triple Press:** Inception (Auto rotation)

### ④ M Button (Gimbal Working Mode)

**Single Press:** Pan&Tilt Follow

**Double Press:** Pan Follow

**Triple Press:** All Lock

**Quartic Press:** POV (All Follow)

**Long Press:** Switch the zoom in/out mode and gimbal tilt control mode (Zoom in/out mode only available in the app)

### ⑤ Navigation Buttons: Up/Down/Left/Right

**Up/Down:**

- Tilt Control (Indicator light shows green)

- Control the image zoom in/out

(Indicator light shows blue and only available in the app)

**Left/Right:** Pan Control

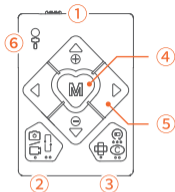

### ⑥ Indicator Light

The indicator light shows green or blue in button operation. If no light shows, it means the remote control is not turned on or no battery.

**Green light:** Gimbal controlling

**Blue light:** Phone camera controlling

## How to mount and balance mobile phone on the gimbal?

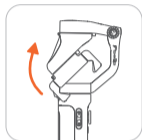

①

Unfold the gimbal



②

Screw up  
the knob



③

Turn the "hohem"  
logo upward

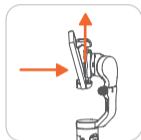

④

Put your phone  
stuck in the bottom  
of phone clamp and  
pull the head of  
phone clamp to  
mount your phone

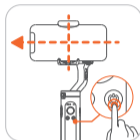

⑤

Slide the phone and  
make sure it is  
clamped in the  
middle, power on  
the gimbal after  
balancing the  
phone clamp



The gimbal would work  
improperly if not screw the  
knob up.



Clench the phone clamp, ensuring that your phone is  
cling to the rubber mat, otherwise the gimbal would  
vibrate or turn off automatically.

## Booting up iSteady X2 at first use

### Activate APP Feature & Bluetooth Connection

Please turn on the gimbal for the first use. Some features are disabled until Hohem Pro app is activated. Download the APP to register for free membership and one-year extended warranty.

#### ① Startup

Long press the function button. At the first start, it will enter a to-be-activated state and the Bluetooth indicator will flash alternately in red and green.

#### ② Bluetooth connection through the App

Turn on the bluetooth of phone. Log into the app Hohem Pro. Following the notice at the top for connection.

#### ③ Activate iSteady X2

After the Bluetooth is connected, an activation prompt box will pop up. Click "Confirm" to complete the activation. Three beeps for noticing you the activation has done, and you can use the gimbal now.

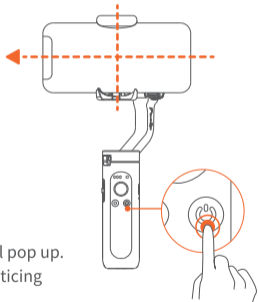



## ■ Button Function

### ① Power (ON/OFF) / Function Button

Long Press: Power On/Off

Single Press: Switch the landscape and portrait modes

Double Press: Recenter the gimbal

Triple Press: Inception (Auto rotation)

Press Five Times: Auto calibration

Press Seven Times: Remote control pairing

(For more details, please refer to page 3)

The bluetooth light will flash alternately in yellow and green.

a. If the remote control is not paired within 30 seconds, the

pairing will be cancelled;

b. Click the function button to cancel pairing;

c. Double-click the function button to clear the paired remote control and cancel pairing;

(And the paired remote control will be unavailable and need to be re-paired)

### ② Joystick

Up/Down: Tilt Control

Left/Right: Pan Control

(It is able to control the roll motor through Left/Right Joystick Settings in Hohem Pro app)

### ④ Shutter Button (Ensure the Bluetooth is connected)

Single Press: Take photo, Start/End video

Double Press: Switch photo/video modes

Triple Press: Switch front/rear cameras (Only available in the app)

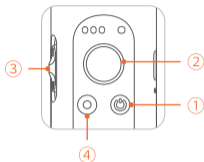

### ③ Zoom Slider

(Only available in the app)

Push Up: Zoom in

Push Down: Zoom out

### How to switch working modes by button?

Combination operation: Press and hold shutter button and tap power button

Single Tap: Pan&Tilt Follow (Default)

Double Tap: Pan Follow

Triple Tap: All Lock

Quartic Tap: POV (All Follow)

\*Tips: To ensure proper operation, please release the shutter button after the power button.

## Working Mode & Follow Speed

\*For changing working mode or follow speed, please open Hohem Pro app - Start Recording - Gimbal Parameter Settings

\*Ensure the Bluetooth is connected and change the settings

### Working Mode

#### Pan&Tilt Follow

This is the default working mode. When you rotate the handle left/right/tilt up/tilt down, the camera will follow the handle movements, and the roll motor is locked without following the movement.

## Pan Follow

When you rotate the handle left/right, the camera will follow the handle movements. The tilt motor does not follow within the angle range of  $-30^{\circ}\sim+30^{\circ}$  movement, if exceed this range, the gimbal will follow the tilt movement, and the roll motor is locked without following the movement.

## All Lock

The roll and pan motors are locked without following the movement. The tilt motor does not follow within the angle range of  $-30^{\circ}\sim+30^{\circ}$  movement, if exceed this range, the gimbal will follow the tilt movement.

## POV (All Follow)

First person point of view

Gives you  $360^{\circ}$  complete movement, you can pan, tilt and roll with it.

## Follow Speed

**General** Shooting with general follow speed

**Slow** Shooting with slow follow speed

**Medium** Shooting to follow the fast movement

**Fast** Fast follow speed for video transition

## How to fold Gimbal?

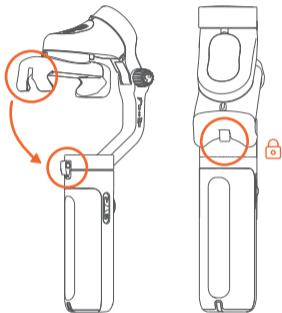

## How to do if the gimbal is not level after powering on?

If the gimbal is not level after turned on, or pan axis is slight drift when the gimbal is still, please calibrate the gimbal on a stationary and horizontal surface.

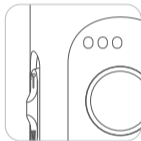

- ① Turn on the gimbal, press function button 5 times
- ② Start calibration after a beep sound
- ③ The battery indicator light keep flashing
- ④ The calibration is done after two beeps sound (the calibration takes about 40 seconds)

## Use as emergency power bank

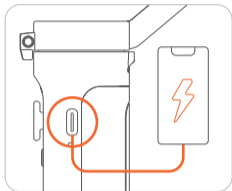

The gimbal can be used as emergency power bank for your mobile phone and other electronic devices.

## Power indicator and Bluetooth indicator function



### Power Indicator Lights

Stay on: Fully charged or charging complete

Single flashing: Charging

Continuous Flashing: Calibrating



## Bluetooth Indicator Light

1.

**A.**Blinks red and green alternatively:

App feature is waiting for activation

**B.**Blinks yellow and green alternatively :

The remote control is pairing

2. Color indicates the status of gimbal

**Green:** Bluetooth is connected

**Yellow:** Bluetooth is not connected

**Red:** Warning of abnormal loads on the stabilizer or failed firmware upgrade

3.Blinking indicators of working modes

**Solid Light:** Pan& Tilt Follow

**Flash twice:** Pan Follow

**Flash triple:** All Lock

**Flash four times:** POV (All Follow)

**Pulse:** Standby mode

## Specifications

<b>Model</b>	iSteady X2	<b>Weight</b>	259g
--------------	------------	---------------	------

<b>Folded Dimensions</b>	179 X 79 X 39 mm
--------------------------	------------------

<b>Battery</b>	18650li-ion	2800mAh
----------------	-------------	---------

<b>Operating Time</b>	10 hours
-----------------------	----------

Bidirectional charging port (Type C) supports gimbal works while charging.

<b>Mechanical Range</b>	* Pan: 320°	* Roll: 320°
	* Tilt: 320°	

<b>Controllable Range</b>	* Pan: 320°
	* Tilt: -30°~+30°

<b>Compatible Phones</b>	Weight : ≤280g
	Thickness: ≤11 mm
	Width: 55mm~90mm

The motor would be shown in the screen due to some of mobile cameras are designed at the middle of phone, such as Xiaomi10, Xiaomi10 Pro, Xiaomi CC9 PRO.

## Warranty Card

User Name:

---

Contact No.:

---

Address:

---

Purchase Date:

---

Prod. Serial No.:

---

Failure Issue:

---

Service Record:

---

1. Within 15 days upon the purchase date. Any functional disorder or quality problem enjoys free replacement service. But ensure the commodity and package with no damage, and we will offer a brand new replacement after confirming the product problem.
2. Warranty valid only under normal use.
3. Used in the normal circumstances, 1 year warranty, maintenance of life (not include the All accidents or artificial damage, improper disassembly or misuse damage is NOT covered by the warranty.)
4. Please keep and offer the warranty card for claiming the warranty service.

## CALL CENTER -Toll Free

**UNITED STATES:** +1(888)9658512

Mon-Fri: 9:00AM-5:00PM(EST)

**UNITED KINGDOM:** +44(0)808 2737578

Mon-Fri: 2:00PM-10:00PM(GMT +0)

**CANADA:** +1(855)758-8939

Mon-Fri: 9:00AM-5:00PM(EST)

**BRAZIL:** +55 (0)800 5911897

Mon-Fri: 10:00AM-6:00PM(GMT -3)

## Contact us

**Email:** [service@hohem.com](mailto:service@hohem.com)

**Website:** [www.hohem.com](http://www.hohem.com)

**Manufacturer:** Hohem Technology Co., Ltd

Connect us at Facebook

—@HohemTechOfficial—