

OWNERS MANUAL

READ BEFORE OPERATING YOUR SYSTEM



VacuMaid[®]
— GARAGE VAC —

IMPORTANT SAFETY INSTRUCTIONS

When using an electrical appliance, basic precautions should always be followed, including the following:

- * Read all instructions before using this appliance.

WARNING: To reduce the risk of fire, electric shock or injury:

- * Always follow these safety instructions

- Do not leave room when hose is plugged into the inlet. Disconnect power before servicing.
- Electric shock could occur if used on wet surfaces.
- Do not allow to be used as a toy. Close attention is necessary when used by or near children.
- Use only as described in this manual. Use only those attachments that are recommended.
- Do not use with damaged cord or plug. If appliance is not working as it should, has been dropped, damaged, left outdoors, or dropped into water, return it to a service center.
- Do not pull or carry by cord, use cord as a handle, close a door on cord, or pull cord around sharp edges or corners. Do not run appliance over cord. Keep cord away from heated surfaces.
- Do not unplug by pulling on cord. To unplug, grasp the plug, not the cord.
- Do not handle plug or appliance with wet hands.
- Do not unplug hose from system by pulling on vacuum hose. To unplug hose, grasp the cuff, located on the end of the hose, pull out with a twisting motion.
- Do not put anything into vacuum inlet or vents. Keep inlet free of things that might slow airflow, such as lint, dust and hair. Do not use the vacuum system if something is blocking an opening.
- If equipped with an air turbine power brush unplug the vacuum hose before attaching power brush. Keep fingers, hands and toes away from the base of the power brush. Failure to do so could result in injury from moving parts.
- Not intended as a wet pickup. Do not use to pick up liquids of any kind. Doing so will void warranty.
- In the event the power unit should get wet, do not use the vacuum system until it has been properly serviced and examined by a serviceman or installer.
- Keep hair, loose clothing, fingers and all parts of the body away from wand, other openings and moving parts.
- If so equipped, do not use your vacuum system without dustbag in place.
- Always disconnect vacuum system before emptying dirt canister or replacing dustbag.
- Use extra care when cleaning on stairs.
- Do not use to pick up flammable or combustible liquids such as gasoline or use in areas where such liquids may be present.
- Do not use to pick up dry wall or cement dust. Doing so will void warranty.
- Do not pick up anything that is burning or smoking, such as cigarettes, matches or hot ashes.
- When finished put the vacuum hose and attachments away to prevent tripping accidents.
- For a grounded appliance, connect to a properly grounded outlet only. See grounding instructions.

CAUTION: Do not use when rug (or floor) is wet.

ATTENTION: Ne pas utiliser lorsque le tapis (ou le plancher) est moduillé.

SAVE THESE INSTRUCTIONS

* THIS IS NOT A WET VAC *

-WARNING-

ELECTRIC SHOCK COULD OCCUR IF USED ON WET SURFACES

GROUNDING INSTRUCTIONS

FOR CORD CONNECTED APPLIANCE

This appliance must be grounded. If it should malfunction or breakdown, grounding provides a path of least resistance for electric current to reduce the risk of electric shock. Your vacuum system is supplied with an electrical cord having a grounding pin. It is recommended that this plug be used only with an appropriate outlet that is properly installed and grounded in accordance with all local codes and ordinances. This appliance is for use on a nominal 120-volt circuit (U.S. only) or 230/250 volt circuits where applicable, and has a grounded plug that looks like the plug shown in Figure A. A temporary adapter, that looks like the adapter illustrated in Figure B, may be used to connect this plug to a 2-pole receptacle as shown in Figure B if a properly grounded outlet is not available.

The temporary adapter should be used only until a properly grounded outlet (Figure A) can be installed by a qualified electrician. **NOTE: Temporary adapters are not permitted in Canada.** The green colored rigid ear, lug or the like, extending from the adapter, must be connected to a permanent ground such as a properly grounded outlet box cover. Whenever the adapter is used, it must be held in place by a metal screw.

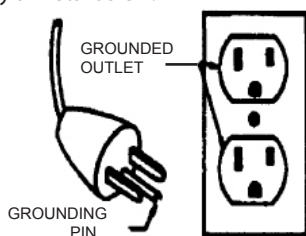

FIGURE A

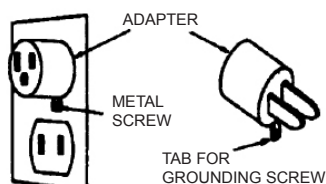

FIGURE B

DANGER--- Improper connection of the equipment - grounding conductor can result in a risk of electric shock. Check with a qualified electrician or your installer if you are in doubt as to whether the outlet is properly grounded. Do not modify the plug provided with the appliance - if it will not fit the outlet use a temporary adaptor as shown and have a proper outlet installed by a qualified electrician as soon as possible.

Your vacuum does not require any oil. The bearings in the motor are greased and sealed for life. **Do not add lubricant.**

Parts



Cannot be plumbed for use as a central vac.

DO NOT USE AS A WET VAC

Additional tools needed for installation:

- Level
- Electric Drill
- (If mounting on block or concrete wall, you will need masonry bit & plastic or lead anchors - not provided)
- Rubber Mallet
- 1/8" drill bit

Other items included with this system...

Tool kit for standard Garage Vac



Tool kit for Garage Vac PRO



Protector Plate (PP101)

This plate should already be installed in your unit when you receive it, just below the HEPA bag.

Be sure it is face up and remains in the vacuum canister. (Pg. 5 for details.)



HEPA Bag (HPB2H)

Must be installed onto the bag stem before use. See Pg. 8 for use & installation details.



Replacements sold in 3 pack.
Part #: HPB2HPK

Installation & Mounting

CHOOSE THE MOUNTING LOCATION

- The unit must be mounted within 5 feet of an electrical outlet. **Do not use an extension cord.**
- The unit should be mounted so that it is in a dry location and out of the way, but still accessible for emptying and accessing the utility valves.

Suggested mounting: Minimum of 12 inches between unit lid and ceiling or shelving.

- Do not install this unit where ambient temperature regularly exceeds 120 degrees F.
- Vacuums must breathe...do not enclose. Be sure to mount 6 inches from sidewalls.

MOUNTING THE WALL BRACKET (SHEETROCK) *

If installing direct from the factory, you will first need to slide the wall bracket out of the unit bracket. *These brackets are found on the back of the unit. There may be a long narrow aluminum brace holding them together. This piece is there for shipping purposes and can be thrown away.*

1. Find center of stud and mount the wall bracket.
Note, the bracket mounts in the middle of the unit, so you will need to mount approx. 3" below your desired unit height. See fig. 1 for more details.
2. Use wall hanger bracket as a template. Use the two vertical holes (approximately 10" apart). Then, mark the location on the stud.
3. Use a 1/8" drill bit and drill two pilot holes for these two vertical holes.
4. Mount the wall hanger bracket with washers and lag screws provided. (Side grommets are for vibration. Use the two vertical holes for mounting.)
5. Tighten screws until the washers are snug against the rubber grommets. (Fig. 2)

ATTACHING UNIT TO MOUNTING BRACKET

Mount the VacuMaid® Garage Vac by sliding the attached unit bracket onto the wall bracket (Fig. 3) and slide it down until the unit rests securely into the bracket.

MOUNTING THE HOSE HANGER

Mount high enough so you can loop your hose only four times and still clear the floor. Pre-drill holes with 1/8" drill bit. Mount to the stud using the two screws provided. (Fig. 4)



Fig. 1 You will need to be able to remove the bag from the top of the unit. Be sure to leave enough room when mounting.



Fig. 2 Mount the wall bracket.



Fig. 3 Slide the unit bracket into the mounted wall bracket.

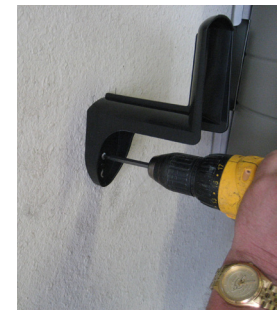

Fig. 4 Mount the hose hanger.

*If mounting on a block or concrete wall, drill the holes with masonry bit and insert plastic or lead anchors (not included). If mounting on plaster, wall board or panel walls, be sure mounting bolts enter studs.

FIRST TIME USE

Before using your system for the first time, follow these 3 steps.

Protector plate must be installed properly for the vacuum to work



PP101
Protector Plate

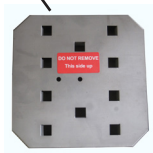

- 1 Make sure the PP101 Protector Plate is in place. This is necessary for proper suction.

Upon receiving your vacuum system, lift off the lid. The protector plate should be located inside the can just below the HEPA bag.

The protector plate is installed correctly when it lays flat, prong side down, directly under the HEPA bag. The warning label should be facing up. The plate provides a barrier between the HEPA bag and mesh screen. This allows air to circulate preventing the motor from overheating.

Do not throw this part away.



- 2 Install the HEPA bag onto the inlet inside the canister.

First, take the bag and fully expand it.

Then place it in the canister and slide its gasket onto the inlet stem until it drops into place in the ridge that is around the inlet stem.



Replace the lid onto the dirt canister and ensure that it seals properly.



- 3 You will need to attach the curved wand to the hose.

To do so, you will twist the wand to the **LEFT** as you thread it onto the hose. Note: This is the opposite direction of typical threading.

REMINDER: This is not a wet pickup and cannot be used with liquid. Doing so will void warranty.

USING YOUR SYSTEM

Vacuuming

Inserting the hose

The hose connects to the system through the utility valve inlet on the front of the unit by lifting the round door open and inserting the hose. (Fig. 1)

See below for using your attachments & cleaning tools.

On/Off Switch

Insert the hose before turning the unit on. The system is turned on and off by flipping the switch on the side of the unit.



USING YOUR ATTACHMENTS & CLEANING TOOLS

Telescopic Wand

Provides you extra length for floor cleaning or reaching high areas.



To use: Adjust by a) twisting the ratcheting mechanism in the middle of the wand to release and extend. Twist back to tighten. b) Adjust by pressing down on the ratcheting mechanism in the middle of the wand to release and extend.

Floor Brush For cleaning light dirt & dust on hard floor surfaces.

To use: Attach to telescopic wand and go back and forth over the area to be cleaned.

Do not force the front of the brush down when moving forward. Allow the brush to gently glide across the floor to pick up larger debris.

(FT220 floor tool is recommended for larger debris. Sold separately)



CLEANING TOOLS

All cleaning tools will attach to either the hose cuff or the telescopic wand by pushing firmly onto the end.

a) Upholstery Tool

Works well for cleaning car upholstery & carpet.



b) Crevice Tool

Reach into cracks and crevices that are hard to reach.



c) Dusting Brush

Use for dusting shelves, tables, dashboards, etc.



Hose Hanger Loop hose on hanger approx. 4-5 times or loop hose on floor and then pick up and hang on hanger.

MAINTENANCE

This system uses a sealed HEPA type bag. The mass of dirt and debris is picked up by your vacuum and deposited into the bag inside your dirt canister.

Emptying your Dirt Can

To remove accumulation, follow these steps:

- 1 Remove the lid by unhooking the clamps & releasing the latches on the top of the canister. (Fig. 1) Lift lid straight up. (Fig. 2)
- 2 Remove the bag by sliding the rubber gasket that surrounds the hole in the paper bag off the plastic inlet stem that protrudes through the front of the canister. (Fig. 3)
- 3 Once the bag is off of the inlet stem, seal the bag by removing the backing from the tab and cover the hole with the flap. Press the flap so that it securely seals over the hole (Fig. 4). This will help prevent dirt and dust from escaping. Now, lift the paper bag from the dirt canister and place in a suitable trash container.
- 4 Take a new bag and extend it fully (Fig. 5).

Installing a New Bag

- 5 Place bag in the canister, and slide its rubber gasket onto the inlet stem until the rubber gasket drops into place in the ridge that is around the inlet stem (Fig. 6).
- 6 Carefully replace the lid onto the dirt canister to ensure that it seals properly. Not doing so could cause a vacuum leak and reduce the cleaning efficiency of your system. Once properly on top, secure the lid with the latches by hooking the clip over the side of the lid and pushing down on the lever to lock into place. Repeat for each side.

If bag breaks...

In the event of a bag breaking while in the unit, it is necessary to lift the plate located under the bag and clean the small screen.

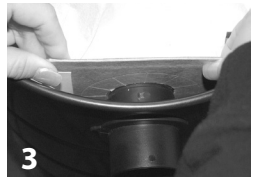

HOW OFTEN SHOULD I CHECK OR EMPTY THE HEPA BAG?

The bag should be changed or cleaned when there is 3-6 inches of dirt or anytime there is a noticeable reduction of air flow at the cleaning tool. Initially, the dirt canister should be checked or emptied weekly until some idea can be obtained as to how long it takes to half fill the canister under your normal cleaning routine. All vacuum systems will function more effectively if they are emptied frequently. Under no circumstances should you allow your dirt canister to become more than 3/4 full before emptying.

WARRANTY

5 YEAR LIMITED* WARRANTY Domestic Residential Use only

This Warranty gives you specific legal rights, you may also have other rights which vary from State to State (or Province).

ITEMS COVERED

*The VacuMaid® GARAGE VAC system is warranted for a period of 5 years. Hoses, floor brushes, and cleaning tools are warranted for a period of 2 years. All warranties commence from the original date of purchase. Any warranted defects will be repaired or replaced without cost to the customer except for transportation charges and/or charges associated with removal and reinstallation. This Warranty is given only to the original owner and cannot be transferred.

ITEMS NOT COVERED

This Warranty does not cover such conditions as normal wear to the power unit resulting from normal usage or from damage caused by accidents, negligence, misuse, or improper alteration, or from damage by fire, flood, or other acts of God. Motor brush wear is normal and is not considered to be a defect in material or workmanship. Further, this Warranty does not apply to vacuum tubing, fittings, inlets, or to the act of installing the VacuMaid® GARAGE VAC system, including installation materials, installation damages, or damage to the power unit caused by defective or improper installation of the VacuMaid® GARAGE VAC. This warranty also does not cover pick up, delivery or house calls.

Picking up liquid of any kind will void warranty.

DISCLAIMER OF OTHER WARRANTIES

LINDSAY MANUFACTURING, INC., HEREBY DISCLAIMS ALL LIABILITY WHATSOEVER FOR ANY INCIDENTAL OR CONSEQUENTIAL DAMAGES WHICH OCCUR AS A RESULT OF DEFECTS IN MATERIAL AND WORKMANSHIP IN THE PRODUCT. LINDSAY MANUFACTURING, INC., ALSO HEREBY DISCLAIMS ALL IMPLIED WARRANTIES, INCLUDING THE WARRANTIES OF MERCHANTABILITY AND FITNESS FOR A PARTICULAR PURPOSE.

SOME STATES (or provinces) DO NOT ALLOW THE EXCLUSION OR LIMITATION OF INCIDENTAL OR CONSEQUENTIAL DAMAGES, SO THE ABOVE LIMITATION OR EXCLUSION MAY NOT APPLY TO YOU. SOME STATES (or provinces) DO NOT ALLOW LIMITATIONS ON HOW LONG AN IMPLIED WARRANTY LASTS, SO THE ABOVE LIMITATIONS MAY NOT APPLY TO YOU. TO THE EXTENT THAT ANY LAW PROHIBITS, IN WHOLE OR PART, THE LIMITATION OF IMPLIED WARRANTIES, ANY IMPLIED WARRANTY APPLICABLE TO THE PRODUCT SHALL NOT EXCEED A PERIOD OF 5 YEARS FOR SINGLE RESIDENTIAL APPLICATIONS OR 90 DAYS FOR COMMERCIAL/INDUSTRIAL AND OTHER APPLICATIONS.

This warranty is exclusive and is in lieu of all other expressed warranties, and in lieu of all other obligations or liabilities on the part of Lindsay Manufacturing, Inc., for damage to person or property. We do not authorize any person, including any dealer, agent, supplier, or representative of Lindsay Manufacturing, Inc., to make any other warranty or guarantee on our behalf, or assume for us any liability on the VACUMAID® GARAGE VAC System other than that contained herein. No oral representations regarding warranty shall be binding upon Lindsay Manufacturing, Inc., whether extended before or after sale of that product.

TERMS OF WARRANTY AND RESTRICTIONS

*The 5 year/2 year term of this limited Warranty is effective for single family residential applications only. In commercial/industrial and other applications, this limited warranty is valid for ninety (90) days only from the date of purchase for all components of the system. In commercial/industrial and other applications, this warranty shall be for the benefit only of the original owner of the VacuMaid® GARAGE VAC system. Any failure caused by an unsupported or third-party component will not be covered by warranty.

HOW TO INVOKE THIS WARRANTY

If it should ever become necessary to invoke the rights and privileges of this Warranty during the period of effectiveness the following procedures should be followed:

- a) Refer to operating maintenance instructions to ascertain that a malfunction of the vacuum cleaner has actually occurred.
- b) **Notify the VacuMaid representative, at 1-800-221-1862, that you have a problem and describe the nature of your difficulty.**

TROUBLESHOOTING

Most problems that develop can be fixed easily by following the below suggested solutions:

Vacuum cleaner won't run

- Be sure the unit is plugged in.
- Be sure you turned the system on.
- Check your circuit breaker panel. Make sure there is not too much on that circuit causing it to trip.

Low suction or no suction

- First, see above.
- Usually low suction is caused by a full bag. Change your bag. See Operating Instructions for details.
- Is the dirt canister lid off or loose? Be sure the lid is replaced squarely on the top of the canister and that the gasket has not been pulled loose or it could allow a vacuum leak. If gasket is loose, reattach with contact cement or super glue.
- Is there blockage in the hose or tools? Disconnect the hose from power unit, use a blunt item to push the clog out. If the blockage is in the tools, remove it.
- Is PP101 Protector Plate in place? Lift the lid. The metal plate should be located just beneath the HEPA bag inside the can, laying flat with the smooth side up.

BAG REPLACEMENTS

HPB2HPK 3 pack of HEPA filtered bags
Available on AMAZON or at www.vacumaid.com

ADD ONS & UPGRADES

Hoses

HS130 30' Hose
HS150 50' Hose

Wands

WO119P Plastic Telescopic Wand
WPO218 Plastic Curved Wand
W419C Chrome Telescopic Wand
W328R Chrome Curved Wand

Tools

WP-112K Wet Pick Up Kit
CT100 Flexible Crevice Tool
CT530/630 Crevice Tool
DB530/630 Dusting Brush
UT530/630 Upholstery Tool
FB215BLK 12" Floor Tool with Bristles
FT220 Notched Floor Tool (no bristles)
PB250 Rug Rat Air Turbine brush
MSLT1 Multi Surface Lint Tool
CT6 Mini-Vac Attachment Kit
IUT200 Upholstery Car Tool with cuff
w/ **HC111BL**

Tool Storage

CB180 Caddy Bag
WWH1 Wall Wand Holder
H431 Hose Hanger - for 30' hose
H231 Hose Hanger - for 50' hose

Cuffs

HV109BL Plastic Hose Cuff 1-1/4"
HV108 Hose to Hose Cuff, threaded both ends

Motors & Replacements

MB122264 GV PRO Replacement Motor
MB119804 GV Replacement Motor
P107B Motor Gasket
DC12005AS Replacement GV lid
BIF125 Bag Inlet Fitting
5584 Utility Valve with Grommet
PF204D 2"x1.705 Reducer Coupling
PF125A GV Bushing
EXF16 Exhaust Stem Fitting
GVB Replacement Wall Mount Bracket
HPB2HPK HEPA Bag (3 pk)

PET PACK

Great addition to your VacuMaid® Garage Vac when you have pets in the home. Not only eliminate unwanted fur from your furnishings but also your pets. **Great for grooming.**

SMALL ANIMAL

PT530 Pet Grooming Tool
HV109SC Plastic Swivel Cuff for 1-1/4"
FT220 Notched Floor and Rug Tool

LARGE ANIMAL

CC206 Curry Comb
HV109SC Plastic Swivel Cuff for 1-1/4"
FT220 Notched Floor and Rug Tool

PERSONNEL VAC PACK

For on the job personnel cleaning, where they are especially dirty or dusty from their working environment such as flour at bakeries, metal shavings at mill, etc. For these specialized cleaning purposes, this tool set will give you the tools necessary for personnel cleaning. **Use to vacuum off clothing.**

HS130 1-1/4" X 30' Silver Hose
HV109BL Hose to Inlet Connector
UT530BL Upholstery Tool Only - Black
H431 Plastic Hose Hanger

For replacement bags or to order additional
tools or accessories,
visit us at **www.vacumaid.com**
or give us a call at
1-800-221-1862

To register your product online, go to
www.vacumaid.com/registration



VacuMaid[®]
Central Vacuum Systems

PO Box 1708
Ponca City, OK 74602
1-800-546-3729