



**SILVAN**  
RESILIENT HARDWOOD COLLECTION  
Wall Installation



## Specifications

7" wide  
7.21" x 78.74" (183 mm x 2000 mm)  
9.2 mm thick  
0.6 mm Hardwood Wear Layer  
19.7 SF per box  
45.35 lb per box

## Welcome

### INTRODUCTION

Congratulations on your purchase of Silvan Resilient Hardwood. Your premium resilient hardwood planks are designed to exceed industry standards. They should provide decades of easy maintenance and service. Please read the following instructions carefully before beginning installation.

## Guidelines

### GENERAL

Silvan Resilient Hardwood should only be installed indoors, NEVER outdoors. Carefully inspect all planks prior to installation. Please note that this is a natural product and slight plank to plank variations in color, grain, and other natural characteristics are expected. If any defects are identified, do not install! Contact Flooret immediately.

## Pre-Installation

CAREFULLY READ ALL INSTRUCTIONS BEFORE YOU BEGIN THE INSTALLATION

- Silvan Wall Installation can be installed in most places in the home and commercial areas. They are not suitable for — and should be not installed in — humid or wet areas such as bathrooms or saunas.
- Silvan Wall Installation cannot be installed on ceilings or angled walls.
- Silvan can be installed both horizontally and vertically on walls.
- Packages should be transported and stored horizontally — acclimatise unopened packages in a dry, well-ventilated area of the job site for at least 48 hours before installation.
- Maintain a room temperature of at least 18°C (64°F) and relative air humidity (RH) range between 35-65% during storage and installation.
- Planks from several different packages can be mixed to get your preferred look.

- Examine each plank in daylight before installation to look for any damage or visible defects in color or texture. Problems with defects need to be brought to the attention of the supplier before installation.
- Silvan Wall Installation clips (sold separately) are small parts, keep them away from small children.

### Substrates

- The substrate (the surface that Silvan Wall Installation will be installed on) should be flat, load-bearing, permanently dry, and free of large cracks.
- Any unevenness greater than 3mm (1/16") over a length of 2 meters (6 ft) needs to be levelled — use patching or levelling compound or ground/sand the area.
- Ensure the substrate is clean.
- Wallpaper should ideally be removed before installing Silvan Wall Installation.
- Silvan Wall Installation must be installed as per the manufacturer's instructions.

**Per industry standards, installation of planks constitutes acceptance of visual defects. Please inspect all planks carefully prior to installation.**



**SILVAN**

RESILIENT HARDWOOD COLLECTION

Wall Installation

### Before Installing

Important information — Screws, glue, and other necessary materials to attach the rail support/panels to the wall are not included. Make sure that the screws, glue, and other mounting material are suitable for the type of wall that you are installing on. When in doubt, contact your local specialized retailer.

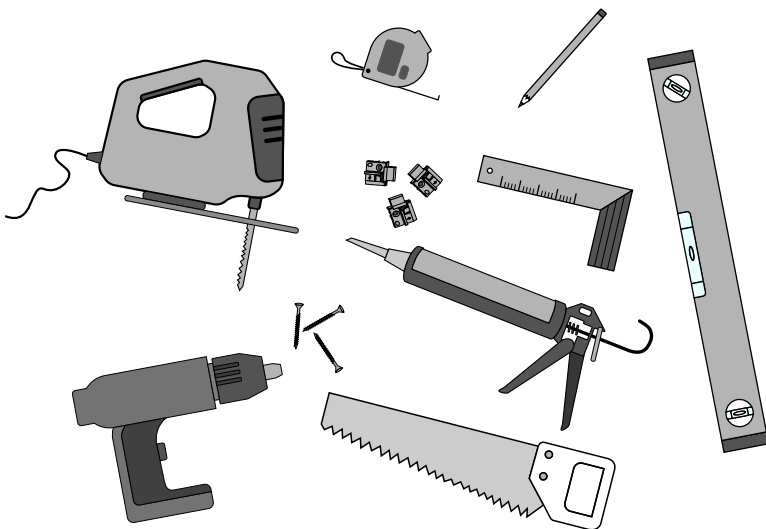
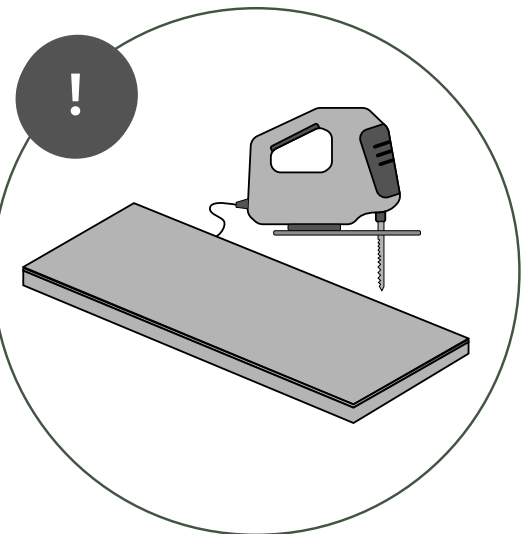
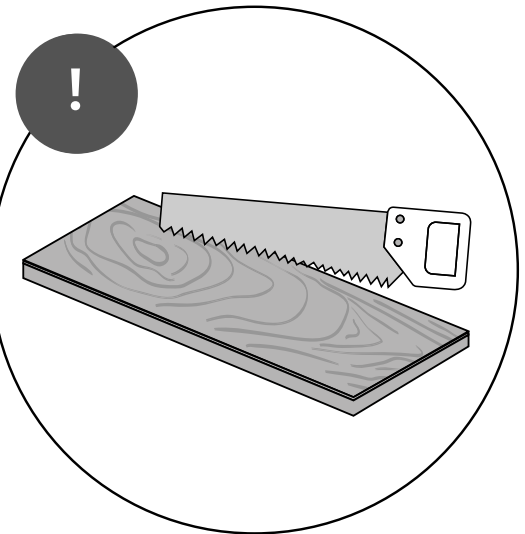

### CAUTION – WOOD DUST

Cutting, sanding or machining wood products produces wood dust. While wood products are not hazardous under OSHA Hazard Communication Standard 29, the International Agency for Research on Cancer (IARC) and the state of California have classified wood dust as a human carcinogen. Precautionary Measures: Equipment should be equipped with a dust collector to reduce airborne wood dust. Wear an appropriate NIOSH designated dust mask to reduce exposure to airborne wood dust. Avoid contact with eyes and skin. In case of irritation, flush eyes or skin with water for at least 15 minutes. In cases of severe irritation, seek immediate medical attention.



**SILVAN**

RESILIENT HARDWOOD COLLECTION

Wall Installation

**Note:** Silvan planks can be installed horizontally or vertically on walls.

A

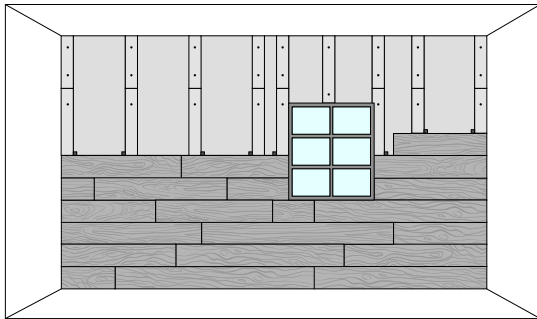

B

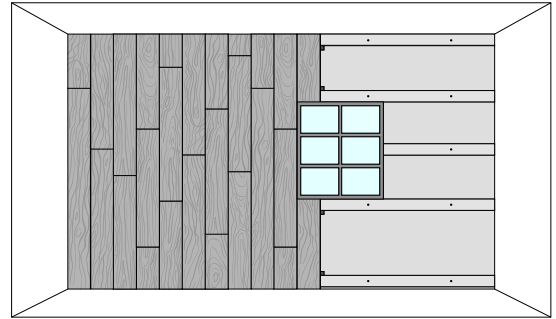

**Step 1:** Cut a plank in half lengthwise.

A1

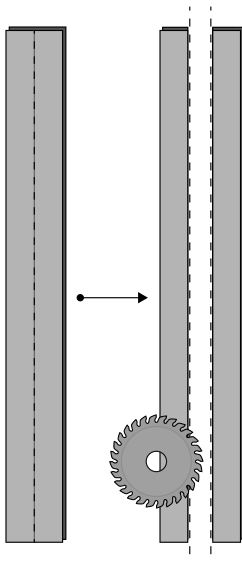

B1

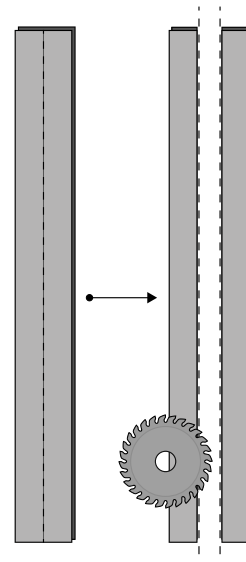



# SILVAN

RESILIENT HARDWOOD COLLECTION

## Wall Installation

**Step 2:** Beginning at the bottom corner of the wall, use a level to accurately position the first half of your cut plank. There should be 5/16" gap between the plank and the adjacent wall. Align the click mechanism as shown.

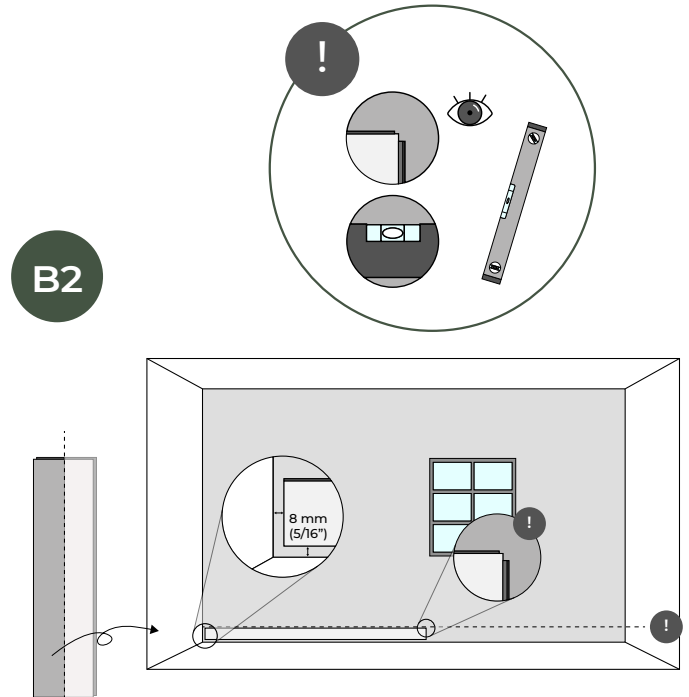
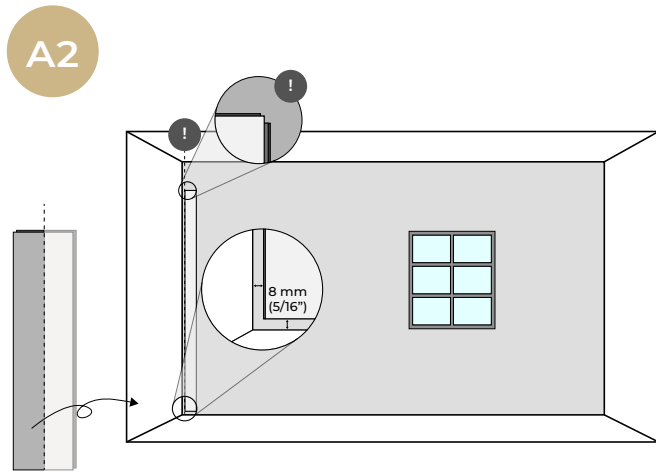

**Step 3:** Screw the plank into the wall making sure the screw heads are not sticking out.

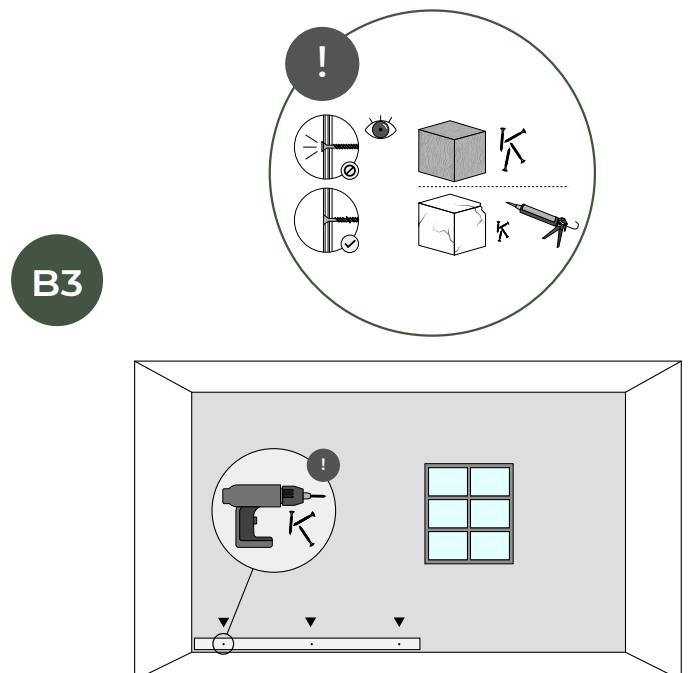
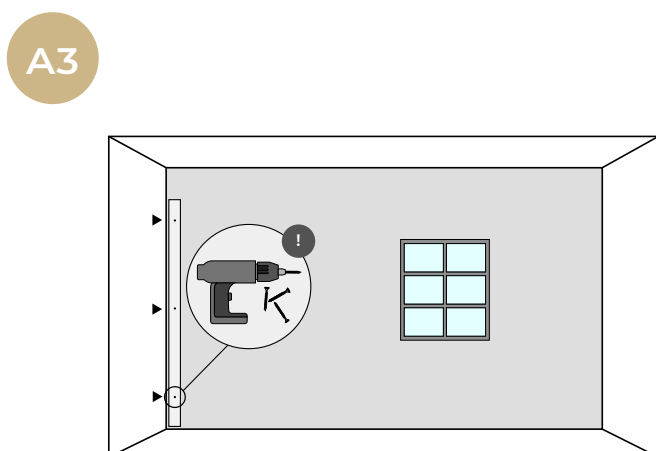



# SILVAN

RESILIENT HARDWOOD COLLECTION

## Wall Installation

**Step 4:** For the next plank(s) follow the previous steps while also clicking the short end into the previous plank.

A4

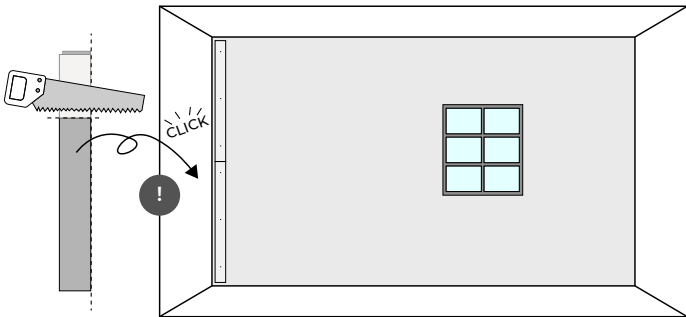

B4

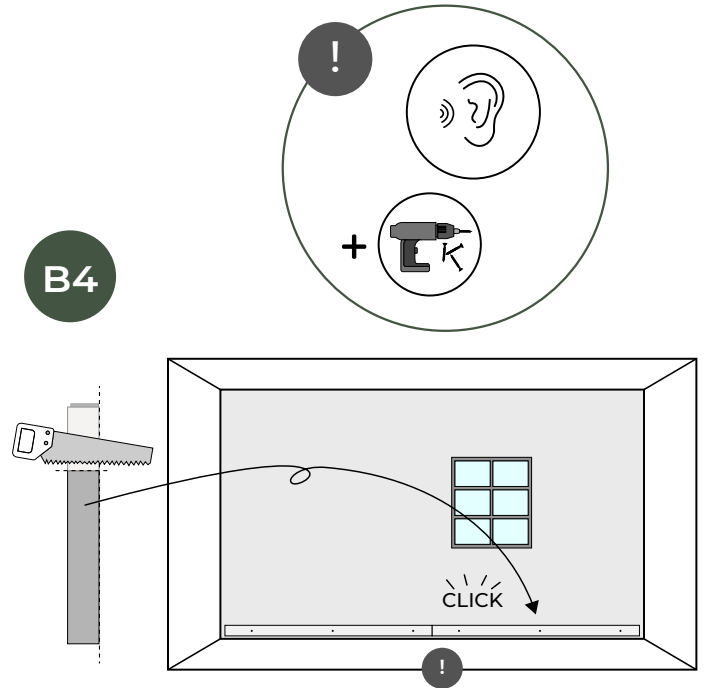

**Step 5:** Install a row at the top of the wall using the same guidelines as the bottom row, but with the click system aligned as shown.

A5

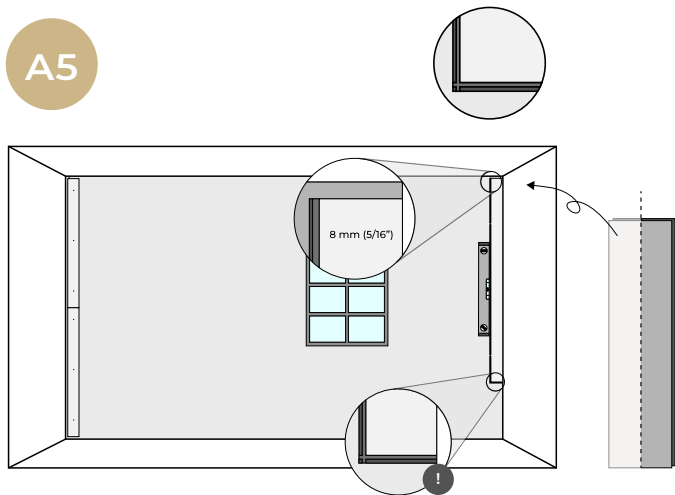

B5

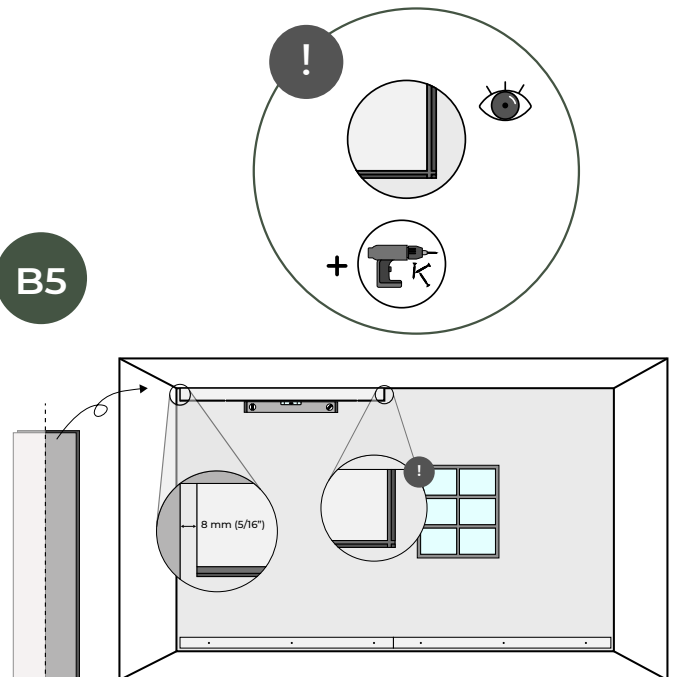



# SILVAN

RESILIENT HARDWOOD COLLECTION

## Wall Installation

**Step 6:** Frame any windows or doors with rows as shown using the same technique outline in previous steps.

A6

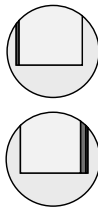
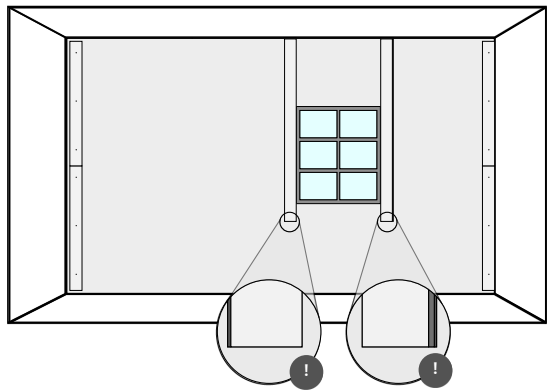

B6

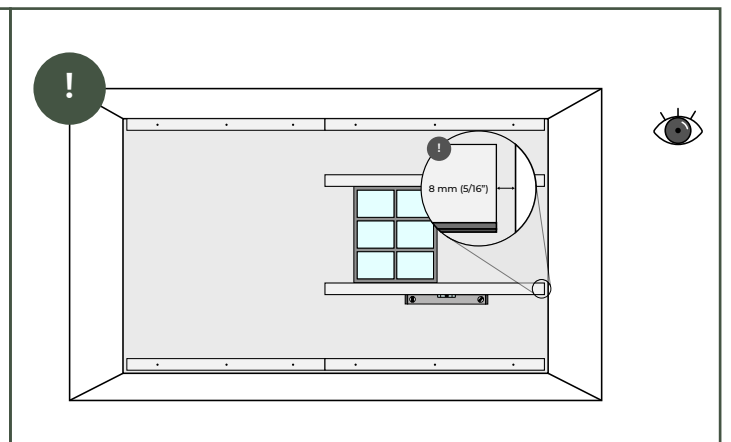
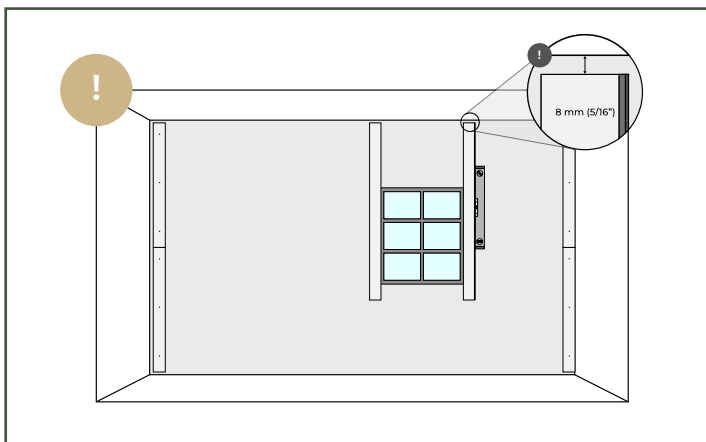
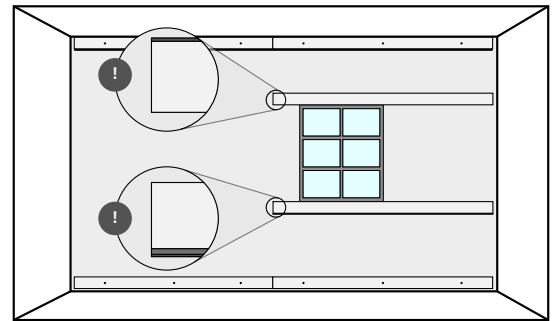
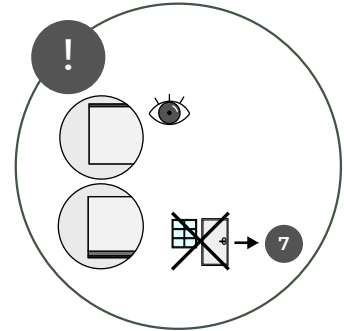
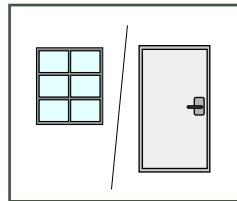





# SILVAN

RESILIENT HARDWOOD COLLECTION

## Wall Installation

**Step 7:** Other than areas accommodating windows/doors, rows should be spaced 23 5/8" apart. From one row to the next, be sure to align the click system as shown in the image.

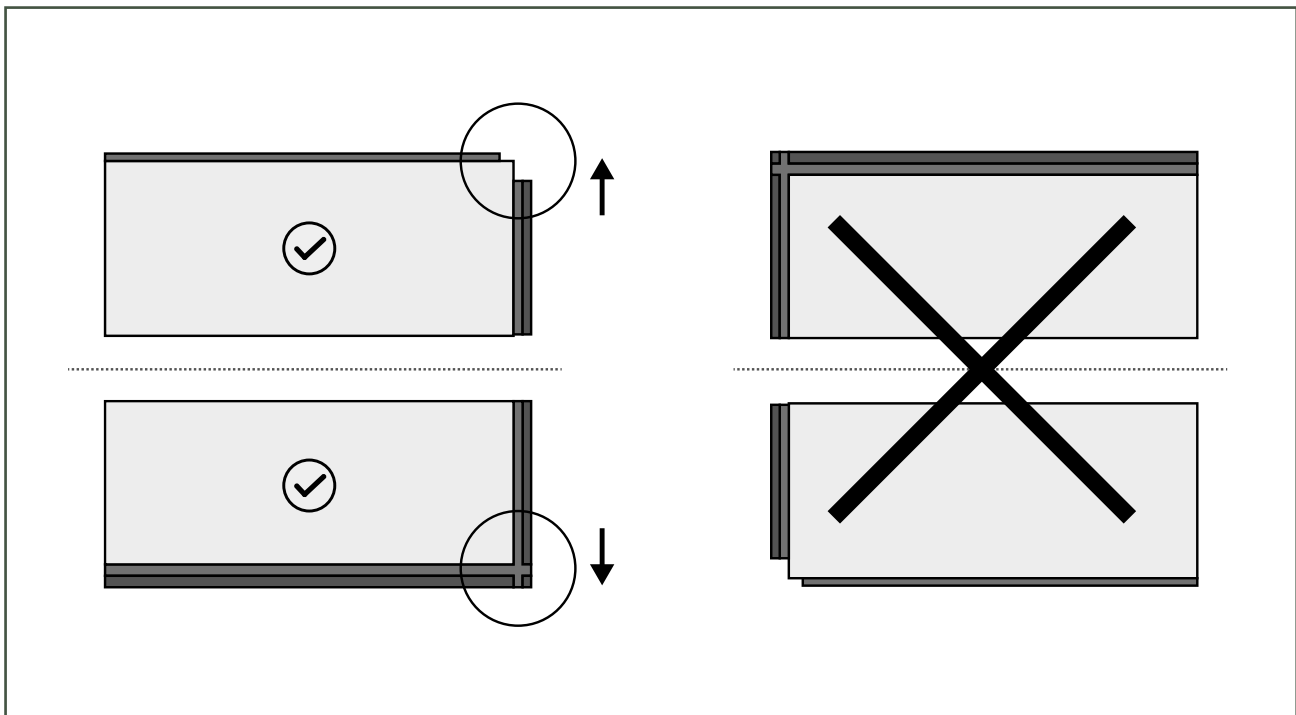
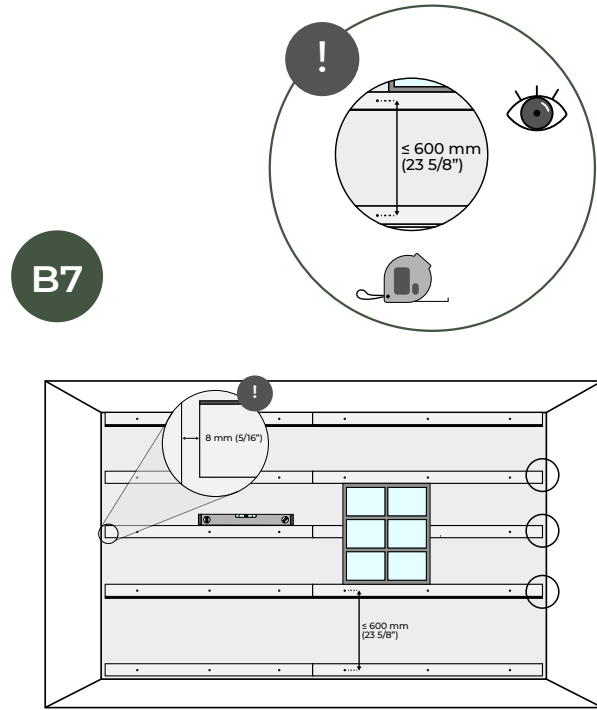
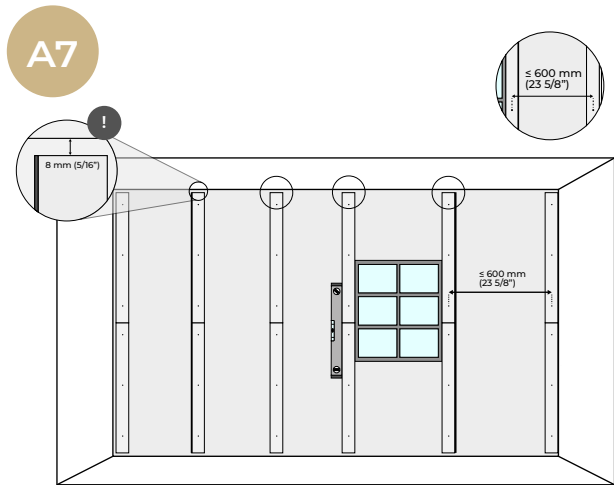





**SILVAN**

RESILIENT HARDWOOD COLLECTION

Wall Installation

**Step 8:** Using a level, align the uncut wall panels with a 5/16th" gap from the adjacent wall with the click mechanism oriented as shown in the image.

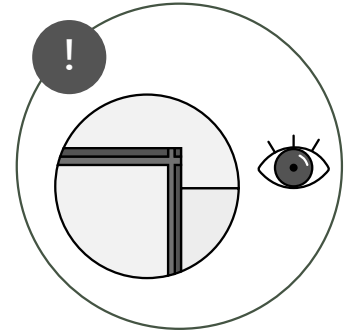

A8

B8

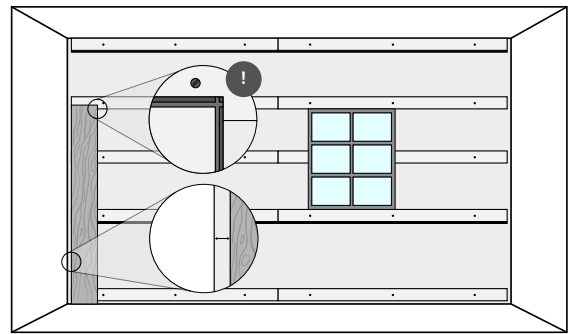
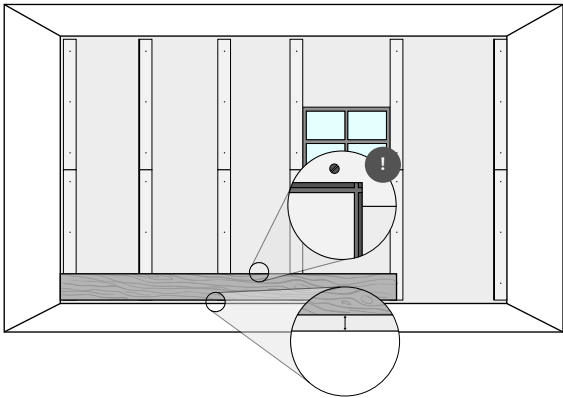

**Step 9:** Interlock the 5G Climb clips at the appropriate intersecting corners.

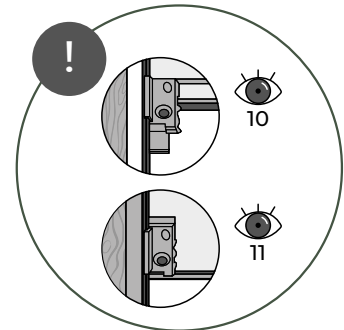

A9

B9

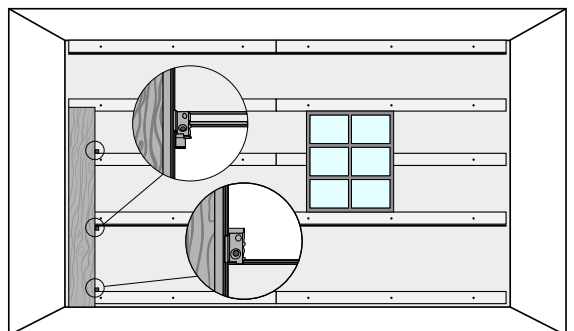
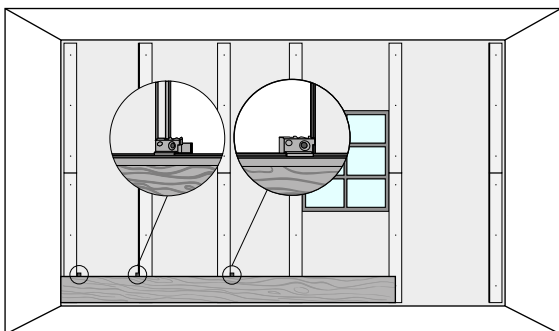



**SILVAN**

RESILIENT HARDWOOD COLLECTION

Wall Installation

**Step 10:** Interlock one side first and then slide to the intersecting corner.

A10

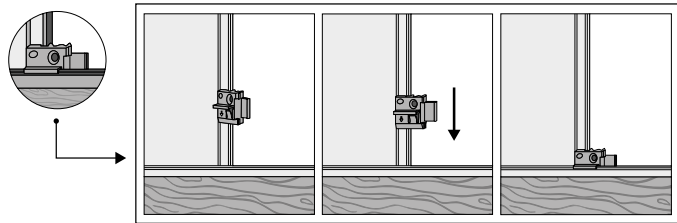

B10

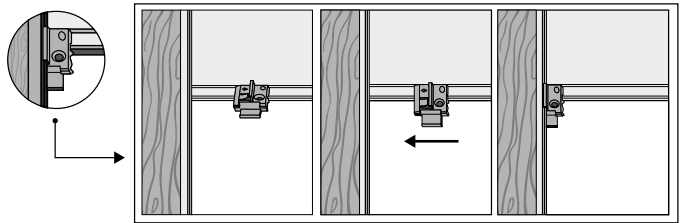

**Step 11:** Repeat for all clips.

A11

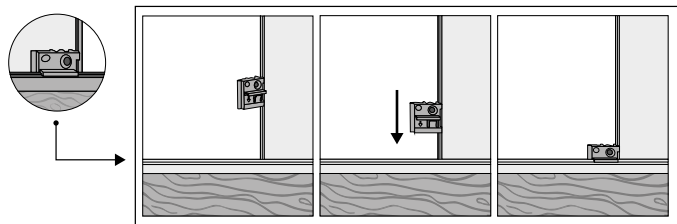

B11

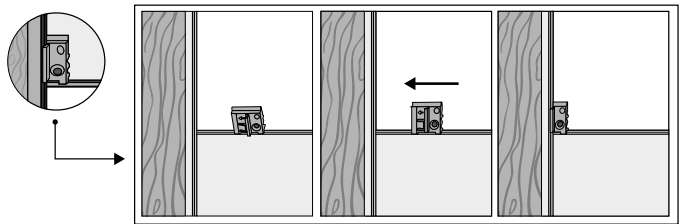



**SILVAN**

RESILIENT HARDWOOD COLLECTION

Wall Installation

**Step 12:** Be sure to leave a  $\frac{3}{8}$ " gap at the ceiling, using a shim if necessary to measure and cut.

A12

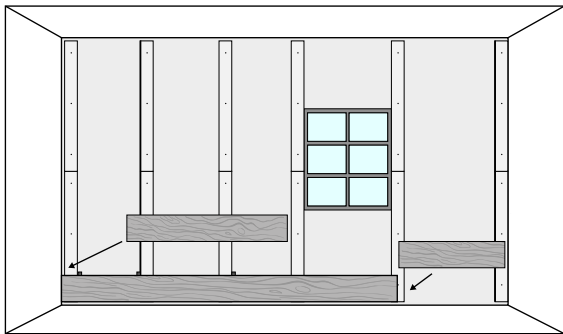

B12

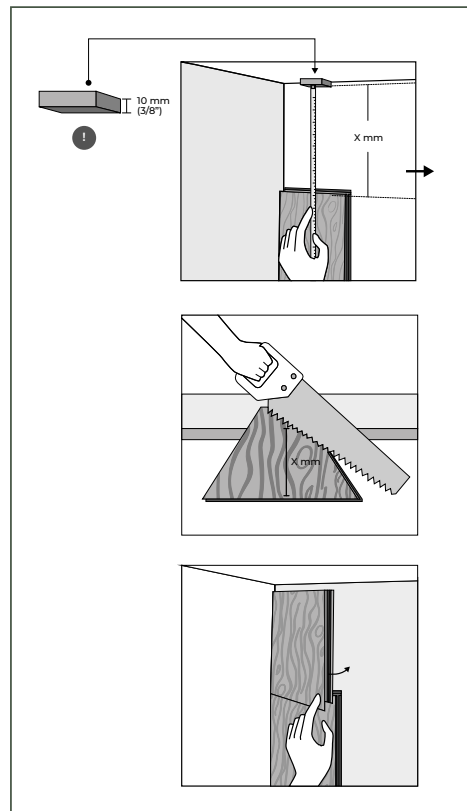
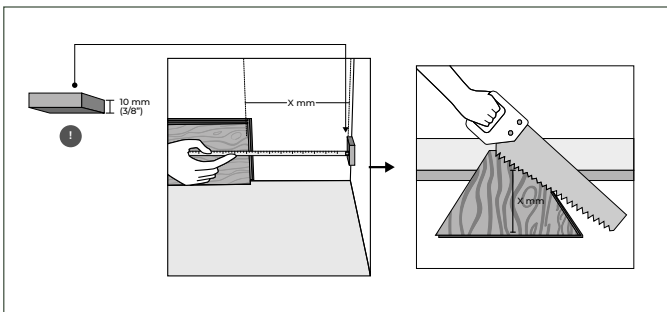
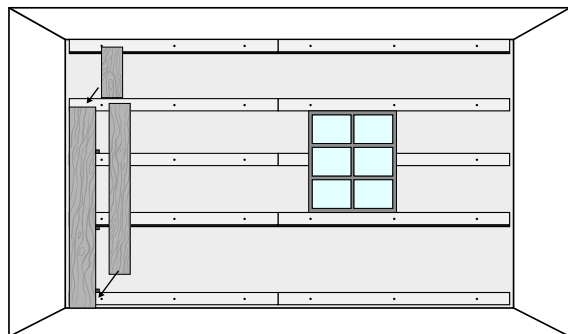



**SILVAN**

RESILIENT HARDWOOD COLLECTION

Wall Installation

**Step 13:** For the next plank(s) follow the previous steps while also clicking the short end into the previous plank.

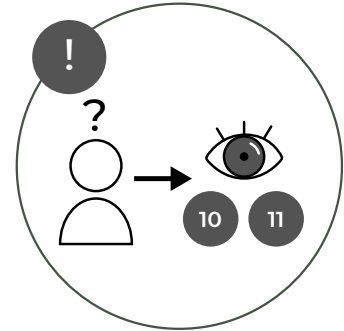

A13

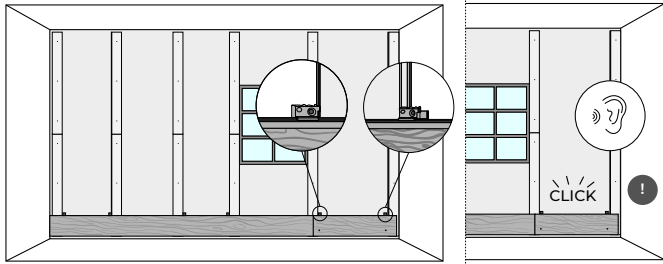

B13

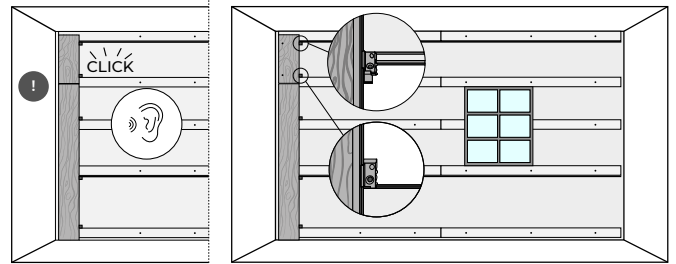

**Step 14:** Use screws to secure the perimeter row.

A14

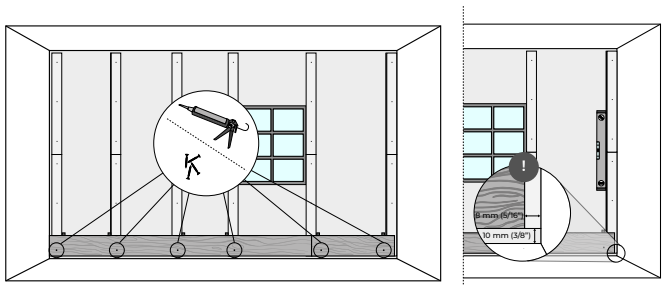

B14

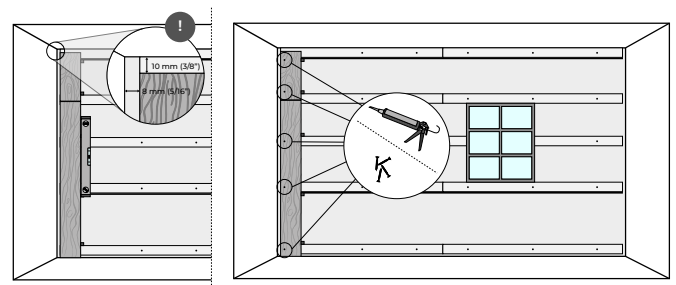



**SILVAN**

RESILIENT HARDWOOD COLLECTION

Wall Installation

**Step 15:** Begin your next row and add 5G climb clips.

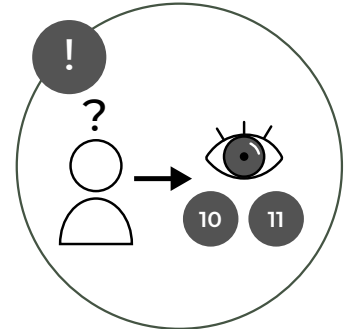

A15

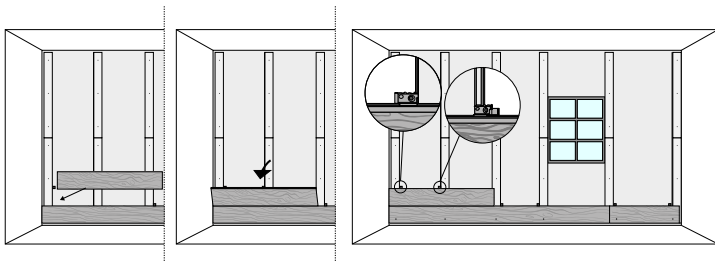

B15

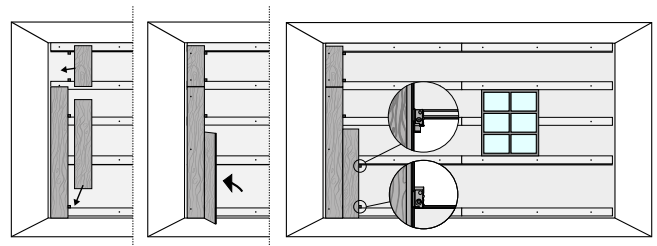

**Note:** Stagger end joints so they are at least 16" apart. You can usually use the cut end of the previous row to start your new row, but only if the end joints are at least 16" apart.

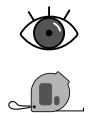
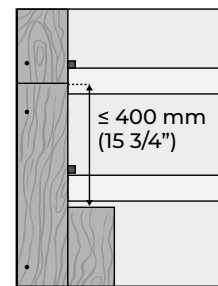
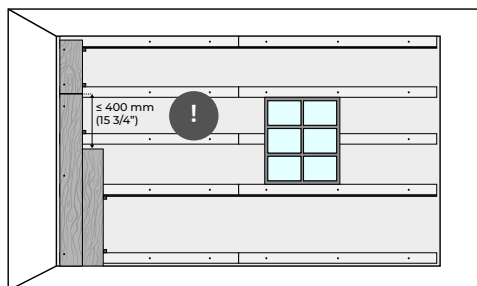
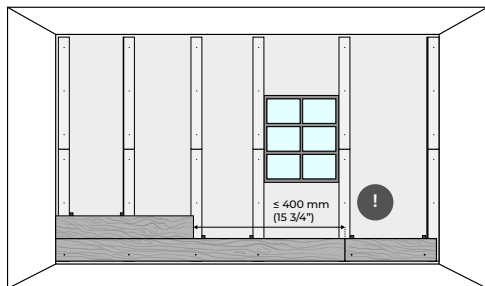

**Step 16:** Measure and cut the final piece of your second row.

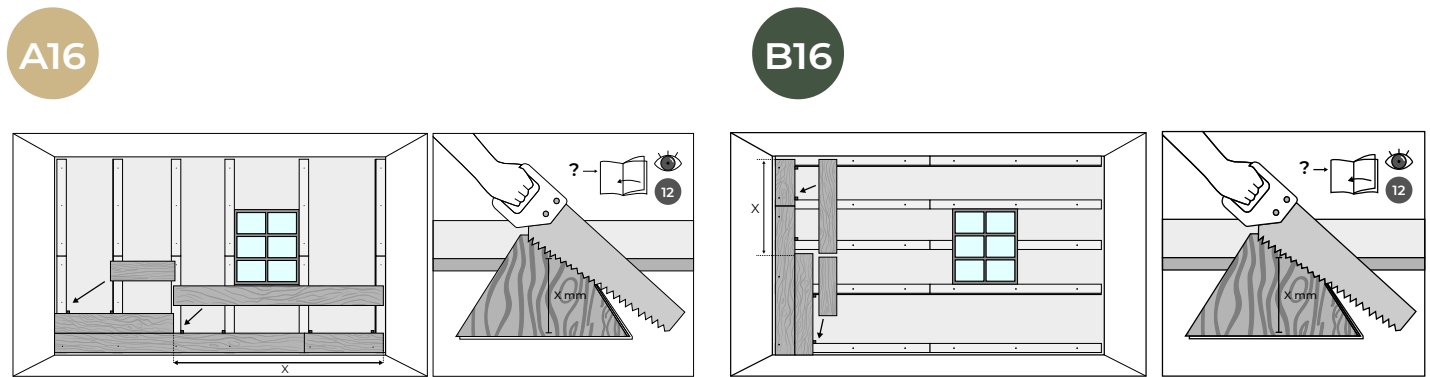

**Step 17:** Click the plank into place, listening for the click sound to ensure the plank is locked in second row.

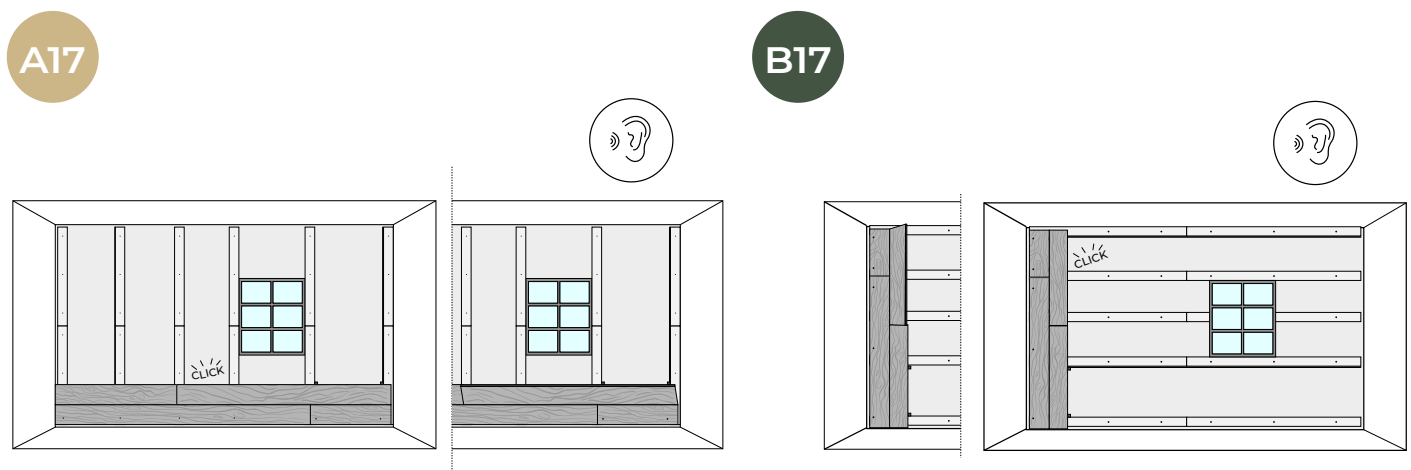



**SILVAN**

RESILIENT HARDWOOD COLLECTION

Wall Installation

**Step 18:** Add 5G Climb clips as previously shown.

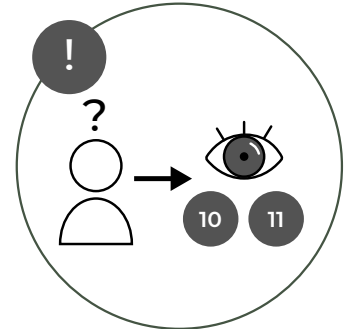

A18

B18

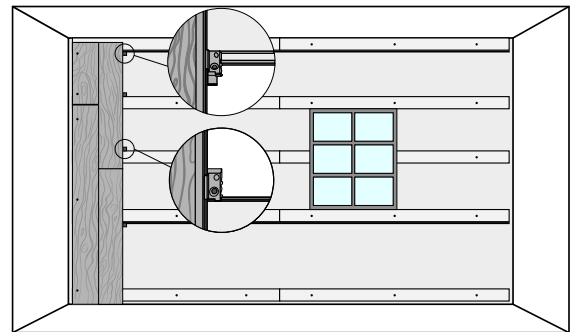
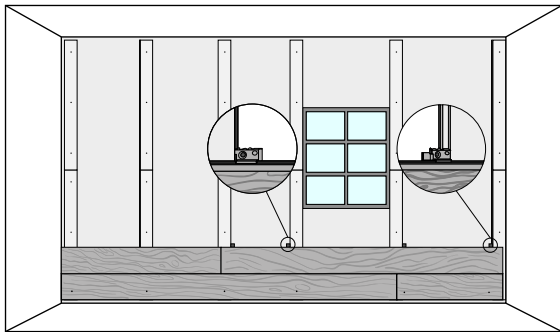

**Step 19:** Continue the installation in this way, making sure to continue staggering the planks from one row to the next.

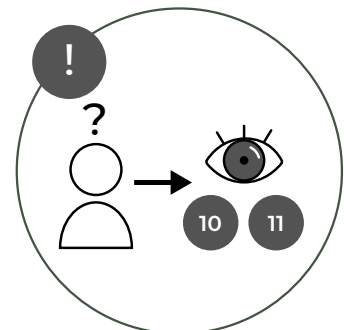

A19

B19

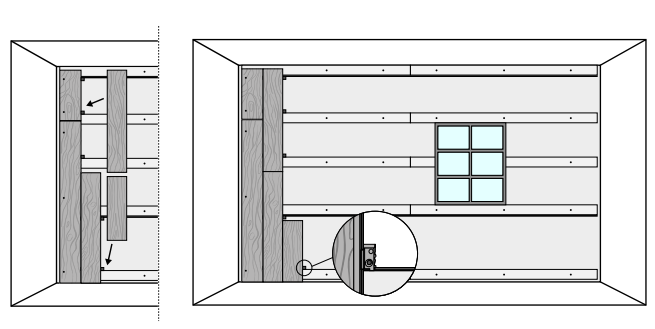
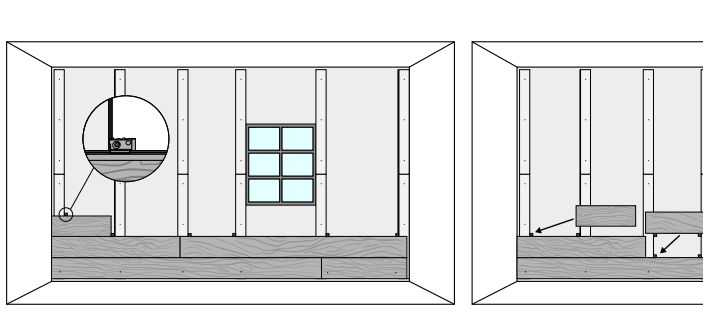





**Step 20:** Install planks across the entire wall until you reach the final row. Place clips accordingly.

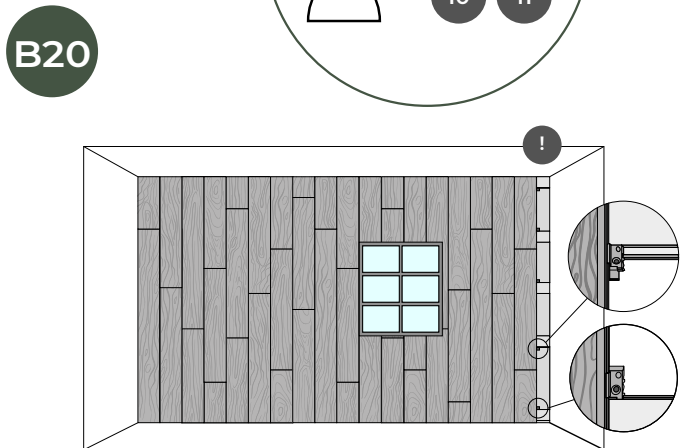
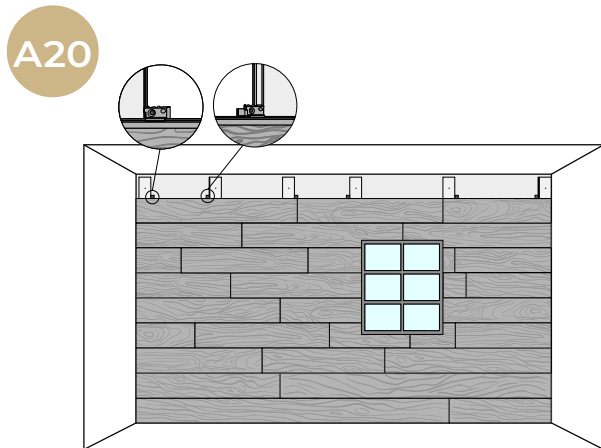

**Step 21:** Measure the space for your final row, making sure to leave 5/16" gap at the wall.

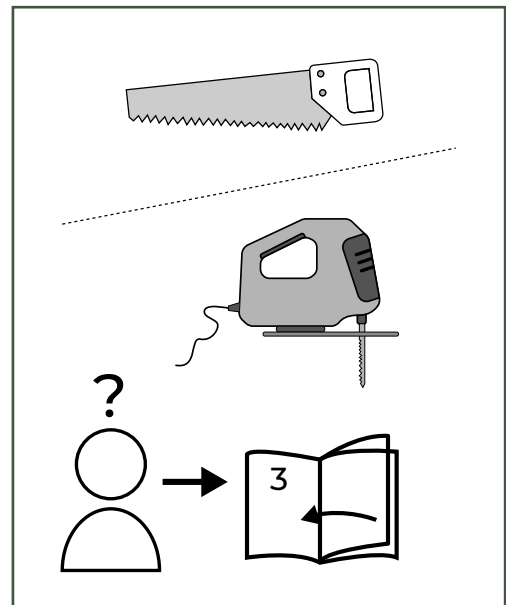
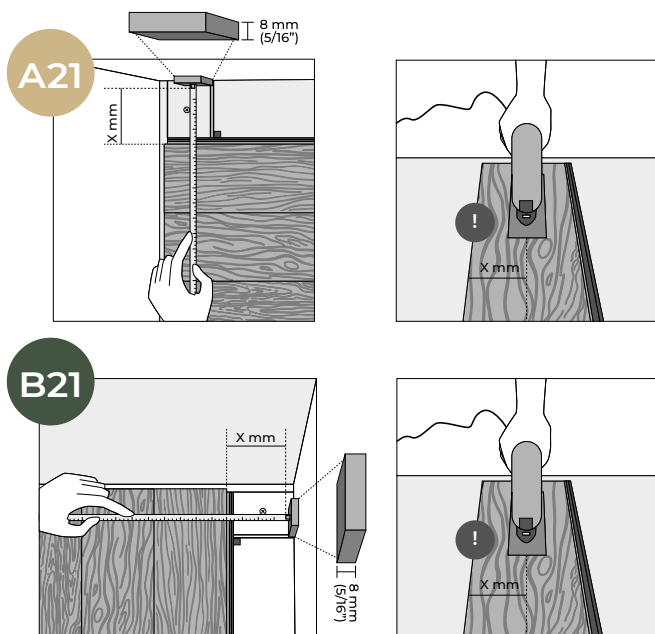

**Step 22:** Install skirting board or decorative trim along the exposed edges as shown.

A22

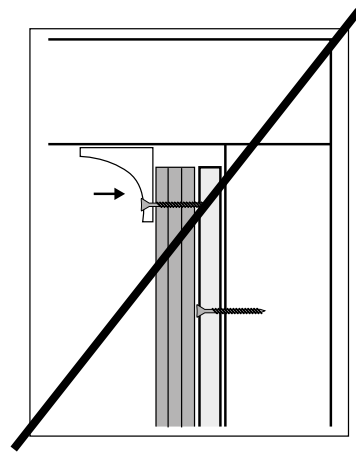
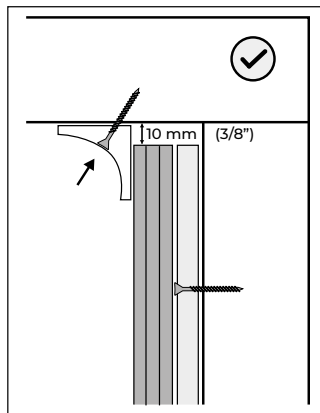
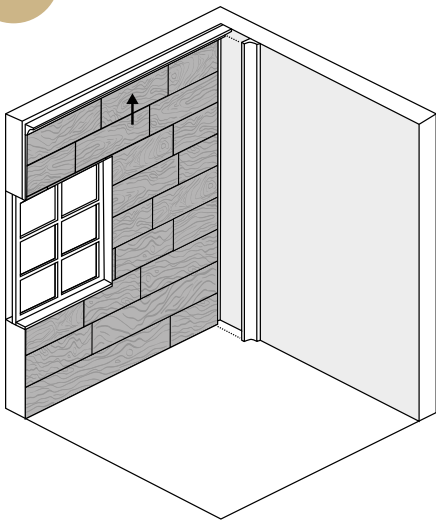

B22

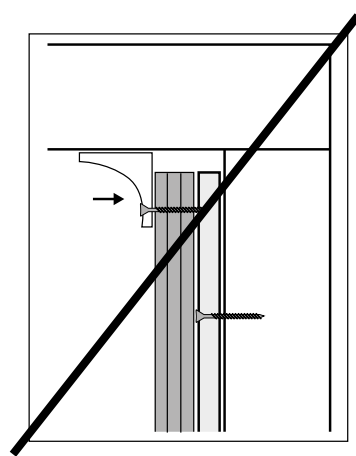
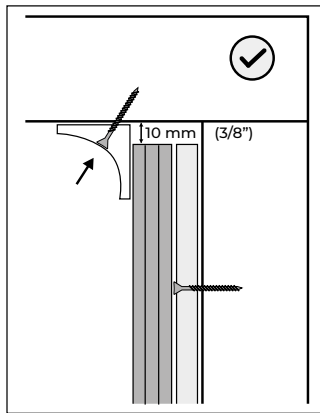
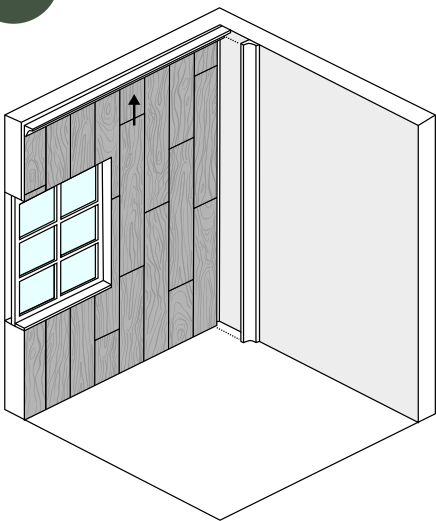

**Uninstalling Planks: 5G Tool**

**A**

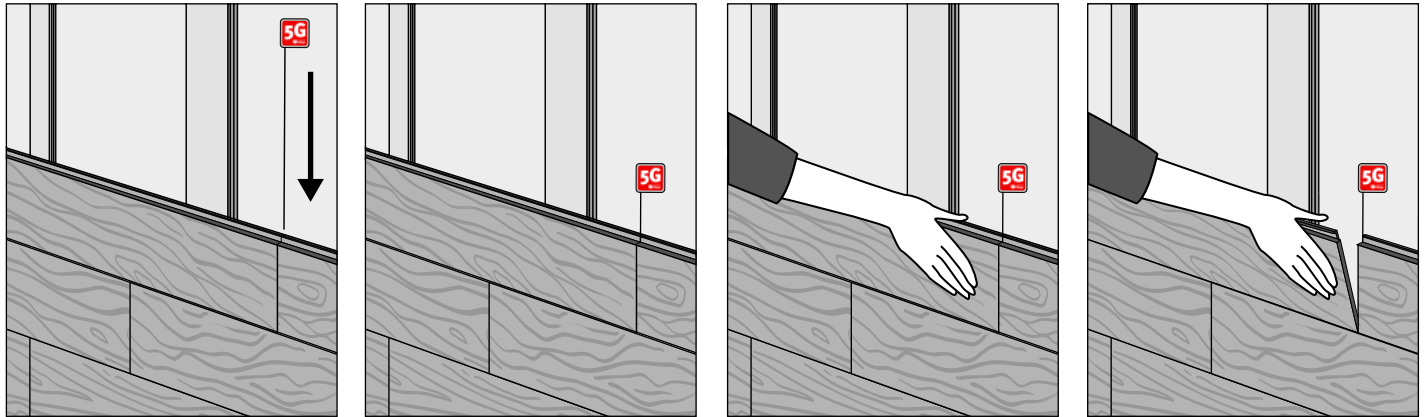

**B**

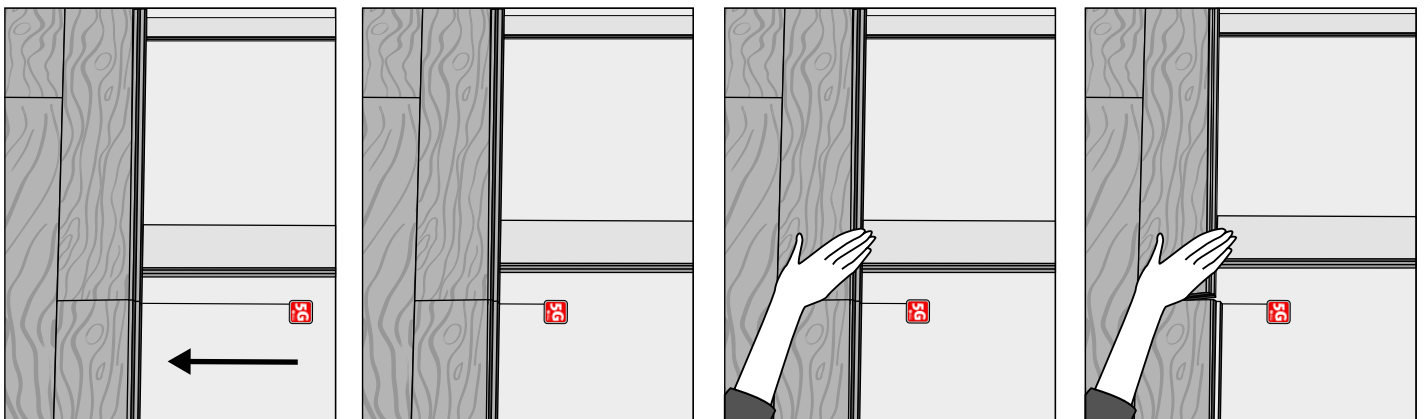

Machining wood products produces wood dust. IARC and the state of California have classified wood dust as a human carcinogen. Equipment should be fitted with a dust collector to reduce airborne wood dust. Wear an appropriate NIOSH designated dust mask to reduce exposure to airborne wood dust. Avoid contact with eyes and skin. In case of irritation, flush with water for at least 15 minutes. In cases of severe irritation, seek immediate medical attention.