

# HALMAI

## Instruction Manual

# HALMAI

## INDEX

- 1** Check before Using
- 2** Note for Battery
- 2** Note for Using
- 2** Maintenance Work
- 3** Note for Injury
- 3** How to Use
- 5** Charging
- 5** Problems and Terms of Settlement
- 7** Specifications
- 7** Warranty and Customer Service

# HALMAI

Thank you for choosing HALMAI! Please read this user guide carefully and keep it in an accessible location so you may refer to it later.

## **IMPORTANT SAFEGUARDS READ ALL INSTRUCTIONS BEFORE USING.**



To reduce the risk of burns, electrocution, fire or injury to persons.

**Please be sure to read the safety instruction as follow to avoid potential hazards that could result in personal injuries or damage to the device.**

## **01 Check before Using**

- 1** Check the power supply cord before the first time use and during the life of the device. Do not use the device if it has a damaged cord or plug, or if it is not working properly.
- 2** Do not plug the device into a voltage system that is not specified on the device or charger. Use with improper voltage will damage the device and VOID warranty.
- 3** Use the original charger only.



## 02 Note for Battery

- 1 The battery needs to be charged fully before the first use to ensure optimal performance.
- 2 Do not over charge the device or use it when charging.
- 3 Charge the device in a well-ventilated condition with 0°C-40°C. Do not charge the device close to flammable or explosive materials.
- 4 Do not cover any thing on it when charging.
- 5 Charge the device once every three months to keep it in normal conditions, the battery performance will decline over several years.

## 03 Note for Using

- 1 To prevent electric leakage and shock or fire, do not draw out the connecting wires during use or touch the plug with the wet hand. Turn the power off after use.
- 2 Misuse, dropping or excessive force may cause device damage.
- 3 Minor should not use this device without parental consent and supervision.

## 04 Maintenance Work

- 1 Do not disassemble the device. Doing so could be dangerous and constitutes voiding warranty conditions.
- 2 Do not store the device in a hot or humid environment. Store it in a cool and dry place.

# HALMAI

- 3 Keep the electrical cord away from heated surfaces.
- 4 Do not dispose of the device in heat or fire.
- 5 Do not clean the device with harmful chemicals or detergents.

## 05 Note for Injury

- 1 Do not use the device if you have an open wound on your nail or hand.
- 2 If you have any skin diseases, heat-sensitive, allergic reactions, onychomycosis, or any other disorder, you should consult your doctor and medical professional before using the device.

**The operator shall be responsible for any consequences including product damage or accidents if not strictly complies with the instructions. If you require any technical support, please contact us.**

**SAVE THE INSTRUCTION MANUAL**

## 06 How to Use

- 1 The indicator light is pressed for the first time for 20 seconds, long press for two seconds to convert to 60 seconds.
- 2 The red light is on when charging, and the blue light is when the battery is fully charged.
- 3 Rechargeable product. The continuous operation time of the product is 40 minutes.

# HALMAI

- Please read the user manual carefully before use.
- Do not pour any liquid into the machine, and do not use it near fire or high temperature, otherwise damage may occur.
- This product uses a rechargeable lithium battery to prevent damage from excessive battery drain.
- This light is not harmful to the human body, but if you look directly at the light source, it will damage your eyesight.
- This light is not harmful to the human body, but if you look directly at the light source, it will damage your eyesight.
- This product is suitable for 365+405nm UV/LED nail polish, some special colors of nail polish such as black, white, etc. The curing time should take two times (120s), please use according to the instructions.
- Not for use in the following groups: skin wound on fingers; heart disease; children; pregnant women; people with skin diseases.
- Please keep this product out of the reach of children.

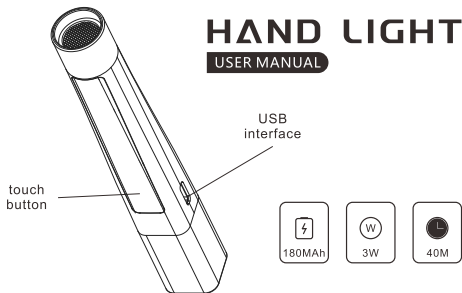

This product is a portable design LED nail lamp, which can quickly cure UV nail polish/extension glue/LED nail polish on the go or wherever you need it.

# HALMAI

## NOTE:

- LED Light Mode: Without curing function, can only provide the lighting requirement for manicure work.
- Avoid eye contact directly with the light, which may cause eye injury.

## 07 Charging

- 1 Connect the charging cord to the lamp.
- 2 Insert the charging cord with the 0.5 A adapter or other USB sockets.
- 3 Indicator will change from RED to GREEN when the device is fully charged.

## 08 Problems and Terms of Settlement

Malfunction	Reasons	Solutions
Device drops to the ground or by other impacts.	1. The "ON/OFF" button doesn't work. 2. Nail Lamp damages.	Avoid device drops or by other impacts.
Long time, large load work.	Burns out, or device lifespan shortens.	The continuous working time should not be too long when the working condition is in heavy load. When the device is overheating, it should be stopped immediately to make it return to normal temperature.

# HALMAI

Malfunction	Reasons	Solutions
The beads do not turn on.	The LED light beads are defective, or the lamp's internal circuits are damaged.	When the light beads are damaged, please contact MelodySusie customer service team for help.
The gel nail polish cannot be cured or dried.	Insufficient curing time may result in incomplete curing of your gel nail polish. The curing time requirements vary from different gel polish brands and colors.	<ol style="list-style-type: none"> <li>1. Please try to extend the curing time appropriately until the nail surface is completely cured.</li> <li>2. Please make sure the nail lamp is closer enough to your nails, and avoid moving your hand too much until curing is complete.</li> <li>3. Please adjust the nail light angle to make sure the light can reach your nails directly.</li> <li>4. When used in conjunction with MelodySusie Nail Lamp (Power higher than 48W).</li> </ol>
Overcharged.	Battery lifespan shortens.	Not exceed the specified charging time.
Insert into a mismatched power supply.	Burns out.	According to the device voltage requirements, insert the matching power supply.
Put the power cord at random, or use the device when charging.	<ol style="list-style-type: none"> <li>1. Battery damages and device lifespan shortens.</li> <li>2. Power cord breaks.</li> <li>3. Poor connection.</li> </ol>	Do not pull the power cord, or do not use the device when charging.
Water into the device, or operate in wet or moist conditions, or use a wet cloth to clean the device.	<ol style="list-style-type: none"> <li>1. Motor burns out.</li> <li>2. Device lifespan shortens.</li> </ol>	Do not operate in wet or moist conditions, only a dry cloth is allowed for cleaning.





## 09 Specifications

Model: Handle uv light lite	Wavelength: 395+405nm
Weight:45g	Size: 110.8x16.38mm
Battery Capacity:180MAh	Input Power: DC5V/0.5A
Power: 3W	Input Port: Tepy-c USB

## 10 Warranty and Customer Service

**HALMAI offers a 1years limited warranty on quality related issues.Please apply for your extra 1years warranty extension and download the instruction manual in other languages by registering on [www.halmaideals.com](http://www.halmaideals.com) if needed.**

Thank you for purchasing from HALMAI.  
You are welcome to share your experience after receiving the product.  
Please contact us for any technical support if needed.