



Questions or Concerns

 support@meowanthome.com

MANUFACTURER

Shenzhen Guiyang Network Technology Co., Ltd

ADDRESS

1404K3, East Block, Shengtang Commercial Building,
Futian District, Shenzhen, China



Made In China

MEOWANT

PET WATER FOUNTAIN

Model: MW-WF02

User Manual

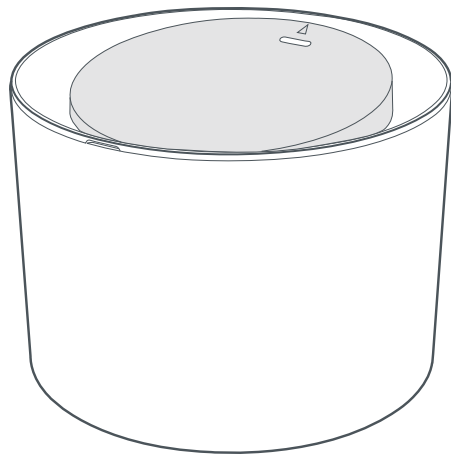

CONTENT

01

**IMPORTANT
SAFETY
INSTRUCTIONS**

01 - 02

02

**EXPLORING
WATER
FOUNTAIN**

03

03

**USING
WATER
FOUNTAIN**

04 - 06

04

**CARE
AND
CLEANING**

07 - 08

05

**TROUBLE-
SHOOTING
GUIDE**

09

06

**WARRANTY
AND
SERVICE**

10

IMPORTANT SAFETY INSTRUCTIONS



READ ALL INSTRUCTIONS BEFORE USE AND SAVE FOR FUTURE REFERENCE

When using an electrical appliance, especially when children are present, basic safety precautions should always be followed, including the following:

INTENDED USE

- This appliance is not intended for use by persons (including children) with reduced physical, sensory or mental capabilities, or lack of experience and knowledge, unless they have been given supervision or instruction concerning the use of the appliance by person responsible for their safety.
- DO NOT allow to be used as a toy. Close attention is necessary when used by or near children and pets. Children and pets should be supervised to ensure that they do not play with the appliance.
- DO NOT use the appliance with pets not able to reach the water tray or with any physical disability.
- For indoor use only. Use the appliance only for intended household purposes as described in this User Manual.

ELECTRICITY SAFETY

- DO NOT operate the appliance if it has a damaged power cord or plug, or if it is malfunctioning or has been damaged in any manner.
- DO NOT immerse the cord, plug, or the base in water or other liquid or allow moisture to come into contact with these parts.
- If the supply cord is damaged, it must be replaced by the manufacturer, its service agent or similarly qualified persons in order to avoid a hazard.
- Always unplug when not in use, before putting on or taking off parts and before cleaning, maintenance or servicing.
- Use ONLY the provided power adapter and charging cable.

RELATED TO USE

- DO NOT use the water fountain without water. Do not let the pump run dry.
- DO NOT install or store the water fountain where it will be exposed to weather or temperatures below 40°F/0°C.
- DO NOT place any foreign object in the water tank. Do not use with water that is micro-biologically unsafe or of unknown quality.
- DO NOT allow pets to chew on or swallow any parts. Cover or hide the power cord with care to prevent pets from biting.
- DO NOT lift the water fountain by lid or water tray. Hold the water tank with both hands, while keeping in upright position.
- DO NOT attempt to disassemble, repair, modify or replace any part of the appliance. No user serviceable parts inside. All servicing should be performed by qualified personnel only.
- Change the filter every 3 to 4 weeks or when the flow rate has noticeably reduced. For two or more cats, you may need to replace more frequently.
- Use only MeoWant recommended accessories and replacement parts.
- Dispose of all packaging materials properly. Keep away from children and pets.

FOR HOUSEHOLD USE ONLY

SAVE THESE INSTRUCTIONS

Specifications

Input	DC 5V --- 1A Type-C
Power Adapter	Input: 100-240V~ 50/60Hz Output: DC 5V --- 1A
Water Tank Capacity	74 oz / 2.2 L
Material	PP

EXPLORING WATER FOUNTAIN



Check if all accessories are included. Contact us via email: support@meowanhome.com if there is any missing part.

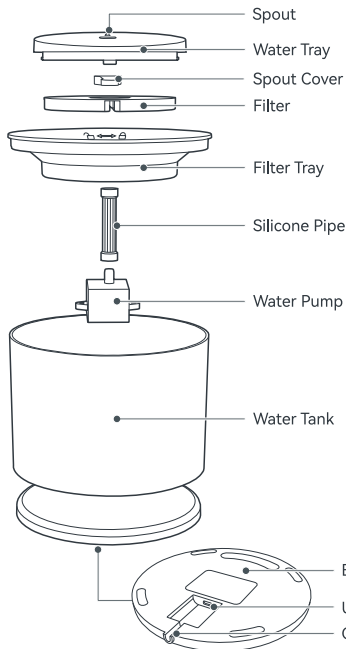

Other Accessories



Cleaning Brush



Type-C USB Cable



Power Adapter

USING WATER FOUNTAIN



- Remove all packaging materials and tapes before use.
- Clean and rinse the water fountain before first use. Refer to “Care and Cleaning” chapter for details.

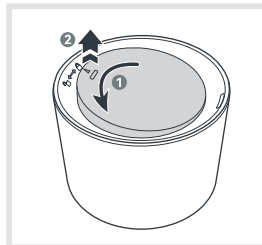

1 Taking Filter Out

Twist to to unlock the water tray and take the inside filter out.

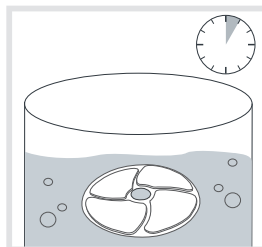

2 Activating Filter

Soak the filter in a clean bowl of water for about 5 minutes. Clean and rinse the water fountain.

* Do not soak the filter in the water tank of the water fountain in case of any surface dust.

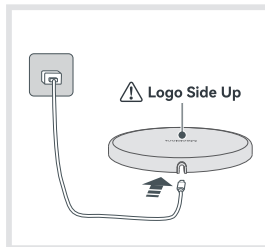

3 Connecting Base

Connect the base to an electrical outlet with the included USB-C cable and adapter. Run the cord through the cable slot.

* Make sure that the logo side faces upward.

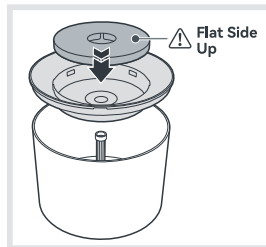

6 Installing Filter

Install the filter tray and filter in sequence. Make sure that the flat side of the filter faces upward.

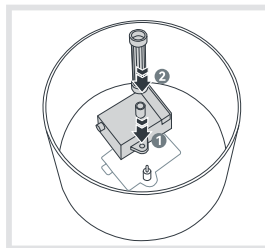

4 Installing Pump

Position the pump according to the bottom frame. Then install the silicone pipe on the pump.

* Make sure that the pump is properly fixed at the center.

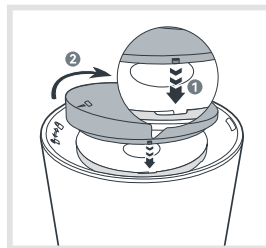

7 Installing Water Tray

Align and insert into the notch. Then twist to lock the water tray in place.

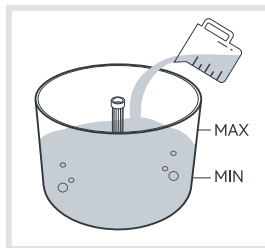

5 Adding Water

Fill the water tank with purified water. Keep the water between the MIN and MAX level.

* To extend the life of pump, add water before starting and never let the pump run dry.

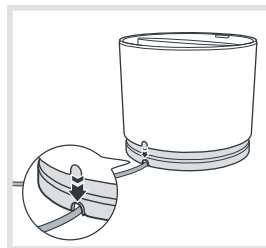

8 Situating Water Tank

Align and situate the assembled tank onto the base properly.

- Solid Green > Working Normally
- Solid Blue > Tank not detected / water below MIN level

CARE AND CLEANING

Daily Cleaning



- It is recommended to clean the water tray and tank each time you refill water.
- For the health of your pet, clean the filter at least once every week and replace every 3 to 4 weeks.
- The base is not washable, wipe clean with a dry cloth only.

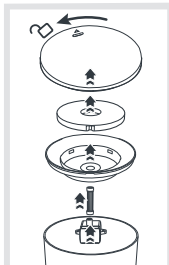

1

Detach the water tray, filter, filter tray, silicone pipe and water pump.

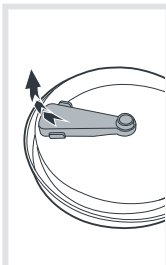

2

Hold to remove the spout cover under the water tray.



3

Rinse clean all parts. For grime build-up, clean with the included brush.

Water Pump



- To prevent scale or grime build-up or pump failure, we recommend cleaning the pump at least once every 2 weeks. Replace the inside foam filter every 3 to 4 weeks.
- Be careful not to drop the pump from a great height.

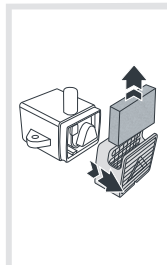

1

Remove the foam filter and pump cover.

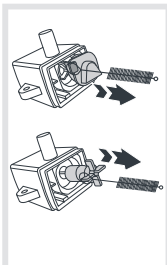

2

Remove the impeller cover and impeller using the brush hook.

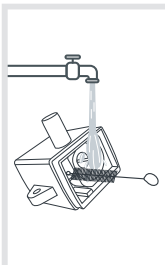

3

Clean all parts under tap water with the brush.

TROUBLESHOOTING GUIDE



The troubleshooting guide addresses the most common problems. If problems persist, feel free to contact the Customer Support via email: support@meowanthome.com

Q: The water fountain does not work or stops working suddenly.

- A:**
- Make sure that the water fountain is connected to a powered outlet with the included cable and adapter.
 - Make sure that the water pump is properly installed and fixed at the center.
 - Make sure that the logo side of the base faces upward and the cord runs through the cable slot.
 - Check if the water runs below the MIN level. Add water between the MIN and MAX level.

Q: Reduced flow rate.

- A:**
- Check and clean the filter. Wash the filter at least once every week and replace every 3 to 4 weeks.
 - Check if the water pump and spout cover (under water tray) is clogged with scale or grime. Clean the pump and spout with the included brush when necessary.

Q: How often should I change the filter?

- A:** It is recommended to replace the filter every 3 to 4 weeks. For replacement filter, contact our customer support or search B09M7ZZ1RP on Amazon.

Q: Does it have to be plugged in all the time or run on batteries?

- A:** The water fountain is not battery powered. It does have to be plugged in all the time

WARRANTY AND SERVICE



Thank you for choosing MeoWant Pet Water Fountain. This product is covered with MeoWant product and labor warranty for 12 months from the date of its original purchase.

The warranty will not apply in cases of:

- Accident, misuse, or repairs performed by unauthorized personnel.
- Any unit that has been tampered with or used for commercial purpose.
- Normal wear and tear of wearable parts.
- Use of force, damage caused by external influences.
- Damage caused by non-observance of the User Manual, e.g. connection to an unsuitable mains supply or non-compliance with the instructions.
- Partially or completely dismantled appliances.
- Defects caused by or resulting from damages from shipping or from repairs, service, or alteration to the product or any of its parts that have been performed by a repair person not authorized.

We can only provide after sales service for products that are sold by MeoWant or MeoWant authorized retailers and distributors. If you have purchased your unit from a different place, please contact your seller for return and warranty issues.

*** Please have your order ID ready before contacting Customer Support.**



FCC Compliance

This device complies with Part 15 of the FCC Rules. Operation is subject to the following two conditions:

- (1) this device may not cause harmful interference, and
- (2) this device must accept any interference received, including interference that may cause undesired operation.

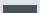

Correct Disposal of This Product (Waste Electrical & Electronic Equipment)

 (Applicable in countries with separate collection systems)

This marking on the product, accessories or literature indicates that the product and its electronic accessories should not be disposed of with other household waste at the end of their working life. To prevent possible harm to the environment or human health from uncontrolled waste disposal, please separate these items from other types of waste and recycle them responsibly to promote the sustainable reuse of material resources. Household users should contact either the retailer where they purchased this product, or their local government office, for details of where and how they can take these items for environmentally safe recycling. Business users should contact their supplier and check the terms and conditions of the purchase contract. This product and its electronic accessories should not be mixed with other commercial wastes for disposal.