

Technical specification

- Input voltage :3V(2x AAA)
- Transmitting frequency:433.925MHz
- Transmitting power: 10 Milliwatt
- Operatingtemperature:-5°C~50 °C
- Transmssion distance:
outside: 200 meters
inside(between two walls):35 meters

Function instruction

WR01-15CHis 15-channel emitter or WR01-05CH is 5-channel emitter. One number of screen means one control channel. Press "channel choose" button P1- (numberdescending) or P1+ (number increasing) to change the channel. On the analogy of this.loose finger when the screen shows the suitable channel that you select effective channel. If screen number show "o" that means all channels if effective (group controlstate).



Notice: Emitter couldn't be exposed to moisture and striked, so as not to affect life, When you use emitter, if found emission distance obviously short or less sensitive, please change another same new battery, Please have batteries for recycling. Caution: Risk of explosion if battery is replaced by an incorrect type. Dispose of used batteries according to the instructions.



Do not dispose of in general waste.
Please recycle batteries and damaged electrical products appropriately.

WR01-15CH WR01-05CH WR01-01CH
Emitter specification A-07 July 2024

Type specification

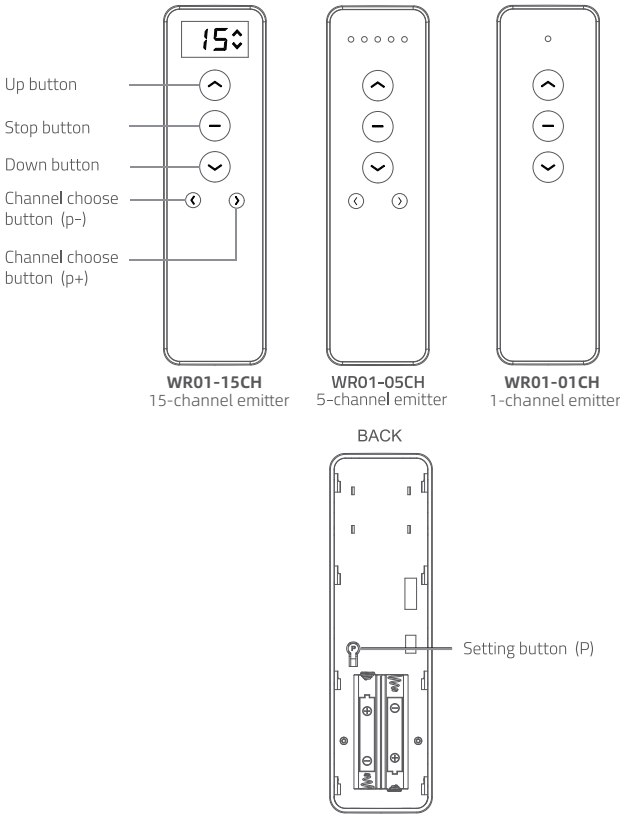

Type specification

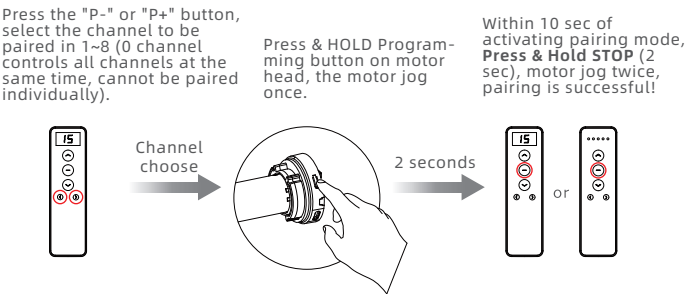

The valid channels selection

* Available for 15-channel remotes only. *

! In the setting state, press the up or down button you can quit quickly, if you want to change the valid channels, reset it.

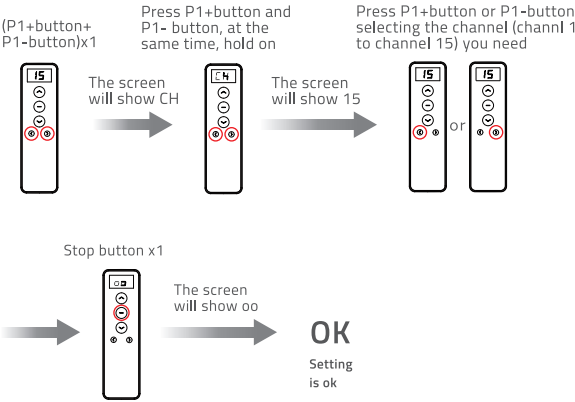

Combination button lock/unlock status

* Available for 15-channel remotes only. *

- ①Factory default is the combination button unlock status, repeated operation can be cycle switching.
- ②the combination button is locked, the combination button is invalid, and the combination button is pressed without sending code, and there is no icon display; in the unlock state, the combination button is pressed with an icon flashing indication.
- ③The button is locked and only affects the emitter code.

