

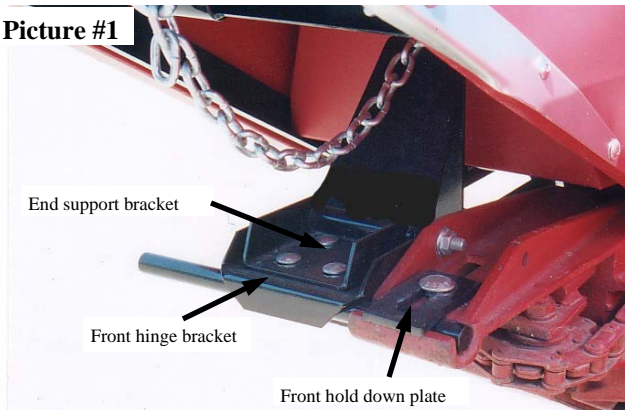

The Original Farmer Designed
59711 U.S. Hwy 12, Litchfield, MN 55355
1-888-485-8411

Assembly Instructions Case IH 800-900-1000 Series 30 Right End GVL I (CI 07713)

Picture #1



Picture #2

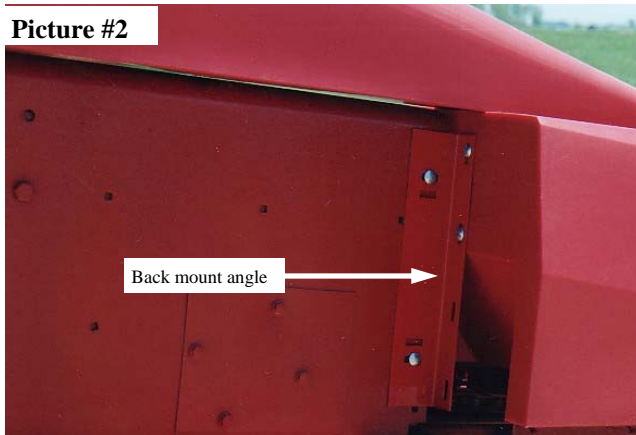

1. Remove the old metal Gatherer and back angle bracket. **(Leave the front hold-down plate on the head.)**
2. Install the front hinge bracket **(Item #9)** and end support bracket **(Item #8)** to the GVL frame. **(Use (4) 3/8" x 1" carriage bolts)** **(Leave loose)** **(Picture #1)**
3. Install the GVL Gatherer Shield **(3/4" shaft sits in the front casting.)** **(Picture #1)**
4. Install the front hold-down plate **(Item #10)** over the shaft and bolt it down with a 1/2" x 1 1/2" carriage bolt and nut **(Tighten nut)**. **(Picture #1)**
5. Install a 7/16" x 6 1/2" bolt through the end support bracket **(Item #8)** and hole in the side of front casting. Install nut and tighten. **(Picture #1)**
6. Position and align the GVL Gatherer Shield and tighten all the bolts.
7. Bolt the back mount angle bracket **(Item #7)** to the corn head. **(Leave loose)** **(Picture #2)**
8. Hold back angle bracket against the back of the Gatherer and drill 5/16" holes in the plastic.
9. Install 5/16" x 3/4" bolts and tighten.
10. Remove PVC pipe that is around the adjustment chain. **(For shipping and handling only!)**
11. **TIGHTEN ALL THE BOLTS AND NUTS.**

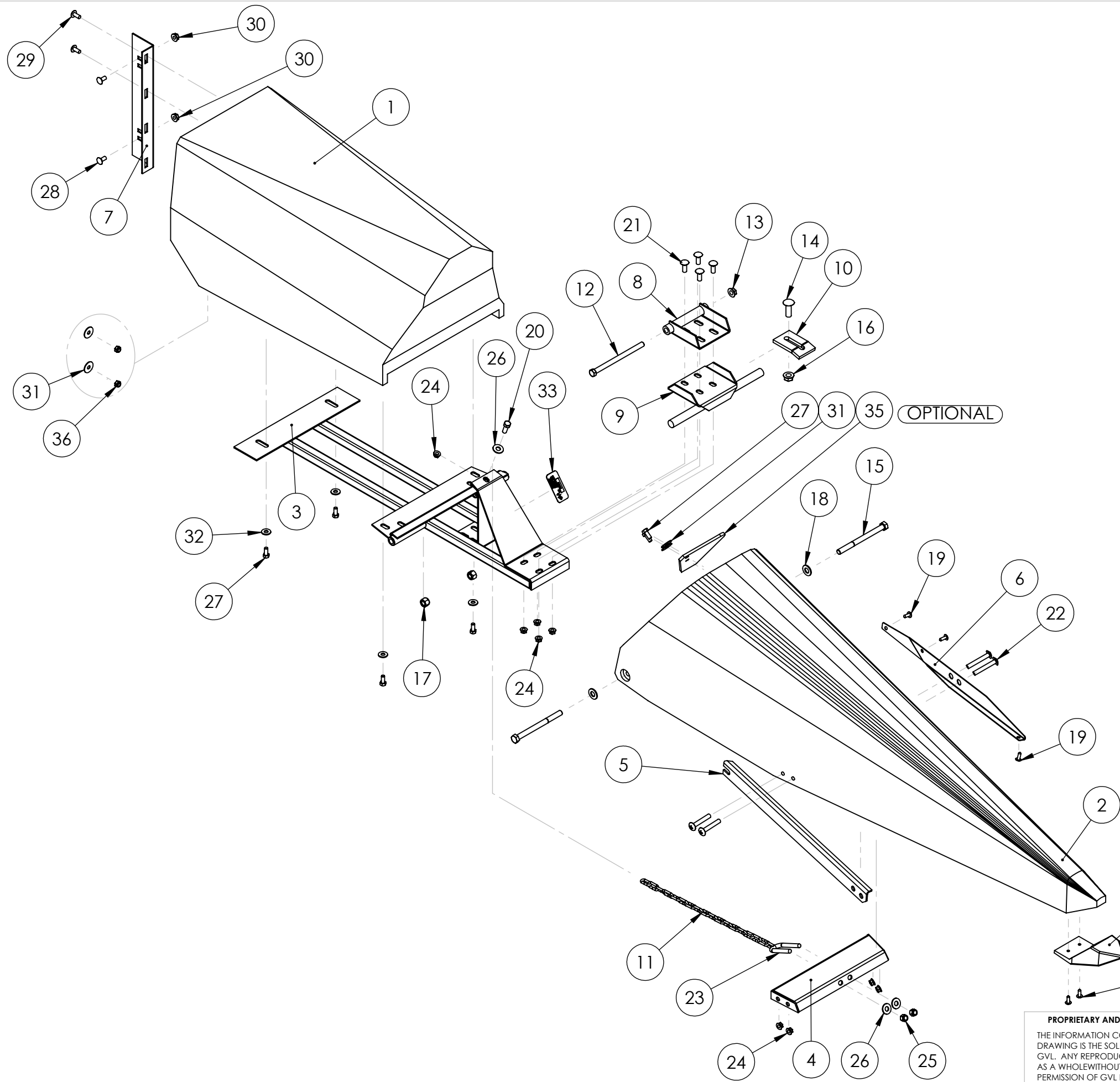

ITEM NO.	PART NUMBER	DESCRIPTION	QTY.
1	RD 07701	30's END RIGHT BACK SHORT	1
2	RD 17700	30's RIGHT END RED	1
3	UN 16702	UNI END MAIN FRAME-30	1
4	UN 17703	FRT ADJ GATH BRKT-30 RIGHT END	1
5	UN 00005	STIFFENER-RIGHT FRONT	1
6	UN 21003	SS W STRIP-LEFT EDGE 30'S END	1
7	CI 01405	BACK MOUNTING ANGLE	1
8	CI 06707	END SUPPORT BRACKET-30	1
9	CI 02212	22" FRT HINGING BRKT	1
10	CI 00005	CI FRONT HOLD DOWN PLATE	1
11	PCC-316	3/16" PROOF CHAIN 21 LINK	1
12	716-612 HB	7/16"x6 1/2" HX HD BOLT	1
13	716-FSN	7/16" FLANGE SERRATED NUT	1
14	12-112 CB	1/2"x1 1/2" CARR BOLT	1
15	12-150 MHB	12X150MM HX HD METRIC BOLT	2
16	12-FSN	1/2" FLANGE SERRATED NUT	1
17	12-MLN	12mm METRIC LOCK NUT	2
18	12-W SAE	1/2" SAE WASHER	2
19	14-34 TTS	1/4"x3/4" SELF TAP SCREW	5
20	38-1 HB	3/8"x1" HX HD BOLT	1
21	38-1 CB	3/8"x1" CARR BOLT-SHORT NECK	4
22	38-134 THB	3/8" X 1-3/4" PHILLIPS TRUSS HEAD BOLT	4
23	38-3 UB	3/8" X 3" U-BOLT	1
24	38-FSN	3/8" FLANGE SERRATED NUT	9
25	38-NLN	3/8" NYLON LOCK NUT	2
26	38-W USS	3/8" USS FLAT WASHER	3
27	516-34 HB	5/16"x3/4" HX HD BOLT	6
28	516-34 CB	5/16"x3/4" CARRAGE BOLT	2
29	516-34 THB	5/16"x3/4" SL RD TR HD BOLT	2
30	516-FSN	5/16" FLANGE SERRATED NUT	2
31	516-W F	5/16 FENDER WASHER	4
32	516-W USS	5/16" USS WASHER	4
33	SN-531	SERIAL NUMBER TAG	1
34	WP-96	WHITE WEAR POINT	1
35	ESB-GVL	GVL EAR SAVER	1
36	516-NLN	5/16" NYLON LOCK NUT	2

PROPRIETARY AND CONFIDENTIAL
 THE INFORMATION CONTAINED IN THIS DRAWING IS THE SOLE PROPERTY OF GVL. ANY REPRODUCTION IN PART OR AS A WHOLE WITHOUT THE WRITTEN PERMISSION OF GVL IS PROHIBITED.

	NAME	DATE
DRAWN	ALS	4/23/08
REVISED	MLB	11-13-12
ENG APPR.		
MFG APPR.		
Q.A.		
COMMENTS:		

GVL POLY

TITLE:
CI 30's RIGHT END GVL I

SIZE B	DWG. NO. CI 07713	REV A
------------------	-----------------------------	-----------------

SCALE: 1:10 WEIGHT: SHEET 1 OF 1