

John Deere 600F & 600P Poly Retractable Finger Instruction Sheet

1. Remove bolt or retaining pin securing finger to bearing inside auger, remove finger.
2. Inspect the bearing for wear or damage. Repair or replace if needed.
3. Remove existing finger guide, remove any burrs from the opening in the auger skin.
4. Install finger guide on the outside of the auger skin. Secure using supplied hardware.
5. Align poly finger with mounting hole. Install bolt or retaining pin to secure finger.

****Important Note****

When finger is fully retracted, it should extend 1/2" above poly guide surface.
Also check clearance between extended finger and auger floor before operating.

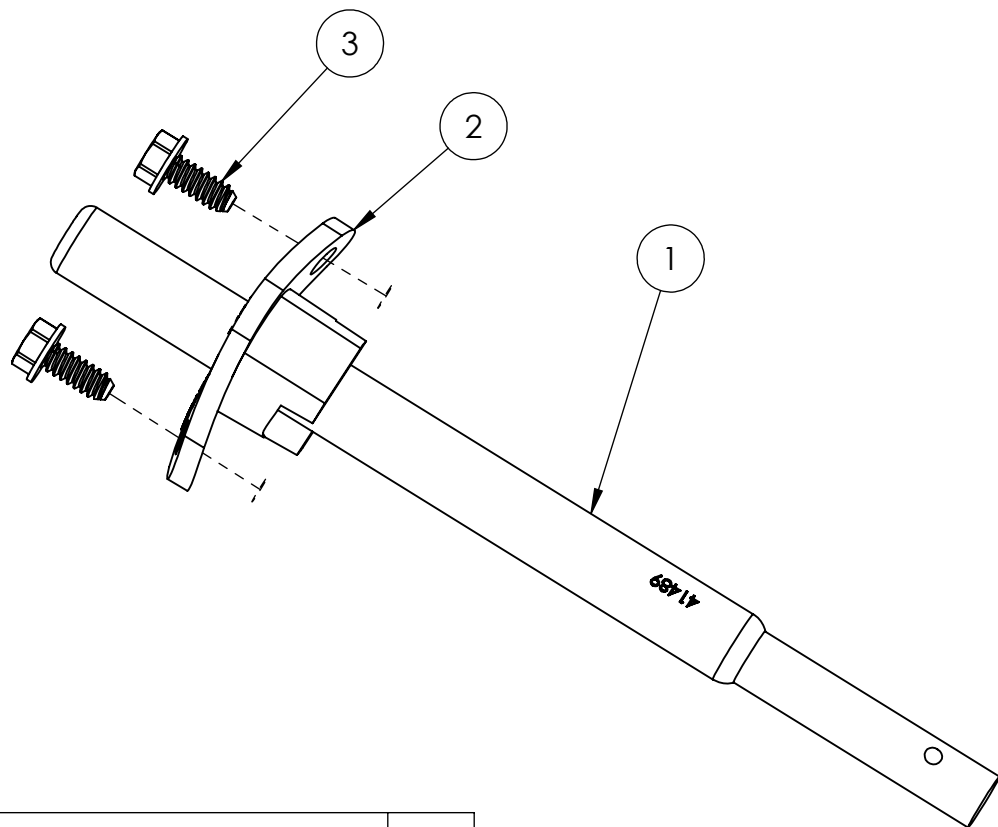

ITEM#	PART#	DESCRIPTION	QTY
1	41489	POLY FINGER	1
2	21018	POLY FINGER GUIDE	1
3	00909	BOLT, 5/16"-18 X 3/4 SELF THREAD HEX	2



120 Eastgate Drive SE
PO Box 7
Hutchinson, MN 55350

1-800-788-6483
1-320-587-2322
1-320-587-6112 (Fax)

WWW.MAYWES.COM