

NOZZLE SCHEDULE							
ITEM	SIZE	RATING	TYPE	MATL.	PROJ IN	PROJ OUT	REMARKS
A	4"	N.P.T	W.F.	C.S	STD.	STD.	EMERGENCY VENT OPENING
B	2"	N.P.T	W.F.	C.S	STD.	STD.	

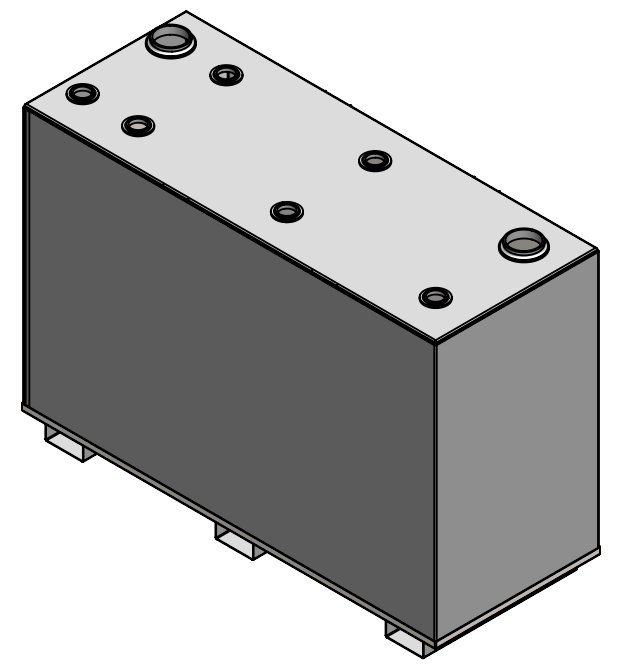
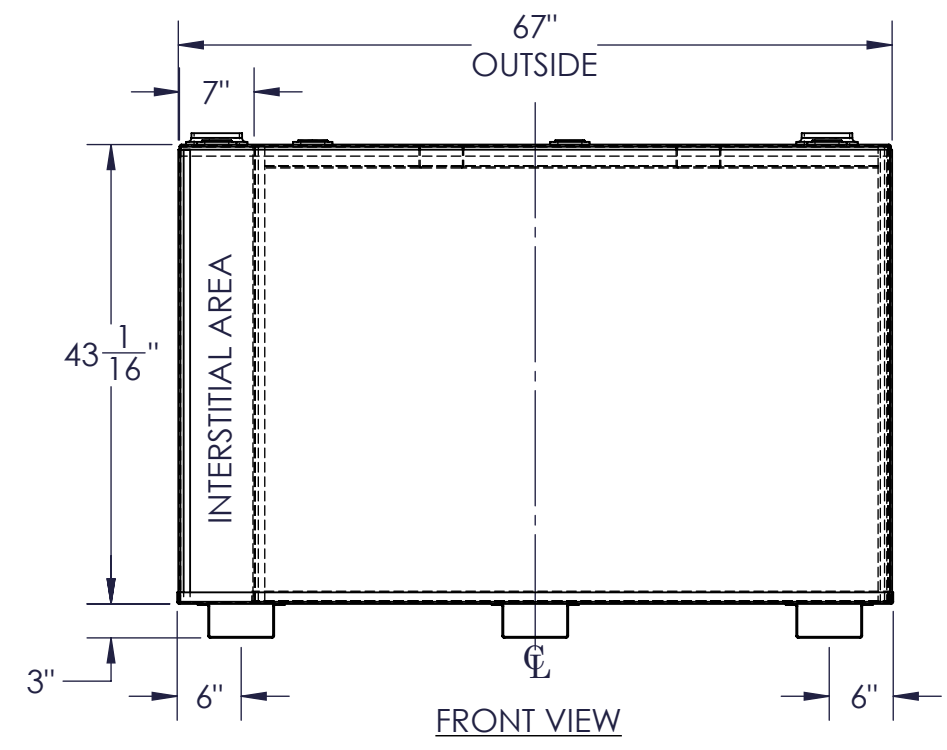
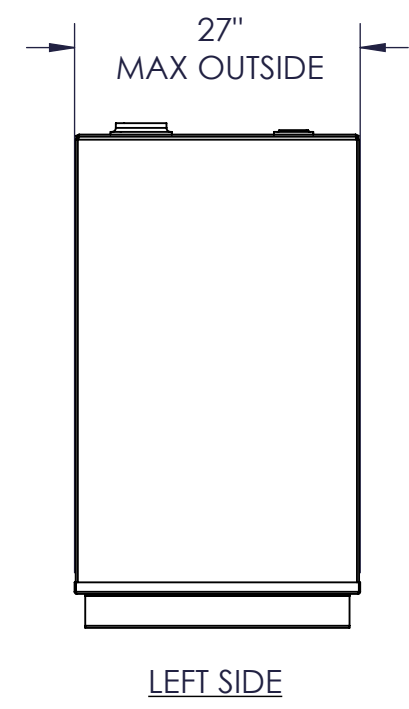

- NOTES:
- A. QUANTITY:
 - B. MATERIAL: 12 GA. H.R. CARBON STEEL
 - C. DESIGN & OPERATING PRESSURE: ATMOSPHERIC.
 - D. DESIGN & OPERATING TEMPERATURE: AMBIENT.
 - E. TANK TO BE BUILT & LABELED PER U.L. SPEC. #142.
 - F. TANK TO BEAR MANUFACTURERS & U.L. LABELS ONLY.
 - G. TANK TO BE AIR TESTED WITH WATER & SOAP SUDS SOLUTION.
 - H. INTERIOR: REMOVE WELD SLAG (SHIP CLEAN & DRY).
 - I. EXTERIOR: GRAY PRIMER INCLUDED; SEE SALES ORDER FOR TOP COAT.
 - J. ALL FITINGS TO BE PROTECTED FOR SHIPMENT.
 - K. CUSTOMER HAS THE RESPONSIBILITY TO VERIFY ALL DIMENSIONS.

APPROVAL FOR CONSTRUCTION
SCHEDULE A - MASTER TERMS &
CONDITION OF SALE*

APPROVED AS DRAWN.

APPROVED WITH NOTED CHANGES,
CONSTRUCTION WILL BE SCHEDULED
WHEN SIGNED DRAWING AND
CONFIRMED ORDER ARE RECEIVED.

SIGNATURE: _____

DATE: _____

*All pages of this Schedule A are incorporated by
reference and are a part of the additional terms of
the Master Terms & Conditions of Sale.
www.newberrytanks.com/masterterms.pdf

SALES ORDER: -		WEIGHT (LBS): 680	
		All units inches unless stated otherwise	
		Phone: 870-735-4473 Fax: 870-735-3982	
DESCRIPTION: 280 GALLON RECTANGULAR UL 142 DOUBLE WALL TANK			
CUSTOMER:		P.O.#	
DATE: 6/11/2020	SCALE:	DWG.# FTDBS-0280	DRAWN BY: AJC
			SHEET 1 OF 1