

Congratulations on choosing the Canopy Breeze® canopy fan, the next level of tailgating comfort! To ensure maximum enjoyment and years of trouble-free service from this product, please read these instructions thoroughly and store them in a safe place. Please visit www.mekooutdoors.com for further information and instructional videos.

One-Year Limited Warranty

Meko Outdoors, Inc warrants this product to be free from defects in material or workmanship for a period of one (1) year following the date of purchase, provided the product is used in a non-commercial manner. This limited warranty does not cover failures as a result of abuse, droppage, or using this product in a manner contrary to its intent. Damage caused by collapsed/toppled canopies as a result of wind or other acts of nature are excluded from this warranty. For warranty inquiries or claims, please do not return the unit to your retailer. To file a warranty claim, please visit www.mekooutdoors.com/warranty and complete the online form, or email us at service@mekooutdoors.com.

What's Included

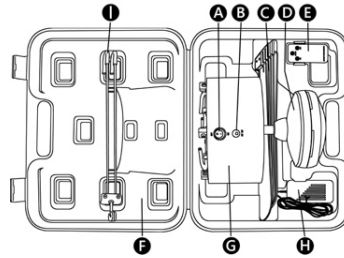

- A** Master power switch
- B** Charging port
- C** 5 fan blades
- D** Motor Assembly
- E** Fan remote control
- F** Case
- G** Battery Housing
- H** Battery charger
- I** Downrod Extension accessory

Compatible Frames *Canopy Breeze fits on perpendicular roof and "Push-up" style frames*

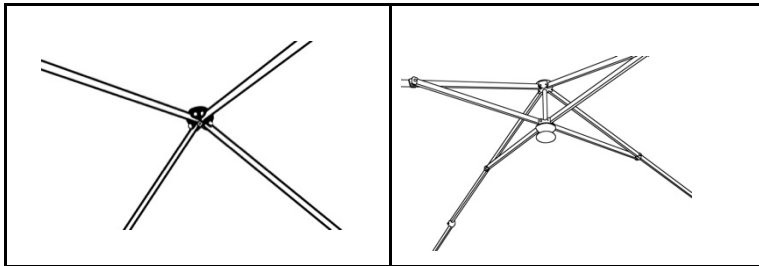

Standard or vented 10' and 12' canopies with perpendicular roof joists, available in most sporting, hardware and discount stores.

Push-up frames, (also known as "One Push," or "Quick Lift") where a single user can raise the canopy roof by pushing up a knob in the center of the frame.

NON-Compatible Frames *Canopy Breeze will not fit on these type frames*

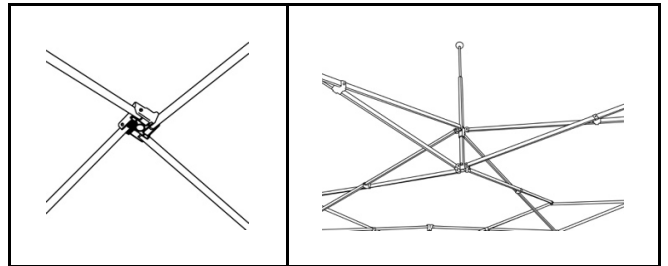

Offset roof joist members are **not compatible**.

Canopies with a center pole, or cross-truss frame whereby the roof fabric is raised via a center pole held by truss supports at the top of the legs are **not compatible**.

Before First Use

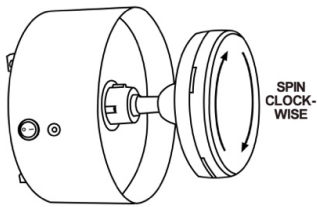

1. Ensure fan motor (the lower part of the motor assembly that the fan blades snap into) is free from obstruction by gently rotating it clockwise while holding the fan. You will feel slight resistance approximately every 3/4", and the motor will make a quiet clicking sound when spinning continuously. Should you rotate the motor *counter-clockwise* and release, a spring clutch inside the fan will turn the motor clockwise back to its original position. Never spin the fan motor counter-clockwise more than 1/4 turn. If the motor does not spin clockwise with minimal effort, do not attempt to use the fan. Contact us at service@mekooutdoors.com for guidance.
2. Charge the battery approximately 6 hours (or until the LED on the charger changes from RED to GREEN) before using.

Installation

⚠ IMPORTANT:

CANOPY BREEZE IS NOT INTENDED FOR PERMANENT OUTDOOR INSTALLATION. PLEASE STORE CANOPY BREEZE IN CASE AFTER EACH USE. PERMANENT CONNECTION OF THE CHARGER TO AN OUTLET WILL VOID WARRANTY.

⚠ WARNING: Do not install or operate the fan if rain, windy or inclement conditions are expected.

⚠ WARNING: Be sure to secure the canopy with stakes, weights or rope when operating the fan.

💡 VENTED CANOPIES will pull more air than enclosed canopies, creating a more comfortable environment.

💡 If sustained winds are expected to be 10 mph or higher, the breeze from the fan will be largely ineffective.

		<p>For STANDARD Canopies</p>	<p>For PUSH-UP style canopies</p>
<p>① Unfold canopy; only raise it halfway up.</p>	<p>② Raise the four hooks on top of the fan.</p>	<p>③ Center the hooks between the four roof joists of the canopy frame apex with the hooks over the top of the frame. Rotate the fan 1/4 turn counterclockwise, then lower each hook onto a roof joist.</p>	<p>④ Depending on the size of the push-up knob on the canopy, it may be necessary to angle the fan slightly so the hooks on the fan can clear the knob.</p>
<p>For PUSH-UP style canopies</p>			
<p>⑤ Once all four hooks are resting on the canopy frame, the fan will sit level, and the fan blades can be inserted.</p>	<p>⑥ Insert each of the five fan blades into the slots on the fan motor assembly and push firmly.</p>	<p>⑦ The inner curve, or concave side of fan blade must face downward (toward the ground) when installed.</p>	<p>⑧ You will hear a "click" once the fan blade snaps into place.</p>

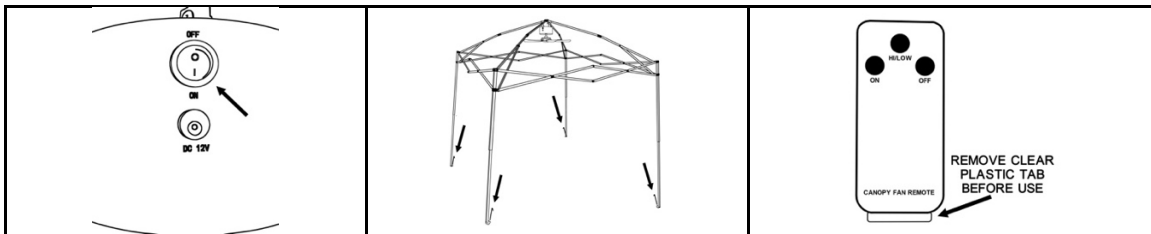

⑨ Once all the fan blades are in place, turn the Master Power Switch to the "ON" position **BEFORE** raising the canopy. It will be hard to reach otherwise.

⑩ Stake the canopy legs securely, place the fabric top on the canopy, and raise it to full height.

⑪ Remove the clear plastic tab from the back of the remote and discard before use. You can now operate the fan using the remote control. The fan blades will spin in a **clockwise** direction.

Uninstalling Canopy Breeze®

1. Turn the fan off using the remote.
2. Lower the canopy back to the half-height position.
3. Flip the Master Power Switch to the "OFF" position.
4. Remove the fan blades. While holding the motor assembly, grasp the front of the blade firmly. Slightly wiggle the blade from side to side while pulling until the blade slides out. If the blades still won't release, remove the fan from the canopy frame and place it upside down on a firm surface, such as a table, to remove the blades. Note that the blades will become easier to remove over time.
5. Lift the fan unit up over the canopy frame and rotate clockwise $\frac{3}{4}$ turn to remove.
6. Lower the hooks and snap them back into their cradles on the top of the battery housing.
7. Place all components back into the case and locks clasps securely.

⚠ Please be sure Master Power Switch is in the "OFF" position when storing the fan. If not, the remote could inadvertently start the motor and cause damage to the fan and or case.

Center Hoop for Hook Mounting

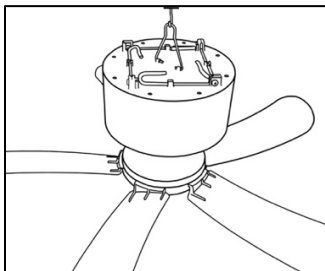

Your fan comes with a hoop on the top for installation on a hook. This will allow for use in other applications in addition to canopies. Please use extreme care when hook mounting.

1. We recommend a hook that is #12 size or bigger, and must support at least 10 lbs.
2. If hanging from a ceiling or gazebo, please be sure the hook is attached directly into the wooden frame or stud under drywall. Do not use hooks that are mounted only in drywall, even if using a drywall anchor.
3. **NOTE: HOOK MUST BE COMPLETELY THREADED INTO WOOD FRAME AS TORQUE FROM THE FAN COULD UNSCREW IT, CAUSING IT TO FALL.**
4. Allow a minimum of 7.5' of clearance between the fan blades and ground, or 6" higher than the tallest occupant.
5. Once the fan is placed on the hook, secure it with a zip or wire tie for extra safety.

Down Rod Extension

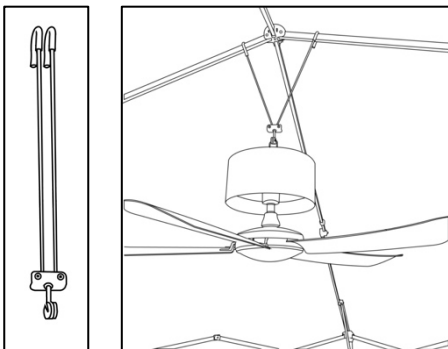

Due to the height and roof pitch of certain canopy frames, air flow created by Canopy Breeze may need to be closer to the occupants. The included down rod extension allows the fan to hang an additional 10" lower than using the four hooks on top of the fan. This puts the breeze from the fan blades closer to the occupants, and also allows the fan to circulate air that is slightly cooler than the air next to the fabric canopy roof.

1. To install, simply open the extension into a "V" shape, and hang it over two of the four canopy frame roof joists that are aligned with each other. **DO NOT** hang it on roof joists that are perpendicular to each other.
2. Hang the fan on the bottom hook of the extension via the center hoop mounted on top of the fan.
3. Allow a minimum of 7.5' of clearance between the fan blades and ground, or 6" higher than the tallest occupant. Should the fan blades be lower than this, remove the extension and hang the fan using the four hooks as outlined in Steps 1-5.
4. Be sure all fan blades are completely inserted so the fan will be balanced, and be sure to test the fan for wobble by turning on the motor before occupants are underneath.
5. If the fan wobbles, this usually indicates one or more fan blades are not inserted completely.

Charging and Battery Care

⚠ WARNING: Only recharge this product with the supplied charger.

1. Plug the charger into a standard 120 Volt 60 Hz electrical outlet. While charging, the LED in the charger will illuminate red. When charging is complete, it will illuminate green. If the charger is blinking red, this indicates a faulty battery. Please contact us for further guidance.
2. Typical recharge time after use is 5 hours from 10% battery charge.
3. **NOTE:** The fan will run indefinitely while the charger is connected to power. **ALWAYS** disconnect power when the fan is not in use and the battery is fully charged. Permanent connection to AC power will shorten the life of the fan's circuitry and void the warranty.
4. **Battery disposal.** This product uses a Lithium-ion rechargeable and recyclable battery. When the battery will no longer hold a charge, it should be removed from the fan and recycled. It should not be incinerated or composted. Contact your local recycling center for information on where to dispose of it properly. In the event the battery in your fan needs replacing, please contact us at service@mekooutdoors.com for instructions and pricing.
5. **Battery Tips.** The powerful lithium-ion battery included with your fan is by far its most expensive component. Maximize the life of your battery with these handy tips:
 - a. Try to avoid "deep discharge" by not letting the battery drain completely.
 - b. It's best to store the fan in an environment of 80°F or cooler. Try not to leave the fan in a hot car for an extended period of time.
 - c. Once the charger illuminates green, unplug it. The battery will discharge approximately 5% over the next several days, and you can "top it off" the day before its next use.
 - d. When storing the fan for long periods of time, only charge the battery to 30-50%. Try to avoid storing the battery at 100% charge for an extended period as this will shorten battery life.
 - e. When using the fan regularly, it is OK to run it for a short period of time, then recharge the battery back to full. Lithium-ion batteries do not have "battery memory," so partial discharge/recharge will not harm them.

Troubleshooting

If after installation the fan will not operate, try one of the following:

1. With the power off, can you rotate the fan motor (the lower portion of the fan body that holds the fan blades) clockwise with a soft clicking sound? When spinning the motor, you will feel a stop approximately every $\frac{3}{4}$ " inch, and this is considered normal. If the motor will not spin, do not use the fan. Contact us at service@mekooutdoors.com for further guidance.
2. Was the fan fully charged before first use, with the LED on the charger illuminating green? **NOTE:** If the LED on the charger is blinking red when plugged into the fan, this indicates a faulty battery. Please contact us at service@mekooutdoors.com for further guidance.
3. Was the Master Power switch on the fan body moved to the ON position before raising the canopy to full height?
4. Was the clear plastic battery safety tab removed from the back of the remote?
5. Does the LED on the front of the remote light up red when any buttons on the remote are pushed? **NOTE:** The LED on the remote should illuminate brightly. Should the LED look dim or pinkish in color, this could indicate a low battery or defective remote.

If all the above steps have been taken, and the fan still will not operate, please contact us at service@mekooutdoors.com for further assistance.

For questions and further information, please visit our website, www.mekooutdoors.com or email us at service@mekooutdoors.com.