

multimec® 3F/4F WA/1WD/1WP

Technical Data

- through-hole or SMD
- 50mA/24VDC
- single pole/momentary
- 10.000.000 operations life time
- IP67 sealing
- temperature range:
low temp: -40/+115°C
high temp: -40/+160°C



Keycaps in frosted white shown on this page can also be used on **illumec™ switch 4F**

Dimensions (through-hole) 3F 1WA

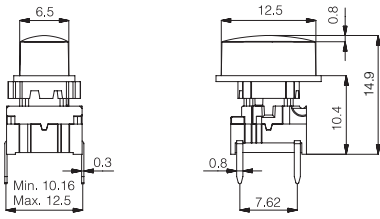

PCB layout

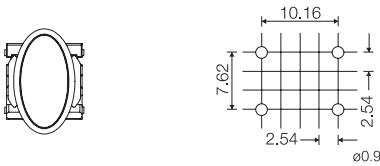

Dimensions (w/LED) 3F 1WD

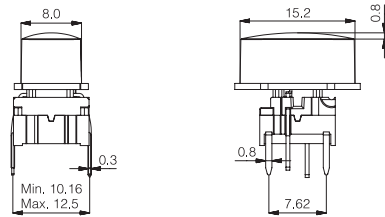

PCB layout (top view)

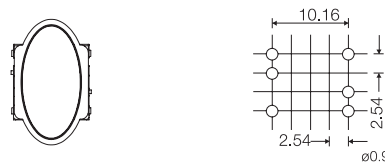

Dimensions (SMD) 3F 1WP

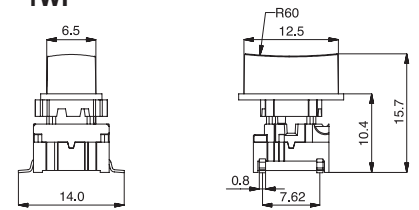

PCB layout

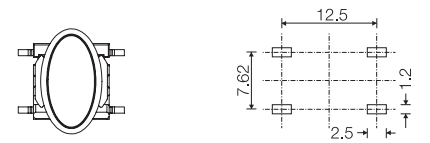

8 different position options

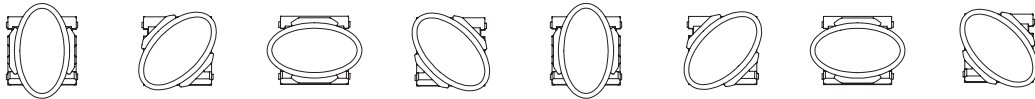

How to order

3 F	<input type="checkbox"/>	<input type="checkbox"/>	+	<input type="checkbox"/>	<input type="checkbox"/>
Switch	Mounting	L 6 low temp. H 9 high temp.		Cap	00 blue 03 grey 08 red 09 black 30 ultra blue 40 pigeon blue 42 aqua blue 53 metal light grey 57 metal dark grey
	T through-hole S surface mount			1WA 1WD 1WP	

3 F	T	<input type="checkbox"/>	<input type="checkbox"/>	+	<input type="checkbox"/>	<input type="checkbox"/>
Switch	Mounting	L 6 low temp. H 9 high temp.	LED		Cap	16 frosted white
	T through-hole		24 green 45 yellow 89 red		1WA 1WD 1WP	

Ordering example: 3FTL6 + 1WA09 or 3FTL689 + 1WP16

For updates of products and/or changes of specifications please see www.mec.dk