



TOYO LED ELECTRONICS LIMITED

Unit 10-11, 19/F, Metro Loft, 38 KwaiHei Street, Kwai Chung, N.T., Hong Kong
Tel : (852) 2540 7288 Fax : (852) 2517 1797
Http://www.toyo-led.com E-mail : sales@toyo-led.com



P/N: TY-ZDSF7623WHC1-3000

SPECIFICATION FOR CUSTOMER APPROVAL

P/N: TY-ZDSF7623WHC1-3000

DATE : May 17, 2019

PREPARED BY : Steven

CONFIRMED BY :

PLEASE CONFIRM & SIGN BACK THIS SHEET TO US

CUSTOMER: _____ **APPROVAL BY:** _____
(COMPANY CHOP) (SIGNATURE)



TOYO LED ELECTRONICS LIMITED

Unit 10-11, 19/F, Metro Loft, 38 KwaiHei Street, Kwai Chung, N.T., Hong Kong
 Tel : (852) 2540 7288 Fax : (852) 2517 1797
 Http://www.toyo-led.com E-mail : sales@toyo-led.com



P/N: TY-ZDSF7623WHC1-3000

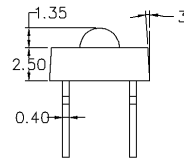
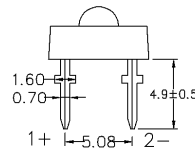
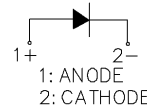
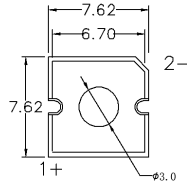

Selection Guide

Part No.	Dice		Lens Color	Iv(mcd)(If=20mA)			Viewing Angle (2θ½)
	Raw Material	Emitted Color		MIN	TYP	MAX	
TY-ZDSF7623WHC1-3000	InGaN	White	Water Clear	2800	---	4900	120°

Absolute Maximum Ratings(Ta=25C°)

Item	Symbol	Maximum	Unit
Power Dissipation	P _D	102	mW
Peak Forward Current (1/10 Duty Cycle 0.1ms Pulse Width)	I _{FP}	100	mA
Continuous Forward Current	I _{Fmax}	30	mA
Reverse Voltage	V _R	5	V
Operating Temperature Range	T _{opr}	-20°C to +75°C	
Storage Temperature Range	T _{stg}	-30°C to +80°C	
Lead Solder Temperature	T _{sol}	260°C for 5 seconds (3mm from the base of epoxy)	

Electrical / Optical Characteristics(Ta=25C°)

Item	Symbol	Min.	Typ.	Max.	Unit	Condition
Forward Voltage	V _F	2.8	---	3.4	V	I _F =20mA
Color Temperature	TC	5600	---	7000	K	I _F =20mA
Reverse Current	I _R	---	---	10	uA	V _R =5V

NOTES:

- All dimensions are in millimeter;
- Tolerance is ±0.25mm unless other specified; Luminous intensity tolerance is ±10%;
- Dominant Emission Wavelength tolerance is ±1nm; Specifications are subject to change without notice.



P/N: TY-ZDSF7623WHC1-3000

Typical Electro-Optical Characteristic Curve:

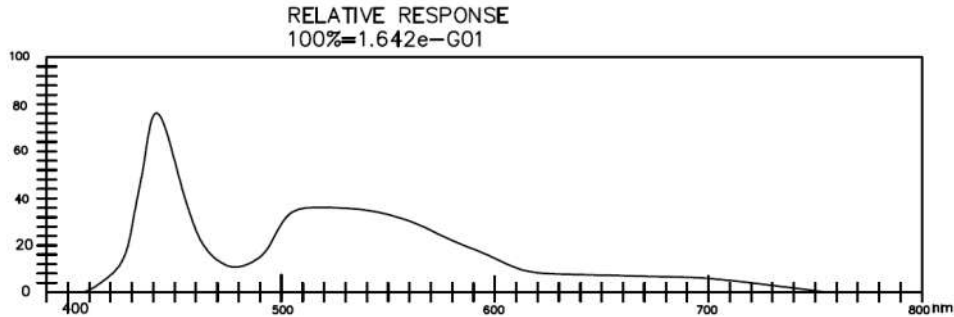

Forward Current vs. Ambient Temperature

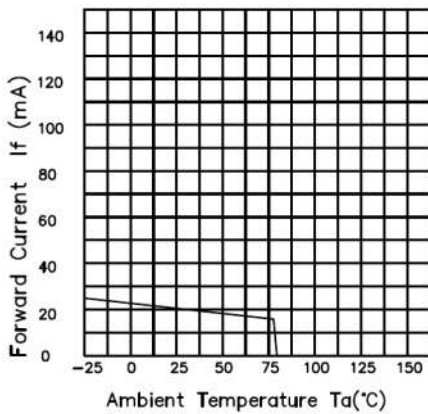

Relative Intensity vs. Ambient Temperature

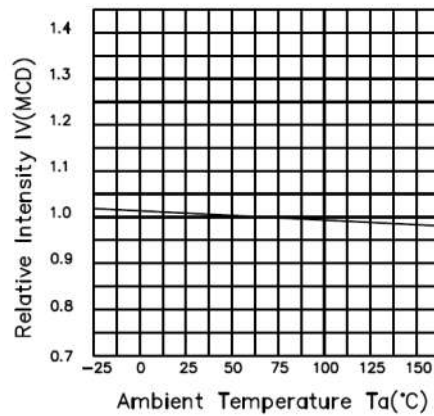

Forward Current vs. Ambient Temperature

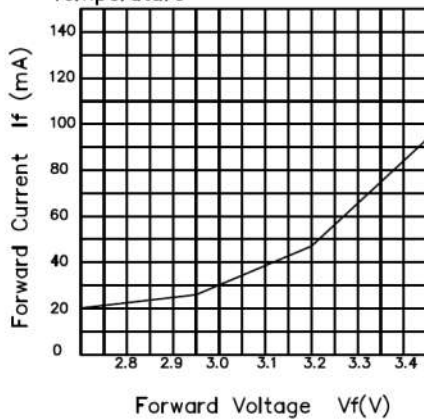

Forward Current vs. Ambient Temperature

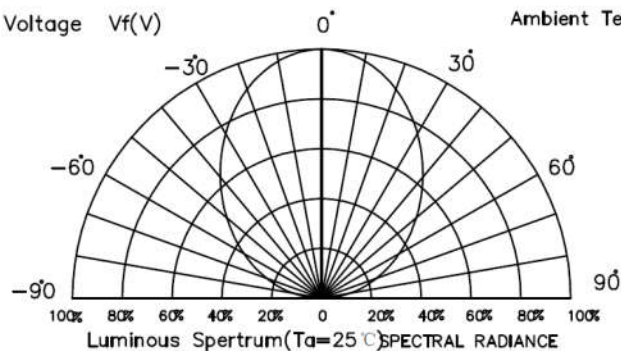
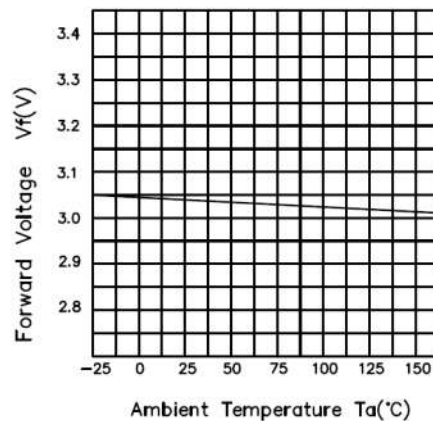



TOYO LED ELECTRONICS LIMITED

Unit 10-11, 19/F, Metro Loft, 38 KwaiHei Street, Kwai Chung, N.T., Hong Kong
 Tel : (852) 2540 7288 Fax : (852) 2517 1797
 Http://www.toyo-led.com E-mail : sales@toyo-led.com



P/N: TY-ZDSF7623WHC1-3000

Bin Range

1. IV Ranks (If=20mA)

Bin Code	Bin22	Bin23
IV (mcd)	2800-3700	3700-4900

2. VF Ranks (If=20mA)

Bin Code	Bin1	Bin2	Bin3
VF (V)	2.8-3.0	3.0-3.2	3.2-3.4

4. X/Y Ranks (If=20mA)

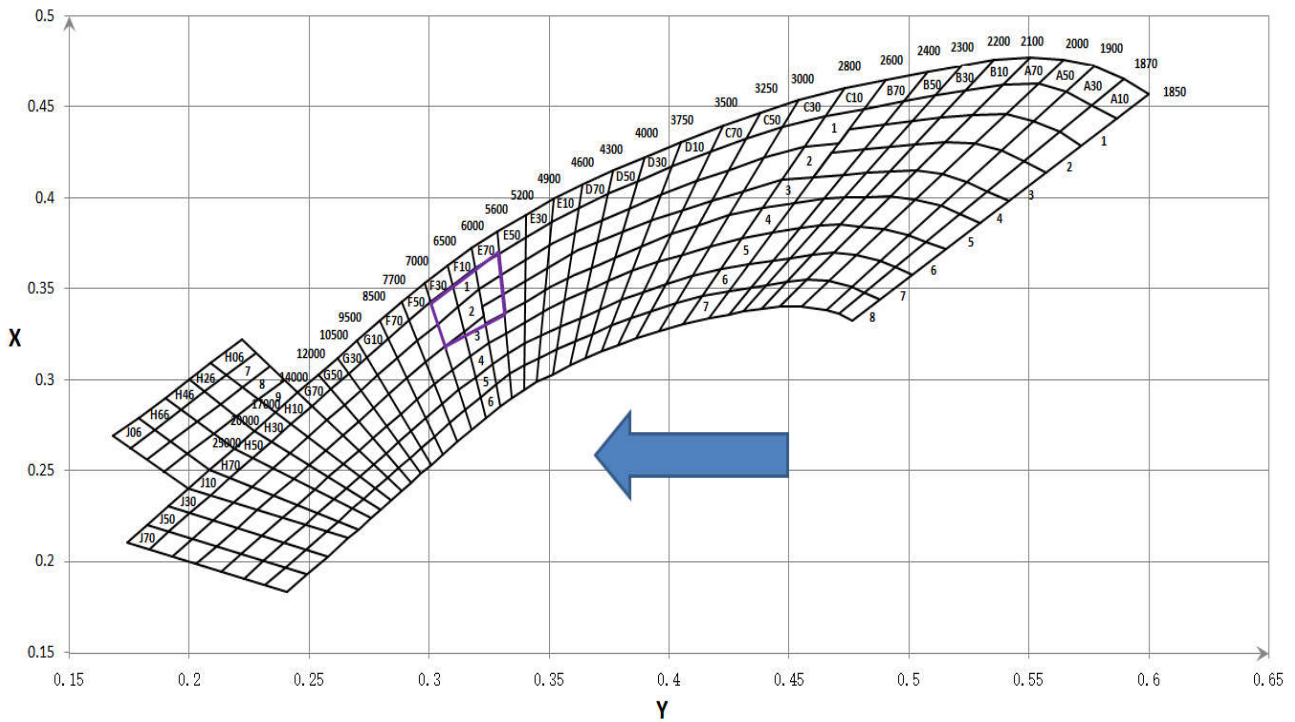

Bin code	CIE-x	CIE-y	CIE-x	CIE-y	CIE-x	CIE-y	CIE-x	CIE-y	CIE-x	CIE-y
E71	0.3193	0.3613	0.3292	0.3692	0.3300	0.3574	0.3210	0.3496	0.3193	0.3613
E72	0.3210	0.3496	0.3300	0.3574	0.3307	0.3465	0.3223	0.3400	0.3210	0.3496
E73	0.3223	0.3400	0.3307	0.3465	0.3314	0.3364	0.3236	0.3308	0.3223	0.3400
F11	0.3099	0.3520	0.3193	0.3613	0.3210	0.3496	0.3122	0.3401	0.3099	0.3520
F12	0.3122	0.3401	0.3210	0.3496	0.3230	0.3351	0.3148	0.3268	0.3122	0.3401
F31	0.3007	0.3425	0.3099	0.3520	0.3122	0.3401	0.3036	0.3307	0.3007	0.3425
F32	0.3036	0.3307	0.3122	0.3401	0.3148	0.3268	0.3065	0.3183	0.3036	0.3307



P/N: TY-ZDSF7623WHC1-3000

◇ Reliability Test Items And Conditions

NO.	Item	Test Condition	Test Hr/cycle/time	Sample Qty	Ac/Re
1	Reflow	TEMP:255±5°C;	3-10 sec	22pcs	0/1
2	High Temperature/HumidityStorage	TEMP: 85°C/ R.H.:85%	1000hrs	22pcs	0/1
3	Low Temperature Storage	TEMP:-40°C	1000hrs	22pcs	0/1
4	DC Operating Life	If=150mA	1000hrs	22pcs	0/1
5	Temperature Cycle	100°C ± 5°C 30 min. ↑ ↓ 5 min -40°C ± 5°C 30 min.	100 Cycles	22pcs	0/1

◇ SMT Reflow Soldering Instructions

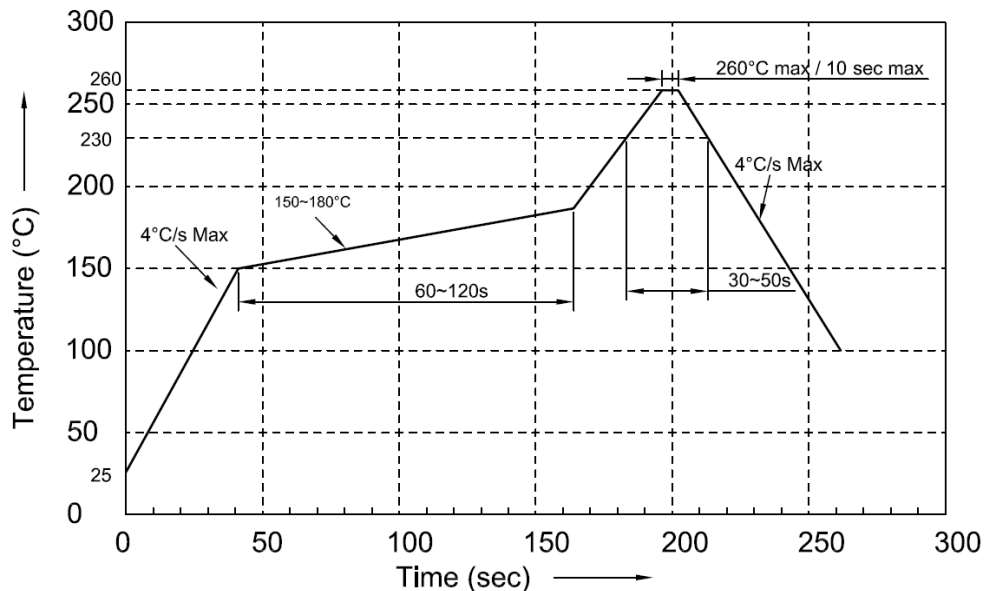

Notes:

1. We recommend the reflow temperature 245±5°C. The maximum soldering temperature should be limited to 260°C for 10s (max).
2. Don't cause stress to the epoxy resin while it is exposed to high temperature.
3. Number of reflow process shall be 2 times or less.



TOYO LED ELECTRONICS LIMITED

Unit 10-11, 19/F, Metro Loft, 38 KwaiHei Street, Kwai Chung, N.T., Hong Kong
Tel : (852) 2540 7288 Fax : (852) 2517 1797
Http://www.toyo-led.com E-mail : sales@toyo-led.com



P/N: TY-ZDSF7623WHC1-3000

BULK & PACKING DIMENSIONS

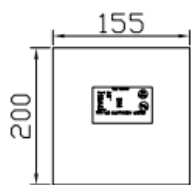

ESD POLYBAG

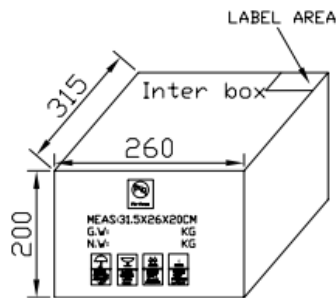

12.5Kpcs/Box
Weight: 4.0kg

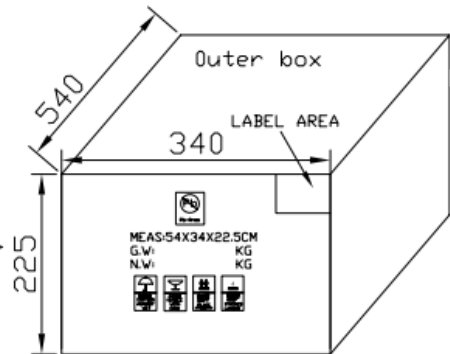

25Kpcs/Carton
Weight : 10.0kg



TOYO LED ELECTRONICS LIMITED

Unit 10-11, 19/F, Metro Loft, 38 KwaiHei Street, Kwai Chung, N.T., Hong Kong
Tel : (852) 2540 7288 Fax : (852) 2517 1797
Http://www.toyo-led.com E-mail : sales@toyo-led.com



P/N: TY-ZDSF7623WHC1-3000

REVISION HISTORY

DATE	REVISION CONTENTS	VERSION
2019-05-17	New	A