



TOYO LED ELECTRONICS LIMITED

Room 1610, Hong Kong Plaza, 188 Connaught Road West, Hong Kong.

Tel : (852) 2540 7288
http://www.toyo-led.com

Fax : (852) 2517 1797
E-mail : sales@toyo-led.com



P/N: TY-HP1BL-S

High Power LEDs Series

SPECIFICATION FOR CUSTOMER APPROVAL

P/N: TY-HP1BL-S

DATE : October 23, 2016

PREPARED BY : Chen you hui

CONFIRMED BY :

PLEASE CONFIRM & SIGN BACK THIS SHEET TO US

CUSTOMER: _____

(COMPANY CHOP)

APPROVAL BY: _____

(SIGNATURE)



TOYO LED ELECTRONICS LIMITED

Room 1610, Hong Kong Plaza, 188 Connaught Road West, Hong Kong.

Tel : (852) 2540 7288
http://www.toyo-led.com

Fax : (852) 2517 1797
E-mail : sales@toyo-led.com



P/N: TY-HP1BL-S

High Power LEDs Series

◆ Features:

- 1 W High Power LED
- Emitted color: Ultra Bright Blue
- Silica package
- Long operating life

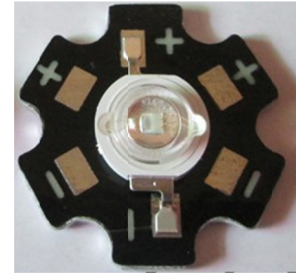

◆ Application

- General lighting
- Architectural Lighting
- Decoration lighting
- Advertisement

◆ Package Dimensions

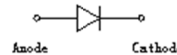
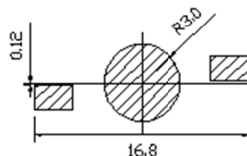
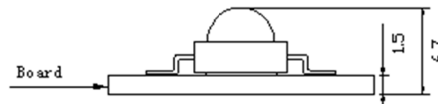
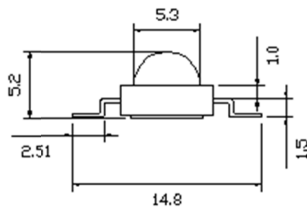
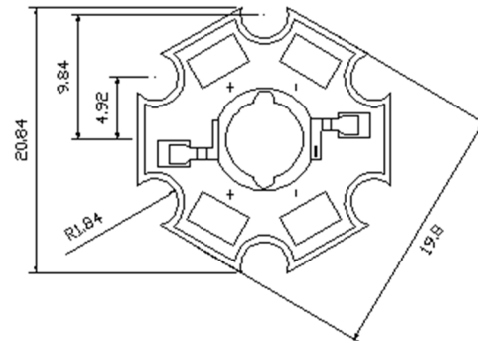
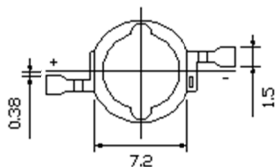

NOTES:

1. All dimensions are in millimeter[unit];
2. Tolerance is ± 0.2 mm especially other specified;
3. Specifications are subject to change without notice.



TOYO LED ELECTRONICS LIMITED

Room 1610, Hong Kong Plaza, 188 Connaught Road West, Hong Kong.

Tel : (852) 2540 7288
http://www.toyo-led.com

Fax : (852) 2517 1797
E-mail : sales@toyo-led.com



P/N: TY-HP1BL-S

High Power LEDs Series

Part No.	Emitted Color	Lens Color
TY-HP1BL-S	Blue	Water Clear

✧ Absolute Maximum Ratings(Ta=25°C)

Item	Symbol	Maximum	Unit
Power Dissipation	PD	1	W
Forward Current	I _{Fmax}	350	mA
Peak Forward Current(1/10 Duty Cycle 0.1ms Pulse Width)	I _{FP}	700	mA
Reverse Voltage	V _R	5	V
Operating Temperature Range	T _{opr}	-30 to+110	°C
Storage Temperature Range	T _{stg}	-40 to+120	°C
Lead Solder Temperature	T _{sol}	260°C	

✧ Electrical/Optical Characteristics(Ta=25°C)

Item	Symbol	Condition	Min.	Typ.	Max.	Unit
Forward Voltage	V _F	I _F =350mA	3.0	--	3.6	V
Luminous Flux	Φ	I _F =350mA	20	--	30	lm
Dominant Wavelength	λ _d	I _F =350mA	460	--	470	nm
Viewing Angle	2θ 1/2	I _F =350mA	---	140	---	Deg