

**RE800 (3 POLE) DC MOTOR**

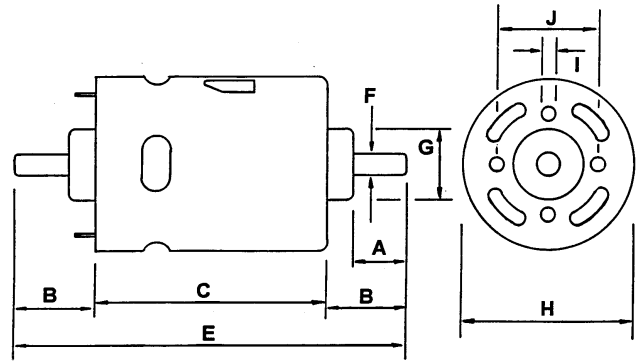

Part No: 457RE800 (MOTOR WITH BRACKET)  
 Part No: 719RE800 (MOTOR WITHOUT BRACKET)  
 Part No: 1114/2 MOTOR BRACKET (90° ONLY)



Weight: 595g (approx)

DIMENSIONS	A	B	C	E	F	G	H	I	J
Millimeter	13.2	20.5	69.0	110.0	6.35	21.75	51.8	M5	32.0
Decimal Inches	0.520	0.810	2.720	4.330	0.250	0.860	2.040		1.260

**MOTOR DATA. (RE800)**

MODEL	VOLTAGE		NO LOAD		AT MAXIMUM EFFICIENCY						STALL TORQUE	
	OPERATING RANGE	NOMINAL	SPEED	CURRENT	SPEED	CURRENT	TORQUE		OUTPUT	EFF	TORQUE	
			R.P.M.	A	R.P.M.	A	oz-in	g-cm	W	%	oz-in	g-cm
RE800	6 - 12	12v Constant	5000	1.1	4340	4.6	12.07	869	38.73	70.2	87.0	6264

Stall Current: RE800 at 12v = 25.86A