

NOTE

IT'S RECCOMENDED THE USE OF THE SERPRESS NUTS OR NUTS DIN 6926 OR DIN 982/985 WITH WASHER DIN 125

UNCONTROLLED COPY
in case of drawing updating/revision
NO AUTOMATIC
resubmission will follow

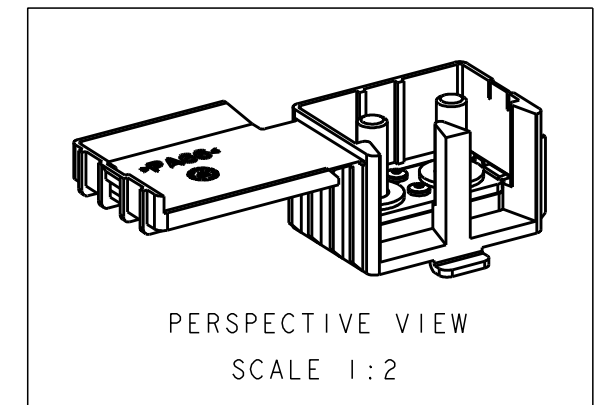
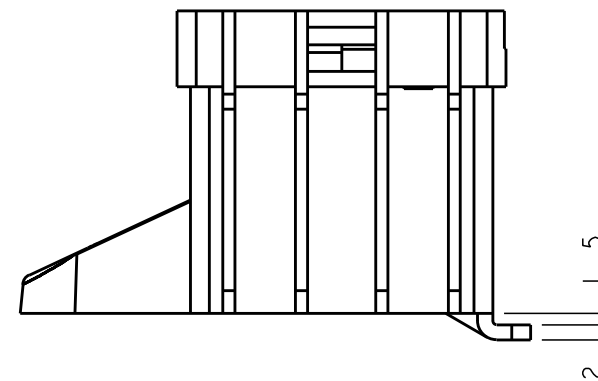
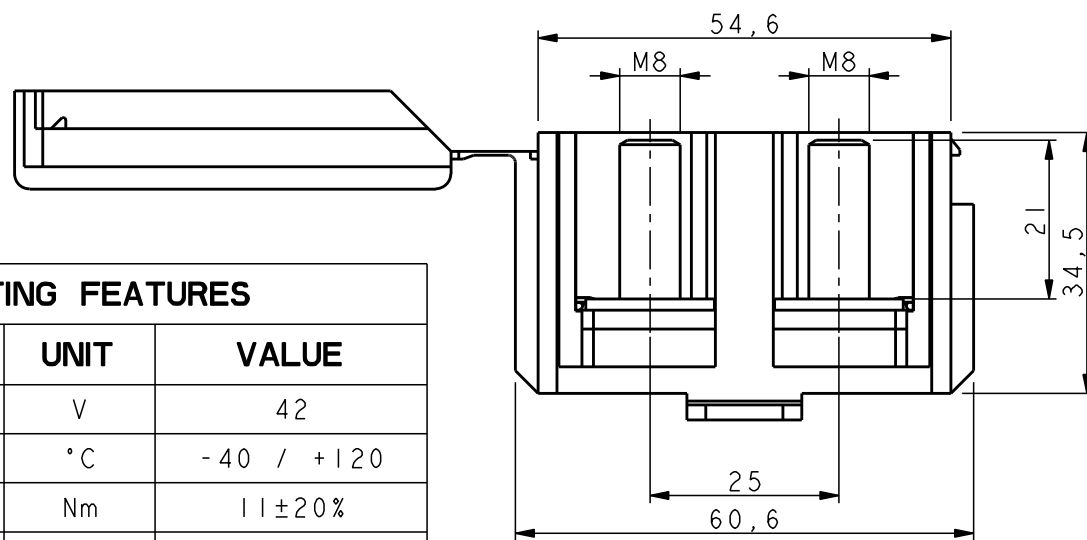
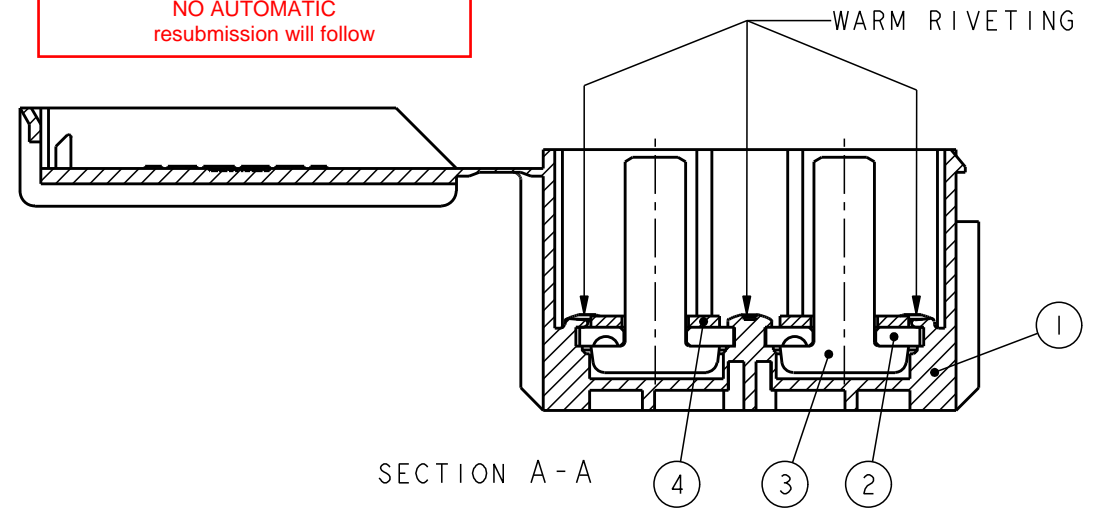
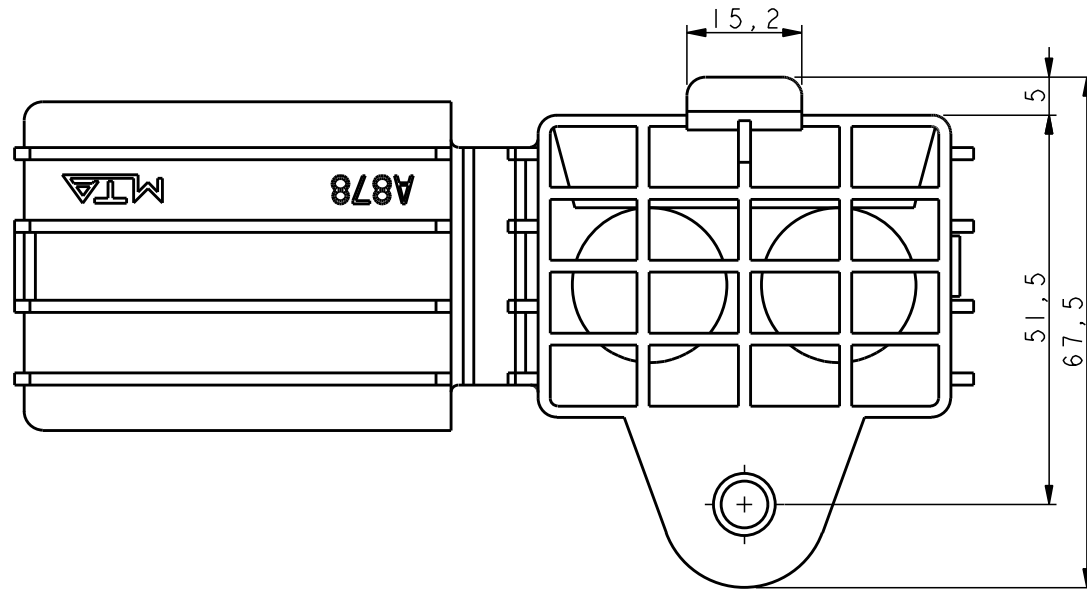

OPERATING FEATURES

FEATURE	UNIT	VALUE
Vmax	V	42
Tmin - Tmax	°C	-40 / +120
Screw torque	Nm	11±20%
IP	IEC 529	10
Flamability	FMVSS302 UL 94	slow combust. veloc. HB
I max at 70°C	A	155
I max at 90°C	A	120

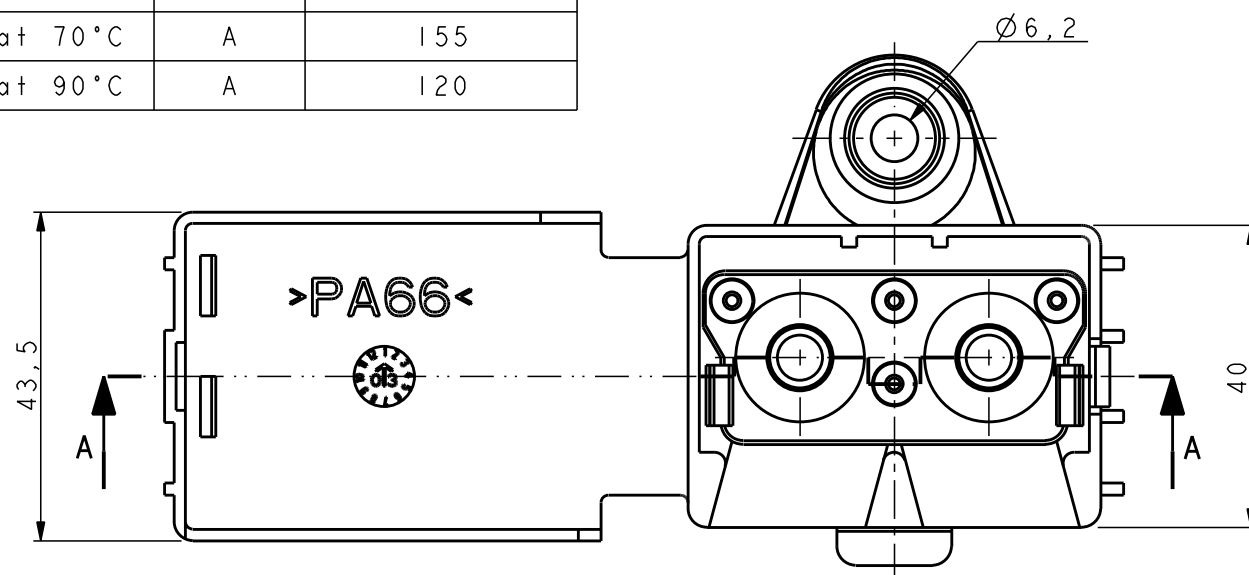

POS.	Q.TY	DENOMINATION	MATERIAL
4	2	SPACER	Steel 140 HV - Zinc plated
3	2	SCREW M8	Steel R50 CV4 - Zinc plated
2	1	CONTACT PLATE	Steel PI2 - Zinc plated
1	1	HOUSING	PA 66 HB - Color BLACK

MTA		MTA P/N	4541100/20			Denom. BRANCH KNOT 2M8				
		Draw No.	B0-045.009A			Used for -				
Rel. Level	Approved		Draw for	CLIENT		Family	CONNECTORS	JOINT		
	Date	Name	Scale	Weight(g)	Lin.Tol.±	Ang.Tol.±	Material	SEE TABLE	Thick.	Width
Draft.	11.09.92	G.CINQUETTI	1:1	78.8	0.5	1°	Coating	SEE TABLE	-	-
Chk	29.09.10	M.CORBANI	A3		Dimensions in (mm)	Sheet	Color	SEE TABLE		
PQApp	29.09.10	R.GONZALEZ					1/1			
App.	29.09.10	M.CORBANI								

9	OPERATING FEATURES UPDATED					
No.	Reason for Revision	Date	29/09/10	Name	R.DALMA	O+

All proprietary rights reserved by MECCANOTECNICA CODOGNÈSE S.p.A. - this drawing shall not be reproduced, or in any way utilized, for the manufacture of the component or unit herein illustrated and must not be released to other parties, without written consent. Any infringement will be legally pursued.