

Specifications

Rating:	1A 30VDC
Contact Resistance:	30mΩ Max
Insulation Resistance:	50MΩ Min 500V DC
Withstand Voltage:	500VAC 1 minute
Housing Material:	PBT
Contact Material:	Nickel Plated Copper
Operating Temperature:	-30°C to +70°C

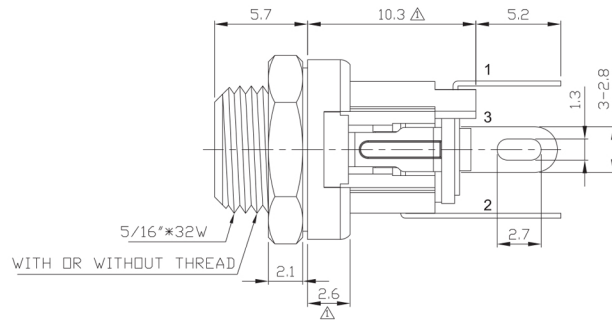
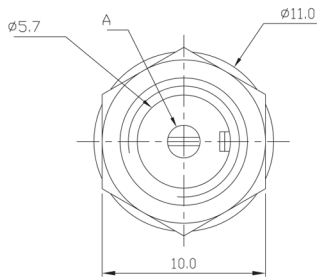
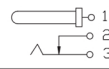

MODEL NO.	DC-025B
SCHEMATIC	
CENTER PIN	Ø 2.0mm Ø 2.5mm

9	WASHER	1	BRASS	NICKEL	
8	NUT	1	BRASS	NICKEL	
7	HOUSING	1	PA66		BLACK
6	INSULATOR	2	PAPER SHEET		RED
5	PIN	1	COPPER	NICKEL	
4	BUSHING	1	BRASS	NICKEL	
3	PIN TERMINAL	1	BRASS	SILVER	
2	BREAK TERMINAL	1	BRASS	SILVER	
1	SLEEVE SPRING	1	P.B.S	SILVER	
NO	PART NAME	Q'TY	MATERIAL	PLATED	REMARK

Description	Ref Code
2.5mm x 5.5mm Metal Panel Mount DC Power Socket	210007