

MADE IN ITALY

RAINPLUS 110

INSTALLATION PÅ BETONGTAK
INSTALLATION IN CONCRETE ROOF DECK

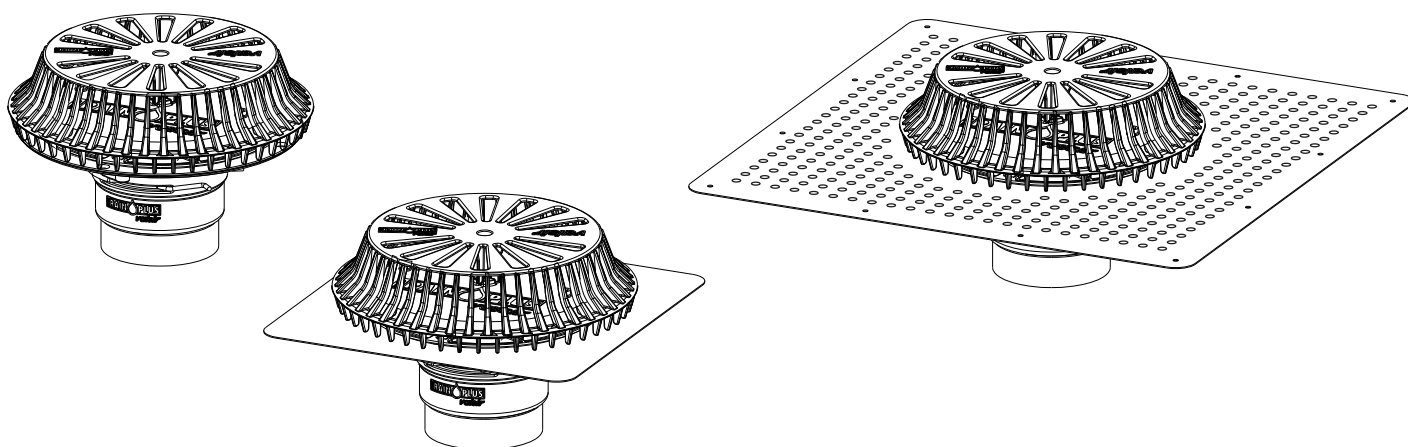

COD. VS0420001

COD. VS0420001 +
COD. VS0420151

COD. VS0420001 +
COD. VS0420158

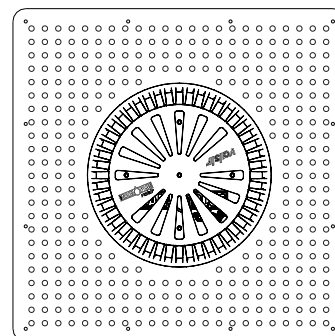
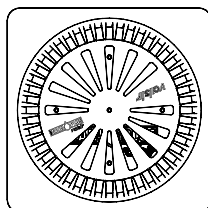
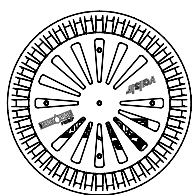
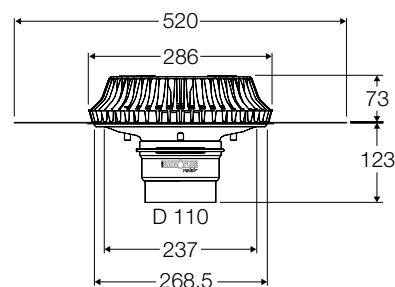
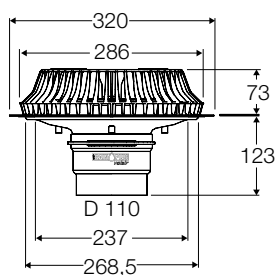
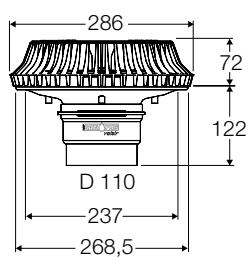

MONTERING ASSEMBLY

1

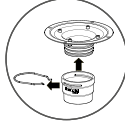
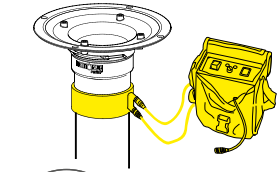

Vid behov kan anslutningsmuffen avlägsnas.
The socket can be removed if necessary.

2

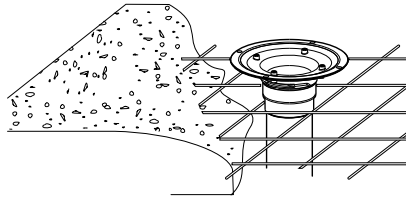

3

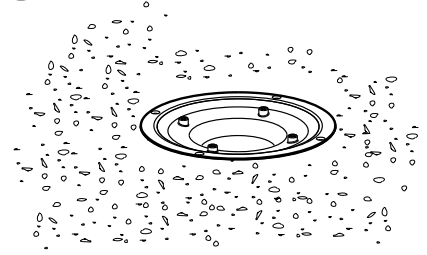

4

Minsta tjocklek 2 mm.
Minimum thickness 2 mm.

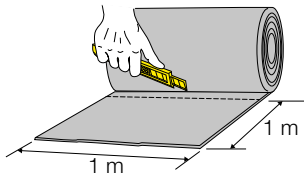

5

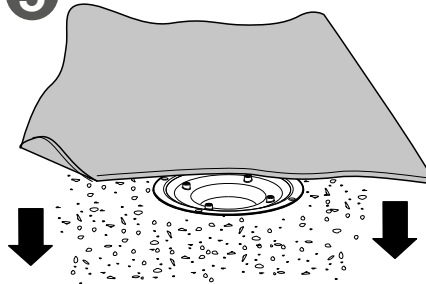

6

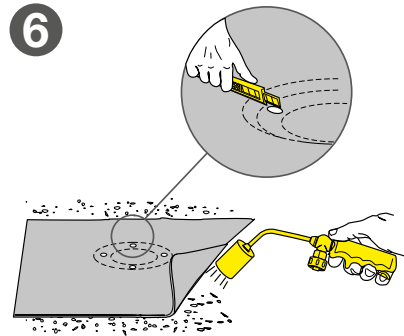

7

Skruva åt flänsen för att fästa det fortfarande varma tätskiktet mot brunnskroppen.
Fix the flange to the body of the outlet while the membrane is still warm.

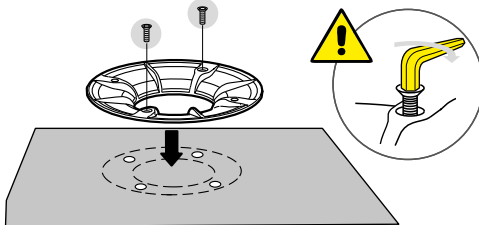

8

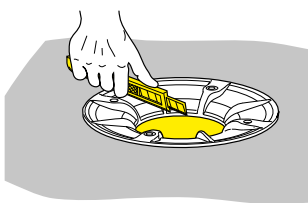

9

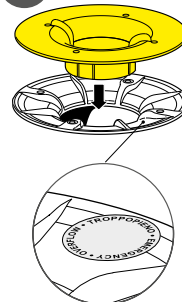

Använd skyddslocket ända tills monteringen är klar. Det kan användas för tillfällig avvattnings genom att avlägsna klisterlappen som täcker hålen. Om brunnen används som bräddavlopp märks den ut med bifogat klistermärke.

Use the protection cap until the installation is complete, it can be used for temporary drainage by removing the sticker that covers the drainage holes. If the outlet is to be used as an overflow it can be identified using the sticker provided.

10

För att installera tätskiktet, följ monteringsanvisningarna från tillverkaren av tätskiktet.
To install the membranes follow the installation rules of the membrane's manufacturer.

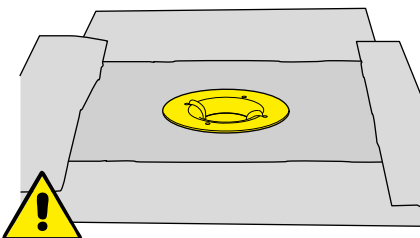

11

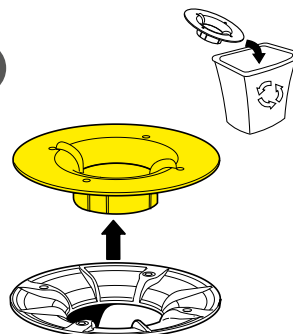

12

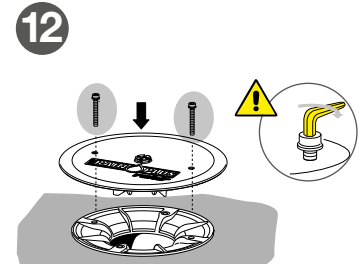

13

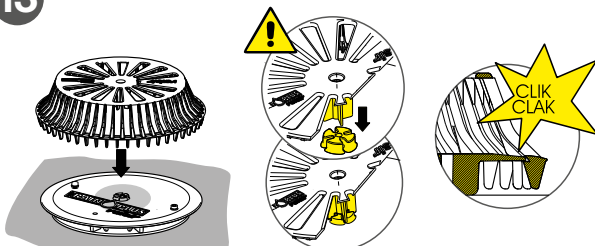

14

Vid behov använd medföljande skruv för att fästa lövsilen på luftlåset.
If necessary use the screw supplied to fix the leaf guard to the anti-vortex plate.

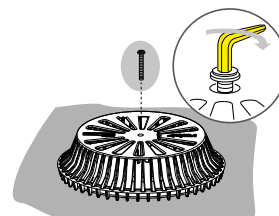

DRIFT OCH UNDERHÅLL

MAINTENANCE

Tak måste regelbundet rensas från löv, skräp och annat som kan orsaka igensättning av brunnarna. Tidsperioden mellan underhållen an brunnarna kan variera beroende på miljöförhållandena (vind, träd, grus, etc.) Det rekommenderas att underhåll utförs innan regnperioden börjar.
Roofs must be cleaned regularly removing any leaves, debris or anything else that may cause the outlets to block. The interval in witch the outlets must be cleaned should be in accordance with local environmental conditions (wind, trees, season etc). It is also advisable to carry this maintenance out just rainy season.

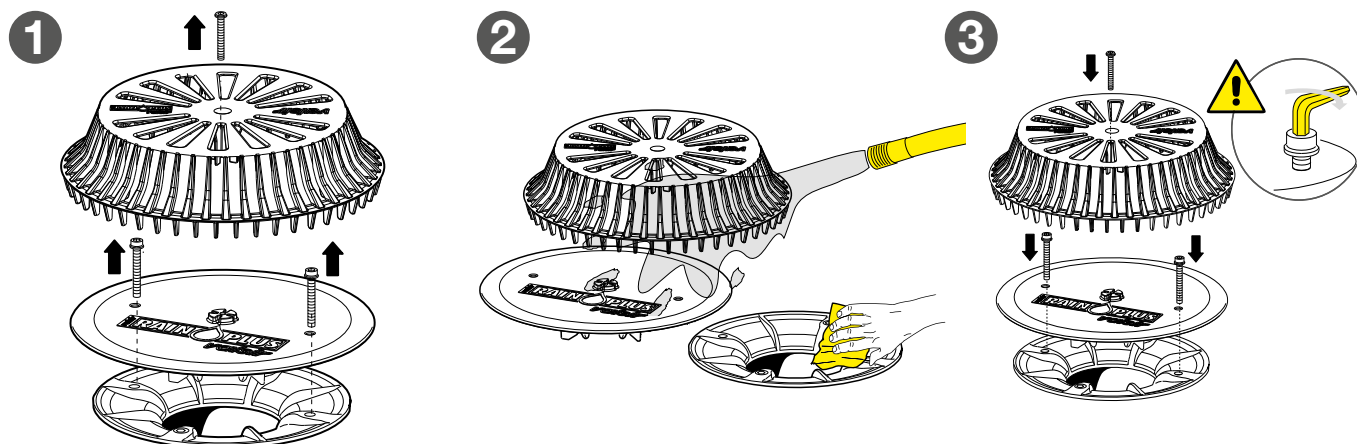

VALSIR S.p.A.
Località Merlaro, 2
25078 Vestone (BS) - Italy
Tel. +39 0365 877.011
Fax +39 0365 81.268
e-mail: assistenza@valsir.it
www.valsir.it

Soggetta all'attività di direzione e coordinamento ex art. 2497 bis C.C.
da parte di Fondital Group S.p.A. - Codice Fiscale 02075160172

valsir[®]
QUALITY FOR PLUMBING